

STATE OF MISSOURI
DEPARTMENT OF NATURAL RESOURCES

MISSOURI CLEAN WATER COMMISSION



MISSOURI STATE OPERATING PERMIT

In compliance with the Missouri Clean Water Law (Chapter 644 RSMo, hereinafter, the Law), and the Federal Water Pollution Control Act (Public Law 92-500, 92nd Congress) as amended,

Permit No.	MO-0123285
Owner:	Kids Across America
Address:	2036 Timberlake Road, Branson, MO 65616
Continuing Authority:	Same as above
Address:	Same as above
Facility Name:	Kids Across America Kamp II
Facility Address:	26272 Private Road 2232. Golden, MO 65658
Legal Description:	Sec.27, T22N, R25W, Barry County
UTM Coordinates:	X=444314, Y= 4049649
Receiving Stream:	Tributary to Table Rock Lake (L2)
First Classified Stream and ID:	Table Rock Lake (L2) (7313) 303(d) List
USGS Basin & Sub-watershed No.:	(11010001-0808)

is authorized to discharge from the facility described herein, in accordance with the effluent limitations and monitoring requirements as set forth herein:

FACILITY DESCRIPTION

Outfall #001 – Residential Subdivision – SIC #7032

Chemical addition for phosphorus removal / septic tanks / splitter-box / recirculating sand filter / ultraviolet disinfection / sludge removed by contract hauler.

Design population equivalent is 638.

Design flow is 66,425 gallons per day.

Actual flow is 37,000 gallons per day.

Design sludge production is 6.38 dry tons/year.

This permit authorizes only wastewater discharges under the Missouri Clean Water Law and the National Pollutant Discharge Elimination System; it does not apply to other regulated areas.

<u>April 1, 2019</u>	<u>January 1, 2024</u>
Effective Date	Modification Date

March 31, 2024
Expiration Date

John Hoke, Director, Water Protection Program

OUTFALL #001	TABLE A-1. FINAL EFFLUENT LIMITATIONS AND MONITORING REQUIREMENTS					
The permittee is authorized to discharge from outfall number(s) as specified in the application for this permit. The final effluent limitations in Table A-1 shall become effective on December 8, 2023 and remain in effect until expiration of the permit. Such discharges shall be controlled, limited and monitored by the permittee as specified below:						
EFFLUENT PARAMETER(S)	UNITS	FINAL EFFLUENT LIMITATIONS			MONITORING REQUIREMENTS	
		DAILY MAXIMUM	WEEKLY AVERAGE	MONTHLY AVERAGE	MEASUREMENT FREQUENCY	SAMPLE TYPE
Limit Set: Q						
Flow	MGD	*		*	once/quarter****	24 hr. estimate
Biochemical Oxygen Demand ₅	mg/L		30	20	once/quarter****	grab
Total Suspended Solids	mg/L		30	20	once/quarter****	grab
<i>E. coli</i> (Note 1)	#/100mL	630		126	once/quarter****	grab
Ammonia as N (Jan 1 – Mar 31)	mg/L	12.1		4.6	once/quarter****	grab
Ammonia as N (Apr 1 – Jun 30)	mg/L	12.1		4.0	once/quarter****	grab
Ammonia as N (Jul 1 – Sep 30)	mg/L	12.1		4.0	once/quarter****	grab
Ammonia as N (Oct 1 – Dec 31)	mg/L	12.1		4.6	once/quarter****	grab
Oil & Grease	mg/L	15		10	once/quarter****	grab
Total Phosphorus	mg/L	*		0.5	once/quarter****	grab
Aluminum, Total Recoverable	mg/L	*		*	once/quarter****	grab
EFFLUENT PARAMETER(S)	UNITS	MINIMUM		MAXIMUM	MEASUREMENT FREQUENCY	SAMPLE TYPE
pH – Units***	SU	6.5		9.0	once/quarter****	grab
MONITORING REPORTS SHALL BE SUBMITTED QUARTERLY ; THE FIRST REPORT IS DUE JANUARY 28, 2024 . THERE SHALL BE NO DISCHARGE OF FLOATING SOLIDS OR VISIBLE FOAM IN OTHER THAN TRACE AMOUNTS.						

* Monitoring requirement only.

*** pH is measured in pH units and is not to be averaged.

**** See table below for quarterly sampling.

Quarterly Minimum Sampling Requirements				
Quarter	Months	<i>E. coli</i>	All Other Parameters	Report is Due
First	January, February, March	Not required to sample.	Sample at least once during any month of the quarter	April 28 th
Second	April, May, June	Sample at least once during any month of the quarter	Sample at least once during any month of the quarter	July 28 th
Third	July, August, September	Sample at least once during any month of the quarter	Sample at least once during any month of the quarter	October 28 th
Fourth	October	Sample once during October	Sample at least once during any month of the quarter	January 28 th
	November & December	Not required to sample.		

Note 1 – Effluent limitations and monitoring requirements for *E. coli* are applicable only during the recreational season from April 1 through October 31. The Monthly Average Limit for *E. coli* is expressed as a geometric mean.

Note x – If no Aluminum was used in a given sampling period, an actual analysis is not necessary. Simply report as “AG – Conditional Monitoring Not Required this Period”.

B. STANDARD CONDITIONS

In addition to specified conditions stated herein, this permit is subject to the attached Parts I & III standard conditions dated August 1, 2014, and August 1, 2019, and hereby incorporated as though fully set forth herein.

C. SPECIAL CONDITIONS

1. Electronic Discharge Monitoring Report (eDMR) Submission System. Per 40 CFR Part 127 National Pollutant Discharge Elimination System (NPDES) Electronic Reporting Rule, reporting of effluent monitoring data and any report required by the permit (unless specifically directed otherwise by the permit) shall be submitted by the permittee via an electronic system to ensure timely, complete, accurate, and nationally consistent set of data about the NPDES program.
 - (a) eDMR Registration Requirements. The permittee must register with the Department's eDMR system through the Missouri Gateway for Environmental Management (MoGEM) before the first report is due. Registration and other information regarding MoGEM can be found at <https://dnr.mo.gov/data-e-services/missouri-gateway-environmental-management-mogem>. Information about the eDMR system can be found at <https://dnr.mo.gov/water/business-industry-other-entities/reporting/electronic-discharge-monitoring-reporting-system-edmr>. The first user shall register as an Organization Official and the association to the facility must be approved by the Department. Regarding Standard Conditions Part I, Section B, #7, the eDMR system is currently the only Department approved reporting method for this permit unless a waiver is granted by the Department. See paragraph (c) below.
 - (b) Electronic Submissions. To access the eDMR system, use the following link in your web browser: <https://apps5.mo.gov/mogems/welcome.action>. If you experience difficulties with using the eDMR system you may contact edmr@dnr.mo.gov or call 855-789-3889 or 573-526-2082 for assistance.
 - (c) Waivers from Electronic Reporting. The permittee must electronically submit compliance monitoring data and reports unless a waiver is granted by the Department in compliance with 40 CFR Part 127. The permittee may obtain an electronic reporting waiver by first submitting an eDMR Waiver Request Form: <https://dnr.mo.gov/document-search/electronic-discharge-monitoring-report-waiver-request-form-mo-780-2692>. The Department will either approve or deny this electronic reporting waiver request within 120 calendar days.
2. The full implementation of this operating permit, which includes implementation of any applicable schedules of compliance, shall constitute compliance with all applicable federal and state statutes and regulations in accordance with §644.051.19, RSMo, and the Clean Water Act (CWA) section 402(k); however, this permit may be reopened and modified, or alternatively revoked and reissued:
 - (a) To comply with any applicable effluent standard or limitation issued or approved under Sections 301(b)(2)(C) and (D), 304(b)(2), and 307(a)(2) of the CWA, if the effluent standard or limitation so issued or approved:
 - (1) contains different conditions or is otherwise more stringent than any effluent limitation in the permit; or
 - (2) controls any pollutant not limited in the permit.
3. All outfalls must be clearly marked in the field.
4. Permittee will cease discharge by connection to a facility with an area-wide management plan per 10 CSR 20-6.010(2)(B) within the timeframe allotted by the continuing authority with its notice of its availability. The permittee shall obtain Department approval for closure according to section 10 CSR 20-6.010(12) or alternate use of these facilities.
5. Report as no-discharge when a discharge does not occur during the report period.
6. Reporting of Non-Detects:
 - (a) An analysis conducted by the permittee or their contracted laboratory shall be conducted in such a way that the precision and accuracy of the analyzed result can be enumerated.
 - (b) See sufficiently sensitive test method requirements in Standard Conditions Part I, Section A, No. 4 regarding proper testing and method minimum levels used for sample analysis.
 - (c) The permittee shall not report a sample result as "Non-Detect" without also reporting the method minimum level of the test. Reporting as "Non Detect" without also including the method minimum level, will be considered failure to report, which is a violation of this permit.
 - (d) The permittee shall provide the "Non-Detect" sample result using the less than symbol and the method minimum level (e.g., <50 µg/L, if the method minimum level for the parameter is 50 µg/L).
 - (e) Where the permit contains a Department determined Minimum Quantification Level (ML) and the permittee is granted authority in the permit to report zero in lieu of the < ML for a specified parameter (conventional, priority pollutants, metals, etc.), then zero (0) is to be reported for that parameter.
 - (f) For the daily maximum, the facility shall report the highest value. If the highest value was a non-detect, use the less than "<" symbol and the laboratory's highest method minimum level.

- (g) For reporting an average based on all non-detected values, remove the "<" sign from the values, average the values, and then add the "<" symbol back to the resulting average.
 - (h) For reporting an average based on a mix of detected and non-detected values (not including *E. coli*), assign a value of "0" for all non-detects for that reporting period and report the average of all the results.
 - (i) When *E. coli* is not detected above the method minimum level, the permittee must report the data qualifier signifying less than detection limit for that parameter (e.g., <1 #/100mL, if the method minimum level is 1 #/100mL). For reporting a geometric mean based on a mix of detected and non-detected values, use one-half of the detection limit (instead of zero) for non-detects when calculating geometric means.
 - (j) See the Fact Sheet Appendix - Non-Detect Example Calculations for further guidance.
- 7. It is a violation of the Missouri Clean Water Law to fail to pay fees associated with this permit (644.055 RSMo).
 - 8. Bypasses are not authorized at this facility unless they meet the criteria in 40 CFR 122.41(m). If a bypass occurs, the permittee shall report in accordance to 40 CFR 122.41(m)(3), and with Standard Condition Part I, Section B, subsection 2. Bypasses are to be reported to the Southwest Regional Office during normal business hours or by using the online Sanitary Sewer Overflow/Facility Bypass Application located at: <https://dnr.mo.gov/data-e-services/missouri-gateway-environmental-management-mogem> or the Environmental Emergency Response spill-line at 573-634-2436 outside of normal business hours. Once an electronic reporting system compliant with 40 CFR Part 127, the National Pollutant Discharge Elimination System (NPDES) Electronic Reporting Rule, is available all bypasses must be reported electronically via the new system. Blending, which is the practice of combining a partially-treated wastewater process stream with a fully-treated wastewater process stream prior to discharge, is not considered a form of bypass. If the permittee wishes to utilize blending, the permittee shall file an application to modify this permit to facilitate the inclusion of appropriate monitoring conditions.
 - 9. The facility must be sufficiently secured to restrict entry by children, livestock and unauthorized persons as well as to protect the facility from vandalism.
 - 10. An Operation and Maintenance (O & M) manual shall be maintained by the permittee and made available to the operator. The O & M manual shall include key operating procedures and a brief summary of the operation of the facility.
 - 11. An all-weather access road to the treatment facility shall be maintained.
 - 12. The outfall sewer shall be protected and maintained against the effects of floodwater, ice, or other hazards as to reasonably insure its structural stability, freedom from stoppage, and that a sample of the effluent can be obtained at a point after the final treatment process and before the discharge mixes with the receiving waters.
 - 13. The media in the filter beds shall be properly maintained to prevent surface pooling, vegetative growth, and accumulation of leaf litter.

D. NOTICE OF RIGHT TO APPEAL

If you were adversely affected by this decision, you may be entitled to pursue an appeal before the administrative hearing commission (AHC) pursuant to Sections 621.250 and 644.051.6 RSMo. To appeal, you must file a petition with the AHC within thirty days after the date this decision was mailed or the date it was delivered, whichever date was earlier. If any such petition is sent by registered mail or certified mail, it will be deemed filed on the date it is mailed; if it is sent by any method other than registered mail or certified mail, it will be deemed filed on the date it is received by the AHC. Any appeal should be directed to:

Administrative Hearing Commission
U.S. Post Office Building, Third Floor
131 West High Street, P.O. Box 1557
Jefferson City, MO 65102-1557
Phone: 573-751-2422
Fax: 573-751-5018
Website: <https://ahc.mo.gov>

Missouri Department of Natural Resources
Factsheet Addendum
For Construction Permit/Modification
#MO-0123285
Kids Across America Kamp II

This addendum gives pertinent information regarding minor/simple modification(s) to the above listed operating permit for a public comment process. An addendum is not an enforceable part of a Missouri State Operating Permit.

Part I – Proposed Construction

Facility Description:

Mixing tank for phosphorus removal/three septic tank/recirculating tank/ flow splitter/recirculating media filter/ UV disinfection/sludge is removed by contract hauler. Construction is to combine the flows from both Kids Across America Kamps, to have an increased design average flow of 66,425 gpd. Once the proposed construction is completed the Kamp 1 facility, MO-0117803, will be decommissioned and the permit terminated.

The continuing authority/owner, Kids Across America is registered with the Secretary of State's office, NO000709151.

Part II – Reason for the Modification

This operating permit is hereby modified to incorporate the Antidegradation review, the increase in design flow to 66,425 gpd. The existing treatment plant will need to be expanded, by expansion of the filter bed, and increase in the UV disinfection system. The facility's ammonia effluent limits were calculated and compared to the non-degrading limits from the Antidegradation Review, with the Antidegradation effluent limits being the more protective limits. The construction was covered under CP0002255, with the statement of work complete received January 30, 2023.

Standard Condition Part III was updated to reflect the most current version. Special condition related to reporting through the Department's electronic discharge reporting system has been updated to reflect the new system. The non-detect special condition was updated to reflect language on how a facility reports non-detects on their discharge monitoring report.

Part III – Effluent Limitations and Monitoring Requirements

OUTFALL #001 – MAIN FACILITY OUTFALL

Effluent limitations derived and established in the below Effluent Limitations Table are based on current operations of the facility. Future permit action due to facility modification may contain new operating permit terms and conditions that supersede the terms and conditions, including effluent limitations, of this operating permit. See Antidegradation Review for Effluent Limit Derivation.

CHANGES TO EFFLUENT LIMITATIONS TABLE:

PARAMETER	Unit	Basis for Limits	Daily Maximum	Weekly Average	Monthly Average	Previous Permit Limit	Sampling Frequency	Reporting Frequency	Sample Type ****
Flow	MGD	1	*		*	*/*	1/quarter	quarterly	E
BOD ₅	mg/L	1,2,4		30		30/20	1/quarter	quarterly	G
TSS	mg/L	1,2,4		30		30/20	1/quarter	quarterly	G
<i>Escherichia coli</i> **	#/100mL	1, 3	630		126	630/126	1/month	monthly	G
Ammonia as N (Jan 1 – Mar 31) (Apr 1 – Jun 30) (Jul 1 – Sep 30) (Oct 1 – Dec 31)	mg/L	2, 3,4	12.1 12.1 12.1 12.1		4.6 4.0 4.0 4.6	Apr – Sep: 12.1/4.0 Oct - Mar: 12.1/4.6	1/quarter	quarterly	C
Oil & Grease	mg/L	1, 3	15		10	15/10	1/quarter	quarterly	G
Total Phosphorus	mg/L	1,2,4	*		0.5		1/quarter	quarterly	G

Aluminum, Total Recoverable	mg/L	1,2,4	*		*	*/	1/quarter	quarterly	G
PARAMETER	Unit	Basis for Limits	Minimum		Maximum	Previous Permit Limit	Sampling Frequency	Reporting Frequency	Sample Type
pH	SU	1,2	6.5		9.0	6.5/9.0	1/quarter	quarterly	G

* - Monitoring requirement only.

** - #/100mL; the Monthly Average for *E. coli* is a geometric mean.

*** - Parameter not previously established in previous state operating permit.

**** - C = 24-hour composite

G = Grab

T = 24-hr. total

E = 24-hr. estimate

M = Measured/calculated

Basis for Limitations Codes:

- | | | |
|--|-----------------------------------|---|
| 1. State or Federal Regulation/Law | 5. Antidegradation Policy | 9. WET Test Policy |
| 2. Water Quality Standard (includes RPA) | 6. Water Quality Model | 10. Multiple Discharger Variance |
| 3. Water Quality Based Effluent Limits | 7. Best Professional Judgment | 11. Nutrient Criteria Implementation Plan |
| 4. Antidegradation Review | 8. TMDL or Permit in lieu of TMDL | |

OUTFALL #001 – DERIVATION AND DISCUSSION OF LIMITS:

- **Flow.** In accordance with [40 CFR Part 122.44(i)(1)(ii)] the volume of effluent discharged from each outfall is needed to assure compliance with permitted effluent limitations. If the permittee is unable to obtain effluent flow, then it is the responsibility of the permittee to inform the Department, which may require the submittal of an operating permit modification.
- **Biochemical Oxygen Demand (BOD₅).** Operating permit retains xx mg/L as a Weekly Average and xx mg/L as a Monthly Average. Please see the attached Antidegradation Review Sheet/Permit In Lieu of TMDL.
- **Total Suspended Solids (TSS).** Operating permit retains 30 mg/L as a Weekly Average and 20 mg/L as a Monthly Average. Please see the attached Antidegradation Review Sheet.
- ***Escherichia coli (E. coli)*.** Monthly average of 126 per 100 mL as a geometric mean and Daily Maximum of 630 per 100 mL as a geometric mean during the recreational season (April 1 – October 31), for discharges within two miles upstream of segments or lakes with Whole Body Contact Recreation (A) designated use of the receiving stream, as per 10 CSR 20-7.015(9)(B). An effluent limit for both monthly average and daily maximum is required by 40 CFR 122.45(d). The Geometric Mean is calculated by multiplying all of the data points and then taking the nth root of this product, where n = # of samples collected. For example: Five *E. coli* samples were collected with results of 1, 4, 6, 10, and 5 (#/100mL). Geometric Mean = 5th root of (1)(4)(6)(10)(5) = 5th root of 1,200 = 4.1 #/100mL.
- **Total Ammonia Nitrogen.** Early Life Stages Present Total Ammonia Nitrogen criteria apply [10 CSR 20-7.031(5)(B)7.C. & Table B3]. Background total ammonia nitrogen = 0.01 mg/L. No Zone of Initial Dilution allowed [10 CSR 20-7.031(5)(A)4.B.(IV)(b).

The Department previously followed the 2007 Ammonia Guidance method for derivation of ammonia limits. However, the EPA's Technical Support Document for Water Quality-based Toxic Controls (TSD) establishes other alternatives to limit derivation. The Department has determined that the approach established in Section 5.4.2 of the TSD, which allows for direct application of both the acute and chronic wasteload allocations (WLA) as permit limits for toxic pollutants, is more appropriate limit derivation approach. Using this method for a discharge to a waterbody where mixing is not allowed, the criterion continuous concentration (CCC) and the criterion maximum concentration (CMC) will equal the chronic and acute WLA respectively. The WLAs are then applied as effluent limits, per Section 5.4.2 of the TSD, where the CMC is the Daily Maximum and the CCC is the Monthly Average. The direct application of both acute and chronic criteria as WLA is also applicable for facilities that discharge into receiving waterbodies with mixing considerations. The CCC and CMC will need to be calculated into WLA with mixing considerations using the mass-balance equation:

$$C_e = \frac{(Q_e + Q_s)C - (Q_s \times C_s)}{(Q_e)}$$

Where C = downstream concentration C_e = effluent concentration
Cs = upstream concentration Q_e = effluent flow
Q_s = upstream flow

In the event that mixing considerations derive an AML less stringent than the MDL, the AML and MDL will be equal and based on the MDL.

Quarter	Temp (°C)*	pH (SU)*	Total Ammonia Nitrogen CCC (mg/L)	Total Ammonia Nitrogen CMC (mg/L)
1 st	11.0	7.8	3.1	12.1
2 nd	21.2	7.8	3.1	12.1
3 rd	26.0	7.8	3.1	12.1
4 th	15.5	7.8	3.1	12.1

* Ecoregion Data (Ozark Highlands)

1Q
Chronic WLA: $C_e = ((0.1030006 + 1.1574)3.1 - (1.1574 * 0.01)) / 0.1030006$ Ce = 38.1
Acute WLA: $C_e = ((0.1030006 + 0)12.1 - (0 * 0.01)) / 0.1030006$ Ce = 12.1
AML = WLA_c = 12.1 mg/L
MDL = WLA_a = 12.1 mg/L

2Q
Chronic WLA: $C_e = ((0.1030006 + 1.1574)3.1 - (1.1574 * 0.01)) / 0.1030006$ Ce = 38.1
Acute WLA: $C_e = ((0.1030006 + 0)12.1 - (0 * 0.01)) / 0.1030006$ Ce = 12.1
AML = WLA_c = 12.1 mg/L
MDL = WLA_a = 12.1 mg/L

3Q
Chronic WLA: $C_e = ((0.1030006 + 1.1574)3.1 - (1.1574 * 0.01)) / 0.1030006$ Ce = 38.1
Acute WLA: $C_e = ((0.1030006 + 0)12.1 - (0 * 0.01)) / 0.1030006$ Ce = 12.1
AML = WLA_c = 12.1 mg/L
MDL = WLA_a = 12.1 mg/L

4Q
Chronic WLA: $C_e = ((0.1030006 + 1.1574)2.7 - (1.1574 * 0.01)) / 0.1030006$ Ce = 32.5
Acute WLA: $C_e = ((0.1030006 + 0)12.1 - (0 * 0.01)) / 0.1030006$ Ce = 12.1
AML = WLA_c = 12.1 mg/L
MDL = WLA_a = 12.1 mg/L

The Non-degrading effluent limits from the Antidegradation Review are more protective, and are the effluent limits being established.

PARAMETER	UNITS	DAILY MAXIMUM	WEEKLY AVERAGE	MONTHLY AVERAGE
AMMONIA AS N (APRIL 1 – SEPT 30)	MG/L	12.1		4.0
AMMONIA AS N (OCT 1 – MAR 31)	MG/L	12.1		4.6

- **pH.** 6.5-9.0 SU. pH limitations of 6.0-9.0 SU [10 CSR 20-7.015] are not protective of the in-stream Water Quality Standard, which states that water contaminants shall not cause pH to be outside the range of 6.5-9.0 SU.
- **Total Phosphorus.** To Table Rock Lake and Lake Taneycomo, 0.5 mg/L per 10 CSR 20-7.015 (3).

- **Aluminum, Total Recoverable.** Monitoring requirement only. This facility uses chemicals for phosphorous removal that may contain aluminum. Monitoring is required to determine if reasonable potential exists for this facility's discharge to exceed water quality standards for Aluminum (Total Recoverable).

Sampling Frequency Justification: The Department has determined that previously established sampling and reporting frequency is sufficient to characterize the facility's effluent and be protective of water quality

Sampling Type Justification: As per 10 CSR 20-7.015, BOD₅, and TSS collected for media filters may be grab samples. Grab samples must be collected for pH, *E. coli*, and Oil & Grease, in accordance with recommended analytical methods. For further information on sampling and testing methods please review 10 CSR 20-7.015(9)(D) 2.

Part IV – Rationale and Derivation of Effluent Limitations & Permit Conditions

ANTI-BACKSLIDING:

A provision in the Federal Regulations [CWA §303(d)(4); CWA §402(o); 40 CFR Part 122.44(l)] that requires a reissued permit to be as stringent as the previous permit with some exceptions.

- ✓ All limits in this operating permit are at least as protective as those previously established; therefore, backsliding does not apply.

ANTIDEGRADATION:

In accordance with Missouri's Water Quality Standard [10 CSR 20-7.031(3)], for domestic wastewater discharge with new, altered, or expanding discharges, the Department is to document by means of Antidegradation Review that the use of a water body's available assimilative capacity is justified. In accordance with Missouri's water quality regulations for antidegradation [10 CSR 20-7.031(3)], degradation may be justified by documenting the socio-economic importance of a discharge after determining the necessity of the discharge. Facilities must submit the antidegradation review request to the Department prior to establishing, altering, or expanding discharges. See <https://dnr.mo.gov/document-search/antidegradation-implementation-procedure>

- ✓ This permit contains new and/or expanded discharge; please see **APPENDIX C- ANTIDEGRADATION ANALYSIS.**

BIOSOLIDS & SEWAGE SLUDGE:

Biosolids are solid materials resulting from domestic wastewater treatment that meet federal and state criteria for beneficial uses (i.e. fertilizer). Sewage sludge is solids, semi-solids, or liquid residue generated during the treatment of domestic sewage in a treatment works; including but not limited to, domestic septage; scum or solids removed in primary, secondary, or advanced wastewater treatment process; and a material derived from sewage sludge. Sewage sludge does not include ash generated during the firing of sewage sludge in a sewage sludge incinerator or grit and screening generated during preliminary treatment of domestic sewage in a treatment works.

- ✓ Permittee is not authorized to land apply biosolids. Sludge/biosolids are removed by contract hauler.

CONTINUING AUTHORITY

Each application for a construction permit or operating permit shall identify the person, as that term is defined in section 644.016(15), RSMo, that is the owner of, operator of, or area-wide management authority for a water contaminant source, point source, wastewater treatment facility, or sewer collection system. This person shall be designated as the continuing authority and shall sign the application. By doing so, the person designated as the continuing authority acknowledges responsibility for compliance with all permit conditions.

- ✓ This is a business and is located outside the service area of a publicly owned or PSC regulated system. The owner and/or continuing authority is in good standing with the Secretary of State's Office and its charter number is N00033786.
 - ✓ At the time of this permit drafting, the facility is located more than a mile from the closest permitted facility and approximately 15 miles from the City of Cassville, which is the closest facility with the potential to be able to accept the flows.

ELECTRONIC DISCHARGE MONITORING REPORT (EDMR) SUBMISSION SYSTEM:

The U.S. Environmental Protection Agency (EPA) promulgated a final rule on October 22, 2015, to modernize Clean Water Act reporting for municipalities, industries, and other facilities by converting to an electronic data reporting system. This final rule requires regulated entities and state and federal regulators to use information technology to electronically report data required by the National Pollutant Discharge Elimination System (NPDES) permit program instead of filing paper reports. To comply with the federal rule, the Department is requiring all permittees to begin submitting discharge monitoring data and reports online. In an effort to aid

facilities in the reporting of applicable information electronically, the Department has created several new forms including operational control monitoring forms and an I&I location and reduction form. These forms are optional and found on the Department's website at the following locations:

Per 40 CFR 127.15 and 127.24, permitted facilities may request a temporary waiver for up to five years or a permanent waiver from electronic reporting from the Department. To obtain an electronic reporting waiver, a permittee must first submit an eDMR Waiver Request Form: <https://dnr.mo.gov/document-search/electronic-discharge-monitoring-report-waiver-request-form-mo-780-2692>. Each facility must make a request. If a single entity owns or operates more than one facility, then the entity must submit a separate request for each facility based on its specific circumstances. An approved waiver is non-transferable.

The Department must review and notify the facility within 120 calendar days of receipt if the waiver request has been approved or rejected [40 CFR 124.27(a)]. During the Department review period as well as after a waiver is granted, the facility must continue submitting a hard-copy of any reports required by their permit. The Department will enter data submitted in hard-copy from those facilities allowed to do so and electronically submit the data to the EPA on behalf of the facility.

- ✓ The permittee/facility is currently using the eDMR data reporting system.

NUMERIC LAKE NUTRIENT CRITERIA:

- ✓ This facility discharges into a lake watershed (Table Rock Lake) where numeric lake nutrient criteria are applicable; however, regulations established in 10 CSR 20-7.015 as well as the Department's lake nutrient criteria implementation plan do not require nutrient monitoring for facilities with design flows less than or equal to 0.1 MGD. The Department issued a memorandum on December 11, 2020 regarding facilities excluded from Table Rock Lake reasonable potential analysis which states, "All minor domestic wastewater treatment facilities located in subwatersheds that are not directly adjacent to Table Rock Lake were found to contribute minimal nutrients compared to nonpoint sources. These facilities do not have reasonable potential to cause or contribute to water quality impairments in Table Rock Lake". In accordance with 10 CSR 7.015(3), Total Phosphorus limit of 0.5 mg/L is required.

WASTELOAD ALLOCATIONS (WLA) FOR LIMITS:

As per [10 CSR 20-2.010(86)], the amount of pollutant each discharger is allowed by the Department to release into a given stream after the Department has determined total amount of pollutant that may be discharged into that stream without endangering its water quality.

- ✓ Wasteload allocations were calculated where applicable using water quality criteria or water quality model results and the dilution equation below:

$$C_e = \frac{(Q_e + Q_s)C - (Q_s \times C_s)}{(Q_e)} \quad (\text{EPA/505/2-90-001, Section 4.5.5})$$

Where C = downstream concentration C_e = effluent concentration
Cs = upstream concentration Q_e = effluent flow
Q_s = upstream flow

Chronic wasteload allocations were determined using applicable chronic water quality criteria (CCC: criteria continuous concentration) and stream volume of flow at the edge of the mixing zone (MZ). Acute wasteload allocations were determined using applicable water quality criteria (CMC: criteria maximum concentration) and stream volume of flow at the edge of the zone of initial dilution (ZID).

Water quality based maximum daily and average monthly effluent limitations were calculated using methods and procedures outlined in USEPA's "Technical Support Document For Water Quality-based Toxics Control" (EPA/505/2-90-001).

Number of Samples "n":

Additionally, in accordance with the TSD for water quality-based permitting, effluent quality is determined by the underlying distribution of daily values, which is determined by the Long Term Average (LTA) associated with a particular Wasteload Allocation (WLA) and by the Coefficient of Variation (CV) of the effluent concentrations. Increasing or decreasing the monitoring frequency does not affect this underlying distribution or treatment performance, which should be, at a minimum, be targeted to comply with the values dictated by the WLA. Therefore, it is recommended that the actual planned frequency of monitoring normally be used to

determine the value of “n” for calculating the AML. However, in situations where monitoring frequency is once per month or less, a higher value for “n” must be assumed for AML derivation purposes. Thus, the statistical procedure being employed using an assumed number of samples is “n = 4” at a minimum. For Total Ammonia as Nitrogen, “n = 30” is used.

Part V – Administrative Requirements

On the basis of preliminary staff review and the application of applicable standards and regulations, the Department, as administrative agent for the Missouri Clean Water Commission, proposes to issue a permit(s) subject to certain effluent limitations, schedules, and special conditions contained herein and within the operating permit. The proposed determinations are tentative pending public comment.

PERMIT SYNCHRONIZATION:

The Department of Natural Resources is currently undergoing a synchronization process for operating permits. Permits are normally issued on a five-year term, but to achieve synchronization many permits will need to be issued for less than the full five years allowed by regulation. The intent is that all permits within a watershed will move through the Watershed Based Management (WBM) cycle together will all expire in the same fiscal year. This will allow further streamlining by placing multiple permits within a smaller geographic area on public notice simultaneously, thereby reducing repeated administrative efforts. This will also allow the Department to explore a watershed based permitting effort at some point in the future. Renewal applications must continue to be submitted within 180 days of expiration, however, in instances where effluent data from the previous renewal is less than 4 years old, that data may be re-submitted to meet the requirements of the renewal application. If the permit provides a schedule of compliance for meeting new water quality based effluent limits beyond the expiration date of the permit, the time remaining in the schedule of compliance will be allotted in the renewed permit. With permit synchronization, this permit will expire in the 1st Quarter of calendar year 2024.

PUBLIC NOTICE:

The Department shall give public notice that a draft permit has been prepared and its issuance is pending. Additionally, public notice will be issued if a public hearing is to be held because of a significant degree of interest in and water quality concerns related to a draft permit. No public notice is required when a request for a permit modification or termination is denied; however, the requester and permittee must be notified of the denial in writing. The Department must issue public notice of a pending operating permit or of a new or reissued statewide general permit. The public comment period is the length of time not less than 30 days following the date of the public notice which interested persons may submit written comments about the proposed permit. For persons wanting to submit comments regarding this proposed operating permit, then please refer to the Public Notice page located at the front of this draft operating permit. The Public Notice page gives direction on how and where to submit appropriate comments.

✓ The Public Notice period for this operating permit was October 8, 2021 to November 8, 2021. No comments received.

DATE OF FACT SHEET: SEPTEMBER 23, 2021

COMPLETED BY:

LEASUE MEYERS, EI
MISSOURI DEPARTMENT OF NATURAL RESOURCES
WATER PROTECTION PROGRAM
ENGINEERING SECTION
leasue.meyers@dnr.mo.gov

APPENDIX A –PROCESS FLOW DIAGRAM

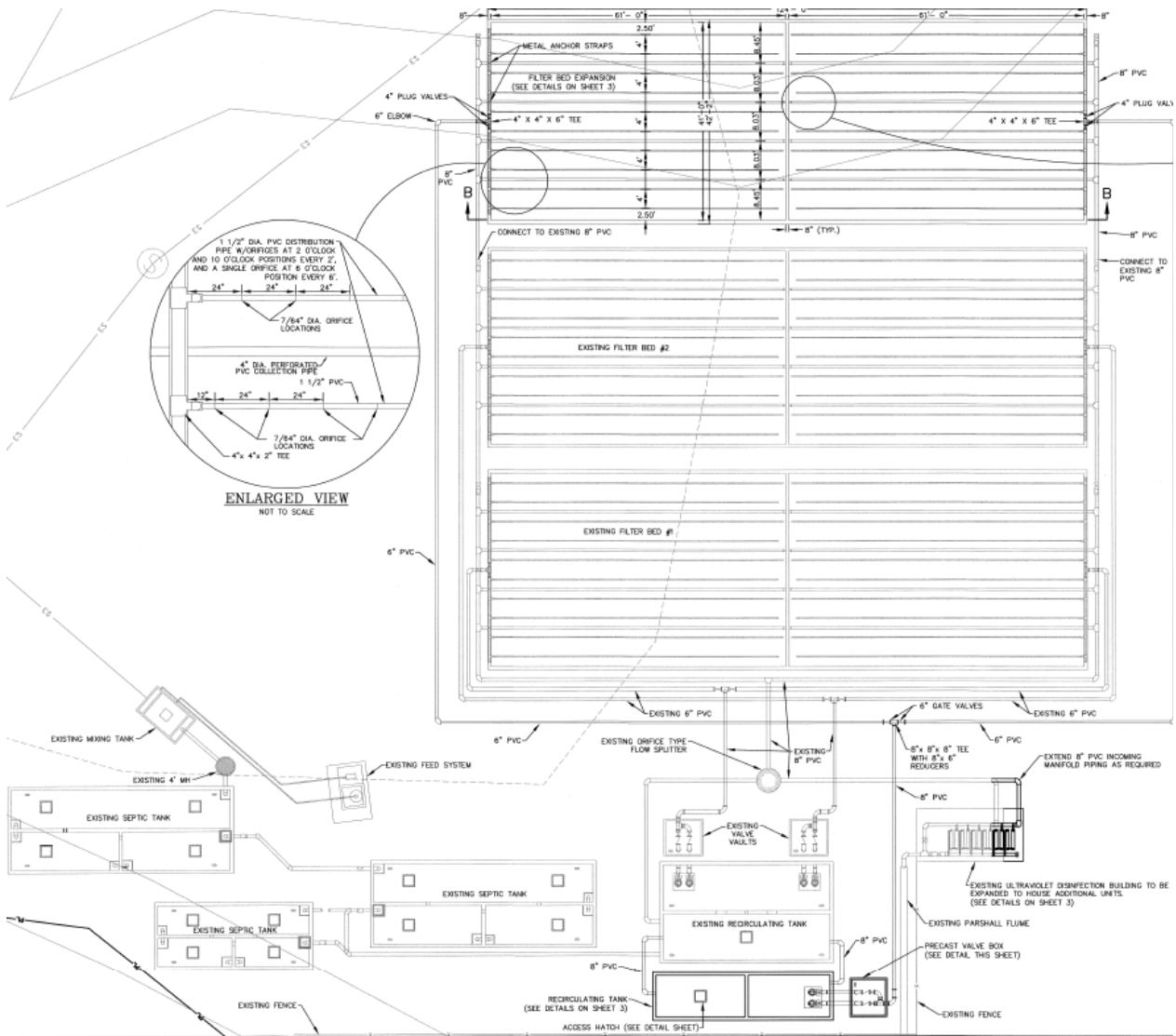

APPENDIX B – NON-DETECT EXAMPLE CALCULATIONS:

Example: Permittee has four samples for Pollutant X which has a method minimum level of 5 mg/L and is to report a Daily Maximum and Monthly Average.

Week 1 = 11.4 mg/L
Week 2 = Non-Detect or <5.0 mg/L
Week 3 = 7.1 mg/L
Week 4 = Non-Detect or <5.0 mg/L

For this example, use subpart (h) - For reporting an average based on a mix of detected and non-detected values (not including *E. coli*), assign a value of “0” for all non-detects for that reporting period and report the average of all the results.

$$11.4 + 0 + 7.1 + 0 = 18.5 \div 4 \text{ (number of samples)} = 4.63 \text{ mg/L.}$$

The Permittee reports a Monthly Average of 4.63 mg/L and a Daily maximum of 11.4 mg/L (Note the < symbol was dropped in the answers).

Example: Permittee has five samples for Pollutant Y that has a method minimum level of 9 µg/L and is to report a Daily Maximum and Monthly Average.

Day 1 = Non-Detect or <9.0 µg/L
Day 2 = Non-Detect or <9.0 µg/L
Day 3 = Non-Detect or <9.0 µg/L
Day 4 = Non-Detect or <9.0 µg/L
Day 5 = Non-Detect or <9.0 µg/L

For this example, use subpart (g) - For reporting an average based on all non-detected values, remove the “<” sign from the values, average the values, and then add the “<” symbol back to the resulting average.

$$(9 + 9 + 9 + 9 + 9) \div 5 \text{ (number of samples)} = <9 \text{ µg/L.}$$

The Permittee reports a Monthly Average of <9.0 µg/L (retain the ‘less than’ symbol) and a Daily Maximum of <9.0 µg/L.

Example: Permittee has four samples for Pollutant Z where the first two tests were conducted using a method with a method minimum level of 4 µg/L and the remaining two tests were conducted using a different method that has a method minimum level of <6 µg/L and is to report a Monthly Average and a Weekly Average.

Week 1 = Non-Detect or <4.0 µg/L
Week 2 = Non-Detect or <4.0 µg/L
Week 3 = Non-Detect or <6.0 µg/L
Week 4 = Non-Detect or <6.0 µg/L

For this example, use subpart (g) - For reporting an average based on all non-detected values, remove the “<” sign from the values, average the values, and then add the “<” symbol back to the resulting average.

$$(4 + 4 + 6 + 6) \div 4 \text{ (number of samples)} = <5 \text{ µg/L. (Monthly)}$$

The facility reports a Monthly Average of <5.0 µg/L and a Weekly Average of <6.0 µg/L.

APPENDIX – NON-DETECT EXAMPLE CALCULATIONS (Continued):

Example: Permittee has five samples for Pollutant Z where the first two tests were conducted using a method with a method minimum level of 4 µg/L and the remaining three tests were conducted using a different method that has a method minimum level of <6 µg/L and is to report a Monthly Average and a Weekly Average.

Week 1 = Non-Detect or <4.0 µg/L
Week 2 = Non-Detect or <4.0 µg/L
Week 2 = Non-Detect or <6.0 µg/L
Week 3 = Non-Detect or <6.0 µg/L
Week 4 = Non-Detect or <6.0 µg/L

For this example, use subpart (g) - For reporting an average based on all non-detected values, remove the "<" sign from the values, average the values, and then add the "<" symbol back to the resulting average.

$(4 + 4 + 6 + 6 + 6) \div 5$ (number of samples) = <5.2 µg/L. (Monthly)
 $(4 + 6) \div 2$ (number of samples) = <5 µg/L. (Week 2)

The facility reports a Monthly Average of <5.2 µg/L and a Weekly Average of <6.0 µg/L (report highest Weekly Average value)

Example: Permittee has four samples for Pollutant Z where the tests were conducted using a method with a method minimum level of 10 µg/L and is to report a Monthly Average and Daily Maximum. The permit lists that Pollutant Z has a Department determined Minimum Quantification Level (ML) of 130 µg/L.

Week 1 = 12 µg/L
Week 2 = 52 µg/L
Week 3 = Non-Detect or <10 µg/L
Week 4 = 133 µg/L

For this example, use subpart (h) - For reporting an average based on a mix of detected and non-detected values (not including *E. coli*), assign a value of "0" for all non-detects for that reporting period and report the average of all the results.

For this example, $(12 + 52 + 0 + 133) \div 4$ (number of samples) = 197.4 = 49.3 µg/L.

The facility reports a Monthly Average of 49.3 µg/L and a Daily Maximum of 133 µg/L.

Example: Permittee has five samples for *E. coli* which has a method minimum level of 1 #/100mL and is to report a Weekly Average (seven (7) day geometric mean) and a Monthly Average (thirty (30) day geometric mean).

Week 1 = 102 #/100mL
Week 2 (Monday) = 400 #/100mL
Week 2 (Friday) = Non-Detect or <1 #/100mL
Week 3 = 15 #/100mL
Week 4 = Non-Detect or <1 #/100mL

For this example, use subpart (i) - When *E. coli* is not detected above the method minimum level, the permittee must report the data qualifier signifying less than detection limit for that parameter (e.g., <1 #/100mL, if the method minimum level is 1 #/100mL). For reporting a geometric mean based on a mix of detected and non-detected values, use one-half of the detection limit (instead of zero) for non-detects when calculating geometric means. The Geometric Mean is calculated by multiplying all of the data points and then taking the nth root of this product, where n = # of samples collected.

The Monthly Average (30 day Geometric Mean) = 5th root of $(102)(400)(0.5)(15)(0.5)$ = 5th root of 153,000 = 10.9 #/100mL.
The 7 day Geometric Mean = 2nd root of $(400)(0.5)$ = 2nd root of 200 = 14.1 #/100mL. (Week 2)

The Permittee reports a Monthly Average (30 day Geometric Mean) of 10.9 #/100mL and a Weekly Average (7 day geometric mean) of 102 #/100mL (report highest Weekly Average value)

APPENDIX C – ANTIDEGRADATION



July 8, 2020

Larry Callen
Kids Across America Foundation
26272 Private Rd 2232
Golden, MO 65658

RE: Water Quality and Antidegradation Review Preliminary Determination for Kids Across America Foundation WWTF, Barry County

Dear Larry Callen:

Enclosed please find the finalized Water Quality and Antidegradation Review (WQAR) for the *Antidegradation Review Request for Kids Across America Foundation WWTF* dated May 26, 2020, in Barry County. The WQAR contains pertinent antidegradation review information based on the use of existing effluent limitations, and monitoring requirements for the facility discharge. It was developed in accordance with 10 CSR 20-7.031, the Clean Water Commission approved *Missouri Antidegradation Implementation Procedure* (AIP) dated July 13, 2016, U.S. Environmental Protection Agency (US EPA) guidance, the applicant-supplied antidegradation review documentation, and the State of Missouri's effluent regulations (10 CSR 20-7.015). Please refer to the *General Assumptions of the Water Quality and Antidegradation Review* section of the enclosed WQAR. The WQAR is preliminary and subject to change as new information becomes available during future permit application processing.

Based on the Missouri Department of Natural Resources' (department's) initial review, preliminary determination is that the applicant-supplied antidegradation review documentation satisfies the requirements of the AIP. This WQAR/preliminary determination may be appealed within 30 days of this letter in accordance with the AIP Section II.F.4.

You may proceed with submittal of an engineering report/facility plan for this project. Upon completion of that review the next step will be to submit a complete application for a construction permit. An operating permit application will also be required 180 days prior to expected discharge. These submittals must reflect the design flow, facility description, and general treatment components of this WQAR or this preliminary determination may have to be revisited. To reduce cost and time spent scanning permit applications, plans, and specification, the Water Protection Program's Engineering Section has begun asking for electronic copies of submitted documents in addition to paper copies. While it is not currently a requirement, submittal of electronic documents on a compact disc or other removable electronic media is being proposed in the new rulemaking for 10 CSR 20-6.010.

Following the department's public notice of a draft Missouri State Operating Permit including the antidegradation review findings and preliminary determination, the department will review any public notice comments received. If significant comments are made, the project may require another



Larry Callen
Page Two

public notice and potentially another antidegradation review. If no comments are received or comments are resolved without another public notice, these findings and determinations will be considered final.

Following issuance of the construction permit and completion of the actual facility construction, the department will proceed with the issuance of the operating permit.

Notice to Permittees: On August 22, 2013, the Environmental Protection Agency (EPA) published a notice in the Federal Register announcing the final national recommended ambient water quality criteria for protection of aquatic life from the effects of ammonia in freshwater. The EPA's guidance, *Final Aquatic Life Ambient Water Quality Criteria for Ammonia – Fresh Water 2013*, is not a rule, nor automatically part of a state's water quality standards. States must adopt new ammonia criteria consistent with EPA's published ammonia criteria into their water quality standards that protect aquatic life in water.

The Water Protection Program (WPP) is providing this notice to inform permittees that EPA's published ammonia criteria for aquatic life protection is lower than the current Missouri criteria. The Department has begun discussions about how these new criteria will be implemented. WPP is suggesting that all permittees consider the lower ammonia criteria and adjust the alternative analysis or proposed alternative's treatment design, if they so choose. Consideration of the future ammonia criteria at this time could avoid a near-future upgrade. More information about the new ammonia criteria for aquatic life protection may be found at: <http://dnr.mo.gov/pubs/pub2481.htm>.

If you should have questions regarding the enclosed WQAR, please contact Aaron Sawyer by telephone at (573) 526-5489 by e-mail at aaron.sawyer@dnr.mo.gov, or by mail at the Missouri Department of Natural Resources, Water Protection Program, P.O. Box 176, Jefferson City, Missouri 65102-0176.

Sincerely,

WATER PROTECTION PROGRAM



Cindy LePage, P.E., Chief
Engineering Section

CL:ast

cc: Wayne Diebold, P.E.; Rozell Engineering Company

Water Quality and Antidegradation Review

*For the Protection of Water Quality
and Determination of Effluent Limits for Discharge to
Tributary to Table Rock Lake*

by

***Kids Across America
Wastewater Treatment Facility***



July, 2020

Table of Contents

1.	Facility Information	14
2.	Water Quality Information.....	14
2.1.	Water Quality History:.....	14
3.	Receiving Waterbody Information	14
4.	General Comments.....	15
5.	Antidegradation Review Information	15
5.1.	TIER DETERMINATION	15
	Table 1. Pollutants of Concern and Tier Determination	15
5.2.	EXISTING WATER QUALITY	15
5.3.	NO DISCHARGE EVALUATION	16
5.4.	LOSING STREAM ALTERATIVE DISCHARGE LOCATION	16
5.5.	DEMONSTRATION OF INSIGNIFICANCE	16
	Table 2. Net Change in Loadings Based upon Current and Proposed Permit Limits.....	16
5.6.	DEMONSTRATION OF NECESSITY AND SOCIAL AND ECONOMIC IMPORTANCE.....	17
6.	General Assumptions of the Water Quality and Antidegradation Review	17
7.	Mixing Considerations.....	17
8.	Permit Limits and Monitoring Information	17
	TABLE 3. EFFLUENT LIMITS FOR OUTFALL #001	18
9.	Receiving Water Monitoring Requirements	18
10.	Derivation and Discussion of Limits	18
10.1.	OUTFALL #001 – MAIN FACILITY OUTFALL	19
10.2.	LIMIT DERIVATION	19
11.	ANTIDEGRADATION REVIEW PRELIMINARY DETERMINATION.....	21
	Appendix A: Map of Discharge Location Outfall #001.	22
	Appendix B: Antidegradation Review Summary Attachments	23

1. Facility Information

FACILITY NAME: Kids Across America Wastewater Treatment Facility (WWTF) NPDES #: MO-0123285

FACILITY TYPE/DESCRIPTION:

FACILITY TYPE: NON-POTW– Residential Subdivision– SIC #7032

FACILITY DESCRIPTION:

The current facility contains three-cell septic tanks followed by a splitter-box. A recirculating sand filter provides treatment followed by UV disinfection, and includes chemical addition for phosphorus removal. Sludge from the facility is removed by a contract hauler. The existing permitted design flow is 48,952 gpd with actual flows of 37,000 gpd. The campground has a second permitted facility, MO-0117803, with a design flow of 17,500 gpd.

The purpose of the proposal is to combine flows from Kids Across America Kamp 1 WWTF and Kids Across America WWTF into a single treatment system. The proposal is to utilize the existing 22,000 gallon septic tank associated with MO-0117803 and direct the flows to the collection system that feeds MO-0123285, where it will receive treatment prior to discharge. This proposed increase in flows received at MO-0123285, totaling 66,452 gpd, will require upgrades to the facility including the addition of recirculating sand filter beds, recirculation tank capacity, and increasing the UV disinfection design capacity. Once the proposed construction is completed the Kamp 1 facility, MO-0117803, will be decommissioned and the permit terminated. The entire campground will then be serviced by a single treatment facility instead of two. No new pollutants will be incorporated into the system and no new flows are proposed to the receiving waterbody segment beyond what is already permitted for the two existing treatment plants.

COUNTY:	<u>Barry</u>	UTM COORDINATES:	<u>X= 444314 / Y=4049649</u>
12- DIGIT HUC:	<u>11010001-0808</u>	LEGAL DESCRIPTION:	<u>Sec. 27 , T22 N, R25W</u>
EDU*:	<u>Ozark/White</u>	ECOREGION:	<u>White River Hills</u>

* - Ecological Drainage Unit

2. Water Quality Information

In accordance with Missouri's Water Quality Standard [10 CSR 20-7.031(3)] and federal antidegradation policy at Title 40 Code of Federal Regulation (CFR) Section 131.12 (a), the Missouri Department of Natural Resources (Department) developed a statewide antidegradation policy and corresponding procedures to implement the policy. A proposed discharge to a water body will be required to undergo a level of Antidegradation Review which documents that the use of a water body's available assimilative capacity is justified. Effective August 30, 2008, and revised July 13, 2016, a facility is required to use Missouri's Antidegradation Implementation Procedure (AIP) for new and expanded wastewater discharges.

2.1. Water Quality History:

The discharge monitoring data over the last five years indicates the facility has been able to consistently achieve compliance with permitted effluent limits. The average values over the sampling period from 2015 to 2020 were as follows: NH₃ – 0.8 mg/L, BOD₅ – 3.2 mg/L, TSS – 1.0 mg/L, TP – 0.36 mg/L. The facility has had one exceedance for pH and one for TP in that timeframe. The most common issue has been failure to submit DMRs, however; the campsite is operated seasonally and almost all of the failure to submit results occurred during the winter season when the campsite is not in use. Table Rock Lake is on the 303(d) list and has a total phosphorus limit requirement of 0.5 mg/L for discharges.

OUTFALL	DESIGN FLOW (CFS)	TREATMENT LEVEL	RECEIVING WATERBODY	DISTANCE TO CLASSIFIED SEGMENT (MI)
001	0.10	Tertiary	Tributary to Table Rock Lake	0.05
			Table Rock Lake	0.0

3. Receiving Waterbody Information

WATERBODY NAME	CLASS	WBID	LOW-FLOW VALUES (CFS)			DESIGNATED USES**
			1Q10	7Q10	30Q10	
Tributary to Table Rock Lake	-	-	-	-	-	General Criteria
Table Rock Lake	L2	7313	-	-	-	AQL, WBC(A), SCR, HHP, IRR, LWW

** Irrigation (IRR), Livestock & Wildlife Protection (LWP), Protection of Warm Water Aquatic Life (AQL), Human Health Protection (HHP), Cool Water Fishery (CLF), Cold Water Fishery (CDF), Whole Body Contact Recreation – Category A (WBC-A), Whole Body Contact Recreation – Category B (WBC-B), Secondary Contact Recreation (SCR), Drinking Water Supply (DWS), Industrial (IND), Groundwater (GRW).

RECEIVING WATER BODY SEGMENT #1: Tributary to Table Rock Lake

Upper end segment* UTM coordinates: X= 444314 / Y= 4049649 (Outfall)

Lower end segment* UTM coordinates: X= 444314 / Y= 4049725 (Confluence with Table Rock Lake)

*Segment is the portion of the stream where discharge occurs. Segment is used to track changes in assimilative capacity and is bound at a minimum by existing sources and confluences with other significant water bodies.

4. General Comments

Wayne Diebold with Rozell Engineering Company, prepared, on behalf of Kids Across America, the Antidegradation Review Request received May 26, 2020.

Applicant elected to determine that discharge of all pollutants of concern (POC) is non-degrading or insignificant to the receiving stream. This analysis was conducted to fulfill the requirements of the AIP. Information that was provided by the applicant in the submitted report and summary forms in Appendix B was used to develop this review document.

A Geohydrologic Evaluation was not submitted for this facility upgrade. The stream is gaining for discharge purposes (Appendix A: Map).

A Missouri Department of Conservation Natural Heritage Review Report was obtained by the applicant. The results of the Natural Heritage Review can be found in Appendix C.

5. Antidegradation Review Information

The following is a review of the *Kids Across America Antidegradation Review* dated April 29, 2020.

5.1. TIER DETERMINATION

Below is a list of pollutants of concern reasonably expected to be in the discharge (see Appendix B). Pollutants of concern are defined as those pollutants “proposed for discharge that affects beneficial use(s) in waters of the state. POCs include pollutants that create conditions unfavorable to beneficial uses in the water body receiving the discharge or proposed to receive the discharge.” (AIP, Page 7). Tier 2 is assumed for all POCs; however, tier determinations were not necessary with maintenance of mass loading determinations (see Appendix B).

Table 1. Pollutants of Concern and Tier Determination

POLLUTANTS OF CONCERN	TIER*	DEGRADATION	COMMENT
BOD ₅ /DO	*	Insignificant	
Total Suspended Solids (TSS)	**	Insignificant	
Ammonia as N	*	Insignificant	
pH	***	Insignificant	Permit limits applied
<i>Escherichia coli</i> (<i>E. coli</i>)	*	Insignificant	Permit limits applied
Total Phosphorus	1	Insignificant	
Aluminum, Total Recoverable	*	Insignificant	
Oil and Grease	*	Insignificant	

*Tier determination not possible with the demonstration of mass loading maintenance. **Tier determination not possible: No in-stream standards for these parameters. *** Standards for these parameters are ranges.

The following Antidegradation Review Summary attachments in Appendix B were used by the applicant:

For pollutants of concern, the attachments are:

☒ Path A, Tier 2: Non-degrading.

5.2. EXISTING WATER QUALITY

No existing water quality data was submitted. The following is a list of dischargers who have point sources that flow into the same waterbody:

Permit	Facility Name	UTMs	Design flow/Actual Flow
MO-0123285	Kids Across America Foundation	444314/4049649	48,952/37,000
MO-0117803	Kids Across America Kamp I	444104/4049305	17,500/11,136

The total flow into the waterbody segment prior to the combining of the two flows and expansion of MO-0123285 is 66,452 gpd. With the proposed upgrades and rerouting of wastewater flows at the Kids Across America Camp, the total flows to the lake will remain the same and no new pollutants will be added.

5.3. NO DISCHARGE EVALUATION

According to 10 CSR 20-6.010 (4)(A)5.B., reports for the purpose of constructing a wastewater treatment facility shall consider the feasibility of constructing and operating a no discharge facility. Missouri's antidegradation implementation procedures specify that if the proposed activity does not result in significant degradation then a demonstration of necessity (i.e., alternatives analysis) and a determination of social and economic importance are not required. For this reason, the no discharge evaluation should be completed during the submittal of engineering report or facility plan for the purpose of obtaining a construction permit.

The proposed project is an effort to regionalize two existing independently permitted facilities into a single facility. The receiving waterbody will not receive any new flows beyond what has already been permitted. No new pollutants will be introduced through this regionalization activity. Due to these reasons the project is considered to be non-degrading for this review.

5.4. LOSING STREAM ALTERNATIVE DISCHARGE LOCATION

Under 10 CSR 20-7.015(4) (A), *discharges to losing stream shall be permitted only after other alternatives including land application, discharge to gaining stream and connection to a regional facility have been evaluated and determined to be unacceptable for environmental and/or economic reasons.*

The facility does not discharge to a losing stream segment or will not discharge within two miles of a losing stream segment.

5.5. DEMONSTRATION OF INSIGNIFICANCE

In Section II.A of the *Missouri's Antidegradation Rule and Implementation Procedure*, a demonstration of insignificance of the discharge requires the applicant to show a reduction, or maintenance of loading, i.e., no change in ambient water quality concentrations in the receiving waters. As demonstrated in the *Antidegradation Review Application* received May 26, 2020, Table 2 below summarizes the results of current loading based on the current permit concentrations and proposed loadings based on the proposed permit concentrations.

Table 2. Net Change in Loadings Based upon Current and Proposed Permit Limits.

POLLUTANTS OF CONCERN	CURRENT WEEKLY/MONTHLY/ DAILY AVG. OR MAX. LIMITS (MG/L)	PROPOSED LIMITS (MG/L)	CURRENT LOADING (LBS/DAY)	PROPOSED LOADING (LBS/DAY)	NET CHANGE (LBS/DAY)
BOD5	30 (AWL) / 20 (AML)	30 (AWL) / 20 (AML)	16.6/11.1	16.6/11.1	0
Total Suspended Solids (TSS)	30 (AWL) / 20 (AML)	30 (AWL) / 20 (AML)	16.6/11.1	16.6/11.1	0
pH	6.5-9.0 SI units	6.5-9.0 SI units	Not applicable**	Not applicable	Not applicable
Ammonia (Summer&Winter)	S: 12.1/4.0 W: 12.1/4.6	12.1/4.0 12.1/4.6	6.7/2.2 6.7/2.5	6.7/2.2 6.7/2.5	0.0
<i>Escherichia coli</i> (<i>E. coli</i>)	Regulatory limits apply	Regulatory limits apply	Not applicable**	Not applicable	Not applicable
Aluminum, Total Recoverable	*/*	*/*	Not applicable**	Not applicable	Not applicable
Total Phosphorus	0.5 (AML)	0.5 (AML)	0.28	0.28	0.0

*WQBEL=water quality based effluent limit. **See Derivation and Discussion of Limits, Section 10. AWL = average weekly limit.

Current design flow (Qd) = 0.066452 MGD

Mass conversion -- 1 mg/L = 8.34 lbs/million gallons

Wasteload Allocation (WLA) = maximum daily or weekly average

Existing Load (lbs/day) = Mass conversion * WLA * Qd

Example: 8.34 (lbs/Mil Gallons)/(mg/L) * 30 mg/L * 0.066452 MGD = 16.6 lbs/day

5.6. DEMONSTRATION OF NECESSITY AND SOCIAL AND ECONOMIC IMPORTANCE

Missouri's antidegradation implementation procedures specify that if the proposed activity does not result in significant degradation then a demonstration of necessity (i.e., alternatives analysis) and a determination of social and economic importance are not required. Thus, the Tier 2 Review is not required.

6. General Assumptions of the Water Quality and Antidegradation Review

1. A Water Quality and Antidegradation Review (WQAR) assumes that [10 CSR 20-6.010(2) Continuing Authorities and 10 CSR 20-6.010(4)(A)5.B., consideration for no discharge] has been or will be addressed in a Missouri State Operating Permit or Construction Permit Application.
2. A WQAR does not indicate approval or disapproval of alternative analysis as per [10 CSR 20-7.015(4) Losing Streams], and/or any section of the effluent regulations.
3. Changes to Federal and State Regulations made after the drafting of this WQAR may alter Water Quality Based Effluent Limits (WQBEL).
4. Effluent limitations derived from Federal or Missouri State Regulations (FSR) may be WQBEL or Effluent Limit Guidelines (ELG).
5. WQBEL supersede ELG only when they are more stringent. Mass limits derived from technology based limits are still appropriate.
6. A WQAR does not allow discharges to waters of the state, and shall not be construed as a National Pollution Discharge Elimination System or Missouri State Operating Permit to discharge or a permit to construct, modify, or upgrade.
7. Limitations and other requirements in a WQAR may change as Water Quality Standards, Methodology, and Implementation procedures change.
8. Nothing in this WQAR removes any obligations to comply with county or other local ordinances or restrictions.
9. If the proposed treatment technology is not covered in 10 CSR 20-8 Design Guides, the treatment process may be considered a new technology. As a new technology, the permittee will need to work with the review engineer to ensure equipment is sized properly. The operating permit may contain additional requirements to evaluate the effectiveness of the technology once the facility is in operation. This Antidegradation Review is based on the information provided by the facility and is not a comprehensive review of the proposed treatment technology. If the review engineer determines the proposed technology will not consistently meet proposed effluent limits, the permittee will be required to revise their Antidegradation Report.

7. Mixing Considerations

Zone of Initial Dilution: Not Allowed [10 CSR 20-7.031(5)(A)4.B.(IV)(b)].

Mixing Zone:

Mixing Zone (MZ) Parameters: According to the USGS 1:24,000K Quadrangle, the main stem lake width near the existing facility outfall location is approximately 1678 feet (ft). Using "normal" water levels of 1687 ft wide and one-quarter of this width equals 419.5 ft. Therefore, because 100 ft is less than 419.5 ft, MZ = 100 ft [10 CSR 20-7.031(5)(A)4.B.(IV)(a)].

Mixing Zone Volume: The flow volume approximates a triangular prism because of the slope of the lake bottom, where the formula is $\text{Volume} = L * W * (D * 0.5)$. Assuming that the width will be either side of the discharge (MZ) length (100 ft) to form the plume effect, the box dimensions are length (L) = 100 ft, width (W) = 100 ft, and depth (D) = 20 ft. Depth was obtained using mixing zone length projected 100 ft.

$$\text{Volume} = L * W * (D * 0.5) = (100') * (100') * (20' * 0.5) = 100,000 \text{ ft}^3.$$

The flow volume of 100,000 ft³ is assumed as the daily mixing zone. Therefore;
 $(100,000 \text{ ft}^3/\text{day}) * (1 \text{ day}/86,400 \text{ sec}) = 1.16 \text{ ft}^3/\text{sec}.$

8. Permit Limits and Monitoring Information

WASTELOAD ALLOCATION
STUDY CONDUCTED (Y OR N):

N

USE ATTAINABILITY
ANALYSIS CONDUCTED (Y OR N):

Y

WHOLE BODY CONTACT
USE RETAINED (Y OR N):

Y

OUTFALL #001

TABLE 3. EFFLUENT LIMITS FOR OUTFALL #001

PARAMETER	UNITS	DAILY MAXIMUM	WEEKLY AVERAGE	MONTHLY AVERAGE	BASIS FOR LIMIT (NOTE 2)	MONITORING FREQUENCY
FLOW	MGD	*		*		once/quarter
BOD ₅	MG/L		30	20	NDEL	once/quarter
TSS	MG/L		30	20	NDEL	once/quarter
pH	SU	6.5 – 9.0		6.5 – 9.0	FSR	once/quarter
AMMONIA AS N (APRIL 1 – SEPT 30)	MG/L	12.1		4.0	NDEL	once/quarter
AMMONIA AS N (OCT 1 – MAR 31)	MG/L	12.1		4.6	NDEL	once/quarter
OIL & GREASE	MG/L	15		10	FSR	Once/quarter
<i>ESCHERICHIA COLIFORM (E. COLI)</i>	NOTE 1	630**		126**	FSR	once/quarter
ALUMINUM, TOTAL RECOVERABLE	µG/L	*		*	FSR	Once/quarter
TOTAL PHOSPHORUS	MG/L			0.5	FSR	ONCE/QUARTER

NOTE 1 – COLONIES/100 mL

NOTE 2 – WATER QUALITY-BASED EFFLUENT LIMITATION – WQBEL; OR MINIMALLY DEGRADING EFFLUENT LIMIT – MDEL; OR PREFERRED ALTERNATIVE EFFLUENT LIMIT – PEL; OR TECHNOLOGY-BASED EFFLUENT LIMIT – TBEL; OR NO DEGRADATION EFFLUENT LIMIT – NDEL; OR FEDERAL/STATE REGULATION – FSR; OR NOT APPLICABLE – N/A. ALSO, PLEASE SEE THE **GENERAL ASSUMPTIONS OF THE WQAR #4 & #5**.

* Monitoring requirements only.

** The Monthly and Weekly Average for *E. coli* shall be reported as a Geometric Mean. The Weekly Average for *E. coli* will be expressed as a geometric mean if more than one sample is collected during a calendar week (Sunday through Saturday). Publicly owned treatment works will receive a weekly average *E. coli* limit and private facilities will receive a daily maximum *E. coli* limit.

9. Receiving Water Monitoring Requirements

No receiving water monitoring requirements recommended at this time.

10. Derivation and Discussion of Limits

Wasteload allocations and limits were calculated using two methods:

1) Water quality-based – Using water quality criteria or water quality model results and the dilution equation below:

$$C = \frac{(C_s \times Q_s) + (C_e \times Q_e)}{(Q_e + Q_s)} \quad (\text{EPA/505/2-90-001, Section 4.5.5})$$

Where: C = downstream concentration

Cs = upstream concentration

Qs = upstream flow

Ce = effluent concentration

Qe = effluent flow

Chronic wasteload allocations were determined using applicable chronic water quality criteria (CCC: criteria continuous concentration) and stream volume of flow at the edge of the mixing zone (MZ). Acute wasteload allocations were determined using applicable water quality criteria (CMC: criteria maximum concentration) and stream volume of flow at the edge of the zone of initial dilution (ZID).

Water quality-based maximum daily and average monthly effluent limitations were calculated using methods and procedures outlined in USEPA's "Technical Support Document For Water Quality-based Toxics Control" (EPA/505/2-90-001).

Chronic wasteload allocations (WLA_c) were determined using applicable chronic water quality criteria (CCC: criteria continuous concentration) and upstream stream flow without mixing considerations. Acute wasteload allocations are only determined in the absence of applicable chronic criteria.

10.1. OUTFALL #001 – MAIN FACILITY OUTFALL

10.2. LIMIT DERIVATION

- **Flow.** In accordance with [40 CFR Part 122.44(i)(1)(ii)] the volume of effluent discharged from each outfall is needed to assure compliance with permitted effluent limitations. If the permittee is unable to obtain effluent flow, then it is the responsibility of the permittee to inform the Department, which may require the submittal of an operating permit modification.
- **Biochemical Oxygen Demand (BOD₅).** BOD₅ limits of 20 mg/L monthly average, 30 mg/L average weekly. The technology-based secondary limitations at 10 CSR 20-7.015 (3) of 20 mg/L monthly and 30 mg/L average weekly are protective of water quality standards and are appropriate non-degrading limits as shown in the table below. The table below shows that the loading to the waterbody segment will be maintained as no new pollutants or wastewater flows will be discharging to the segment as a result of the proposed regionalization project. This demonstration of insignificance satisfies the requirements of the AIP. These limitations are non-degrading and protective of existing water quality.

Parameter	Limit	WLA (mg/L)	(LBS/MG)/(mg/L)	Current Qd (MGD)	Current Load (lbs/day)	New Qd (MGD)	Non-degrading limit (mg/L)	New load	Loading Change
BOD	Monthly	20	8.34	0.066452	11.1	0.066452	20	11.1	0.0
	Weekly	30	8.34	0.066452	16.6	0.066452	30	16.6	0.0

Influent monitoring may be required for this facility in its Missouri State Operating Permit.

- **Total Suspended Solids (TSS).** 20 mg/L monthly average, 30 mg/L average weekly limit. The technology-based secondary limitations at 10 CSR 20-7.015 (3) of 20 mg/L monthly and 30 mg/L average weekly are protective of water quality standards and are appropriate non-degrading limits as shown in the table below. The table below shows that the loading to the waterbody segment will be maintained as no new pollutants or wastewater flows will be discharging to the segment as a result of the proposed regionalization project. This demonstration of insignificance satisfies the requirements of the AIP. These limitations are non-degrading and protective of existing water quality.

Parameter	Limit	WLA (mg/L)	(LBS/MG)/(mg/L)	Current Qd (MGD)	Current Load (lbs/day)	New Qd (MGD)	Non-degrading limit (mg/L)	New load	Loading Change
TSS	Monthly	20	8.34	0.066452	11.1	0.066452	20	11.1	0.0
	Weekly	30	8.34	0.066452	16.6	0.066452	30	16.6	0.0

Influent monitoring may be required for this facility in its Missouri State Operating Permit.

- **pH.** – 6.5-9.0 SU. Technology based limits [10 CSR 20-7.015] are protective of the water quality standard [10 CSR 20-7.015(3)(A)1.B.], due to the buffering capacity of the mixing zone.
- **Total Ammonia Nitrogen.** Early Life Stages Present Total Ammonia Nitrogen criteria apply [10 CSR 20-7.031(5)(B)7.C. & Table B3]. Background total ammonia nitrogen = 0.01 mg/L

Season	Temp (°C)	pH (SU)	Total Ammonia Nitrogen CCC (mg N/L)	Total Ammonia Nitrogen CMC (mg N/L)
Summer	26	7.8	1.5	12.1
Winter	6	7.8	3.1	12.1

Summer: April 1 – September 30, Winter: October 1 – March 31.

The Department calculated the following water quality-based limitations (WQBEL) to be protective of water quality standards for the expanded discharge design flow. The table below shows the maximum daily and average monthly limitations for winter and summer.

Summer:

$$C_e = (((Q_e + Q_s) * C) - (Q_s * C_s)) / Q_e$$

$$\begin{aligned} \text{Chronic WLA: } C_e &= ((0.076 + 1.16)1.5 - (1.16 * 0.01)) / 0.076 \\ C_e &= 24.24 \text{ mg/L} \end{aligned}$$

$$\begin{aligned} \text{Acute WLA: } C_e &= ((0.076 + 0.0)12.1 - (0.0 * 0.01)) / 0.076 \\ C_e &= 12.1 \text{ mg/L} \end{aligned}$$

$$LTA_c = 24.24 \text{ mg/L} (0.737) = 17.85 \text{ mg/L}$$

$$[CV = 0.74, 99^{\text{th}} \text{ Percentile, 30 day avg.}]$$

$$LTA_a = 12.1 \text{ mg/L } (0.266) = \mathbf{3.22 \text{ mg/L}} \quad [CV = 0.74, 99^{\text{th}} \text{ Percentile}]$$

$$MDL = 3.22 \text{ mg/L } (3.76) = 12.1 \text{ mg/L} \quad [CV = 0.74, 99^{\text{th}} \text{ Percentile}]$$

$$AML = 3.22 \text{ mg/L } (1.24) = 4.0 \text{ mg/L} \quad [CV = 0.74, 95^{\text{th}} \text{ Percentile, } n = 30]$$

Winter:

$$\text{Chronic WLA: } C_e = ((0.076 + 1.16)3.1 - (1.16 * 0.01))/0.076$$

$$C_e = 50.23 \text{ mg/L}$$

$$\text{Acute WLA: } C_e = ((0.076 + 0.0)12.1 - (0.0 * 0.01))/0.076$$

$$C_e = 12.1 \text{ mg/L}$$

$$LTA_c = 50.23 \text{ mg/L } (0.780) = 39.20 \text{ mg/L} \quad [CV = 0.6, 99^{\text{th}} \text{ Percentile, 30 day avg.}]$$

$$LTA_a = 12.1 \text{ mg/L } (0.321) = \mathbf{3.89 \text{ mg/L}} \quad [CV = 0.6, 99^{\text{th}} \text{ Percentile}]$$

$$MDL = 3.89 \text{ mg/L } (3.11) = 12.1 \text{ mg/L} \quad [CV = 0.6, 99^{\text{th}} \text{ Percentile}]$$

$$AML = 3.89 \text{ mg/L } (1.19) = 4.6 \text{ mg/L} \quad [CV = 0.6, 95^{\text{th}} \text{ Percentile, } n = 30]$$

Water Quality Based Effluent Limits

Season	Maximum Daily Limit (mg/l)	Average Monthly Limit (mg/l)
Summer	12.1	4.0
Winter	12.1	4.6

Non-Degrading Effluent Limits.

Parameter	Limit	Current Limit (mg/L)	(LBS/MG)/(mg/L)	Current Qd (MGD)	Current Load (lbs/day)	New Qd (MGD)	Non-degrading limit (mg/L)	New load	Loading Change
Ammonia	Monthly	4.0	8.34	0.066452	2.2	0.066452	4.0	2.2	0.0
Summer	Daily	12.1	8.34	0.066452	6.7	0.066452	12.1	6.7	0.0

Parameter	Limit	Current Limit (mg/L)	(LBS/MG)/(mg/L)	Current Qd (MGD)	Current Load (lbs/day)	New Qd (MGD)	Non-degrading limit (mg/L)	New load	Loading Change
Ammonia	Monthly	4.6	8.34	0.066452	2.5	0.066452	4.6	2.5	0.0
Winter	Weekly	12.1	8.34	0.066452	6.7	0.066452	12.1	6.7	0.0

- **Escherichia coli (E. coli).** Monthly average of 126 per 100 mL as a geometric mean and Daily Maximum of 630 during the recreational season (April 1 – October 31), to protect Whole Body Contact Recreation (A) designated use of the receiving stream, as per 10 CSR 20-7.031(5)(C). An effluent limit for both monthly average and daily maximum is required by 40 CFR 122.45(d).

For facilities less than 100,000 gpd: Per the effluent regulations the *E. coli* sampling/monitoring frequency shall be set to match the monitoring frequency of wastewater and sludge sampling program for the receiving water category in 7.015(1)(B)3. during the recreational season (April 1 – October 31), with compliance to be determined by calculating the geometric mean of all samples collected during the reporting period (samples collected during the calendar week for the weekly average, and samples collected during the calendar month for the monthly average). The weekly average requirement is consistent with EPA federal regulation 40 CFR 122.45(d). Please see **GENERAL ASSUMPTIONS OF THE WQAR #7**

- **Oil & Grease.** Conventional pollutant, [10 CSR 20-7.031, Table A1]. Effluent limitation for protection of aquatic life; 10 mg/L monthly average, 15 mg/L daily maximum.
- **Total Phosphorus.** To Table Rock Lake and Lake Taneycomo, 0.5 mg/L per 10 CSR 20-7.015 (3).

Parameter	Limit	Current Limit (mg/L)	(LBS/MG)/(mg/L)	Current Qd (MGD)	Current Load (lbs/day)	New Qd (MGD)	Non-degrading limit (mg/L)	New load	Loading Change
Phosphorus	Monthly	0.5	8.34	0.066452	0.3	0.066452	0.5	0.3	0.0

Aluminum, Total Recoverable. Monitoring requirement only. This facility uses chemicals for phosphorous removal that may contain aluminum. Monitoring is required to determine if reasonable potential exists for this facility's discharge to exceed water quality standards for Aluminum (Total Recoverable).

11. ANTIDEGRADATION REVIEW PRELIMINARY DETERMINATION

The proposed facility discharge will result in no degradation of the segment identified in Table Rock Lake. Per the requirements of the AIP, the effluent limits in this review were developed to be protective of beneficial uses and to retain the remaining assimilative capacity. The Department has determined that the submitted review is sufficient and meets the requirements of the AIP. No further analysis is needed for this discharge.

Reviewer: Aaron Sawyer

Date: 6/25/2020

Unit Chief: John Rustige, P.E.

Appendix A: Map of Discharge Location Outfall #001.



Appendix B: Antidegradation Review Summary Attachments

1) Antidegradation Review Summary/Request

		MISSOURI DEPARTMENT OF NATURAL RESOURCES WATER PROTECTION PROGRAM, WATER POLLUTION CONTROL BRANCH ANTIDEGRADATION REVIEW SUMMARY / REQUEST		FOR DEPARTMENT USE ONLY	
				APP NO.	
				FEE RECEIVED	CHECK NO.
				DATE RECEIVED	
1. FACILITY					
NAME KIDS ACROSS AMERICA FOUNDATION				COUNTY BARRY	
ADDRESS (PHYSICAL) 26272 PRIVATE ROAD 2232		CITY GOLDEN		STATE MO	ZIP CODE 65658
PERMIT NUMBER MO-0123285		PROPOSED DESIGN FLOW 66,452 GPD		SIC / NAICS CODE 7032	
2. OWNER					
NAME KIDS ACROSS AMERICA FOUNDATION					
ADDRESS 2036 TIMBERLAKE ROAD		CITY BRANSON		STATE MO	ZIP CODE 65616
EMAIL ADDRESS lccallen@kaakamps.org		TELEPHONE NUMBER WITH AREA CODE 417-266-4000			
3. CONTINUING AUTHORITY The regulatory requirement regarding continuing authority is found in 10 CSR 20-6.010(2).					
NAME KIDS ACROSS AMERICA FOUNDATION		SECRETARY OF STATE CHARTER NUMBER N00033786			
ADDRESS 2036 TIMBERLAKE ROAD		CITY BRANSON		STATE MO	ZIP CODE 65616
EMAIL ADDRESS lccallen@kaakamps.org		TELEPHONE NUMBER WITH AREA CODE 417-266-4000			
4. CONSULTANT					
PREPARER NAME WAYNE DIEBOLD		COMPANY NAME ROZELL ENGINEERING COMPANY			
ADDRESS 2404 STATE HWY 248, SUITE 4		CITY BRANSON		STATE MO	ZIP CODE 65616
EMAIL ADDRESS wdiebold@rozellgroup.net		TELEPHONE NUMBER WITH AREA CODE 417-334-4141			
5. RECEIVING WATER BODY SEGMENT #1					
NAME TABLE ROCK LAKE					
5.1 Upper end of segment – Location of discharge UTM: X= 444314, Y= 4049649 OR Lat _____, Long _____					
5.2 Lower end of segment – UTM: X= _____, Y= _____ OR Lat _____, Long _____					
Per the Missouri Antidegradation Implementation Procedure (AIP), the definition of a segment, "a segment is a section of water that is bound, at a minimum, by significant existing sources and confluences with other significant water bodies."					
6. WATER BODY SEGMENT #2 (IF APPLICABLE, Use another form if a third segment is needed)					
NAME					
6.1 Upper end of segment – End of Segment #1 UTM: X= _____, Y= _____ OR Lat _____, Long _____					
6.2 Lower end of segment – UTM: X= _____, Y= _____ OR Lat _____, Long _____					
7. DECHLORINATION					
If chlorination and dechlorination is the existing or proposed method of disinfection treatment, will the effluent discharged be equal to or less than the Water Quality Standards for Total Residual Chlorine stated in Table A1 of 10 CSR 20-7.031?					
<input type="checkbox"/> Yes <input checked="" type="checkbox"/> No – What is the proposed method of disinfection? ULTRA-VIOLET DISINFECTION					
Based on the disinfection treatment system being designed for total removal of Total Residual Chlorine, minimal degradation for Total Residual Chlorine is assumed and the facility will be required to meet the water quality based effluent limits. These compliance limits for Total Residual Chlorine are much less than the method detection limit of 0.13 mg/L.					

8. SUMMARIZE THE FEASIBILITY OF CONSTRUCTING A NO-DISCHARGE TREATMENT WASTEWATER FACILITY

According to the Antidegradation Implementation Procedure Sections I.B. and II.B.1., the feasibility of no-discharge alternatives must be considered. No-discharge alternatives may include connection to a regional treatment facility, surface land application, subsurface land application, and recycle or reuse.

A no-discharge system would not be feasible at this site. There are already two discharging facilities that serve the camps which we are wanting to combine into one. There would not be enough suitable land available for surface or subsurface application. There are no regional systems anywhere close to this site that could be connected to. So far as recycle or reuse of the effluent is concerned, these camps serve kids throughout the summer that use the open areas on a daily basis and it would be almost impossible to keep them out of any area where treated effluent would be applied.

9. ADDITIONAL REQUIREMENTS

Complete and submit the following with this submittal:

- ☐ Copy of the Geohydrologic Evaluation – Submit request through the Missouri Geological Survey website
- ☐ Copy of the Missouri Natural Heritage from the Missouri Department of Conservation website
- ☐ Attach your Antidegradation Review Report and all supporting documentation as these forms are only a summary.
- ☐ If applicable, submit a copy of any Existing Water Quality data used in this process. Include the date range of the data, source(s) of the data, and location of data collection relative to the outfall. If using your own collected water quality data, submit a copy of the Quality Assurance Project Plan (QAPP) approved by the department's Watershed Protection Section. For more detailed information, see the Missouri Antidegradation Implementation Procedure (AIP), Section II.A.1.

10. PATH / TIER REVIEW ATTACHMENTS ENCLOSED

Path A: Tier 2 – Non-Degradation Mass Balance	<input type="checkbox"/> Yes	<input type="checkbox"/> No
Path B: Tier 2 – Minimal Degradation	<input type="checkbox"/> Yes	<input type="checkbox"/> No
Path C: Tier 2 – Significant Degradation	<input type="checkbox"/> Yes	<input type="checkbox"/> No
Path D: Tier 1 – Preliminary Review Request	<input type="checkbox"/> Yes	<input type="checkbox"/> No
Path E: Temporary Degradation	<input type="checkbox"/> Yes	<input type="checkbox"/> No

11. APPLICANT PROPOSED ANTIDEGRADATION REVIEW EFFLUENT LIMITS

Preliminary effluent limits for the proposed project are dependent upon the path selected.

[illegible]

* Place an X in appropriate box for the concentration units for each Pollutant of Concern.

12. PROPOSED PROJECT SUMMARY	
<p>Kids Across America is proposing to continue to use the existing 22,000 gallon septic tank at the Kamp I facility but pump the discharge from it into the nearby gravity sewer main and let it flow down to the Kamp II facility. The Kamp II facility would be upgraded to accept the additional flow with an additional filter bed, recirc. tank capacity, disinfection, etc. The Kamp I facility would be shut down and the Operating Permit MO-0117803 would be terminated. This would leave them with one discharge and only one facility to operate. The overall flow from the site would not change as the design flow of 17,500 gpd for MO-0117803 would be added to the design flow of 48,952 gpd for Operating Permit MO-0123285 leaving the overall design flow for the entire development at 66,452 gpd.</p>	
<p>Applicants choosing to use a new wastewater technology that are considered an "unproven technology" in Missouri must comply with the requirements set forth in the <i>New Technology Definitions and Requirements fact sheet</i>.</p>	
13. CONTINUING AUTHORITY WAIVER (For New Discharges)	
<p>In accordance with 10 CSR 20-6.010(2)(C), applicants proposing use of a lower preference continuing authority, when the higher level authority is available, must submit a waiver from the existing higher authority one or other documentation for the department's review, provided it does not conflict with any area-wide management plan approved under section 208 of the Federal Clean Water Act or by the Missouri Clean Water Commission. Is the waiver necessary? <input type="checkbox"/> Yes <input checked="" type="checkbox"/> No</p> <p>If yes, provide a copy.</p>	
14. APPLICATION FEE	
<p><input type="checkbox"/> CHECK NUMBER <input type="checkbox"/> JETPAY CONFIRMATION NUMBER</p>	
15. SIGNATURE	
<p>I am authorized and hereby certify that I am familiar with the information contained in this document and to the best of my knowledge and belief such information is true, complete and accurate.</p>	
<p>SIGNATURE </p>	<p>DATE 5-26-2020</p>
<p>PRINT NAME WAYNE DIEBOLD</p>	<p>TITLE PRESIDENT</p>
<p>PLEASE IDENTIFY YOUR STATUS FOR THIS PROJECT: <input type="checkbox"/> OWNER <input type="checkbox"/> CONTINUING AUTHORITY <input checked="" type="checkbox"/> CONSULTANT</p>	

[illegible]

12. PROPOSED PROJECT SUMMARY	
<p>Kids Across America is proposing to continue to use the existing 22,000 gallon septic tank at the Kamp I facility but pump the discharge from it into the nearby gravity sewer main and let it flow down to the Kamp II facility. The Kamp II facility would be upgraded to accept the additional flow with an additional filter bed, recirc. tank capacity, disinfection, etc. The Kamp I facility would be shut down and the Operating Permit MO-0117803 would be terminated. This would leave them with one discharge and only one facility to operate. The overall flow from the site would not change as the design flow of 17,500 gpd for MO-0117803 would be added to the design flow of 48,952 gpd for Operating Permit MO-0123285 leaving the overall design flow for the entire development at 66,452 gpd.</p>	
<p>Applicants choosing to use a new wastewater technology that are considered an "unproven technology" in Missouri must comply with the requirements set forth in the <i>New Technology Definitions and Requirements fact sheet</i>.</p>	
13. CONTINUING AUTHORITY WAIVER (For New Discharges)	
<p>In accordance with 10 CSR 20-6.010(2)(C), applicants proposing use of a lower preference continuing authority, when the higher level authority is available, must submit a waiver from the existing higher authority one or other documentation for the department's review, provided it does not conflict with any area-wide management plan approved under section 208 of the Federal Clean Water Act or by the Missouri Clean Water Commission. Is the waiver necessary? <input type="checkbox"/> Yes <input checked="" type="checkbox"/> No</p> <p>If yes, provide a copy.</p>	
14. APPLICATION FEE	
<p><input type="checkbox"/> CHECK NUMBER <input type="checkbox"/> JETPAY CONFIRMATION NUMBER</p>	
15. SIGNATURE	
<p>I am authorized and hereby certify that I am familiar with the information contained in this document and to the best of my knowledge and belief such information is true, complete and accurate.</p>	
<p>SIGNATURE </p>	<p>DATE 5-26-2020</p>
<p>PRINT NAME WAYNE DIEBOLD</p>	<p>TITLE PRESIDENT</p>
<p>PLEASE IDENTIFY YOUR STATUS FOR THIS PROJECT: <input type="checkbox"/> OWNER <input type="checkbox"/> CONTINUING AUTHORITY <input checked="" type="checkbox"/> CONSULTANT</p>	

[illegible]

3. PROPOSED PROJECT SUMMARY

Kids Across America is proposing to continue to use the existing 22,000 gallon septic tank at the Kamp I facility but pump the discharge from it into the nearby gravity sewer main and let it flow down to the Kamp II facility. The Kamp II facility would be upgraded to accept the additional flow with an additional filter bed, recirc. tank capacity, disinfection, etc. The Kamp I facility would be shut down and the Operating Permit MO-0117803 would be terminated. This would leave them with one discharge and only one facility to operate. The overall flow from the site would not change as the design flow of 17,500 gpd for MO-0117803 would be added to the design flow of 48,952 gpd for Operating Permit MO-0123285 leaving the overall design flow for the entire development at 66,452 gpd.



Missouri Department of Conservation

Missouri Department of Conservation's Mission is to protect and manage the forest, fish, and wildlife resources of the state and to facilitate and provide opportunities for all citizens to use, enjoy and learn about these resources.

Natural Heritage Review Level Three Report: Species Listed Under the Federal Endangered Species Act

There are records for species listed under the Federal Endangered Species Act, and possibly also records for species listed Endangered by the state, or Missouri Species and/or Natural Communities of Conservation Concern within or near the the defined Project Area. Please contact the U.S. Fish and Wildlife Service and the Missouri Department of Conservation for further coordination.

Foreword: Thank you for accessing the Missouri Natural Heritage Review Website developed by the Missouri Department of Conservation with assistance from the U.S. Fish and Wildlife Service, the U.S. Army Corps of Engineers, Missouri Department of Transportation and NatureServe. The purpose of this website is to provide information to federal, state and local agencies, organizations, municipalities, corporations and consultants regarding sensitive fish, wildlife, plants, natural communities and habitats to assist in planning, designing and permitting stages of projects.

PROJECT INFORMATION

Project Name and ID Number: Kids Across America Foundation Wastewater Facility Upgrade #7524

Project Description: Expansion of existing wastewater treatment facility located at T22N,R25W,Sec 27, 36.590200E,-93.622340N, Tributary to Table Rock Lake in Barry County.

Project Type: Waste Transfer, Treatment, and Disposal, Liquid waste/Effluent, Wastewater treatment plant, Construction or expansion

Contact Person: Wayne Diebold

Contact Information: wdiebold@rozellgroup.net or 417-334-4141

Disclaimer: The NATURAL HERITAGE REVIEW REPORT produced by this website identifies if a species tracked by the Natural Heritage Program is known to occur within or near the area submitted for your project, and shares suggested recommendations on ways to avoid or minimize project impacts to sensitive species or special habitats. If an occurrence record is present, or the proposed project might affect federally listed species, the user must contact the Department of Conservation or U.S. Fish and Wildlife Service for more information. The Natural Heritage Program tracks occurrences of sensitive species and natural communities where the species or natural community has been found. Lack of an occurrence record does not mean that a sensitive plant, animal or natural community is not present on or near the project area. Depending on the project, current habitat conditions, and geographic location in the state, surveys may be necessary. Additionally, because land use conditions change and animals move, the existence of an occurrence record does not mean the species/habitat is still present. Therefore, Reports include information about records near but not necessarily on the project site.

The Natural Heritage Report is not a site clearance letter for the project. It provides an indication of whether or not public lands and sensitive resources are known to be (or are likely to be) located close to the proposed project. Incorporating information from the Natural Heritage Program into project plans is an important step that can help reduce unnecessary impacts to Missouri's sensitive fish, forest and wildlife resources. However, the Natural Heritage Program is only one reference that should be used to evaluate potential adverse project impacts. Other types of information, such as wetland and soils maps and on-site inspections or surveys, should be considered. Reviewing current landscape and habitat information, and species' biological characteristics would additionally ensure that Missouri Species of Conservation Concern are appropriately identified and addressed in planning efforts.

U.S. Fish and Wildlife Service – Endangered Species Act (ESA) Coordination: Lack of a Natural Heritage Program occurrence record for federally listed species in your project area does not mean the species is not present, as the area may never have been surveyed. Presence of a Natural Heritage Program occurrence record does not mean the project will result in negative impacts. The information within this report is not intended to replace Endangered Species Act consultation with the U.S. Fish and Wildlife Service (USFWS) for listed species. Direct contact with the USFWS may be necessary to complete consultation and it is required for actions with a federal connection, such as federal funding or a federal permit; direct contact is also required if ESA concurrence is necessary. Visit the USFWS Information for Planning and Conservation (IPaC) website at <https://ecos.fws.gov/ipac/> for further information. This site was developed to help streamline the USFWS environmental review process and is a first step in ESA coordination. The Columbia Missouri Ecological Field Services Office may be reached at 573-234-2132, or by mail at 101 Park Deville Drive, Suite A, Columbia, MO 65203.

Transportation Projects: If the project involves the use of Federal Highway Administration transportation funds, these recommendations may not fulfill all contract requirements. Please contact the Missouri Department of Transportation at 573-526-4778 or www.modot.mo.gov/ehp/index.htm for additional information on recommendations.

Species or Communities of Conservation Concern within the Area:

There are records for species listed under the Federal Endangered Species Act, and possibly also records for species listed Endangered by the state, or Missouri Species and/or Natural Communities of Conservation Concern within or near the the defined Project Area. Please contact the U.S. Fish and Wildlife Service and the Missouri Department of Conservation for further coordination.

MDC Natural Heritage Review
Resource Science Division
P.O. Box 180
Jefferson City, MO
65102-0180
Phone: 573-522-4115 ext. 3182
NaturalHeritageReview@mdc.mo.gov

U.S. Fish and Wildlife Service
Ecological Service
101 Park Deville Drive
Suite A
Columbia, MO
65203-0007
Phone: 573-234-2132

Other Special Search Results:

The project occurs on or near public land, TABLE ROCK LAKE USACOE, please contact COE.

Project Type Recommendations:

Waste Transfer, Treatment and Disposal -Wastewater treatment plant: New or Maintenance; [Clean Water Act](#) permits issued by other agencies regulate both construction and operation of wastewater systems, and provide many important protections for fish and wildlife resources throughout the project area and at some distance downstream. Fish and wildlife almost always benefit when unnatural pollutants are removed from water, and concerns are minimal if construction is managed to minimize erosion and sedimentation/runoff to nearby streams and lakes, including adherence to any "Clean Water Permit" conditions.

Revegetation of disturbed areas is recommended to minimize erosion, as is restoration with of native plant species compatible with the local landscape and for wildlife needs. Annuals like ryegrass may be combined with native perennials for quicker green-up. Avoid aggressive exotic perennials such as crown vetch and sericea lespedeza.

Management Recommendations for Construction Projects Affecting Missouri Streams and Rivers is a Conservation Department publication available at http://mdc.mo.gov/sites/default/files/resources/2013/02/constprojnearstreams_2013.pdf

Project Location and/or Species Recommendations:

Endangered Species Act Coordination - Indiana bats (*Myotis sodalis*, federal- and state-listed endangered) and Northern long-eared bats (*Myotis septentrionalis*, federal-listed threatened) may occur near the project area. Both of these species of bats hibernate during winter months in caves and mines. During the summer months, they roost and raise young under the bark of trees in wooded areas, often riparian forests and upland forests near perennial streams. During project activities, avoid degrading stream quality and where possible leave snags standing and preserve mature forest canopy. Do not enter caves known to harbor Indiana bats or Northern long-eared bats, especially from September to April. If any trees need to be removed for your project, please contact the U.S. Fish and Wildlife Service (Ecological Services, 101 Park Deville Drive, Suite A, Columbia, Missouri 65203-0007; Phone 573-234-2132 ext. 100 for Ecological Services) for further coordination under the Endangered Species Act.

Invasive exotic species are a significant issue for fish, wildlife and agriculture in Missouri. Seeds, eggs, and larvae may be moved to new sites on boats or construction equipment. Please inspect and clean equipment thoroughly before moving between project sites. See <http://mdc.mo.gov/9633> for more information.

- Remove any mud, soil, trash, plants or animals from equipment before leaving any water body or work area.
- Drain water from boats and machinery that have operated in water, checking motor cavities, live-well, bilge and transom wells, tracks, buckets, and any other water reservoirs.
- When possible, wash and rinse equipment thoroughly with hard spray or HOT water (?140° F, typically available at do-it-yourself car wash sites), and dry in the hot sun before using again.

Streams and Wetlands – Clean Water Act Permits: Streams and wetlands in the project area should be protected from activities that degrade habitat conditions. For example, soil erosion, water pollution, placement of fill, dredging, in-stream activities, and riparian corridor removal, can modify or diminish aquatic habitats. Streams and wetlands may be protected under the Clean Water Act and require a permit for any activities that result in fill or other modifications to the site. Conditions provided within the U.S. Army Corps of Engineers (USACE) Clean Water Act Section 404 permit (<http://www.nwk.usace.army.mil/Missions/RegulatoryBranch.aspx>) and the Missouri Department of Natural Resources (DNR) issued Clean Water Act Section 401 Water Quality Certification (<http://dnr.mo.gov/env/wpp/401/index.html>), if required, should help minimize impacts to the aquatic organisms and aquatic habitat within the area. Depending on your project type, additional permits may be required by the Missouri Department of Natural Resources, such as permits for stormwater, wastewater treatment facilities, and confined animal feeding operations. Visit <http://dnr.mo.gov/env/wpp/permits/index.html> for more information on DNR permits. Visit both the USACE and DNR for more information on Clean Water Act permitting.

For further coordination with the Missouri Department of Conservation and the U.S. Fish and Wildlife Services, please see the contact information below.

MDC Natural Heritage Review
Resource Science Division
P.O. Box 180
Jefferson City, MO
65102-0180
Phone: 573-522-4115 ext. 3182
NaturalHeritageReview@mdc.mo.gov

U.S. Fish and Wildlife Service
Ecological Service
101 Park Deville Drive
Suite A
Columbia, MO
65203-0007
Phone: 573-234-2132

Miscellaneous Information

FEDERAL Concerns are species/habitats protected under the Federal Endangered Species Act and that have been known near enough to the project site to warrant consideration. For these, project managers must contact the U.S. Fish and Wildlife Service Ecological Services (101 Park Deville Drive Suite A, Columbia, Missouri 65203-0007; Phone 573-234-2132; Fax 573-234-2181) for consultation.

STATE Concerns are species/habitats known to exist near enough to the project site to warrant concern and that are protected under the Wildlife Code of Missouri (RSMo 3 CSR 10). "State Endangered Status" is determined by the Missouri Conservation Commission under constitutional authority, with requirements expressed in the Missouri Wildlife Code, rule 3CSR 10-4.111. Species tracked by the Natural Heritage Program have a "State Rank" which is a numeric rank of relative rarity. Species tracked by this program and all native Missouri wildlife are protected under rule 3CSR 10-4.110 General Provisions of the Wildlife Code.

Additional information on Missouri's sensitive species may be found at <http://mdc.mo.gov/discover-nature/field-guide/endangered-species>. Detailed information about the animals and some plants mentioned may be accessed at http://mdc4.mdc.mo.gov/applications/mofwis/mofwis_search1.aspx. If you would like printed copies of best management practices cited as internet URLs, please contact the Missouri Department of Conservation.

**MISSOURI DEPARTMENT OF NATURAL RESOURCES
STATEMENT OF BASIS
MO-0123285
KIDS ACROSS AMERICA FOUNDATION WASTEWATER TREATMENT FACILITY**

This Statement of Basis (Statement) gives pertinent information regarding minor modification(s) to the above listed operating permit without the need for a public comment process. A Statement is not an enforceable part of a Missouri State Operating Permit.

Part I – Facility Information

Facility Type: Non-POTW
Facility Description: Chemical addition for phosphorus removal / three-cell septic tanks / splitter-box / recirculating sand filter / ultraviolet disinfection / sludge removed by contract hauler.

Part II – Modification Rationale

This operating permit is hereby modified to reflect a change in ownership and continuing authority from the Kids Across America Foundation to Kids Across America.

No other changes were made at this time.

Part III – Administrative Requirements

On the basis of preliminary staff review and the application of applicable standards and regulations, the Department, as administrative agent for the Missouri Clean Water Commission, proposes to issue a permit(s) subject to certain effluent limitations, schedules, and special conditions contained herein and within the operating permit.

DATE OF FACT SHEET: JANUARY 7, 2020

COMPLETED BY:

**MYRANDA ALFORD, ENVIRONMENTAL SPECIALIST
MISSOURI DEPARTMENT OF NATURAL RESOURCES
WATER PROTECTION PROGRAM
OPERATING PERMITS SECTION - DOMESTIC WASTEWATER UNIT
(573) 526-4029
Myranda.Alford@dnr.mo.gov**

**MISSOURI DEPARTMENT OF NATURAL RESOURCES
FACT SHEET
FOR THE PURPOSE OF RENEWAL
OF
MO-0123285
KIDS ACROSS AMERICA FOUNDATION WASTEWATER TREATMENT PLANT**

The Federal Water Pollution Control Act ("Clean Water Act" Section 402 Public Law 92-500 as amended) established the National Pollutant Discharge Elimination System (NPDES) permit program. This program regulates the discharge of pollutants from point sources into the waters of the United States, and the release of stormwater from certain point sources. All such discharges are unlawful without a permit (Section 301 of the "Clean Water Act"). After a permit is obtained, a discharge not in compliance with all permit terms and conditions is unlawful. Missouri State Operating Permits (MSOPs) are issued by the Director of the Missouri Department of Natural Resources (Department) under an approved program, operating in accordance with federal and state laws (Federal "Clean Water Act" and "Missouri Clean Water Law" Section 644 as amended). MSOPs are issued for a period of five years unless otherwise specified.

As per [40 CFR Part 124.8(a)] and [10 CSR 20-6.020(1)(A)2.] a Factsheet shall be prepared to give pertinent information regarding the applicable regulations, rationale for the development of effluent limitations and conditions, and the public participation process for the Missouri State Operating Permit (operating permit) listed below.

A Factsheet is not an enforceable part of an operating permit.

This Factsheet is for a Minor.

Part I – Facility Information

Facility Type: NON-POTW – SIC #7032

Facility Description: Chemical addition for phosphorus removal / three-cell septic tanks / splitter-box / recirculating sand filter / ultraviolet disinfection / sludge removed by contract hauler.

Have any changes occurred at this facility or in the receiving water body that affects effluent limit derivation?

☒ - No

Application Date: 09/20/18

Expiration Date: 03/31/19

OUTFALL(S) TABLE:

OUTFALL	DESIGN FLOW (CFS)	TREATMENT LEVEL	EFFLUENT TYPE
#001	0.076	Secondary	Domestic

Facility Performance History:

This facility was last inspected on September 9, 2010. The conditions at the time of the inspections were found to be satisfactory. A review of discharge monitoring reports noted the following observations or limit exceedances (month/year):

DMR Non-Receipt: 1/18

Phosphorus, P: 7/15, 8/13

Numerous Non-Discharge: Facility not in use during winter months

Comments:

Changes in this permit include the addition of lake mixing and aluminum monitoring; phosphorus daily monitoring was removed while monitoring for all parameters was changed from monthly to quarterly. See Part VI of the Fact Sheet for further information regarding the addition and removal of effluent parameters. Special conditions were updated to include the addition of the Electronic Discharge Monitoring Report (eDMR) Submission System.

Part II – Operator Certification Requirements

☒ - This facility is not required to have a certified operator.

Part III– Operational Monitoring

☒ - As per [10 CSR 20-9.010(4)], the facility is not required to conduct operational monitoring.

Part IV – Receiving Stream Information

RECEIVING STREAM(S) TABLE: OUTFALL #001

WATER-BODY NAME	CLASS	WBID	DESIGNATED USES*	12-DIGIT HUC	DISTANCE TO CLASSIFIED SEGMENT (MI)
Tributary to Table Rock Lake	NA	NA	General Criteria	11010001-0808	0.05
Table Rock Lake	L2	7313	AQL, WBC-A, SCR, HHP, IRR, LWW		

*As per 10 CSR 20-7.031 Missouri Water Quality Standards, the Department defines the Clean Water Commission's water quality objectives in terms of "water uses to be maintained and the criteria to protect those uses." The receiving stream and 1st classified receiving stream's beneficial water uses to be maintained are in the receiving stream table in accordance with [10 CSR 20-7.031(1)(C)].

Uses which may be found in the receiving streams table, above:

10 CSR 20-7.031(1)(C)1.:

AQL = Protection of aquatic life (Current narrative use(s) are defined to ensure the protection and propagation of fish shellfish and wildlife, which is further subcategorized as: **WWH** = Warm Water Habitat; **CDF** = Cold-water fishery (Current narrative use is cold-water habitat.); **CLF** = Cool-water fishery (Current narrative use is cool-water habitat); **EAH** = Ephemeral Aquatic Habitat; **MAH** = Modified Aquatic Habitat; **LAH** = Limited Aquatic Habitat. This permit uses AQL effluent limitations in 10 CSR 20-7.031 Table A for all habitat designations unless otherwise specified.)

10 CSR 20-7.031(1)(C)2.: Recreation in and on the water

WBC = Whole Body Contact recreation where the entire body is capable of being submerged;

WBC-A = Whole body contact recreation that supports swimming uses and has public access;

WBC-B = Whole body contact recreation that supports swimming;

SCR = Secondary Contact Recreation (like fishing, wading, and boating).

10 CSR 20-7.031(1)(C)3. to 7.:

HHP (formerly HHF) = Human Health Protection as it relates to the consumption of fish;

IRR = Irrigation for use on crops utilized for human or livestock consumption;

LWW = Livestock and wildlife watering (Current narrative use is defined as **LWP** = Livestock and Wildlife Protection);

DWS = Drinking Water Supply;

IND = Industrial water supply

10 CSR 20-7.031(1)(C)8-11.: Wetlands (10 CSR 20-7.031 Table A currently does not have corresponding habitat use criteria for these defined uses)

WSA = Storm- and flood-water storage and attenuation; **WHP** = Habitat for resident and migratory wildlife species;

WRC = Recreational, cultural, educational, scientific, and natural aesthetic values and uses; **WHC** = Hydrologic cycle maintenance.

10 CSR 20-7.031(6): **GRW** = Groundwater

RECEIVING STREAM(S) LOW-FLOW VALUES:

RECEIVING STREAM (C, E, P, P1)	LOW-FLOW VALUES (CFS)		
	1Q10	7Q10	30Q10
Tributary to Table Rock Lake	0	0	0

MIXING CONSIDERATIONS

Mixing Zone: Not Allowed [10 CSR 20-7.031(5)(A)4.B.(I)(a)].

Zone of Initial Dilution: Not Allowed [10 CSR 20-7.031(5)(A)4.B.(I)(b)].

MIXING CONSIDERATIONS

Zone of Initial Dilution: Not Allowed [10 CSR 20-7.031(5)(A)4.B.(IV)(b)].

Mixing Zone:

Mixing Zone (MZ) Parameters: According to the USGS 1:24,000K Quadrangle, the mainstem lake width near the facility outfall location is approximately 1678 feet (ft.). Using “normal” water levels of 1678 ft. wide and one-quarter of this width equals 419.5 ft. Therefore, because 100 feet is less than 419.5 ft., MZ = 100 feet [10 CSR 20-7.031(5)(A)5.B.(IV)(a)].

Mixing Zone Volume: The flow volume approximates a triangular prism because of the slope of the lake bottom, where the formula is $\text{Volume} = L * W * (D * 0.5)$. Assuming that the width will be either side of the discharge (MZ) length (100 feet) to form the plume effect, the box dimensions are length (L) = 100 ft., width (W) = 100 ft., and depth (D) = 5 ft. Depth was obtained using mixing zone length projected 100 ft. from shoreline to the intersecting contour on 7.5' USGS topographic map (shoreline contour=920 ft. and lake depth contour at 100 ft. from shore = 900 ft.).

$$\text{Volume} = L * W * (D * 0.5) = (100') * (100') * (20' * 0.5) = 100,000 \text{ ft}^3.$$

The flow volume of 25,000 ft³ is assumed as the daily mixing zone. Therefore;
 $30Q_{10} = (100,000 \text{ ft}^3/\text{day}) * (1 \text{ day}/86,400 \text{ sec}) = 1.16 \text{ ft}^3/\text{sec}.$

Receiving Water Body's Water Quality

Currently, no stream survey has been conducted by the Department. When a stream survey is conducted, more information may be available about the receiving stream.

Part V – Rationale and Derivation of Effluent Limitations & Permit Conditions

ALTERNATIVE EVALUATIONS FOR NEW FACILITIES:

As per [10 CSR 20-7.015(4)(A)], discharges to losing streams shall be permitted only after other alternatives including land application, discharges to a gaining stream and connection to a regional wastewater treatment facility have been evaluated and determined to be unacceptable for environmental and/or economic reasons.

☒ - The facility does not discharge to a Losing Stream as defined by [10 CSR 20-2.010(40)] & [10 CSR 20-7.031(1)(O)], or is an existing facility.

ANTI-BACKSLIDING:

A provision in the Federal Regulations [CWA §303(d)(4); CWA §402(o); 40 CFR Part 122.44(l)] that requires a reissued permit to be as stringent as the previous permit with some exceptions.

☒ - Limitations in this operating permit for the reissuance of this permit conform to the anti-backsliding provisions of Section 402(o) of the Clean Water Act, and 40 CFR Part 122.44.

☒ - Information is available which was not available at the time of permit issuance (other than revised regulations, guidance, or test methods) and which would have justified the application of a less stringent effluent limitation at the time of permit issuance.

- **Sampling Frequency.** The previous permit contained monthly sampling and reporting frequencies. This permit contains quarterly sampling and reporting frequencies due to the low design flow of the facility, consistency amongst effluent data, and compliance with effluent limits. The permit is still protective of water quality.

☒ - The Department determines that technical mistakes or mistaken interpretations of law were made in issuing the permit under section 402(a)(1)(b).

- **General Criteria.** The previous permit contained a special condition which described a specific set of prohibitions related to general criteria found in 10 CSR 20-7.031(4). In order to comply with 40 CFR 122.44(d)(1), the permit writer has conducted reasonable potential determinations for each general criterion and established numeric effluent limitations where reasonable potential exists. While the removal of the previous permit special condition creates the appearance of backsliding, since this permit establishes numeric limitations where reasonable potential to cause or contribute to an excursion of the general criteria exists the permit maintains sufficient effluent limitations and monitoring requirements in order to protect water quality, this permit is equally protective as compared to the previous permit. Therefore, given this new information, and the fact that the previous permit special condition was not consistent with 40 CFR 122.44(d)(1), an error occurred in the establishment of the general criteria as a special condition of the previous permit. Please see Part VI – Effluent Limits Determination for more information regarding the reasonable potential determinations for each general criterion related to this facility.

ANTIDEGRADATION:

In accordance with Missouri's Water Quality Standard [10 CSR 20-7.031(3)], the Department is to document by means of Antidegradation Review that the use of a water body's available assimilative capacity is justified. Degradation is justified by documenting the socio-economic importance of a discharging activity after determining the necessity of the discharge.

☒ - No degradation proposed and no further review necessary. Facility did not apply for authorization to increase pollutant loading or to add additional pollutants to their discharge.

AREA-WIDE WASTE TREATMENT MANAGEMENT & CONTINUING AUTHORITY:

As per [10 CSR 20-6.010(2)(C)], An applicant may utilize a lower preference continuing authority by submitting, as part of the application, a statement waiving preferential status from each existing higher preference authority, providing the waiver does not conflict with any area-wide management plan approved under section 208 of the Federal Clean Water Act or any other regional sewage service and treatment plan approved for higher preference authority by the Department.

BIOSOLIDS & SEWAGE SLUDGE:

Biosolids are solid materials resulting from domestic wastewater treatment that meet federal and state criteria for beneficial uses (i.e. fertilizer). Sewage sludge is solids, semi-solids, or liquid residue generated during the treatment of domestic sewage in a treatment works; including but not limited to, domestic septage; scum or solids removed in primary, secondary, or advanced wastewater treatment process; and a material derived from sewage sludge. Sewage sludge does not include ash generated during the firing of sewage sludge in a sewage sludge incinerator or grit and screening generated during preliminary treatment of domestic sewage in a treatment works.

☒ - Permittee is not authorized to land apply biosolids. Sludge/biosolids are removed by contract.

COMPLIANCE AND ENFORCEMENT:

Enforcement is the action taken by the Water Protection Program (WPP) to bring an entity into compliance with the Missouri Clean Water Law, its implementing regulations, and/or any terms and conditions of an operating permit. The primary purpose of the enforcement activity in the WPP is to resolve violations and return the entity to compliance.

☒ - The facility is not currently under Water Protection Program enforcement action.

ELECTRONIC DISCHARGE MONITORING REPORT (EDMR) SUBMISSION SYSTEM:

The U.S. Environmental Protection Agency (EPA) promulgated a final rule on October 22, 2015, to modernize Clean Water Act reporting for municipalities, industries, and other facilities by converting to an electronic data reporting system. This final rule requires regulated entities and state and federal regulators to use information technology to electronically report data required by the National Pollutant Discharge Elimination System (NPDES) permit program instead of filing paper reports. To comply with the federal rule, the Department is requiring all permittees to begin submitting discharge monitoring data and reports online. In an effort to aid facilities in the reporting of applicable information electronically, the Department has created several new forms including operational control monitoring forms and an I & I location and reduction form. These forms are for optional use and can be found on the Department's website at the following locations:

Operational Monitoring Lagoon: <http://dnr.mo.gov/forms/780-2801-f.pdf>

Operational Monitoring Mechanical: <http://dnr.mo.gov/forms/780-2800-f.pdf>

I&I Report: <http://dnr.mo.gov/forms/780-2690-f.pdf>

Per 40 CFR 127.15 and 127.24, permitted facilities may request a temporary waiver for up to five years or a permanent waiver from electronic reporting from the Department. To obtain an electronic reporting waiver, a permittee must first submit an eDMR Waiver Request Form: <http://dnr.mo.gov/forms/780-2692-f.pdf>. A request must be made for each facility. If more than one facility is owned or operated by a single entity, then the entity must submit a separate request for each facility based on its specific circumstances. An approved waiver is non-transferable.

The Department must review and notify the facility within 120 calendar days of receipt if the waiver request has been approved or rejected [40 CFR 124.27(a)]. During the Department review period as well as after a waiver is granted, the facility must continue submitting a hard-copy of any reports required by their permit. The Department will enter data submitted in hard-copy from those facilities allowed to do so and electronically submit the data to the EPA on behalf of the facility.

☒ - The permittee/facility is currently using the eDMR data reporting system.

NUMERIC LAKE NUTRIENT CRITERIA

☒ - This facility discharges into a lake watershed where numeric lake nutrient criteria are applicable. However, regulations established in 10 CSR 20-7.015 as well as the department's lake nutrient criteria implementation plan do not require nutrient monitoring for facilities with design flows less than or equal to 0.1MGD. Should the lake within this watershed be identified as impaired due to nutrient loading, the department will conduct watershed modeling to determine if this facility has reasonable potential to cause or contribute to the impairment. Consequently, monitoring or effluent limitations may be established at a later date based on the modeling results. For more information, please see the department's Nutrient Criteria Implementation Plan at: <https://dnr.mo.gov/env/wpp/rules/documents/nutrient-implementation-plan-final-072618.pdf>.

PRETREATMENT PROGRAM:

The reduction of the amount of pollutants, the elimination of pollutants, or the alteration of the nature of pollutant properties in wastewater prior to or in lieu of discharging or otherwise introducing such pollutants into a Publicly Owned Treatment Works [40 CFR Part 403.3(q)].

Pretreatment programs are required at any POTW (or combination of POTW operated by the same authority) and/or municipality with a total design flow greater than 5.0 MGD and receiving industrial wastes that interfere with or pass through the treatment works or are otherwise subject to the pretreatment standards. Pretreatment programs can also be required at POTWs/municipals with a design flow less than 5.0 MGD if needed to prevent interference with operations or pass through.

☒ - The permittee, at this time, is not required to have a Pretreatment Program or does not have an approved pretreatment program.

REASONABLE POTENTIAL ANALYSIS (RPA):

Federal regulation [40 CFR Part 122.44(d)(1)(i)] requires effluent limitations for all pollutants that are or may be discharged at a level that will cause or have the reasonable potential to cause or contribute to an in-stream excursion above narrative or numeric water quality standard.

In accordance with [40 CFR Part 122.44(d)(1)(iii)] if the permit writer determines that any given pollutant has the reasonable potential to cause, or contribute to an in-stream excursion above the WQS, the permit must contain effluent limits for that pollutant.

☒ - An RPA was conducted on appropriate parameters. Please see **APPENDIX – RPA RESULTS**.

REMOVAL EFFICIENCY:

Removal efficiency is a method by which the Federal Regulations define Secondary Treatment and Equivalent to Secondary Treatment, which applies to Biochemical Oxygen Demand 5-day (BOD₅) and Total Suspended Solids (TSS) for Publicly Owned Treatment Works (POTWs)/municipals.

☒ - Influent monitoring is not being required to determine percent removal.

SANITARY SEWER OVERFLOWS (SSO) AND INFLOW AND INFILTRATION (I&I):

Sanitary Sewer Overflows (SSOs) are defined as untreated sewage releases and are considered bypassing under state regulation [10 CSR 20-2.010(12)] and should not be confused with the federal definition of bypass. SSOs result from a variety of causes including blockages, line breaks, and sewer defects that can either allow wastewater to backup within the collection system during dry weather conditions or allow excess stormwater and groundwater to enter and overload the collection system during wet weather conditions. SSOs can also result from lapses in sewer system operation and maintenance, inadequate sewer design and construction, power failures, and vandalism. SSOs include overflows out of manholes, cleanouts, broken pipes, and other into waters of the state and onto city streets, sidewalks, and other terrestrial locations.

Inflow and Infiltration (I&I) is defined as unwanted intrusion of stormwater or groundwater into a collection system. This can occur from points of direct connection such as sump pumps, roof drain downspouts, foundation drains, and storm drain cross-connections or through cracks, holes, joint failures, faulty line connections, damaged manholes, and other openings in the collection system itself. I&I results from a variety of causes including line breaks, improperly sealed connections, cracks caused by soil erosion/settling, penetration of vegetative roots, and other sewer defects. In addition, excess stormwater and groundwater entering the collection system from line breaks and sewer defects have the potential to negatively impact the treatment facility.

Missouri RSMo §644.026.1.(13) mandates that the Department issue permits for discharges of water contaminants into the waters of this state, and also for the operation of sewer systems. Such permit conditions shall ensure compliance with all requirements as established by sections 644.006 to 644.141. Standard Conditions Part I, referenced in the permit, contains provisions requiring proper operation and maintenance of all facilities and systems of treatment and control. Missouri RSMo §644.026.1.(15) instructs the Department to require proper maintenance and operation of treatment facilities and sewer systems and proper disposal of residual waste from all such facilities. To ensure that public health and the environment are protected, any noncompliance which may endanger public health or the environment must be reported to the Department within 24 hours of the time the permittee becomes aware of the

noncompliance. Standard Conditions Part I, referenced in the permit, contains the reporting requirements for the permittee when bypasses and upsets occur. The permit also contains requirements for permittees to develop and implement a program for maintenance and repair of the collection system. The permit requires that the permittee submit an annual report to the Department for the previous calendar year that contains a summary of efforts taken by the permittee to locate and eliminate sources of excess I & I, a summary of general maintenance and repairs to the collection system, and a summary of any planned maintenance and repairs to the collection system for the upcoming calendar year.

☒ - This facility is not required to develop or implement a program for maintenance and repair of the collection system; however, it is a violation of Missouri State Environmental Laws and Regulations to allow untreated wastewater to discharge to waters of the state.

SCHEDULE OF COMPLIANCE (SOC):

Per 644.051.4 RSMo, a permit may be issued with a Schedule of Compliance (SOC) to provide time for a facility to come into compliance with new state or federal effluent regulations, water quality standards, or other requirements. Such a schedule is not allowed if the facility is already in compliance with the new requirement, or if prohibited by other statute or regulation. A SOC includes an enforceable sequence of interim requirements (actions, operations, or milestone events) leading to compliance with the Missouri Clean Water Law, its implementing regulations, and/or the terms and conditions of an operating permit. *See also* Section 502(17) of the Clean Water Act, and 40 CFR §122.2. For new effluent limitations, the permit may include interim monitoring for the specific parameter to demonstrate the facility is not already in compliance with the new requirement. Per 40 CFR § 122.47(a)(1) and 10 CSR 20-7.031(11), compliance must occur as soon as possible. If the permit provides a schedule for meeting new water quality based effluent limits, an SOC must include an enforceable, final effluent limitation in the permit even if the SOC extends beyond the life of the permit.

An SOC is not allowed:

- For effluent limitations based on technology-based standards established in accordance with federal requirements, if the deadline for compliance established in federal regulations has passed. 40 CFR § 125.3.
- For a newly constructed facility in most cases. Newly constructed facilities must meet applicable effluent limitations when discharge begins, because the facility has installed the appropriate control technology as specified in a permit or antidegradation review. An SOC is allowed for a new water quality based effluent limit that was not included in a previously public noticed permit or antidegradation review, which may occur if a regulation changes during construction.
- To develop a TMDL, UAA, or other study associated with development of a site specific criterion. A facility is not prohibited from conducting these activities, but an SOC may not be granted for conducting these activities.

In order to provide guidance to Permit Writers in developing SOC's, and attain a greater level of consistency, on April 9, 2015 the Department issued an updated policy on development of SOC's. This policy provides guidance to Permit Writers on the standard time frames for schedules for common activities, and guidance on factors that may modify the length of the schedule such as a Cost Analysis for Compliance.

☒ - This permit does not contain an SOC.

STORMWATER POLLUTION PREVENTION PLAN (SWPPP):

In accordance with 40 CFR 122.44(k) *Best Management Practices (BMPs)* to control or abate the discharge of pollutants when: (1) Authorized under section 304(e) of the Clean Water Act (CWA) for the control of toxic pollutants and hazardous substances from ancillary industrial activities; (2) Authorized under section 402(p) of the CWA for the control of stormwater discharges; (3) Numeric effluent limitations are infeasible; or (4) the practices are reasonably necessary to achieve effluent limitations and standards or to carry out the purposes and intent of the CWA.

In accordance with the EPA's *Developing Your Stormwater Pollution Prevention Plan, A Guide for Industrial Operators*, (Document number EPA 833-B-09-002) [published by the United States Environmental Protection Agency (USEPA) in February 2009], BMPs are measures or practices used to reduce the amount of pollution entering (regarding this operating permit) waters of the state. BMPs may take the form of a process, activity, or physical structure.

Additionally in accordance with the Stormwater Management, a SWPPP is a series of steps and activities to (1) identify sources of pollution or contamination, and (2) select and carry out actions which prevent or control the pollution of stormwater discharges. The purpose of a SWPPP is to comply with all applicable stormwater regulations by creating an adaptive management plan to control and mitigate stream pollution from stormwater runoff. Developing a SWPPP provides opportunities to employ appropriate BMPs to minimize the risk of pollutants being discharged during storm events. The following paragraph outlines the general steps the permittee should take to determine which BMPs will work to achieve the benchmark values or limits in the permit. This section is not intended to be all encompassing or restrict the use of any physical BMP or operational and maintenance procedure assisting in pollution control. Additional steps or revisions to the SWPPP may be required to meet the requirements of the permit.

Areas which should be included in the SWPPP are identified in 40 CFR 122.26(b)(14). Once the potential sources of stormwater pollution have been identified, a plan should be formulated to best control the amount of pollutant being released and discharged by

each activity or source. This should include, but is not limited to, minimizing exposure to stormwater, good housekeeping measures, proper facility and equipment maintenance, spill prevention and response, vehicle traffic control, and proper materials handling. Once a plan has been developed the facility will employ the control measures determined to be adequate to achieve the benchmark values discussed above. The facility will conduct monitoring and inspections of the BMPs to ensure they are working properly and re-evaluate any BMP not achieving compliance with permitting requirements. For example, if sample results from an outfall show values of TSS above the benchmark value, the BMP being employed is deficient in controlling stormwater pollution. Corrective action should be taken to repair, improve, or replace the failing BMP. This internal evaluation is required at least once per month but should be continued more frequently if BMPs continue to fail. If failures do occur, continue this trial and error process until appropriate BMPs have been established.

For new, altered, or expanded stormwater discharges, the SWPPP shall identify reasonable and effective BMPs while accounting for environmental impacts of varying control methods. The antidegradation analysis must document why no discharge or no exposure options are not feasible. The selection and documentation of appropriate control measures shall serve as an alternative analysis of technology and fulfill the requirements of antidegradation [10 CSR 20-7.031(3)]. For further guidance, consult the antidegradation implementation procedure (<http://dnr.mo.gov/env/wpp/docs/AIP050212.pdf>).

Alternative Analysis (AA) evaluation of the BMPs is a structured evaluation of BMPs that are reasonable and cost effective. The AA evaluation should include practices that are designed to be: 1) non-degrading; 2) less degrading; or 3) degrading water quality. The glossary of AIP defines these three terms. The chosen BMP will be the most reasonable and effective management strategy while ensuring the highest statutory and regulatory requirements are achieved and the highest quality water attainable for the facility is discharged. The AA evaluation must demonstrate why “no discharge” or “no exposure” is not a feasible alternative at the facility. This structured analysis of BMPs serves as the antidegradation review, fulfilling the requirements of 10 CSR 20-7.031(3) Water Quality Standards and *Antidegradation Implementation Procedure* (AIP), Section II.B.

If parameter-specific numeric exceedances continue to occur and the permittee feels there are no practicable or cost-effective BMPs which will sufficiently reduce a pollutant concentration in the discharge to the benchmark values established in the permit, the permittee can submit a request to re-evaluate the benchmark values. This request needs to include 1) a detailed explanation of why the facility is unable to comply with the permit conditions and unable to establish BMPs to achieve the benchmark values; 2) financial data of the company and documentation of cost associated with BMPs for review and 3) the SWPPP, which should contain adequate documentation of BMPs employed, failed BMPs, corrective actions, and all other required information. This will allow the Department to conduct a cost analysis on control measures and actions taken by the facility to determine cost-effectiveness of BMPs. The request shall be submitted in the form of an operating permit modification; the application is found at: <http://dnr.mo.gov/forms/index.html>.

☒ - At this time, the permittee is not required to develop and implement a SWPPP.

VARIANCE:

As per the Missouri Clean Water Law § 644.061.4, variances shall be granted for such period of time and under such terms and conditions as shall be specified by the commission in its order. The variance may be extended by affirmative action of the commission. In no event shall the variance be granted for a period of time greater than is reasonably necessary for complying with the Missouri Clean Water Law §§644.006 to 644.141 or any standard, rule or regulation promulgated pursuant to Missouri Clean Water Law §§644.006 to 644.141.

☒ - This operating permit is not drafted under premises of a petition for variance.

WASTELOAD ALLOCATIONS (WLA) FOR LIMITS:

As per [10 CSR 20-2.010(86)], the amount of pollutant each discharger is allowed by the Department to release into a given stream after the Department has determined total amount of pollutant that may be discharged into that stream without endangering its water quality.

☒ - Wasteload allocations were calculated where applicable using water quality criteria or water quality model results and the dilution equation below:

$$C_e = \frac{(Q_e + Q_s)C - (Q_s \times C_s)}{(Q_e)} \quad (\text{EPA/505/2-90-001, Section 4.5.5})$$

Where C = downstream concentration
Cs = upstream concentration
Qs = upstream flow
Ce = effluent concentration
Qe = effluent flow

Chronic wasteload allocations were determined using applicable chronic water quality criteria (CCC: criteria continuous concentration) and stream volume of flow at the edge of the mixing zone (MZ). Acute wasteload allocations were determined using applicable water quality criteria (CMC: criteria maximum concentration) and stream volume of flow at the edge of the zone of initial dilution (ZID).

Water quality based maximum daily and average monthly effluent limitations were calculated using methods and procedures outlined in USEPA's "Technical Support Document For Water Quality-based Toxics Control" (EPA/505/2-90-001).

Number of Samples "n":

Additionally, in accordance with the TSD for water quality-based permitting, effluent quality is determined by the underlying distribution of daily values, which is determined by the Long Term Average (LTA) associated with a particular Wasteload Allocation (WLA) and by the Coefficient of Variation (CV) of the effluent concentrations. Increasing or decreasing the monitoring frequency does not affect this underlying distribution or treatment performance, which should be, at a minimum, be targeted to comply with the values dictated by the WLA. Therefore, it is recommended that the actual planned frequency of monitoring normally be used to determine the value of "n" for calculating the AML. However, in situations where monitoring frequency is once per month or less, a higher value for "n" must be assumed for AML derivation purposes. Thus, the statistical procedure being employed using an assumed number of samples is "n = 4" at a minimum. For Total Ammonia as Nitrogen, "n = 30" is used.

WLA MODELING:

There are two general types of effluent limitations, technology-based effluent limits (TBELs) and water quality based effluent limits (WQBELs). If TBELs do not provide adequate protection for the receiving waters, then WQBEL must be used.

☒ - A WLA study was either not submitted or determined not applicable by Department staff.

WATER QUALITY STANDARDS:

Per [10 CSR 20-7.031(4)], General Criteria shall be applicable to all waters of the state at all times including mixing zones. Additionally, [40 CFR 122.44(d)(1)] directs the Department to establish in each NPDES permit to include conditions to achieve water quality established under Section 303 of the Clean Water Act, including State narrative criteria for water quality.

WHOLE EFFLUENT TOXICITY (WET) TEST:

A WET test is a quantifiable method of determining if a discharge from a facility may be causing toxicity to aquatic life by itself, in combination with or through synergistic responses when mixed with receiving stream water.

Under the federal Clean Water Act (CWA) §101(a)(3), requiring WET testing is reasonably appropriate for site-specific Missouri State Operating Permits for discharges to waters of the state issued under the National Pollutant Discharge Elimination System (NPDES). WET testing is also required by 40 CFR 122.44(d)(1). WET testing ensures that the provisions in the 10 CSR 20-6.010(8)(A)7. and the Water Quality Standards 10 CSR 20-7.031(4)(D),(F),(G),(J)2.A & B are being met. Under [10 CSR 20-6.010(8)(B)], the Department may require other terms and conditions that it deems necessary to assure compliance with the Clean Water Act and related regulations of the Missouri Clean Water Commission. In addition the following MCWL apply: §§§644.051.3 requires the Department to set permit conditions that comply with the MCWL and CWA; 644.051.4 specifically references toxicity as an item we must consider in writing permits (along with water quality-based effluent limits, pretreatment, etc...); and 644.051.5 is the basic authority to require testing conditions. WET test will be required by facilities meeting the following criteria:

- ☐ Facility is a designated Major.
- ☐ Facility continuously or routinely exceeds its design flow.
- ☐ Facility that exceeds its design population equivalent (PE) for BOD₅ whether or not its design flow is being exceeded.
- ☐ Facility (whether primarily domestic or industrial) that alters its production process throughout the year.
- ☐ Facility handles large quantities of toxic substances, or substances that are toxic in large amounts.
- ☐ Facility has Water Quality-based Effluent Limitations for toxic substances (other than NH₃)
- ☐ Facility is a municipality with a Design Flow ≥ 22,500 gpd.
- ☐ Other – please justify.

☒ - At this time, the permittee is not required to conduct WET test for this facility

40 CFR 122.41(M) - BYPASSES:

The federal Clean Water Act (CWA), Section 402 prohibits wastewater dischargers from "bypassing" untreated or partially treated sewage (wastewater) beyond the headworks. A bypass is defined as an intentional diversion of waste streams from any portion of a treatment facility, [40 CFR 122.41(m)(1)(i)]. Additionally, Missouri regulation 10 CSR 20-7.015(9)(G) states a bypass means the intentional diversion of waste streams from any portion of a treatment facility, except in the case of blending, to waters of the state. Only under exceptional and specified limitations do the federal regulations allow for a facility to bypass some or all of the flow from its treatment process. Bypasses are prohibited by the CWA unless a permittee can meet all of the criteria listed in 40 CFR

122.41(m)(4)(i)(A), (B), & (C). Any bypasses from this facility are subject to the reporting required in 40 CFR 122.41(l)(6) and per Missouri's Standard Conditions I, Section B, part 2.b. Additionally, Anticipated Bypasses include bypasses from peak flow basins or similar devices designed for peak wet weather flows.

☒ - This facility does not anticipate bypassing.

303(d) LIST & TOTAL MAXIMUM DAILY LOAD (TMDL):

Section 303(d) of the federal Clean Water Act requires that each state identify waters that are not meeting water quality standards and for which adequate water pollution controls have not been required. Water quality standards protect such beneficial uses of water as whole body contact (such as swimming), maintaining fish and other aquatic life, and providing drinking water for people, livestock and wildlife. The 303(d) list helps state and federal agencies keep track of waters that are impaired but not addressed by normal water pollution control programs.

A TMDL is a calculation of the maximum amount of a given pollutant that a body of water can absorb before its water quality is affected. If a water body is determined to be impaired as listed on the 303(d) list, then a watershed management plan will be developed that shall include the TMDL calculation

☒ - This facility discharges to a 303(d) listed stream. Table Rock Lake is listed on the 2018 Missouri 303(d) for Chlorophyll-a and Total Nitrogen. It is unknown at this time if the facility is a source of the above listed pollutant(s) or considered to contribute to the impairment of Table Rock Lake. Once a TMDL is developed, the permit may be modified to include WLAs from the TMDL.

Part VI – Effluent Limits Determination

APPLICABLE DESIGNATIONS OF WATERS OF THE STATE:

As per Missouri's Effluent Regulations [10 CSR 20-7.015], the waters of the state are divided into the below listed seven (7) categories. Each category lists effluent limitations for specific parameters, which are presented in each outfall's Effluent Limitation Table and further discussed in the Derivation & Discussion of Limits section.

- | | |
|---|---|
| <input type="checkbox"/> Missouri or Mississippi River [10 CSR 20-7.015(2)] | <input type="checkbox"/> Special Streams [10 CSR 20-7.015(6)] |
| <input checked="" type="checkbox"/> Lakes or Reservoirs [10 CSR 20-7.015(3)] | <input type="checkbox"/> Subsurface Waters [10 CSR 20-7.015(7)] |
| <input type="checkbox"/> Losing Streams [10 CSR 20-7.015(4)] | <input type="checkbox"/> All Other Waters [10 CSR 20-7.015(8)] |
| <input type="checkbox"/> Metropolitan No-Discharge Streams [10 CSR 20-7.015(5)] | |

OUTFALL #001 – MAIN FACILITY OUTFALL

Effluent limitations derived and established in the below Effluent Limitations Table are based on current operations of the facility. Future permit action due to facility modification may contain new operating permit terms and conditions that supersede the terms and conditions, including effluent limitations, of this operating permit.

EFFLUENT LIMITATIONS TABLE:

PARAMETER	Unit	Basis for Limits	Daily Maximum	Weekly Average	Monthly Average	Previous Permit Limit	Sampling Frequency	Reporting Frequency	Sample Type ****
Flow	MGD	1	*		*	*/	1/quarter	quarterly	T
BOD ₅	mg/L	1		30	20	30/20	1/quarter	quarterly	G
TSS	mg/L	1		30	20	30/20	1/quarter	quarterly	G
<i>Escherichia coli</i> **	#/100mL	1, 3	630		126	630/126	1/quarter	quarterly	G
Ammonia as N (Apr 1 – Sep 30)	mg/L	2, 3	12.1		4.0	12.1/4.6	1/quarter	quarterly	G
Ammonia as N (Oct 1 – Mar 31)	mg/L	2, 3	12.1		4.6	12.1/4.6	1/quarter	quarterly	G
Total Phosphorus	µg/L	1			0.5	*/0.5	1/quarter	quarterly	G
Aluminum, Total Recoverable	µg/L	1	*		*	***	1/quarter	quarterly	G
PARAMETER	Unit	Basis for Limits	Minimum		Maximum	Previous Permit Limit	Sampling Frequency	Reporting Frequency	Sample Type
pH	SU	1	6.0		9.0	6.0-9.0	1/quarter	quarterly	G

* - Monitoring requirement only.

** - #/100mL; the Monthly Average for *E. coli* is a geometric mean.

**** - C = 24-hour composite

G = Grab

*** - Parameter not previously established in previous state operating permit.

T = 24-hr. total
E = 24-hr. estimate**Basis for Limitations Codes:**

- | | | |
|--|-----------------------------------|----------------------------------|
| 1. State or Federal Regulation/Law | 5. Antidegradation Policy | 9. WET Test Policy |
| 2. Water Quality Standard (includes RPA) | 6. Water Quality Model | 10. Multiple Discharger Variance |
| 3. Water Quality Based Effluent Limits | 7. Best Professional Judgment | |
| 4. Antidegradation Review | 8. TMDL or Permit in lieu of TMDL | |

OUTFALL #001 – DERIVATION AND DISCUSSION OF LIMITS:

- **Flow.** In accordance with [40 CFR Part 122.44(i)(1)(ii)] the volume of effluent discharged from each outfall is needed to assure compliance with permitted effluent limitations. If the permittee is unable to obtain effluent flow, then it is the responsibility of the permittee to inform the Department, which may require the submittal of an operating permit modification.
- **Biochemical Oxygen Demand (BOD₅).** Effluent limitations have been retained from previous state operating permit, please see the **APPLICABLE DESIGNATION OF WATERS OF THE STATE** sub-section of the **Effluent Limits Determination**.
- **Total Suspended Solids (TSS).** Effluent limitations have been retained from previous state operating permit, please see the **APPLICABLE DESIGNATION OF WATERS OF THE STATE** sub-section of the **Effluent Limits Determination**.

Escherichia coli (E. coli). Monthly average of 126 per 100 mL as a geometric mean and Daily Maximum of 630 per 100 mL during the recreational season (April 1 – October 31), to protect Whole Body Contact Recreation (B) designated use of the receiving stream, as per 10 CSR 20-7.031(5)(C). An effluent limit for both monthly average and daily maximum is required by 40 CFR 122.45(d). The Geometric Mean is calculated by multiplying all of the data points and then taking the nth root of this product, where n = # of samples collected. For example: Five *E. coli* samples were collected with results of 1, 4, 6, 10, and 5 (#/100mL). Geometric Mean = 5th root of (1)(4)(6)(10)(5) = 5th root of 1,200 = 4.1 #/100mL.

- **Total Ammonia Nitrogen.** Early Life Stages Present Total Ammonia Nitrogen criteria apply [10 CSR 20-7.031(5)(B)7.C. & Table B3]. Background total ammonia nitrogen = 0.01 mg/L. No Zone of Initial Dilution allowed [10 CSR 20-7.031(5)(A)4.B.(IV)(b).

Season	Temp (°C)	pH (SU)	Total Ammonia Nitrogen CCC (mg/L)	Total Ammonia Nitrogen CMC (mg/L)
Summer	26	7.8	1.5	12.1
Winter	6	7.8	3.1	12.1

Summer: April 1 – September 30

Chronic WLA: $C_e = ((0.076 + 1.16)1.5 - (1.16 * 0.01))/0.076$
 $C_e = 24.24 \text{ mg/L}$

Acute WLA: $C_e = ((0.076 + 0.0)12.1 - (0.0 * 0.01))/0.076$
 $C_e = 12.1 \text{ mg/L}$

$LTA_c = 24.24 \text{ mg/L} (0.737) = 17.85 \text{ mg/L}$
 $LTA_a = 12.1 \text{ mg/L} (0.266) = 3.22 \text{ mg/L}$

[CV = 0.74, 99th Percentile, 30 day avg.]
 [CV = 0.74, 99th Percentile]

Use most protective number of LTA_c or LTA_a .

MDL = 3.22 mg/L (3.76) = **12.1 mg/L**
 AML = 3.22 mg/L (1.24) = **4.0 mg/L**

[CV = 0.74, 99th Percentile]
 [CV = 0.74, 95th Percentile, n = 30]

Winter: October 1 – March 31

Chronic WLA: $C_e = ((0.076 + 1.16)3.1 - (1.16 * 0.01))/0.076$
 $C_e = 50.23 \text{ mg/L}$

Acute WLA: $C_e = ((0.076 + 0.0)12.1 - (0.0 * 0.01))/0.076$
 $C_e = 12.1 \text{ mg/L}$

$LTA_c = 50.23 \text{ mg/L} (0.780) = 39.20 \text{ mg/L}$
 $LTA_a = 12.1 \text{ mg/L} (0.321) = 3.89 \text{ mg/L}$

[CV = 0.6, 99th Percentile, 30 day avg.]
 [CV = 0.6, 99th Percentile]

Use most protective number of LTA_c or LTA_a .

MDL = 3.89 mg/L (3.11) = **12.1** mg/L

[CV = 0.6, 99th Percentile]

AML = 3.89 mg/L (1.19) = **4.6** mg/L

[CV = 0.6, 95th Percentile, n =30]

- **pH.** 6.0-9.0 SU. pH limitations [10 CSR 20-7.015] are protective of the water quality standard [10 CSR 20-7.031(5)(E)], due to the assimilative capacity of the receiving stream.
- **Total Phosphorus.** To Table Rock Lake and Lake Taneycomo, 0.5 mg/L per 10 CSR 20-7.015 (3).
- **Aluminum, Total Recoverable.** Monitoring requirement only. This facility uses chemicals for phosphorous removal that may contain aluminum. Monitoring is required to determine if reasonable potential exists for this facility's discharge to exceed water quality standards for Aluminum (Total Recoverable).

Sampling Frequency Justification: The previous permit contained monthly sampling and reporting frequencies. This permit contains quarterly sampling and reporting frequencies due to compliance with effluent limits. The permit is still protective of water quality. Sampling for *E. coli* is set at quarterly per 10 CSR 20-7.015(9)(D)6.C.

Sampling Type Justification: As per 10 CSR 20-7.015, BOD₅ and TSS collected for sand filters may be grab samples. Grab samples must be collected for pH, and *E. coli* in accordance with recommended analytical methods. For further information on sampling and testing methods please review 10 CSR 20-7.015(9)(D) 2.

OUTFALL #001 – GENERAL CRITERIA CONSIDERATIONS:

In accordance with 40 CFR 122.44(d)(1), effluent limitations shall be placed into the permit for those pollutants which have been determined to cause, have the reasonable potential to cause, or contribute to an excursion above any State water quality standard, including State narrative criteria for water quality. The rule further states that pollutants which have been determined to cause, have the reasonable potential to cause, or contribute to an excursion above a narrative criterion within an applicable State water quality standard, the permit shall contain a numeric effluent limitation to protect that narrative criterion. In order to comply with this regulation, the permit writer will complete reasonable potential determinations on whether the discharge will violate any of the general criteria listed in 10 CSR 20-7.031(4). These specific requirements are listed below followed by derivation and discussion (the lettering matches that of the rule itself, under 10 CSR 20-7.031(4)). It should also be noted that Section 644.076.1, RSMo as well as Section D – Administrative Requirements of Standard Conditions Part I of this permit states that it shall be unlawful for any person to cause or permit any discharge of water contaminants from any water contaminant or point source located in Missouri that is in violation of sections 644.006 to 644.141 of the Missouri Clean Water Law or any standard, rule or regulation promulgated by the commission.

- (A) Waters shall be free from substances in sufficient amounts to cause the formation of putrescent, unsightly or harmful bottom deposits or prevent full maintenance of beneficial uses. The discharge from this facility is made up of treated domestic wastewater. Based on a review of a recent Report of Compliance Inspection for the inspection conducted on September 28, 2018 no evidence of an excursion of this criterion has been observed by the Department in the past and the facility has not disclosed any other information related to the characteristics of the discharge on their permit application which has the potential to cause or contribute to an excursion of this narrative criterion. Additionally, this facility utilizes secondary treatment technology and is currently in compliance with effluent limitations that are more stringent than the secondary treatment technology based effluent limits established in 40 CFR 133 and there has been no indication to the Department that the stream has had issues maintaining beneficial uses as a result of this discharge. Based on the information reviewed during the drafting of this permit, these final effluent limitations appear to have protected against the excursion of this criterion in the past. Therefore, the discharge does not have the reasonable potential to cause or contribute to an excursion of this criterion.
- (B) Waters shall be free from oil, scum and floating debris in sufficient amounts to be unsightly or prevent full maintenance of beneficial uses. Please see (A) above as justification is the same.
- (C) Waters shall be free from substances in sufficient amounts to cause unsightly color or turbidity, offensive odor or prevent full maintenance of beneficial uses. Please see (A) above as justification is the same.
- (D) Waters shall be free from substances or conditions in sufficient amounts to result in toxicity to human, animal or aquatic life. This permit contains final effluent limitations which are protective of both acute and chronic toxicity for various pollutants that are either expected to be discharged by domestic wastewater facilities or that were disclosed by this facility on the application for permit coverage. Based on the information reviewed during the drafting of this permit, it has been determined if the facility meets final effluent limitations established in this permit, there is no reasonable potential for the discharge to cause an excursion of this criterion.
- (E) There shall be no significant human health hazard from incidental contact with the water. Please see (D) above as justification is the same.
- (F) There shall be no acute toxicity to livestock or wildlife watering. Please see (D) above as justification is the same.
- (G) Waters shall be free from physical, chemical or hydrologic changes that would impair the natural biological community. Please see (A) above as justification is the same.

(H) Waters shall be free from used tires, car bodies, appliances, demolition debris, used vehicles or equipment and solid waste as defined in Missouri's Solid Waste Law, section 260.200, RSMo, except as the use of such materials is specifically permitted pursuant to section 260.200-260.247. The discharge from this facility is made up of treated domestic wastewater. No evidence of an excursion of this criterion has been observed by the Department in the past and the facility has not disclosed any other information related to the characteristics of the discharge on their permit application which has the potential to cause or contribute to an excursion of this narrative criterion. Additionally, any solid wastes received or produced at this facility are wholly contained in appropriate storage facilities, are not discharged, and are disposed of offsite. This discharge is subject to Standard Conditions Part III, which contains requirements for the management and disposal of sludge to prevent its discharge. Therefore, this discharge does not have reasonable potential to cause or contribute to an excursion of this criterion.

Part VII – Cost Analysis for Compliance

Pursuant to Section 644.145, RSMo., the Department is required to determine whether a permit or decision is affordable and makes a “finding of affordability” for certain permitting and enforcement decisions. This requirement applies to discharges from combined or separate sanitary sewer systems or publically-owned treatment works.

☒ - The Department is not required to complete a cost analysis for compliance because the facility is not a combined or separate sanitary sewer system for a publically-owned treatment works.

Part VIII – Administrative Requirements

On the basis of preliminary staff review and the application of applicable standards and regulations, the Department, as administrative agent for the Missouri Clean Water Commission, proposes to issue a permit(s) subject to certain effluent limitations, schedules, and special conditions contained herein and within the operating permit. The proposed determinations are tentative pending public comment.

WATER QUALITY STANDARD REVISION:

In accordance with section 644.058, RSMo, the Department is required to utilize an evaluation of the environmental and economic impacts of modifications to water quality standards of twenty-five percent or more when making individual site-specific permit decisions.

☒ - This operating permit does not contain requirements for a water quality standard that has changed twenty-five percent or more since the previous operating permit.

PERMIT SYNCHRONIZATION:

The Department of Natural Resources is currently undergoing a synchronization process for operating permits. Permits are normally issued on a five-year term, but to achieve synchronization many permits will need to be issued for less than the full five years allowed by regulation. The intent is that all permits within a watershed will move through the Watershed Based Management (WBM) cycle together will all expire in the same fiscal year. This will allow further streamlining by placing multiple permits within a smaller geographic area on public notice simultaneously, thereby reducing repeated administrative efforts. This will also allow the Department to explore a watershed based permitting effort at some point in the future. Renewal applications must continue to be submitted within 180 days of expiration, however, in instances where effluent data from the previous renewal is less than 4 years old, that data may be re-submitted to meet the requirements of the renewal application. If the permit provides a schedule of compliance for meeting new water quality based effluent limits beyond the expiration date of the permit, the time remaining in the schedule of compliance will be allotted in the renewed permit.

PUBLIC NOTICE:

The Department shall give public notice that a draft permit has been prepared and its issuance is pending. Additionally, public notice will be issued if a public hearing is to be held because of a significant degree of interest in and water quality concerns related to a draft permit. No public notice is required when a request for a permit modification or termination is denied; however, the requester and permittee must be notified of the denial in writing. The Department must issue public notice of a pending operating permit or of a new or reissued statewide general permit. The public comment period is the length of time not less than 30 days following the date of the public notice which interested persons may submit written comments about the proposed permit. For persons wanting to submit comments regarding this proposed operating permit, then please refer to the Public Notice page located at the front of this draft operating permit. The Public Notice page gives direction on how and where to submit appropriate comments.

☒ - The Public Notice period for this operating permit was from December 7, 2018 to January 7, 2019. No responses received.

DATE OF FACT SHEET: OCTOBER 31, 2018

COMPLETED BY:

**KYLE WILLENBURG, ENVIRONMENTAL SPECIALIST
MISSOURI DEPARTMENT OF NATURAL RESOURCES
WATER PROTECTION PROGRAM
OPERATING PERMITS SECTION - DOMESTIC WASTEWATER UNIT
(573) 751-5827
Kyle.Willenburg@dnr.mo.gov**

Appendices

APPENDIX – RPA RESULTS:

Parameter	CMC*	RWC Acute*	CCC*	RWC Chronic*	n**	Range max/min	CV***	MF	RP Yes/No
Total Ammonia as Nitrogen (Summer) mg/L	12.1	13.57	1.5	13.57	16	4.6/0.13	0.75	2.95	YES
Total Ammonia as Nitrogen (Winter) mg/L	12.1	0.00	3.1	0.00	0	0/0	0.60	0.00	NO

N/A – Not Applicable

* - Units are (µg/L) unless otherwise noted.

** - If the number of samples is 10 or greater, then the CV value must be used in the WQBEL for the applicable constituent.

*** - Coefficient of Variation (CV) is calculated by dividing the Standard Deviation of the sample set by the Mean of the same sample set.

RWC – Receiving Water Concentration. It is the concentration of a toxicant or the parameter toxicity in the receiving water after mixing (if applicable).

n – Is the number of samples.

MF – Multiplying Factor. 99% Confidence Level and 99% Probability Basis.

RP – Reasonable Potential. It is where an effluent is projected or calculated to cause an excursion above a water quality standard based on a number of factors including, as a minimum, the four factors listed in 40 CFR 122.44(d)(1)(ii).

Reasonable Potential Analysis is conducted as per (TSD, EPA/505/2-90-001, Section 3.3.2). A more detailed version including calculations of this RPA is available upon request.

APPENDIX – FACILITY MAP





STANDARD CONDITIONS FOR NPDES PERMITS
ISSUED BY
THE MISSOURI DEPARTMENT OF NATURAL RESOURCES
MISSOURI CLEAN WATER COMMISSION
REVISED
AUGUST 1, 2014

These Standard Conditions incorporate permit conditions as required by 40 CFR 122.41 or other applicable state statutes or regulations. These minimum conditions apply unless superseded by requirements specified in the permit.

Part I – General Conditions

Section A – Sampling, Monitoring, and Recording

1. **Sampling Requirements.**
 - a. Samples and measurements taken for the purpose of monitoring shall be representative of the monitored activity.
 - b. All samples shall be taken at the outfall(s) or Missouri Department of Natural Resources (Department) approved sampling location(s), and unless specified, before the effluent joins or is diluted by any other body of water or substance.
2. **Monitoring Requirements.**
 - a. Records of monitoring information shall include:
 - i. The date, exact place, and time of sampling or measurements;
 - ii. The individual(s) who performed the sampling or measurements;
 - iii. The date(s) analyses were performed;
 - iv. The individual(s) who performed the analyses;
 - v. The analytical techniques or methods used; and
 - vi. The results of such analyses.
 - b. If the permittee monitors any pollutant more frequently than required by the permit at the location specified in the permit using test procedures approved under 40 CFR Part 136, or another method required for an industry-specific waste stream under 40 CFR subchapters N or O, the results of such monitoring shall be included in the calculation and reported to the Department with the discharge monitoring report data (DMR) submitted to the Department pursuant to Section B, paragraph 7.
3. **Sample and Monitoring Calculations.** Calculations for all sample and monitoring results which require averaging of measurements shall utilize an arithmetic mean unless otherwise specified in the permit.
4. **Test Procedures.** The analytical and sampling methods used shall conform to the reference methods listed in 10 CSR 20-7.015 unless alternates are approved by the Department. The facility shall use sufficiently sensitive analytical methods for detecting, identifying, and measuring the concentrations of pollutants. The facility shall ensure that the selected methods are able to quantify the presence of pollutants in a given discharge at concentrations that are low enough to determine compliance with Water Quality Standards in 10 CSR 20-7.031 or effluent limitations unless provisions in the permit allow for other alternatives. A method is “sufficiently sensitive” when; 1) the method minimum level is at or below the level of the applicable water quality criterion for the pollutant or, 2) the method minimum level is above the applicable water quality criterion, but the amount of pollutant in a facility’s discharge is high enough that the method detects and quantifies the level of pollutant in the discharge, or 3) the method has the lowest minimum level of the analytical methods approved under 10 CSR 20-7.015. These methods are also required for parameters that are listed as monitoring only, as the data collected may be used to determine if limitations need to be established. A permittee is responsible for working with their contractors to ensure that the analysis performed is sufficiently sensitive.
5. **Record Retention.** Except for records of monitoring information required by the permit related to the permittee’s sewage sludge use and disposal activities, which shall be retained for a period of at least five (5) years (or longer as required by 40 CFR part 503), the permittee shall retain records of all monitoring information, including all calibration and maintenance records and all original strip chart recordings for continuous monitoring instrumentation, copies of all reports required by the permit, and records of all data used to complete the application for the permit, for a period of at least three (3) years from the date of the sample, measurement, report or application. This period may be extended by request of the Department at any time.

6. **Illegal Activities.**
 - a. The Federal Clean Water Act provides that any person who falsifies, tampers with, or knowingly renders inaccurate any monitoring device or method required to be maintained under the permit shall, upon conviction, be punished by a fine of not more than \$10,000, or by imprisonment for not more than two (2) years, or both. If a conviction of a person is for a violation committed after a first conviction of such person under this paragraph, punishment is a fine of not more than \$20,000 per day of violation, or by imprisonment of not more than four (4) years, or both.
 - b. The Missouri Clean Water Law provides that any person or who falsifies, tampers with, or knowingly renders inaccurate any monitoring device or method required to be maintained pursuant to sections 644.006 to 644.141 shall, upon conviction, be punished by a fine of not more than \$10,000, or by imprisonment for not more than six (6) months, or by both. Second and successive convictions for violation under this paragraph by any person shall be punished by a fine of not more than \$50,000 per day of violation, or by imprisonment for not more than two (2) years, or both.

Section B – Reporting Requirements

1. **Planned Changes.**
 - a. The permittee shall give notice to the Department as soon as possible of any planned physical alterations or additions to the permitted facility when:
 - i. The alteration or addition to a permitted facility may meet one of the criteria for determining whether a facility is a new source in 40 CFR 122.29(b); or
 - ii. The alteration or addition could significantly change the nature or increase the quantity of pollutants discharged. This notification applies to pollutants which are subject neither to effluent limitations in the permit, nor to notification requirements under 40 CFR 122.42;
 - iii. The alteration or addition results in a significant change in the permittee’s sludge use or disposal practices, and such alteration, addition, or change may justify the application of permit conditions that are different from or absent in the existing permit, including notification of additional use or disposal sites not reported during the permit application process or not reported pursuant to an approved land application plan;
 - iv. Any facility expansions, production increases, or process modifications which will result in a new or substantially different discharge or sludge characteristics must be reported to the Department 60 days before the facility or process modification begins. Notification may be accomplished by application for a new permit. If the discharge does not violate effluent limitations specified in the permit, the facility is to submit a notice to the Department of the changed discharge at least 30 days before such changes. The Department may require a construction permit and/or permit modification as a result of the proposed changes at the facility.
2. **Non-compliance Reporting.**
 - a. The permittee shall report any noncompliance which may endanger health or the environment. Relevant information shall be provided orally or via the current electronic method approved by the Department, within 24 hours from the time the permittee becomes aware of the circumstances, and shall be reported to the appropriate Regional Office during normal business hours or the Environmental Emergency Response hotline at 573-634-2436 outside of normal business hours. A written submission shall also be provided within five (5) business days of the time the permittee becomes aware of the circumstances. The written submission shall contain a description of the noncompliance and its cause; the period of noncompliance, including exact dates and times, and if the noncompliance has not been corrected, the anticipated time it is expected to continue; and steps taken or planned to reduce, eliminate, and prevent reoccurrence of the noncompliance.



STANDARD CONDITIONS FOR NPDES PERMITS
ISSUED BY
THE MISSOURI DEPARTMENT OF NATURAL RESOURCES
MISSOURI CLEAN WATER COMMISSION
REVISED
AUGUST 1, 2014

- b. The following shall be included as information which must be reported within 24 hours under this paragraph.
 - i. Any unanticipated bypass which exceeds any effluent limitation in the permit.
 - ii. Any upset which exceeds any effluent limitation in the permit.
 - iii. Violation of a maximum daily discharge limitation for any of the pollutants listed by the Department in the permit required to be reported within 24 hours.
 - c. The Department may waive the written report on a case-by-case basis for reports under paragraph 2. b. of this section if the oral report has been received within 24 hours.
3. **Anticipated Noncompliance.** The permittee shall give advance notice to the Department of any planned changes in the permitted facility or activity which may result in noncompliance with permit requirements. The notice shall be submitted to the Department 60 days prior to such changes or activity.
 4. **Compliance Schedules.** Reports of compliance or noncompliance with, or any progress reports on, interim and final requirements contained in any compliance schedule of the permit shall be submitted no later than 14 days following each schedule date. The report shall provide an explanation for the instance of noncompliance and a proposed schedule or anticipated date, for achieving compliance with the compliance schedule requirement.
 5. **Other Noncompliance.** The permittee shall report all instances of noncompliance not reported under paragraphs 2, 3, and 6 of this section, at the time monitoring reports are submitted. The reports shall contain the information listed in paragraph 2. a. of this section.
 6. **Other Information.** Where the permittee becomes aware that it failed to submit any relevant facts in a permit application, or submitted incorrect information in a permit application or in any report to the Department, it shall promptly submit such facts or information.
 7. **Discharge Monitoring Reports.**
 - a. Monitoring results shall be reported at the intervals specified in the permit.
 - b. Monitoring results must be reported to the Department via the current method approved by the Department, unless the permittee has been granted a waiver from using the method. If the permittee has been granted a waiver, the permittee must use forms provided by the Department.
 - c. Monitoring results shall be reported to the Department no later than the 28th day of the month following the end of the reporting period.
- b. Notice.
 - i. Anticipated bypass. If the permittee knows in advance of the need for a bypass, it shall submit prior notice, if possible at least 10 days before the date of the bypass.
 - ii. Unanticipated bypass. The permittee shall submit notice of an unanticipated bypass as required in Section B – Reporting Requirements, paragraph 5 (24-hour notice).
 - c. Prohibition of bypass.
 - i. Bypass is prohibited, and the Department may take enforcement action against a permittee for bypass, unless:
 1. Bypass was unavoidable to prevent loss of life, personal injury, or severe property damage;
 2. There were no feasible alternatives to the bypass, such as the use of auxiliary treatment facilities, retention of untreated wastes, or maintenance during normal periods of equipment downtime. This condition is not satisfied if adequate back-up equipment should have been installed in the exercise of reasonable engineering judgment to prevent a bypass which occurred during normal periods of equipment downtime or preventive maintenance; and
 3. The permittee submitted notices as required under paragraph 2. b. of this section.
 - ii. The Department may approve an anticipated bypass, after considering its adverse effects, if the Department determines that it will meet the three (3) conditions listed above in paragraph 2. c. i. of this section.
3. **Upset Requirements.**
 - a. Effect of an upset. An upset constitutes an affirmative defense to an action brought for noncompliance with such technology based permit effluent limitations if the requirements of paragraph 3. b. of this section are met. No determination made during administrative review of claims that noncompliance was caused by upset, and before an action for noncompliance, is final administrative action subject to judicial review.
 - b. Conditions necessary for a demonstration of upset. A permittee who wishes to establish the affirmative defense of upset shall demonstrate, through properly signed, contemporaneous operating logs, or other relevant evidence that:
 - i. An upset occurred and that the permittee can identify the cause(s) of the upset;
 - ii. The permitted facility was at the time being properly operated; and
 - iii. The permittee submitted notice of the upset as required in Section B – Reporting Requirements, paragraph 2. b. ii. (24-hour notice).
 - iv. The permittee complied with any remedial measures required under Section D – Administrative Requirements, paragraph 4.
 - c. Burden of proof. In any enforcement proceeding, the permittee seeking to establish the occurrence of an upset has the burden of proof.

Section C – Bypass/Upset Requirements

1. **Definitions.**
 - a. *Bypass*: the intentional diversion of waste streams from any portion of a treatment facility, except in the case of blending.
 - b. *Severe Property Damage*: substantial physical damage to property, damage to the treatment facilities which causes them to become inoperable, or substantial and permanent loss of natural resources which can reasonably be expected to occur in the absence of a bypass. Severe property damage does not mean economic loss caused by delays in production.
 - c. *Upset*: an exceptional incident in which there is unintentional and temporary noncompliance with technology based permit effluent limitations because of factors beyond the reasonable control of the permittee. An upset does not include noncompliance to the extent caused by operational error, improperly designed treatment facilities, inadequate treatment facilities, lack of preventive maintenance, or careless or improper operation.
2. **Bypass Requirements.**
 - a. Bypass not exceeding limitations. The permittee may allow any bypass to occur which does not cause effluent limitations to be exceeded, but only if it also is for essential maintenance to assure efficient operation. These bypasses are not subject to the provisions of paragraphs 2. b. and 2. c. of this section.

Section D – Administrative Requirements

1. **Duty to Comply.** The permittee must comply with all conditions of this permit. Any permit noncompliance constitutes a violation of the Missouri Clean Water Law and Federal Clean Water Act and is grounds for enforcement action; for permit termination, revocation and reissuance, or modification; or denial of a permit renewal application.
 - a. The permittee shall comply with effluent standards or prohibitions established under section 307(a) of the Federal Clean Water Act for toxic pollutants and with standards for sewage sludge use or disposal established under section 405(d) of the CWA within the time provided in the regulations that establish these standards or prohibitions or standards for sewage sludge use or disposal, even if the permit has not yet been modified to incorporate the requirement.
 - b. The Federal Clean Water Act provides that any person who violates section 301, 302, 306, 307, 308, 318 or 405 of the Act, or any permit condition or limitation implementing any such sections in a permit issued under section 402, or any requirement imposed in a pretreatment program approved under sections 402(a)(3) or 402(b)(8) of the Act, is subject to a civil penalty not to exceed \$25,000 per day for each violation. The Federal Clean Water Act provides that any person who negligently violates sections 301, 302, 306, 307, 308, 318, or 405 of the Act, or any condition or limitation implementing any of such sections in a permit issued under section 402 of the Act, or any requirement



STANDARD CONDITIONS FOR NPDES PERMITS
ISSUED BY
THE MISSOURI DEPARTMENT OF NATURAL RESOURCES
MISSOURI CLEAN WATER COMMISSION
REVISED
AUGUST 1, 2014

imposed in a pretreatment program approved under section 402(a)(3) or 402(b)(8) of the Act, is subject to criminal penalties of \$2,500 to \$25,000 per day of violation, or imprisonment of not more than one (1) year, or both. In the case of a second or subsequent conviction for a negligent violation, a person shall be subject to criminal penalties of not more than \$50,000 per day of violation, or by imprisonment of not more than two (2) years, or both. Any person who knowingly violates such sections, or such conditions or limitations is subject to criminal penalties of \$5,000 to \$50,000 per day of violation, or imprisonment for not more than three (3) years, or both. In the case of a second or subsequent conviction for a knowing violation, a person shall be subject to criminal penalties of not more than \$100,000 per day of violation, or imprisonment of not more than six (6) years, or both. Any person who knowingly violates section 301, 302, 303, 306, 307, 308, 318 or 405 of the Act, or any permit condition or limitation implementing any of such sections in a permit issued under section 402 of the Act, and who knows at that time that he thereby places another person in imminent danger of death or serious bodily injury, shall, upon conviction, be subject to a fine of not more than \$250,000 or imprisonment of not more than 15 years, or both. In the case of a second or subsequent conviction for a knowing endangerment violation, a person shall be subject to a fine of not more than \$500,000 or by imprisonment of not more than 30 years, or both. An organization, as defined in section 309(c)(3)(B)(iii) of the CWA, shall, upon conviction of violating the imminent danger provision, be subject to a fine of not more than \$1,000,000 and can be fined up to \$2,000,000 for second or subsequent convictions.

- c. Any person may be assessed an administrative penalty by the EPA Director for violating section 301, 302, 306, 307, 308, 318 or 405 of this Act, or any permit condition or limitation implementing any of such sections in a permit issued under section 402 of this Act. Administrative penalties for Class I violations are not to exceed \$10,000 per violation, with the maximum amount of any Class I penalty assessed not to exceed \$25,000. Penalties for Class II violations are not to exceed \$10,000 per day for each day during which the violation continues, with the maximum amount of any Class II penalty not to exceed \$125,000.
 - d. It is unlawful for any person to cause or permit any discharge of water contaminants from any water contaminant or point source located in Missouri in violation of sections 644.006 to 644.141 of the Missouri Clean Water Law, or any standard, rule or regulation promulgated by the commission. In the event the commission or the director determines that any provision of sections 644.006 to 644.141 of the Missouri Clean Water Law or standard, rules, limitations or regulations promulgated pursuant thereto, or permits issued by, or any final abatement order, other order, or determination made by the commission or the director, or any filing requirement pursuant to sections 644.006 to 644.141 of the Missouri Clean Water Law or any other provision which this state is required to enforce pursuant to any federal water pollution control act, is being, was, or is in imminent danger of being violated, the commission or director may cause to have instituted a civil action in any court of competent jurisdiction for the injunctive relief to prevent any such violation or further violation or for the assessment of a penalty not to exceed \$10,000 per day for each day, or part thereof, the violation occurred and continues to occur, or both, as the court deems proper. Any person who willfully or negligently commits any violation in this paragraph shall, upon conviction, be punished by a fine of not less than \$2,500 nor more than \$25,000 per day of violation, or by imprisonment for not more than one year, or both. Second and successive convictions for violation of the same provision of this paragraph by any person shall be punished by a fine of not more than \$50,000 per day of violation, or by imprisonment for not more than two (2) years, or both.
2. **Duty to Reapply.**
- a. If the permittee wishes to continue an activity regulated by this permit after the expiration date of this permit, the permittee must apply for and obtain a new permit.
 - b. A permittee with a currently effective site-specific permit shall submit an application for renewal at least 180 days before the expiration date of the existing permit, unless permission for a later date has been granted by the Department. (The Department shall not grant permission

for applications to be submitted later than the expiration date of the existing permit.)

- c. A permittee with currently effective general permit shall submit an application for renewal at least 30 days before the existing permit expires, unless the permittee has been notified by the Department that an earlier application must be made. The Department may grant permission for a later submission date. (The Department shall not grant permission for applications to be submitted later than the expiration date of the existing permit.)
3. **Need to Halt or Reduce Activity Not a Defense.** It shall not be a defense for a permittee in an enforcement action that it would have been necessary to halt or reduce the permitted activity in order to maintain compliance with the conditions of this permit.
4. **Duty to Mitigate.** The permittee shall take all reasonable steps to minimize or prevent any discharge or sludge use or disposal in violation of this permit which has a reasonable likelihood of adversely affecting human health or the environment.
5. **Proper Operation and Maintenance.** The permittee shall at all times properly operate and maintain all facilities and systems of treatment and control (and related appurtenances) which are installed or used by the permittee to achieve compliance with the conditions of this permit. Proper operation and maintenance also includes adequate laboratory controls and appropriate quality assurance procedures. This provision requires the operation of back-up or auxiliary facilities or similar systems which are installed by a permittee only when the operation is necessary to achieve compliance with the conditions of the permit.
6. **Permit Actions.**
- a. Subject to compliance with statutory requirements of the Law and Regulations and applicable Court Order, this permit may be modified, suspended, or revoked in whole or in part during its term for cause including, but not limited to, the following:
 - i. Violations of any terms or conditions of this permit or the law;
 - ii. Having obtained this permit by misrepresentation or failure to disclose fully any relevant facts;
 - iii. A change in any circumstances or conditions that requires either a temporary or permanent reduction or elimination of the authorized discharge; or
 - iv. Any reason set forth in the Law or Regulations.
 - b. The filing of a request by the permittee for a permit modification, revocation and reissuance, or termination, or a notification of planned changes or anticipated noncompliance does not stay any permit condition.
7. **Permit Transfer.**
- a. Subject to 10 CSR 20-6.010, an operating permit may be transferred upon submission to the Department of an application to transfer signed by the existing owner and the new owner, unless prohibited by the terms of the permit. Until such time the permit is officially transferred, the original permittee remains responsible for complying with the terms and conditions of the existing permit.
 - b. The Department may require modification or revocation and reissuance of the permit to change the name of the permittee and incorporate such other requirements as may be necessary under the Missouri Clean Water Law or the Federal Clean Water Act.
 - c. The Department, within 30 days of receipt of the application, shall notify the new permittee of its intent to revoke or reissue or transfer the permit.
8. **Toxic Pollutants.** The permittee shall comply with effluent standards or prohibitions established under section 307(a) of the Federal Clean Water Act for toxic pollutants and with standards for sewage sludge use or disposal established under section 405(d) of the Federal Clean Water Act within the time provided in the regulations that establish these standards or prohibitions or standards for sewage sludge use or disposal, even if the permit has not yet been modified to incorporate the requirement.
9. **Property Rights.** This permit does not convey any property rights of any sort, or any exclusive privilege.



STANDARD CONDITIONS FOR NPDES PERMITS
ISSUED BY
THE MISSOURI DEPARTMENT OF NATURAL RESOURCES
MISSOURI CLEAN WATER COMMISSION
REVISED
AUGUST 1, 2014

10. **Duty to Provide Information.** The permittee shall furnish to the Department, within a reasonable time, any information which the Department may request to determine whether cause exists for modifying, revoking and reissuing, or terminating this permit or to determine compliance with this permit. The permittee shall also furnish to the Department upon request, copies of records required to be kept by this permit.
11. **Inspection and Entry.** The permittee shall allow the Department, or an authorized representative (including an authorized contractor acting as a representative of the Department), upon presentation of credentials and other documents as may be required by law, to:
 - a. Enter upon the permittee's premises where a regulated facility or activity is located or conducted, or where records must be kept under the conditions of the permit;
 - b. Have access to and copy, at reasonable times, any records that must be kept under the conditions of this permit;
 - c. Inspect at reasonable times any facilities, equipment (including monitoring and control equipment), practices, or operations regulated or required under this permit; and
 - d. Sample or monitor at reasonable times, for the purposes of assuring permit compliance or as otherwise authorized by the Federal Clean Water Act or Missouri Clean Water Law, any substances or parameters at any location.
12. **Closure of Treatment Facilities.**
 - a. Persons who cease operation or plan to cease operation of waste, wastewater, and sludge handling and treatment facilities shall close the facilities in accordance with a closure plan approved by the Department.
 - b. Operating Permits under 10 CSR 20-6.010 or under 10 CSR 20-6.015 are required until all waste, wastewater, and sludges have been disposed of in accordance with the closure plan approved by the Department and any disturbed areas have been properly stabilized. Disturbed areas will be considered stabilized when perennial vegetation, pavement, or structures using permanent materials cover all areas that have been disturbed. Vegetative cover, if used, shall be at least 70% plant density over 100% of the disturbed area.
13. **Signatory Requirement.**
 - a. All permit applications, reports required by the permit, or information requested by the Department shall be signed and certified. (See 40 CFR 122.22 and 10 CSR 20-6.010)
 - b. The Federal Clean Water Act provides that any person who knowingly makes any false statement, representation, or certification in any record or other document submitted or required to be maintained under this permit, including monitoring reports or reports of compliance or non-compliance shall, upon conviction, be punished by a fine of not more than \$10,000 per violation, or by imprisonment for not more than six (6) months per violation, or by both.
 - c. The Missouri Clean Water Law provides that any person who knowingly makes any false statement, representation or certification in any application, record, report, plan, or other document filed or required to be maintained pursuant to sections 644.006 to 644.141 shall, upon conviction, be punished by a fine of not more than ten thousand dollars, or by imprisonment for not more than six months, or by both.
14. **Severability.** The provisions of the permit are severable, and if any provision of the permit, or the application of any provision of the permit to any circumstance, is held invalid, the application of such provision to other circumstances, and the remainder of the permit, shall not be affected thereby.

STANDARD CONDITIONS FOR NPDES PERMITS
ISSUED BY
THE MISSOURI DEPARTMENT OF NATURAL RESOURCES
MISSOURI CLEAN WATER COMMISSION
August 1, 2019

PART III – BIOSOLIDS AND SLUDGE FROM DOMESTIC TREATMENT FACILITIES

SECTION A – GENERAL REQUIREMENTS

1. PART III Standard Conditions pertain to biosolids and sludge requirements under the Missouri Clean Water Law and regulations for domestic and municipal wastewater and also incorporates federal sludge disposal requirements under 40 CFR Part 503 for domestic wastewater. The Environmental Protection Agency (EPA) has principal authority for permitting and enforcement of the federal sludge regulations under 40 CFR Part 503 for domestic biosolids and sludge.
2. PART III Standard Conditions apply only to biosolids and sludge generated at domestic wastewater treatment facilities, including public owned treatment works (POTW) and privately owned facilities.
3. Biosolids and Sludge Use and Disposal Practices:
 - a. The permittee is authorized to operate the biosolids and sludge generating, treatment, storage, use, and disposal facilities listed in the facility description of this permit.
 - b. The permittee shall not exceed the design sludge/biosolids volume listed in the facility description and shall not use biosolids or sludge disposal methods that are not listed in the facility description, without prior approval of the permitting authority.
 - c. For facilities operating under general operating permits that incorporate Standard Conditions PART III, the facility is authorized to operate the biosolids and sludge generating, treatment, storage, use and disposal facilities identified in the original operating permit application, subsequent renewal applications or subsequent written approval by the department.
4. Biosolids or Sludge Received from other Facilities:
 - a. Permittees may accept domestic wastewater biosolids or sludge from other facilities as long as the permittee's design sludge capacity is not exceeded and the treatment facility performance is not impaired.
 - b. The permittee shall obtain a signed statement from the biosolids or sludge generator or hauler that certifies the type and source of the sludge
5. Nothing in this permit precludes the initiation of legal action under local laws, except to the extent local laws are preempted by state law.
6. This permit does not preclude the enforcement of other applicable environmental regulations such as odor emissions under the Missouri Air Pollution Control Law and regulations.
7. This permit may (after due process) be modified, or alternatively revoked and reissued, to comply with any applicable biosolids or sludge disposal standard or limitation issued or approved under Section 405(d) of the Clean Water Act or under Chapter 644 RSMo.
8. In addition to Standard Conditions PART III, the Department may include biosolids and sludge limitations in the special conditions portion or other sections of a site specific permit.
9. Exceptions to Standard Conditions PART III may be authorized on a case-by-case basis by the Department, as follows:
 - a. The Department may modify a site-specific permit following permit notice provisions as applicable under 10 CSR 20-6.020, 40 CFR § 124.10, and 40 CFR § 501.15(a)(2)(ix)(E).
 - b. Exceptions cannot be granted where prohibited by the federal sludge regulations under 40 CFR Part 503.

SECTION B – DEFINITIONS

1. Best Management Practices are practices to prevent or reduce the pollution of waters of the state and include agronomic loading rates (nitrogen based), soil conservation practices, spill prevention and maintenance procedures and other site restrictions.
2. Biosolids means organic fertilizer or soil amendment produced by the treatment of domestic wastewater sludge.
3. Biosolids land application facility is a facility where biosolids are spread onto the land at agronomic rates for production of food, feed or fiber. The facility includes any structures necessary to store the biosolids until soil, weather, and crop conditions are favorable for land application.
4. Class A biosolids means a material that has met the Class A pathogen reduction requirements or equivalent treatment by a Process to Further Reduce Pathogens (PFRP) in accordance with 40 CFR Part 503.
5. Class B biosolids means a material that has met the Class B pathogen reduction requirements or equivalent treatment by a Process to Significantly Reduce Pathogens (PSRP) in accordance with 40 CFR Part 503.
6. Domestic wastewater means wastewater originating from the sanitary conveniences of residences, commercial buildings, factories and institutions; or co-mingled sanitary and industrial wastewater processed by a (POTW) or a privately owned facility.
7. Feed crops are crops produced primarily for consumption by animals.
8. Fiber crops are crops such as flax and cotton.
9. Food crops are crops consumed by humans which include, but is not limited to, fruits, vegetables and tobacco.
10. Industrial wastewater means any wastewater, also known as process wastewater, not defined as domestic wastewater. Per 40 CFR Part 122.2, process wastewater means any water which, during manufacturing or processing, comes into direct contact with or results from the production or use of any raw material, intermediate product, finished product, byproduct, or waste product. Land application of industrial wastewater, residuals or sludge is not authorized by Standard Conditions PART III.
11. Mechanical treatment plants are wastewater treatment facilities that use mechanical devices to treat wastewater, including, sand filters, extended aeration, activated sludge, contact stabilization, trickling filters, rotating biological contact systems, and other similar facilities. It does not include wastewater treatment lagoons or constructed wetlands for wastewater treatment.
12. Plant Available Nitrogen (PAN) is nitrogen that will be available to plants during the growing seasons after biosolids application.
13. Public contact site is land with a high potential for contact by the public. This includes, but is not limited to, public parks, ball fields, cemeteries, plant nurseries, turf farms, and golf courses.
14. Sludge is the solid, semisolid, or liquid residue removed during the treatment of wastewater. Sludge includes septage removed from septic tanks or equivalent facilities. Sludge does not include carbon coal byproducts (CCBs), sewage sludge incinerator ash, or grit/screenings generated during preliminary treatment of domestic sewage.
15. Sludge lagoon is part of a mechanical wastewater treatment facility. A sludge lagoon is an earthen or concrete lined basin that receives sludge that has been removed from a wastewater treatment facility. It does not include a wastewater treatment lagoon or sludge treatment units that are not a part of a mechanical wastewater treatment facility.
16. Septage is the sludge pumped from residential septic tanks, cesspools, portable toilets, Type III marine sanitation devices, or similar treatment works such as sludge holding structures from residential wastewater treatment facilities with design populations of less than 150 people. Septage does not include grease removed from grease traps at a restaurant or material removed from septic tanks and other similar treatment works that have received industrial wastewater. The standard for biosolids from septage is different from other sludges. See Section H for more information.

SECTION C – MECHANICAL WASTEWATER TREATMENT FACILITIES

1. Biosolids or sludge shall be routinely removed from wastewater treatment facilities and handled according to the permit facility description and the requirements of Standard Conditions PART III or in accordance with Section A.3.c., above.
2. The permittee shall operate storage and treatment facilities, as defined by Section 644.016(23), RSMo, so that there is no biosolids or sludge discharged to waters of the state. Agricultural storm water discharges are exempt under the provisions of Section 644.059, RSMo.
3. Mechanical treatment plants shall have separate biosolids or sludge storage compartments in accordance with 10 CSR 20, Chapter 8. Failure to remove biosolids or sludge from these storage compartments on the required design schedule is a violation of this permit.

SECTION D – BIOSOLIDS OR SLUDGE DISPOSED AT OTHER TREATMENT FACILITY OR BY CONTRACT HAULER

1. Permittees that use contract haulers, under the authority of their operating permit, to dispose of biosolids or sludge, are responsible for compliance with all the terms of this permit. Contract haulers that assume the responsibility of the final disposal of biosolids or sludge, including biosolids land application, must obtain a Missouri State Operating Permit unless the hauler transports the biosolids or sludge to another permitted treatment facility.
2. Testing of biosolids or sludge, other than total solids content, is not required if biosolids or sludge are hauled to a permitted wastewater treatment facility, unless it is required by the accepting facility.

SECTION E – INCINERATION OF SLUDGE

1. Please be aware that sludge incineration facilities may be subject to the requirements of 40 CFR Part 503 Subpart E, Missouri Air Conservation Commission regulations under 10 CSR 10, and solid waste management regulations under 10 CSR 80, as applicable.
2. Permittee may be authorized under the facility description of this permit to store incineration ash in lagoons or ash ponds. This permit does not authorize the disposal of incineration ash. Incineration ash shall be disposed in accordance with 10 CSR 80; or, if the ash is determined to be hazardous, with 10 CSR 25.
3. In addition to normal sludge monitoring, incineration facilities shall report the following as part of the annual report, mass of sludge incinerated and mass of ash generated. Permittee shall also provide the name of the ash disposal facility and permit number if applicable.

SECTION F – SURFACE DISPOSAL SITES AND BIOSOLIDS AND SLUDGE LAGOONS

1. Please be aware that surface disposal sites of biosolids or sludge from wastewater treatment facilities may be subject to other laws including the requirements in 40 CFR Part 503 Subpart C, Missouri Air Conservation Commission regulations under 10 CSR 10, and solid waste management regulations under 10 CSR 80, as applicable.
2. Biosolids or sludge storage lagoons are temporary facilities and are not required to obtain a permit as a solid waste management facility under 10 CSR 80. In order to maintain biosolids or sludge storage lagoons as storage facilities, accumulated biosolids or sludge must be removed routinely, but not less than once every two years unless an alternate schedule is approved in the permit. The amount of biosolids or sludge removed will be dependent on biosolids or sludge generation and accumulation in the facility. Enough biosolids or sludge must be removed to maintain adequate storage capacity in the facility.
 - a. In order to avoid damage to the lagoon seal during cleaning, the permittee may leave a layer of biosolids or sludge on the bottom of the lagoon, upon prior approval of the Department; or
 - b. Permittee shall close the lagoon in accordance with Section I.

SECTION G – LAND APPLICATION OF BIOSOLIDS

1. The permittee shall not land apply biosolids unless land application is authorized in the facility description, the special conditions of the issued NPDES permit, or in accordance with Section A.3.c., above.
2. This permit only authorizes “Class A” or “Class B” biosolids derived from domestic wastewater to be land applied onto grass land, crop land, timber, or other similar agricultural or silviculture lands at rates suitable for beneficial use as organic fertilizer and soil conditioner.
3. Class A Biosolids Requirements: Biosolids shall meet Class A requirements for application to public contact sites, residential lawns, home gardens or sold and/or given away in a bag or other container.
4. Class B biosolids that are land applied to agricultural and public contact sites shall comply with the following restrictions:
 - a. Food crops that touch the biosolids/soil mixture and are totally above the land surface shall not be harvested for 14 months after application of biosolids.
 - b. Food crops below the surface of the land shall not be harvested for 20 months after application of biosolids when the biosolids remain on the land surface for four months or longer prior to incorporation into the soil.
 - c. Food crops below the surface of the land shall not be harvested for 38 months after application of biosolids when the biosolids remain on the land surface for less than four months prior to incorporation into the soil.
 - d. Animal grazing shall not be allowed for 30 days after application of biosolids.
 - e. Food crops, feed crops, and fiber crops shall not be harvested for 30 days after application of biosolids.
 - f. Turf shall not be harvested for one year after application of biosolids if used for lawns or high public contact sites in close proximity to populated areas such as city parks or golf courses.
 - g. After Class B biosolids have been land applied to public contact sites with high potential for public exposure, as defined in 40 CFR § 503.31, such as city parks or golf courses, access must be restricted for 12 months.
 - h. After Class B biosolids have been land applied public contact sites with low potential for public exposure as defined in 40 CFR § 503.31, such as a rural land application or reclamation sites, access must be restricted for 30 days.
5. Pollutant limits
 - a. Biosolids shall be monitored to determine the quality for regulated pollutants listed in Table 1, below. Limits for any pollutants not listed below may be established in the permit.
 - b. The number of samples taken is directly related to the amount of biosolids or sludge produced by the facility (See Section J, below). Samples should be taken only during land application periods. When necessary, it is permissible to mix biosolids with lower concentrations of biosolids as well as other suitable Department approved material to achieve pollutant concentration below those identified in Table 1, below.
 - c. Table 1 gives the ceiling concentration for biosolids. Biosolids which exceed the concentrations in Table 1 may not be land applied.

TABLE 1

Biosolids ceiling concentration	
Pollutant	Milligrams per kilogram dry weight
Arsenic	75
Cadmium	85
Copper	4,300
Lead	840
Mercury	57
Molybdenum	75
Nickel	420
Selenium	100
Zinc	7,500

- d. Table 2 below gives the low metal concentration for biosolids. Because of its higher quality, biosolids with pollutant concentrations below those listed in Table 2 can safely be applied to agricultural land, forest, public contact sites, lawns, home gardens or be given away without further analysis. Biosolids containing metals in concentrations above the low metals concentrations but below the ceiling concentration limits may be land applied but shall not exceed the annual loading rates in Table 3 and the cumulative loading rates in Table 4. The permittee is required to track pollutant loading onto application sites for parameters that have exceeded the low metal concentration limits.

TABLE 2

Biosolids Low Metal Concentration	
Pollutant	Milligrams per kilogram dry weight
Arsenic	41
Cadmium	39
Copper	1,500
Lead	300
Mercury	17
Nickel	420
Selenium	100
Zinc	2,800

- e. Annual pollutant loading rate.

Table 3

Biosolids Annual Loading Rate	
Pollutant	Kg/ha (lbs./ac) per year
Arsenic	2.0 (1.79)
Cadmium	1.9 (1.70)
Copper	75 (66.94)
Lead	15 (13.39)
Mercury	0.85 (0.76)
Nickel	21 (18.74)
Selenium	5.0 (4.46)
Zinc	140 (124.96)

- f. Cumulative pollutant loading rates.

Table 4

Biosolids Cumulative Pollutant Loading Rate	
Pollutant	Kg/ha (lbs./ac)
Arsenic	41 (37)
Cadmium	39 (35)
Copper	1500 (1339)
Lead	300 (268)
Mercury	17 (15)
Nickel	420 (375)
Selenium	100 (89)
Zinc	2800 (2499)

6. Best Management Practices. The permittee shall use the following best management practices during land application activities to prevent the discharge of biosolids to waters of the state.
- Biosolids shall not be applied to the land if it is likely to adversely affect a threatened or endangered species listed under § 4 of the Endangered Species Act or its designated critical habitat.
 - Apply biosolids only at the agronomic rate of nitrogen needed (see 5.c. of this section).
 - The applicator must document the Plant Available Nitrogen (PAN) loadings, available nitrogen in the soil, and crop

nitrogen removal when either of the following occurs: 1) When biosolids are greater than 50,000 mg/kgTN; or 2) When biosolids are land applied at an application rate greater than two dry tons per acre per year.

- i. PAN can be determined as follows:
(Nitrate + nitrite nitrogen) + (organic nitrogen x 0.2) + (ammonia nitrogen x volatilization factor¹).
¹ Volatilization factor is 0.7 for surface application and 1 for subsurface application. Alternative volatilization factors and mineralization rates can be utilized on a case-by-case basis.
- ii. Crop nutrient production/removal to be based on crop specific nitrogen needs and realistic yield goals. **NOTE:** There are a number of reference documents on the Missouri Department of Natural Resources website that are informative to implement best management practices in the proper management of biosolids, including crop specific nitrogen needs, realistic yields on a county by county basis and other supporting references.
- iii. Biosolids that are applied at agronomic rates shall not cause the annual pollutant loading rates identified in Table 3 to be exceeded.
- d. Buffer zones are as follows:
 - i. 300 feet of a water supply well, sinkhole, water supply reservoir or water supply intake in a stream;
 - ii. 300 feet of a losing stream, no discharge stream, stream stretches designated for whole body contact recreation, wild and scenic rivers, Ozark National Scenic Riverways or outstanding state resource waters as listed in the Water Quality Standards, 10 CSR 20-7.031;
 - iii. 150 feet of dwellings or public use areas;
 - iv. 100 feet (35 feet if biosolids application is down-gradient or the buffer zone is entirely vegetated) of lake, pond, wetlands or gaining streams (perennial or intermittent);
 - v. 50 feet of a property line. Buffer distances from property lines may be waived with written permission from neighboring property owner.
 - vi. For the application of dry, cake or liquid biosolids that are subsurface injected, buffer zones identified in 5.d.i. through 5.d.iii above, may be reduced to 100 feet. The buffer zone may be reduced to 35 feet if the buffer zone is permanently vegetated. Subsurface injection does not include methods or technology reflective of combination surface/shallow soil incorporation.
- e. Slope limitation for application sites are as follows:
 - i. For slopes less than or equal to 6 percent, no rate limitation;
 - ii. Applied to a slope 7 to 12 percent, the applicator may apply biosolids when soil conservation practices are used to meet the minimum erosion levels;
 - iii. Slopes > 12 percent, apply biosolids only when grass is vegetated and maintained with at least 80 percent ground cover at a rate of two dry tons per acre per year or less.
 - iv. Dry, cake or liquid biosolids that are subsurface injected, may be applied on slopes not to exceed 20 percent. Subsurface injection does not include the use of methods or technology reflective of combination surface/shallow soil incorporation.
- f. No biosolids may be land applied in an area that it is reasonably certain that pollutants will be transported into waters of the state.
- g. Biosolids may be land applied to sites with soil that are snow covered, frozen, or saturated with liquid when site restrictions or other controls are provided to prevent pollutants from being discharged to waters of the state during snowmelt or stormwater runoff. During inclement weather or unfavorable soil conditions use the following management practices:
 - i. A maximum field slope of 6% and a minimum 300 feet grass buffer between the application site and waters of the state. A 35 feet grass buffer may be utilized for the application of dry, cake or liquid biosolids that are subsurface injected. Subsurface injection does not include the use of methods or technology reflective of combination surface/shallow soil incorporation;
 - ii. A maximum field slope of 2% and 100 feet grass buffer between the application site and waters of the state. A 35 feet grass buffer may be used for the application of dry, cake or liquid biosolids that are subsurface injected. Subsurface injection does not include the use of methods or technology reflective of combination surface/shallow soil incorporation;
 - iii. Other best management practices approved by the Department.

SECTION H – SEPTAGE

1. Haulers that land apply septage must obtain a state permit. An operating permit is not required for septage haulers who transport septage to another permitted treatment facility for disposal.
2. Do not apply more than 30,000 gallons of septage per acre per year or the volume otherwise stipulated in the operating permit.
3. Septic tanks are designed to retain sludge for one to three years which will allow for a larger reduction in pathogens and vectors, as compared to mechanical treatment facilities.
4. Septage must comply with Class B biosolids regarding pathogen and vector attraction reduction requirements before it may be applied to crops, pastures or timberland. To meet required pathogen and vector reduction requirements, mix 50 pounds of hydrated lime for every 1,000 gallons of septage and maintain a septage pH of at least 12 pH standard units for 30 minutes or more prior to application.
5. Lime is to be added to the pump truck and not directly to the septic tanks, as lime would harm the beneficial bacteria of the septic tank.
6. As residential septage contains relatively low levels of metals, the testing of metals in septage is not required.

SECTION I– CLOSURE REQUIREMENTS

1. This section applies to all wastewater facilities (mechanical and lagoons) and sludge or biosolids storage and treatment facilities. It does not apply to land application sites.
2. Permittees of a domestic wastewater facility who plan to cease operation must obtain Department approval of a closure plan which addresses proper removal and disposal of all sludges and/or biosolids. Permittee must maintain this permit until the facility is closed in accordance with the approved closure plan per 10 CSR 20 – 6.010 and 10 CSR 20 – 6.015.
3. Biosolids or sludge that are left in place during closure of a lagoon or earthen structure or ash pond shall not exceed the agricultural loading rates as follows:
 - a. Biosolids and sludge shall meet the monitoring and land application limits for agricultural rates as referenced in Section G, above.
 - b. If a wastewater treatment lagoon has been in operation for 15 years or more without sludge removal, the sludge in the lagoon qualifies as a Class B biosolids with respect to pathogens due to anaerobic digestion, and testing for fecal coliform is not required. For other lagoons, testing for fecal coliform is required to show compliance with Class B biosolids limitations. In order to reach Class B biosolids requirements, fecal coliform must be less than 2,000,000 colony forming units or 2,000,000 most probable number. All fecal samples must be presented as geometric mean per gram.
 - c. The allowable nitrogen loading that may be left in the lagoon shall be based on the plant available nitrogen (PAN) loading. For a grass cover crop, the allowable PAN is 300 pounds/acre. Alternative, site-specific application rates may be included in the closure plan for department consideration.
 - i. PAN can be determined as follows:
$$(\text{Nitrate} + \text{nitrite nitrogen}) + (\text{organic nitrogen} \times 0.2) + (\text{ammonia nitrogen} \times \text{volatilization factor}^1).$$
¹ Volatilization factor is 0.7 for surface application and 1 for subsurface application. Alternative volatilization factors and mineralization rates can be utilized on a case-by-case basis.
4. Domestic wastewater treatment lagoons with a design treatment capacity less than or equal to 150 persons, are “similar treatment works” under the definition of septage. Therefore the sludge within the lagoons may be treated as septage during closure activities. See Section B, above. Under the septage category, residuals may be left in place as follows:
 - a. Testing for metals or fecal coliform is not required.
 - b. If the wastewater treatment lagoon has been in use for less than 15 years, mix lime with the sludge at a rate of 50 pounds of hydrated lime per 1000 gallons (134 cubic feet) of sludge.
 - c. The amount of sludge that may be left in the lagoon shall be based on the plant available nitrogen (PAN) loading. 100 dry tons/acre of sludge may be left in the basin without testing for nitrogen. If 100 dry tons/acre or more will be left in the lagoon, test for nitrogen and determine the PAN using the calculation above. Allowable PAN loading is 300 pounds/acre.
5. Biosolids or sludge left within the domestic lagoon shall be mixed with soil on at least a 1 to 1 ratio, and unless otherwise approved, the lagoon berm shall be demolished, and the site shall be graded and contain $\geq 70\%$ vegetative density over 100% of the site so as to avoid ponding of storm water and provide adequate surface water drainage without creating erosion. Alternative biosolids or sludge and soil mixing ratios may be included in the closure plan for department consideration.
6. Lagoon and earthen structure closure activities shall obtain a storm water permit for land disturbance activities that equal or exceed one acre in accordance with 10 CSR 20-6.200.
7. When closing a mechanical wastewater plant, all biosolids or sludge must be cleaned out and disposed of in accordance with the Department approved closure plan before the permit for the facility can be terminated.
 - a. Land must be stabilized which includes any grading, alternate use or fate upon approval by the Department, remediation, or other work that exposes sediment to stormwater per 10 CSR 20-6.200. The site shall be graded and contain $\geq 70\%$ vegetative density over 100% of the site, so as to avoid ponding of storm water and provide adequate

- surface water drainage without creating erosion.
- b. Hazardous Waste shall not be land applied or disposed during mechanical plant closures unless in accordance with Missouri Hazardous Waste Management Law and Regulations pursuant to 10 CSR 25.
 - c. After demolition of the mechanical plant, the site must only contain clean fill defined in Section 260.200.1(6) RSMo as uncontaminated soil, rock, sand, gravel, concrete, asphaltic concrete, cinderblocks, brick, minimal amounts of wood and metal, and inert solids as approved by rule or policy of the Department for fill, reclamation, or other beneficial use. Other solid wastes must be removed.
8. If biosolids or sludge from the domestic lagoon or mechanical treatment plant exceeds agricultural rates under Section G and/or I, a landfill permit or solid waste disposal permit must be obtained if the permittee chooses to seek authorization for on-site sludge disposal under the Missouri Solid Waste Management Law and regulations per 10 CSR 80, and the permittee must comply with the surface disposal requirements under 40 CFR Part 503, Subpart C.

SECTION J – MONITORING FREQUENCY

1. At a minimum, biosolids or sludge shall be tested for volume and percent total solids on a frequency that will accurately represent sludge quantities produced and disposed. Please see the table below.

TABLE 5

Biosolids or Sludge produced and disposed (Dry Tons per Year)	Monitoring Frequency (See Notes 1, and 2)		
	Metals, Pathogens and Vectors, Total Phosphorus, Total Potassium	Nitrogen TKN, Nitrogen PAN ¹	Priority Pollutants ²
319 or less	1/year	1 per month	1/year
320 to 1650	4/year	1 per month	1/year
1651 to 16,500	6/year	1 per month	1/year
16,501+	12/year	1 per month	1/year

¹ Calculate plant available nitrogen (PAN) when either of the following occurs: 1) when biosolids are greater than 50,000 mg/kg TN; or 2) when biosolids are land applied at an application rate greater than two dry tons per acre per year.

² Priority pollutants (40 CFR 122.21, Appendix D, Tables II and III) are required only for permit holders that must have a pre-treatment program. Monitoring requirements may be modified and incorporated into the operating permit by the Department on a case-by-case basis.

Note 1: Total solids: A grab sample of sludge shall be tested one per day during land application periods for percent total solids. This data shall be used to calculate the dry tons of sludge applied per acre.

Note 2: Table 5 is not applicable for incineration and permit holders that landfill their sludge.

2. Permittees that operate wastewater treatment lagoons, peak flow equalization basins, combined sewer overflow basins or biosolids or sludge lagoons that are cleaned out once a year or less, may choose to sample only when the biosolids or sludge is removed or the lagoon is closed. Test one composite sample for each 319 dry tons of biosolids or sludge removed from the lagoon during the reporting year or during lagoon closure. Composite sample must represent various areas at one-foot depth.
3. Additional testing may be required in the special conditions or other sections of the permit.
4. Biosolids and sludge monitoring shall be conducted in accordance with federal regulation 40 CFR § 503.8, Sampling and analysis.

SECTION K – RECORD KEEPING AND REPORTING REQUIREMENTS

1. The permittee shall maintain records on file at the facility for at least five years for the items listed in Standard Conditions PART III and any additional items in the Special Conditions section of this permit. This shall include dates when the biosolids or sludge facility is checked for proper operation, records of maintenance and repairs and other relevant information.
2. Reporting period
 - a. By February 19th of each year, applicable facilities shall submit an annual report for the previous calendar year period for all mechanical wastewater treatment facilities, sludge lagoons, and biosolids or sludge disposal facilities.
 - b. Permittees with wastewater treatment lagoons shall submit the above annual report only when biosolids or sludge are removed from the lagoon during the report period or when the lagoon is closed.
3. Report Form. The annual report shall be prepared on report forms provided by the Department or equivalent forms approved by the Department.
4. Reports shall be submitted as follows:
Major facilities, which are those serving 10,000 persons or more or with a design flow equal to or greater than 1 million gallons per day or that are required to have an approved pretreatment program, shall report to both the Department and EPA if the facility land applied, disposed of biosolids by surface disposal, or operated a sewage sludge incinerator. All other facilities shall maintain their biosolids or sludge records and keep them available to Department personnel upon request. State reports shall be submitted to the address listed as follows:

DNR regional or other applicable office listed in the
permit (see cover letter of permit)
ATTN: Sludge Coordinator

Reports to EPA must be electronically submitted online via the Central Data Exchange at: <https://cdx.epa.gov/> Additional information is available at: <https://www.epa.gov/biosolids/compliance-and-annual-reporting-guidance-about-clean-water-act-laws>

5. Annual report contents. The annual report shall include the following:
 - a. Biosolids and sludge testing performed. If testing was conducted at a greater frequency than what is required by the permit, all test results must be included in the report.
 - b. Biosolids or sludge quantity shall be reported as dry tons for the quantity produced and/or disposed.
 - c. Gallons and % solids data used to calculate the dry ton amounts.
 - d. Description of any unusual operating conditions.
 - e. Final disposal method, dates, and location, and person responsible for hauling and disposal.
 - i. This must include the name and address for the hauler and sludge facility. If hauled to a municipal wastewater treatment facility, sanitary landfill, or other approved treatment facility, give the name of that facility.
 - ii. Include a description of the type of hauling equipment used and the capacity in tons, gallons, or cubic feet.
 - f. Contract Hauler Activities:

If using a contract hauler, provide a copy of a signed contract from the contractor. Permittee shall require the contractor to supply information required under this permit for which the contractor is responsible. The permittee shall submit a signed statement from the contractor that he has complied with the standards contained in this permit, unless the contract hauler has a separate biosolids or sludge use permit.
 - g. Land Application Sites:
 - i. Report the location of each application site, the annual and cumulative dry tons/acre for each site, and the landowners name and address. The location for each spreading site shall be given as a legal description for nearest ¼, ¼, Section, Township, Range, and county, or UTM coordinates. The facility shall report PAN when either of the following occurs: 1) When biosolids are greater than 50,000 mg/kg TN; or 2) when biosolids are land applied at an application rate greater than two dry tons per acre per year.
 - ii. If the “Low Metals” criteria are exceeded, report the annual and cumulative pollutant loading rates in pounds per acre for each applicable pollutant, and report the percent of cumulative pollutant loading which has been reached at each site.
 - iii. Report the method used for compliance with pathogen and vector attraction requirements.
 - iv. Report soil test results for pH and phosphorus. If no soil was tested during the year, report the last date when tested and the results.