

STATE OF MISSOURI
DEPARTMENT OF NATURAL RESOURCES
MISSOURI CLEAN WATER COMMISSION



MISSOURI STATE OPERATING PERMIT

In compliance with the Missouri Clean Water Law (Chapter 644 RSMo, hereinafter, the Law), and the Federal Water Pollution Control Act (Public Law 92-500, 92nd Congress) as amended,

Permit No.	MO-0122963
Owner:	Associated Electric Cooperative, Inc.
Address:	2814 S. Golden Avenue, Springfield, MO 65807
Continuing Authority:	Same as above
Address:	Same as above
Facility Name:	AECI, Nodaway Power Plant
Facility Address:	31491 300 th Street, Conception Junction, MO 64434
Legal Description:	SE ¼, SW ¼, Sec. 1, T63N, R35W, Nodaway County
UTM Coordinates:	Outfall #001: X = 347569, Y = 4461220
Receiving Stream:	Tributary to the One Hundred and Two River
First Classified Stream and ID:	One Hundred and Two River (P), WBID# 0342
USGS Basin & Sub-watershed No.:	10240013-0403 (Dog Branch-One Hundred and Two River)

authorizes activities pursuant to the terms and conditions of this permit in accordance with the Missouri Clean Water Law and/or the National Pollutant Discharge Elimination System; it does not apply to other regulated activities.

FACILITY DESCRIPTION

Outfall #001 – Natural gas fueled simple cycle power plant (182 MW), two units – SIC #4911 – Wastewater from the facility is evaporative cooler blowdown and a single cell storage pond; stormwater is not categorically industrial for this type of power plant. No domestic certified operator is required. Design flow is 9,000 gallons per day; actual flow varies with the operation period.

September 1, 2023
Effective Date

August 31, 2028
Expiration Date



John Hoke, Director, Water Protection Program

A. EFFLUENT LIMITATIONS AND MONITORING REQUIREMENTS

OUTFALL #001 wastewater	TABLE A-1 FINAL EFFLUENT LIMITATIONS AND MONITORING REQUIREMENTS				
The facility is authorized to discharge from outfall(s) as specified. The final effluent limitations shall become effective on September 1, 2023 and remain in effect until expiration of the permit. Discharges shall be controlled, limited, and monitored by the facility as specified below:					
EFFLUENT PARAMETERS	UNITS	FINAL EFFLUENT LIMITATIONS		MONITORING REQUIREMENTS	
		DAILY MAXIMUM	MONTHLY AVERAGE	MINIMUM MEASUREMENT FREQUENCY	SAMPLE TYPE
LIMIT SET: M					
PHYSICAL					
Flow	MGD	*	*	once/year	24 hr. estimate
CONVENTIONAL					
Oil & Grease	mg/L	15	10	once/year	grab
pH [†]	SU	6.5 to 9.0	-	once/year	grab
Total Suspended Solids	mg/L	100	30	once/year	grab
MONITORING REPORTS SHALL BE SUBMITTED ANNUALLY; THE FIRST REPORT IS DUE JANUARY 28, 2024.					

* Monitoring and reporting requirement only

[†] pH: the facility will report the minimum and maximum values; pH is not to be averaged.

B. STANDARD CONDITIONS

In addition to specified conditions stated herein, this permit is subject to the attached Part I standard conditions dated August 1, 2014 and hereby incorporated as though fully set forth herein.

C. SPECIAL CONDITIONS

- Spills, Overflows, and Other Unauthorized Discharges.
 - Any spill, overflow, or other discharge(s) not specifically authorized are unauthorized discharges.
 - If an unauthorized discharge cause or permit any contaminants to discharge or enter waters of the state, the unauthorized discharge must be reported to the regional office as soon as practicable but no more than 24 hours after the discovery of the discharge. If the spill or overflow needs to be reported after normal business hours or on the weekend, the facility must call the Department's 24 hour spill line at 573-634-2436.
- Any discharge not meeting permitted limits may be pumped and hauled to an accepting wastewater treatment facility, or otherwise properly disposed.
- Electronic Discharge Monitoring Report (eDMR) Submission System. The NPDES Electronic Reporting Rule, 40 CFR Part 127, reporting of effluent monitoring data and any report required by the permit (unless specifically directed otherwise by the permit), shall be submitted via an electronic system to ensure timely, complete, accurate, and nationally consistent set of data for the NPDES program. The eDMR system is currently the only Department-approved reporting method for this permit unless specified elsewhere in this permit, or a waiver is granted by the Department. The facility must register in the Department's eDMR system through the Missouri Gateway for Environmental Management (MoGEM) before the first report is due. All reports uploaded into the system shall be reasonably named so they are easily identifiable, such as "WET Test Chronic Outfall 002 Jan 2023", or "Outfall004-DailyData-Mar2025".
- Site-wide minimum Best Management Practices (BMPs). At a minimum, the facility shall adhere to the following:
 - Provide good housekeeping practices on the site to keep trash from entry into waters of the state. Dumpsters must remain closed when not in use.
 - Prevent the spillage or loss of fluids, oil, grease, fuel, etc. from vehicle maintenance, equipment cleaning, warehouse activities, and other areas, to prevent the contamination of stormwater from these substances.
 - Provide collection facilities and arrange for proper disposal of waste products including but not limited to petroleum waste products, and solvents.
 - Store all paint, solvents, petroleum products, petroleum waste products (except fuels), and storage containers (such as drums, cans, or cartons) so these materials are not exposed to stormwater or provide other prescribed BMPs such as plastic lids and/or portable spill pans to prevent the commingling of stormwater with container contents. Commingled water may not be

discharged under this permit. Provide spill prevention control, and/or management sufficient to prevent any spills of these pollutants from entering waters of the state. Any containment system used to implement this requirement shall be constructed of materials compatible with the substances contained and shall also prevent the contamination of groundwater. Spill records shall be retained on-site or readily accessible electronically.

- (e) Provide sediment and erosion control sufficient to prevent or minimize sediment loss off of the property, and to protect embankments from erosion.
 - (f) Wash water for vehicles, building(s), or pavement must be handled in a no-discharge manner (infiltration, hauled off-site, etc.). Describe the no-discharge method used and include all pertinent information (quantity/frequency, soap use, effluent destination, BMPs, etc.) in the application for renewal. If wash water is not produced, note this instead.
 - (g) The facility shall not apply salt and sand (traction control) in excess of what is required to maintain safe roadways and walkways. In the spring, after potential for additional snow or ice accumulation, if there is evidence of significant excess traction control materials, the facility shall remove excess sand or salt as soon as possible to minimize and control the discharge of salt and solids. At all times the facility shall use salt judiciously to minimize freshwater salinization.
 - (h) Salt and sand shall be stored in a manner minimizing mobilization in stormwater (for example: under roof, in covered container, under tarp, etc.).
5. Oil/Water Separators. This site is authorized to operate oil water separator tanks (if considered USTs) for the treatment of wastewater or stormwater and falls under 10 CSR 26-2.010(2)(B) if treating water with petroleum oils. OWS, serving this facility are hereby authorized and shall be operated per manufacturer's specifications. The specifications and operating records must be made accessible to Department staff upon request. Petroleum oil water separator sludge is considered used oil; sludge must be disposed of in accordance with 10 CSR 25-11.279. OWS treating animal, vegetable, or food grade oils are not required to be authorized under these regulations. All best management practices for all OWS systems must be adhered.
6. All outfalls must be clearly marked in the field.
7. Report no discharge when a discharge does not occur during the report period. It is a violation of this permit to report no-discharge when a discharge has occurred.
8. Reporting of Non-Detects.
- (a) Compliance analysis conducted by the facility or any contracted laboratory shall be conducted in such a way the precision and accuracy of the analyzed result can be enumerated. See sufficiently sensitive test method requirements in Standard Conditions Part I, §A, No. 4 regarding proper testing and detection limits used for sample analysis. For the purposes of this permit, the definitions in 40 CFR 136 apply; method detection limit (MDL) and laboratory-established reporting limit (RL) are used interchangeably in this permit. The reporting limits established by the laboratory must be below the lowest effluent limits established for the specified parameter (including any parameter's future limit after an SOC) in the permit unless the permit provides for an ML.
 - (b) The facility shall not report a sample result as "non-detect" without also reporting the MDL. Reporting "non-detect" without also including the MDL will be considered failure to report, which is a violation of this permit.
 - (c) For the daily maximum, the facility shall report the highest value; if the highest value was a non-detect, use the less than "<" symbol and the laboratory's highest method detection limit (MDL) or the highest reporting limit (RL); whichever is higher (e.g. <6).
 - (d) When calculating monthly averages, zero shall be used in place of any value(s) not detected. Where all data used in the average are below the MDL or RL, the highest MDL or RL shall be reported as "<#" for the average as indicated in item (c).
9. Failure to pay fees associated with this permit is a violation of the Missouri Clean Water Law (644.055 RSMo).
10. This permit does not cover land disturbance activities.
11. This permit does not allow stream channel or wetland alterations unless approved by Clean Water Act §404 permitting authorities.
12. This permit does not authorize in-stream treatment, the placement of fill materials in flood plains, placement of solid materials into any waterway, the obstruction of stream flow, or changing the channel of a defined drainage course.
13. All records required by this permit may be maintained electronically. These records can be maintained in a searchable format.
14. Changes in Discharges of Toxic Pollutant.
- In addition to the reporting requirements under 40 CFR 122.41, all existing manufacturing, commercial, mining, and silvicultural dischargers must notify the Director per 40 CFR 122.42(a)(1) and (2) as soon as recognizing:
- (a) An activity has occurred or will occur which would result in the discharge, on a routine or frequent basis, of any toxic pollutant which is not limited in the permit, if that discharge will exceed the highest of the following notification levels:

- (1) One hundred micrograms per liter (100 µg/L);
 - (2) Two hundred micrograms per liter (200 µg/L) for acrolein and acrylonitrile;
 - (3) Five hundred micrograms per liter (500 µg/L) for 2,4-dinitrophenol and for 2-methyl-4, 6-dinitrophenol;
 - (4) One milligram per liter (1 mg/L) for antimony;
 - (5) Five (5) times the maximum concentration value reported for the pollutant in the permit application in accordance with 40 CFR 122.21(g)(7); or
 - (6) The notification level established by the Department in accordance with 40 CFR 122.44(f).
 - (b) Any activity has occurred or will occur which would result in any discharge, on a non-routine or infrequent basis, of a toxic pollutant which is not limited in the permit, if that discharge will exceed the highest of the following "notification levels":
 - (1) Five hundred micrograms per liter (500 µg/L);
 - (2) One milligram per liter (1 mg/L) for antimony;
 - (3) Ten (10) times the maximum concentration value reported for the pollutant in the permit application in accordance with 40 CFR 122.21(g)(7).
 - (4) The level established by the Director in accordance with 40 CFR 122.44(f).
 - (c) Authorization of new or expanded pollutant discharges may be required under a permit modification or renewal, and may require an antidegradation review.
15. This permit does not authorize the facility to accept, treat, or discharge wastewater from other sources unless explicitly authorized herein. If the facility would like to accept, treat, or discharge wastewater from another activity or facility, the permit must be modified to include external wastewater pollutant sources in the permit.
16. The full implementation of this operating permit, which includes implementation of any applicable schedules of compliance, shall constitute compliance with Sections 301, 302, 306, 307, and 403 of the federal Clean Water Act, except for standards imposed under Section 307 for toxic pollutants injurious to human health, and with equivalent provisions of the Missouri Clean Water Law, in accordance with Section 644.051.16 RSMo and CWA §402(k). This permit may be reopened and modified, or alternatively revoked and reissued to comply with any applicable effluent standard or limitation issued or approved under CWA §§301(b)(2)(C) and (D), §304(b)(2), and §307(a)(2), if the effluent standard or limitation so issued or approved contains different conditions or is otherwise more stringent than any effluent limitation in the permit, or controls any pollutant not already limited in the permit. This permit may be modified, revoked and reissued, or terminated for cause, including determination new pollutants found in the discharge not identified in the application for the new or revised permit. The filing of a request by the facility for a permit modification, termination, notice of planned changes, or anticipated non-compliance does not stay any permit condition.
17. Any discharges (or qualified activities such as land application) not expressly authorized in this permit, and not clearly disclosed in the permit application, cannot become authorized or shielded from liability under CWA section 402(k) or Section 644.051.16, RSMo, by disclosure to EPA, state, or local authorities after issuance of this permit via any means, including any other permit applications, funding applications, the SWPPP, discharge monitoring reporting, or during an inspection. Submit a permit modification application, as well as an antidegradation determination if appropriate, to request authorization of new or expanded discharges.

D. NOTICE OF RIGHT TO APPEAL

If you were adversely affected by this decision, you may be entitled to pursue an appeal before the administrative hearing commission (AHC) pursuant to 621.250 and 644.051.6 RSMo. To appeal, you must file a petition with the AHC within thirty days after the date this decision was mailed or the date it was delivered, whichever date was earlier. If any such petition is sent by registered mail or certified mail, it will be deemed filed on the date it is mailed; if it is sent by any method other than registered mail or certified mail, it will be deemed filed on the date it is received by the AHC. Any appeal shall be directed to:

Administrative Hearing Commission; U.S. Post Office Building, Third Floor
131 West High Street, P.O. Box 1557; Jefferson City, MO 65102-1557
Phone: 573-751-2422; Fax: 573-751-5018
Website: <https://ahc.mo.gov>

MISSOURI DEPARTMENT OF NATURAL RESOURCES
FACT SHEET
FOR THE PURPOSE OF RENEWAL OF MO-0122963
NODAWAY POWER PLANT

The Federal Water Pollution Control Act (Clean Water Act (CWA) §402 Public Law 92-500 as amended) established the National Pollutant Discharge Elimination System (NPDES) permit program. This program regulates the discharge of pollutants from point sources into the waters of the United States, and the release of stormwater from certain point sources. All such discharges are unlawful without a permit (§301 of the Clean Water Act). After a permit is obtained, a discharge not in compliance with all permit terms and conditions is unlawful. Missouri State Operating Permits (MSOPs) are issued by the Director of the Missouri Department of Natural Resources (Department) under an approved program, operating in accordance with federal and state laws (Federal Clean Water Act and Missouri Clean Water Law 644 RSMo as amended). MSOPs may also cover underground injection, non-discharging facilities, and land application facilities. Permits are issued for a period of five (5) years unless otherwise specified for less.

As per [40 CFR Part 124.8(a)] and [10 CSR 20-6.020(1)(A)2.] a factsheet shall be prepared to give pertinent information regarding applicable regulations, rationale for the development of limitations and conditions, and the public participation process for the Missouri State Operating Permit (MSOP or permit) listed below. A factsheet is not an enforceable part of a permit.

PART I. FACILITY INFORMATION

Facility Type: Industrial: minor, not categorical, <1 MGD
SIC Code(s): 4911
NAICS Code(s): 221112
Application Date: 05/31/2022
Expiration Date: 12/31/2022

FACILITY DESCRIPTION

This facility consists of two simple-cycle natural gas fired turbine generators and no steam turbine engines (hence the facility is exempt from 40 CFR 423). Each unit has an evaporative cooling system where blowdown water is drained to a single cell storage pond. Water used in the cooling process is from the rural drinking water supply (Nodaway Water Supply District #3) so the major pollutant of concern is chlorine. However, the retention time coupled with the infrequent discharges, chlorine has the chance to dissipate and volatilize therefore chlorine is not a parameter of concern. The pond was originally constructed as a holding structure for land application of wastewater. Originally, they believed the drinking water used in the cooling practice would be concentrated to the point it would violate water quality standards. After several years of operation, it was found the blowdown water was, in fact, meeting water quality standards. The facility has not changed practices therefore there is no reason to include chlorine monitoring. To eliminate the costs of land application of wastewater, the facility discontinued land application in 2004. The pond was modified in 2008 to add a drain with which the operator may control the time and volume of discharge. The 2009 permit contained limitations for TRC because the source of the cooling water is rural potable water. However, because of the extensive retention time, sunlight, short run times, and stormwater dilution, the facility does not discharge chlorine therefore the 2017 permit removed monitoring.

The pond currently receives influent from the evaporative cooling process and from secondary containment dikes around the transformers. Water that has accumulated in secondary containment dikes is inspected for oil sheen prior to discharge to the storage pond. This facility is operated as a peaking facility; therefore, it is used primarily in the summer months. The storage pond does not discharge until the plant has been used frequently enough for it to fill. For this reason, effluent monitoring is only required once a year (most likely in the summer months) when the pond is expected to be full and discharging. While this facility and the facility's discharge is not absolutely subject to New Source Performance Standards (40 CFR 423.15) total suspended solids and oil and grease were introduced in the 2014 permit renewal for this facility by use of best professional judgment.

Items listed in the facility (or outfall) description, applicable to the operation, maintenance, control, and resultant effluent quality are required to be enumerated in the facility description. The facility description ensures the facility continues to operate the wastewater (or stormwater) controls listed in the permit to preserve and maintain the effluent quality pursuant to 40 CFR 122.21(e). Any planned changes to the facility (which changes the facility or outfall description) are required to be reported to the Department pursuant to 40 CFR 122.41(l)(1)(ii). If the facility does not or cannot use all of their disclosed treatment devices, this is considered bypassing pursuant to 40 CFR 122.41(m) in the case of wastewater, and BMP disruption in the case of stormwater.

PERMITTED FEATURES TABLE

OUTFALL	AVERAGE FLOW	DESIGN FLOW	TREATMENT LEVEL	EFFLUENT TYPE
#001	0 MGD	0.009 MGD	settling; retention	evaporative cooler blowdown, non-industrial, non-categorical stormwater

FACILITY MAP



WATER BALANCE DIAGRAM

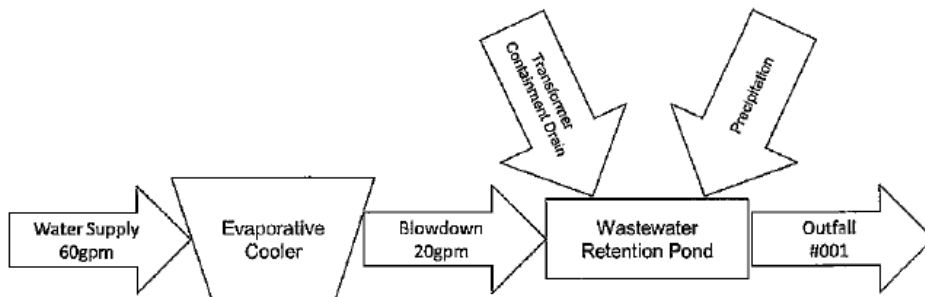

FACILITY PERFORMANCE HISTORY & COMMENTS

The electronic discharge monitoring reports were reviewed for the last five years; the facility did not discharge. No inspections were performed during the last permit term.

CONTINUING AUTHORITY

Pursuant to 10 CSR 20-6.010(2)(A) and (E), the Department has received the appropriate continuing authority authorized signature from the facility. The Missouri Secretary of State continuing authority charter number for this facility is Q00101340; this number was verified to be associated with the facility and precisely matches the continuing authority reported by the facility.

Pursuant to 10 CSR 20-6.010(2)(B)4, this facility is a Level 4 Authority.

- ✓ Pursuant to 10 CSR 20-6.010(2)(D), the facility demonstrated the closest collection system was greater than 2000 feet from the property line per 10 CSR 20-6.010(2)(C)3.

OTHER ENVIRONMENTAL PERMITS

In accordance with 40 CFR 122.21(f)(6), the Department evaluated other environmental permits currently held by this facility; which has a Part 70 air operating permit; <https://dnr.mo.gov/air/business-industry/air-permits/aeci-nodaway-power-plant-op2010-001>

PART II. RECEIVING WATERBODY INFORMATION

RECEIVING WATERBODY TABLE:

OUTFALL	WATERBODY NAME	CLASS	WBID	DESIGNATED USES	DISTANCE TO SEGMENT	12-DIGIT HUC
#001	Tributary to One Hundred and Two River	n/a	n/a	n/a	0.0 mi	10240013-0403 (Dog Branch- One Hundred and Two River)
	One Hundred and Two River	P	0342	DWS, HHP, IRR, LWW, SCR, WBC-B, WWH (AQL)	2.26 miles	

* The receiving waterbody number only was changed; the receiving stream itself has not changed, only the numbering convention.

Classes are representations of hydrologic flow volume or lake basin size per 10 CSR 20-7.031(1)(E).

Designated uses are described in 10 CSR 20-7.031(1)(F).

WBID: Waterbody Identification Number per 10 CSR 20-7.031(1)(Q) and (S)

HUC: Hydrologic Unit Code <https://water.usgs.gov/GIS/huc.html>

EXISTING WATER QUALITY & IMPAIRMENTS

The receiving waterbody(s) segment(s), upstream, and downstream confluence water quality was reviewed. The USGS

<https://waterdata.usgs.gov/nwis/sw> or the Department's quality data database was reviewed.

https://apps5.mo.gov/mocwis_public/wqa/waterbodySearch.do and <https://apps5.mo.gov/wqa/> Impaired waterbodies which may be impacted by discharges from this facility were determined. Impairments include waterbodies on the 305(b) or 303(d) list and those waterbodies or watersheds under a TMDL. <https://dnr.mo.gov/water/what-were-doing/water-planning/quality-standards-impaired-waters-total-maximum-daily-loads/tmdls> Section 303(d) of the federal Clean Water Act requires each state identify waters not meeting water quality standards and for which adequate water pollution controls have not been required. <https://dnr.mo.gov/water/what-were-doing/water-planning/quality-standards-impaired-waters-total-maximum-daily-loads/impaired-waters> Water quality standards protect beneficial uses of water as provided in 10 CSR 20-7.031. The 303(d) list helps state and federal agencies keep track of impaired waters not addressed by normal water pollution control programs. A TMDL is a calculation of the maximum amount of a given pollutant a water body can absorb before its water quality is affected; hence, the purpose of a TMDL is to determine the pollutant loading a specific waterbody can assimilate without exceeding water quality standards.

✓ There are no upstream or downstream impairments near this facility.

WATERBODY MIXING CONSIDERATIONS

For all wastewater outfalls, mixing zone and zone of initial dilution are not allowed per 10 CSR 20-7.031(5)(A)4.B.(I)(a) and (b), as the base stream flow does not provide dilution to the effluent.

PART III. RATIONALE AND DERIVATION OF PERMIT CONDITIONS

ANTIBACKSLIDING

Federal antibacksliding requirements [CWA §402(o) and 40 CFR § 122.44(l) [https://www.ecfr.gov/current/title-40/chapter-I/subchapter-D/part-122#p-122.44\(l\)](https://www.ecfr.gov/current/title-40/chapter-I/subchapter-D/part-122#p-122.44(l))] generally prohibit a reissued permit from containing effluent limitations that are less stringent than the previous permit, with some exceptions. All renewed permits are analyzed for evidence of backsliding. There are several express statutory exceptions to the antibacksliding requirements, located in CWA § 402(o)(2) and 40 CFR 122.44(l). Parameters are discussed individually in Part IV of the fact sheet.

✓ The limitations in this permit are the same as the last permit.

ANTIDEGRADATION REVIEW

Wastewater discharges with new, altered, or expanding flows, the Department is to document, by means of antidegradation review, if the use of a water body's available assimilative capacity is justified. See <https://dnr.mo.gov/document-search/antidegradation-implementation-procedure>

✓ Not applicable; the facility has not submitted information proposing expanded or altered process water discharge; no further degradation proposed therefore no further review necessary.

BEST MANAGEMENT PRACTICES

Minimum site-wide best management practices are established in this permit to ensure all facilities are managing their sites equally to protect waters of the state from certain activities which could cause negative effects in receiving water bodies. While not all sites require a SWPPP because the SIC codes are specifically exempted in 40 CFR 122.26(b)(14) or 10 CSR 20-6.200(2), these best management practices are not specifically included only for stormwater purposes. These practices are minimum requirements for all industrial sites to protect waters of the state. If the minimum best management practices are not followed, the facility may violate

general criteria [10 CSR 20-7.031(4)]. Statutes are applicable to all permitted facilities in the state, therefore pollutants cannot be released unless in accordance with 644.011 and 644.016 (17) RSMo.

CLOSURE

To properly decontaminate and close a wastewater storage structure, treatment structure, lagoon, basin, or device, the facility must draft a complete closure plan, and include the Closure Request Form #2512 <https://dnr.mo.gov/document-search/facility-closure-request-form-mo-780-2512> The publication, Wastewater Treatment Plant Closure - PUB2568 found at <https://dnr.mo.gov/print/document-search/pub2568> may be helpful to develop the closure plan. The regional office will then approve the closure plan, and provide authorization to begin the work. The regional office contact information can be found here: <https://dnr.mo.gov/about-us/division-environmental-quality/regional-office>

CHANGES IN DISCHARGES OF TOXIC POLLUTANT

This special condition reiterates the federal rules found in 40 CFR 122.44(f) for technology treatments and 122.42(a)(1) for all other toxic substances. In these rules, the facility is required to report changes in amounts of toxic substances discharged. Toxic substances are defined in 40 CFR 122.2 as "...any pollutant listed as toxic under section 307(a)(1)" or, in the case of "sludge use or disposal practices," any pollutant identified in regulations implementing section 405(d) of the CWA." Section 307 of the clean water act then refers to those parameters listed in 40 CFR 401.15 and any other toxic parameter the Department determines is applicable for reporting under these rules in the permit. The facility must also consider any other toxic pollutant in the discharge as reportable under this condition and must report all increases to the Department as soon as discovered in the effluent. The Department may open the permit to implement any required effluent limits pursuant to CWA §402(k) where sufficient data was not supplied within the application but was supplied at a later date by either the facility or other resource determined to be representative of the discharge, such as sampling by Department personnel.

COMPLIANCE AND ENFORCEMENT

Enforcement is the action taken by the Water Protection Program (WPP) to bring an entity into compliance with the Missouri Clean Water Law, its implementing regulations, and/or any terms and conditions of an operating permit. The primary purpose of the enforcement activity in the WPP is to resolve violations and return the entity to compliance.

✓ Not applicable; the facility is not currently under Water Protection Program enforcement action.

DISCHARGE MONITORING REPORTING – ELECTRONIC (eDMR) SUBMISSION SYSTEM

The U.S. Environmental Protection Agency (EPA) promulgated a final rule on October 22, 2015, to modernize Clean Water Act reporting for municipalities, industries, and other facilities by requiring electronic data reporting. To comply with the federal rule, the Department is requiring all facilities to submit discharge monitoring data and reports online. To review historical data, the Department's database has a publically facing search engine, available at https://apps5.mo.gov/mocwis_public/dmrDisclaimer.do

Registration and other information regarding MoGEM can be found at <https://dnr.mo.gov/mogem>. Information about the eDMR system can be found at <https://dnr.mo.gov/env/wpp/edmr.htm>. The first user shall register as an Organization Official and the association to the facility must be approved by the Department. To access the eDMR system, use: <https://apps5.mo.gov/mogems/welcome.action>. For assistance using the eDMR system, contact edmr@dnr.mo.gov or call 855-789-3889 or 573-526-2082. To assist the facility in entering data into the eDMR system, the permit describes limit sets designators in each table in Part A of the permit. Facility personnel will use these identifiers to ensure data entry is being completed appropriately. For example, M for monthly, Q for quarterly, A for annual, and others as identified.

EFFLUENT LIMITATIONS

Two general types of effluent limitations, technology-based effluent limits (TBELs) and water quality based effluent limits (WQBELs) are reviewed. Permits are required to establish the most stringent or most protective limit per 10 CSR 20-7.015(9)(A) and 40 CFR 122.44(b)(1). Effluent limitations derived and established for this permit are based on current operations of the facility. Any flow through the outfall is considered a discharge and must be sampled and reported as provided in the permit. Daily maximums and monthly averages are required for continuous discharges per 40 CFR 122.45(d)(1). Weekly limits are not available for non-POTWs.

FEDERAL EFFLUENT LIMITATION GUIDELINES

Effluent Limitation Guidelines, or ELGs, are found at 40 CFR 400-499. <https://www.ecfr.gov/current/title-40/chapter-I/subchapter-N> These are limitations established by the EPA based on the type of activities a facility is conducting. Most ELGs are for process wastewater and some address stormwater. Effluent guidelines are not always established for every pollutant present in a point source discharge. In many instances, EPA promulgates effluent guidelines for an indicator pollutant. Industrial facilities complying with the effluent guidelines for the indicator pollutant will also control other pollutants (e.g. pollutants with a similar chemical structure). For example, EPA may choose to regulate only one of several metals present in the effluent from an industrial category, and compliance with the effluent guidelines will ensure similar metals present in the discharge are adequately controlled. All are technology based limitations which must be met by the applicable facility at all times. If Reasonable Potential is established for any particular parameter, and water-quality based effluent limits are more protective of the receiving water's quality, the WQBEL will be used as the limiting factor in accordance with 40 CFR 122.44(d) and 10 CSR 20-7.015(9)(A).

- ✓ The facility does not have an associated ELG. 40 CFR 423 only applies to power plants that have a steam cycle.

GENERAL CRITERIA CONSIDERATIONS

In accordance with 40 CFR 122.44(d)(1), effluent limitations shall be placed into permits for pollutants determined to cause, have reasonable potential to cause, or to contribute to, an excursion above any water quality standard, including narrative water quality criteria. In order to comply with this regulation, permit decisions were made by completing a reasonable potential determination on whether discharges have reasonable potential to cause, or contribute to an excursion of the general criteria listed in 10 CSR 20-7.031(4). See Part III REASONABLE POTENTIAL for more information. In instances where reasonable potential exists, the permit includes limitations to address the reasonable potential. In discharges where reasonable potential does not exist, the permit may include monitoring to later determine the discharge's potential to impact the narrative criteria. Additionally, 644.076.1 RSMo, as well as Part I §D – Administrative Requirements of Standard Conditions included in this permit state it shall be unlawful for any person to cause or allow any discharge of water contaminants from any water contaminant or point source located in Missouri in violation of §§644.006 to 644.141 of the Missouri Clean Water Law or any standard, rule, or regulation promulgated by the commission. See Part IV for specific determinations.

GOOD HOUSEKEEPING PRACTICES

Good housekeeping is a practical, cost-effective way to maintain a clean and orderly facility to prevent potential pollution sources from coming into contact with stormwater. It includes establishing protocols to reduce the possibility of mishandling materials or equipment and employee training. Common areas where good housekeeping practices should be followed include trash containers and adjacent areas, material storage areas, vehicle and equipment maintenance areas, and loading docks. Good housekeeping practices must include a schedule for regular pickup and disposal of garbage and waste materials and routine inspections of drums, tanks, and containers for leaks and structural conditions. Practices also include containing and covering garbage, waste materials, and debris. Involving employees in routine monitoring of housekeeping practices is an effective means of ensuring the continued implementation of these measures.

Specific good housekeeping may include:

- ◆ Spill and overflow protection under chemical or fuel connectors to contain spillage at liquid storage tanks
- ◆ Load covers on residue hauling vehicles and ensure gates on trucks are sealed and the truck body is in good condition
- ◆ Containment curbs around loading/unloading areas or tanks
- ◆ Techniques to reduce solids residue which may be tracked on to access roads traveled by residue trucks or residue handling vehicles.
- ◆ Techniques to reduce solid residue on exit roads leading into and out of residue handling areas

Industrial facilities may conduct activities that use, store, manufacture, transfer, and/or dispose of PFAS containing materials. Successful good housekeeping practices to minimize PFAS exposure to stormwater could include inventorying the location, quantity, and method of storage; using properly designed storage and transfer techniques; providing secondary containment around chemical storage areas; and using proper techniques for cleaning or replacement of production systems or equipment.

Where feasible, minimizing exposure of potential pollutant sources to precipitation is an important control option. Minimizing exposure prevents pollutants, including debris, from coming into contact with precipitation and can reduce the need for BMPs to treat contaminated stormwater runoff. It can also prevent debris from being picked up by stormwater and carried into drains and surface waters. Examples of BMPs for exposure minimization include covering materials or activities with temporary structures (e.g., tarps) when wet weather is expected or moving materials or activities to existing or new permanent structures (e.g., buildings, silos, sheds). Even the simple practice of keeping a dumpster lid closed can be a very effective pollution prevention measure. Another example could include locating PFAS-containing materials and residues away from drainage pathways and surface waters. For erosion and sediment control, BMPs must be selected and implemented to limit erosion on areas of your site that, due to topography, activities, soils, cover, materials, or other factors, are likely to experience erosion. Erosion control BMPs such as seeding, mulching, and sodding prevent soil from becoming dislodged and should be considered first. Sediment control BMPs such as silt fences, sediment ponds, and stabilized entrances trap sediment after it has eroded. Sediment control BMPs should be used to back-up erosion control BMPs.

The SWPPP (if required for this facility) must contain a narrative evaluation of the appropriateness of stormwater management practices that divert, infiltrate, reuse, or otherwise manage stormwater runoff so as to reduce the discharge of pollutants. Appropriate measures are highly site-specific, but may include, among others, vegetative swales, collection and reuse of stormwater, inlet controls, snow management, infiltration devices, and wet retention measures. A combination of preventive and treatment BMPs will yield the most effective stormwater management for minimizing the offsite discharge of pollutants via stormwater runoff. BMPs schedules must also address preventive maintenance records or logbooks, regular facility inspections, spill prevention and response, and employee training.

GROUNDWATER MONITORING

Groundwater is a water of the state according to 644.016(27) RSMo, is subject to regulations at 10 CSR 20-7.015(7) and 10 CSR 20-7.031(6), and must be protected accordingly.

- ✓ This facility is not required to monitor groundwater for the water protection program as there are no sub-surface discharges.

ICE-MELT PRODUCT REMOVAL

The Department is authorized to require BMPs for facilities per 40 CFR 122.44(k)(2). The facility should, to the extent practicable, remove large pieces of salt as soon as possible. After winter weather has ceased for the year, the facility needs to inspect all low-lying areas for extra salt and sand, and remove these as soon as possible. Salt applied to large areas has the potential to cause freshwater salinization which could result in a fish kill of sensitive species. To reduce potential for solids entering a stream, sand or other traction control materials will need to be evaluated against the probability that these materials could cause general criteria violations of solids and bottom deposits per 10 CSR 20-7.031(4).

LAND APPLICATION

Land application, which is surficial dispersion of wastewater or surficial spreading of sludge can be performed by facilities as an alternative to discharging. Authority to regulate these activities is pursuant to 644.026 RSMo. The Department implements requirements for these types of operations pursuant to 10 CSR 20-6.015(4)(A)1 which instructs the Department to develop permit conditions containing limitations, monitoring, reporting, and other requirements to protect soils, crops, surface waters, groundwater, public health, and the environment. Sub-surface dispersion or application of wastewater is typically considered a Class V UIC system; See UNDERGROUND INJECTION CONTROL section below.

- ✓ Not applicable; this permit does not authorize operation of a surficial land application system to disperse wastewater or sludge.

LAND DISTURBANCE

Land disturbance, sometimes called construction activities, are actions which cause disturbance of the root layer or soil; these include clearing, grading, and excavating of the land. 40 CFR 122.26(b)(14) and 10 CSR 20-6.200(3) requires permit coverage for these activities. Coverage is not required for facilities when only providing maintenance of original line and grade, hydraulic capacity, or to continue the original purpose of the facility.

- ✓ Not applicable; this permit does not provide coverage for land disturbance activities. The facility may obtain a separate land disturbance permit (MORA) online at <https://dnr.mo.gov/water/business-industry-other-entities/permits-certification-engineering-fees/stormwater/construction-land-disturbance> MORA permits may not cover disturbance of contaminated soils, however, site specific permits such as this one can be modified to include appropriate controls for land disturbance of contaminated soils by adding site-specific BMP requirements and additional outfalls.

MAJOR WATER USER

Any surface or groundwater user with a water source and the equipment necessary to withdraw or divert 100,000 gallons (or 70 gallons per minute) or more per day combined from all sources from any stream, river, lake, well, spring, or other water source is considered a major water user in Missouri. <https://dnr.mo.gov/water/business-industry-other-entities/reporting/major-water-users> All major water users are required by 256.400 RSMo to register water use annually. <https://dnr.mo.gov/document-search/frequently-asked-major-water-user-questions-pub2236/pub2236>

- ✓ Not applicable; this facility cannot withdraw water from the state in excess of 70 gpm or 0.1 MGD. This facility utilizes drinking water in the process.

MODIFICATION REQUESTS

Facilities have the option to request a permit modification from the Department at any time under RSMo 644.051.9. Requests must be submitted to the Water Protection Program with the appropriate forms and fees paid per 10 CSR 20-6.011. It is recommended facilities contact the program early so the correct forms and fees are submitted, and the modification request can be completed in a timely fashion. Minor modifications, found in 40 CFR 122.63, are processed without the need for a public comment period. Major modifications, those requests not explicitly fitting under 40 CFR 122.63, do require a public notice period. Modifications to permits must be completed when: a new pollutant is found in the discharge; operational or functional changes occur which affect the technology, function, or outcome of treatment; the facility desires alternate numeric benchmarks; or other changes are needed to the permit.

Modifications are not required when utilizing or changing additives in accordance with the publication <https://dnr.mo.gov/document-search/additive-usage-wastewater-treatment-facilities-pub2653/pub2653> nor are required when a temporary change or provisional discharge has been authorized by the regional office. While provisional discharges may be authorized by the regional office, they will not be granted for more than the time necessary for the facility to obtain an official modification from the Water Protection Program. Temporary provisional discharges due to weather events or other unforeseen circumstances may or may not necessitate a permit modification. The facility may ask for a Compliance Assistance Visit (CAV) from the regional office to assist in the decision-making process; CAVs are provided free to the permitted entity.

OIL/WATER SEPARATOR SYSTEMS AND USED OIL

Oil water separator (OWS) systems are frequently found at industrial sites where process water, wastewater, or stormwater may contain oils, petroleum, greases, oily wastewaters, or other immiscible liquids requiring separation. Food industry discharges typically require treatment prior to discharge to publically owned treatment works. Per 10 CSR 26-2.010(2)(B), all oil water separators

classified as underground storage tanks (UST) which meet the volume requirements, must be operated according to manufacturer's specifications. OWS which are USTs may be authorized in NPDES permits per 10 CSR 26-2.010(2)(B) or otherwise will be regulated as a underground petroleum storage tank under tank rules. A facility may operate an OWS which is not considered a UST for the wastewater or stormwater at any facility without specific NPDES permit authorization. Alternatively, a facility is not required to cover a UST OWS under the NPDES permit if they desire to obtain alternative regulatory compliance. OWS treating animal, vegetable, or food grade oils are not required to be authorized under 10 CSR 20-26-2.020(2)(B). All best management practices for all OWS systems must be adhered. In 2017, field-poured concrete tanks, previously exempted from the tanks rules, lost their exempt status. Facilities must re-evaluate these concrete structures pursuant to these now relevant rules. Adjacent USTs are not covered by these regulations.

Any and all water treatment systems designed to remove floating immiscible oils are termed oil water separators. If a device is intended to capture oil and separate it from water which is to be discharged, this generally qualifies that oil as used oil (if it is petroleum-based in nature). Used oil and oily sludge must be disposed of in accordance with 10 CSR 25-11.279. Pursuant to 40 CFR 279.20(b)(2)(ii)(B), separating used petroleum-based oil from wastewater generated on-site (to make the wastewater acceptable for discharge or reuse pursuant to Federal or state regulations governing the management or discharge of wastewaters) are considered used oil generators and not processors under self-implementing 40 CFR 279 Standards For The Management Of Used Oil. Oily wastes generated by OWS are also generally subject to Spill Prevention, Control, and Countermeasure (SPCC) regulations.

OPERATOR CERTIFICATION REQUIREMENTS

Operators or supervisors of operations at regulated domestic wastewater treatment facilities shall be certified in accordance with 10 CSR 20-9 and any other applicable state law or regulation.

- ✓ Not applicable; this facility is not owned or operated by a municipality, public sewer district, county, public water supply district, or private sewer company regulated by the Public Service Commission, or operated by a state or federal agency.

PERMIT SHIELD

The permit shield provision of the Clean Water Act (Section 402(k)) and Missouri Clean Water Law (644.051.16 RSMo) provides that when a permit holder is in compliance with its NPDES permit or MSOP, it is effectively in compliance with certain sections of the Clean Water Act, and equivalent sections of the Missouri Clean Water Law. In general, the permit shield is a legal defense against certain enforcement actions, but is only available when the facility is in compliance with its permit and satisfies other specific conditions, including having completely disclosed all discharges and all facility processes and activities to the Department at time of application. It is the facility's responsibility to ensure that all potential pollutants, waste streams, discharges, and activities, as well as wastewater land application, storage, and treatment areas, are all fully disclosed to the Department at the time of application or during the draft permit review process. Previous permit applications are not necessarily evaluated or considered during permit renewal actions. All relevant disclosures must be provided with each permit application, including renewal applications, even when the same information was previously disclosed in a past permit application. Subsequent requests for authorization to discharge additional pollutants, expanded or newly disclosed flows, or for authorization for previously unpermitted and undisclosed activities or discharges, will likely require an official permit modification, including another public participation process.

REASONABLE POTENTIAL (RP)

Regulations per 10 CSR 20-7.015(9)(A)2 and 40 CFR 122.44(d)(1)(i) require effluent limitations for all pollutants which are (or may be) discharged at a level causing or have the reasonable potential to cause (or contribute to) an in-stream excursion above narrative or numeric water quality standards. Per 10 CSR 20-7.031(4), general criteria shall be applicable to all waters of the state at all times; however, acute toxicity criteria may be exceeded by permit allowance in zones of initial dilution, and chronic toxicity criteria may be exceeded by permit allowance in mixing zones. A reasonable potential analysis (RPA) is a numeric RP decision calculated using effluent data provided by the facility for parameters that have a numeric Water Quality Standard (WQS). If any given pollutant has the reasonable potential to cause or contribute to an in-stream excursion above the WQS, the permit must contain a WQBEL for the pollutant per 40 CFR Part 122.44(d)(1)(iii) and the most stringent limits per 10 CSR 20-7.031(9)(A). The RPA is performed using the *Technical Support Document for Water Quality Based Toxics Control (TSD)* methods (EPA/505/2-90-001) for continuous discharges. See additional considerations under Part II WATERBODY MIXING CONSIDERATIONS and Part III WASTELOAD ALLOCATIONS. Wasteload allocations are determined utilizing the same equations and statistical methodology. Absent sufficient effluent data, WQBELs are derived without consideration of effluent variability and is assumed to be present unless found to be absent to meet the requirements of antidegradation review found in 10 CSR 20-7.031(3) and reporting of toxic substances pursuant to 40 CFR 122.44(f). The Department's permit writer's manual (<https://dnr.mo.gov/water/business-industry-other-entities/technical-assistance-guidance/wastewater-permit-writers-manual>), the EPA's permit writer's manual (<https://www.epa.gov/npdes/npdes-permit-writers-manual>), program policies, and best professional judgment guide each decision. Each parameter in each outfall is carefully considered; and all applicable information regarding: technology based effluent limitations, effluent limitation guidelines, water quality standards, inspection reports, stream water quality information, stream flows, uses assigned to each waterbody, and all applicable site specific information and data gathered by the facility through discharge monitoring reports and renewal (or new) application sampling.

Reasonable potential determinations (RPD) are based on physical conditions of the site as provided in Sections 3.1.2, 3.1.3, and 3.2 of the TSD using best professional judgement. An RPD consists of evaluating visual observations for compliance with narrative criteria,

non-numeric information, or small amounts of numerical data (such as 1 data point supplied in the application). Narrative criteria with RP typically translate to a numeric WQS, so a parameter's establishment being based on narrative criteria does not necessarily make the decision an RPD vs RP—how the data is collected does, however. For example, a facility with orange discharge can have RP for narrative criteria like color, but a numeric iron limit is established to account for the violation of narrative criteria based on effluent data submitted by the facility. When insufficient data is received to make a determination on RP based on numeric effluent data, the RPD decisions are based on best professional judgment considering the type of effluent discharged, the current operational controls in place, and historical overall management of the site. In the case of iron causing excursions of narrative criteria for color, if a facility has not had iron monitoring in a previous permit, adding iron monitoring would be an RPD, since numeric data isn't being used in the determination, but observable, site-specific conditions are.

When the facility is performing surficial or subsurface land application, the volume of water, frequency of application, type of vegetation, soil type, land slopes, and general overall operating conditions are considered. 10 CSR 20-8 are regulations for the minimum operating conditions for land application; these regulations cannot be excused even if there is no RP. RP is reserved for discharging outfalls given that these outfalls are the only ones which water quality standards apply to, but the process is similar as the site conditions are compared to regulations, soil sampling, pollutant profile, and other site specific conditions. In the case of non-discharging outfalls, an RPD is instead used to determine monitoring requirements.

The TSD RPA method cannot be performed on stormwater as the flow is intermittent and highly variable. A stormwater RPD consists of reviewing application data and discharge monitoring data and comparing those data to narrative or numeric water quality criteria. For stormwater outfalls, considerations are required per 10 CSR 20-6.200(6)(B)2: A. application and other information supplied by the facility; B. effluent guidelines; C. best professional judgment; D. water quality; and E. BMPs.

RPDs are also performed for WET testing in wastewater. While no WET regulations specific to industrial wastewater exist, 40 CFR 122.21(j)(5) implies the following can be considered: 1) the variability of the pollutants; 2) the ratio of wastewater flow to receiving stream flow; and 3) current technology employed to remove toxic pollutants. Generally, sufficient data does not exist to mathematically determine RPA for WET, but instead compares the data for other toxic parameters in the wastewater with the necessity to implement WET testing with either monitoring or limits. When toxic parameters exhibit RP, WET testing is generally included in the permit as an RPD. However, if all toxic parameters are controlled via limitations or have exhibited no toxicity in the past, then WET testing may be waived. Only in instances where the wastewater is well characterized can WET testing be waived.

WET testing is typically not implemented for stormwater. Stormwater discharges do not adhere to the same principles of wastewater RPAs because stormwater discharges are not continuous, and at the time of precipitation discharge the receiving stream is also no longer at base (0) flow, meaning that using RP to develop WET testing requirements for stormwater is unrepresentative. The Department works with the Missouri Department of Conservation and has understanding of streams already exhibiting toxicity, even without the influence of industrial wastewater or stormwater. Facilities discharging to streams with historical toxicity are required to use laboratory water for dilution, instead of water from the receiving stream when performing WET tests.

TSD methods encountered may be § 3.3.2, § 5.7.3 for metals, and § 5.4.1 for chloride. Part IV EFFLUENT LIMIT DETERMINATIONS provides specific decisions related to this permit. In general, removal of a WQBEL if there is no RP is not considered backsliding, see ANTIBACKSLIDING for additional information.

- ✓ No statistical RPAs were performed for this permit.
- ✓ In a meeting on February 17, 2023, the EPA verbally agreed that removal of limits for a parameter with no RP is not considered backsliding.
- ✓ The previous permit indicated "There Shall Be No Discharge of Floating Solids or Visible Foam in Other Than Trace Amounts" under each table. The statement was not evaluated against actual site conditions therefore, this general criteria was re-assessed. It was determined that this facility does not discharge foam in amounts which would indicate reasonable potential, therefore the statement was removed. The permit contains numeric limits for solids. Removal of these narrative criteria is not subject to antibacksliding provisions as there is no RP for foam.

REGIONAL OFFICES (ROS)

Regional Offices will provide a compliance assistance visit at a facility's request; a regional map with links to phone numbers can be found here: <https://dnr.mo.gov/about-us/division-environmental-quality/regional-office>. Or use <https://dnr.mo.gov/compliance-assistance-enforcement> to request assistance from the Region online.

RENEWAL REQUIREMENTS

The renewal special condition permit requirement is designed to guide the facility to prepare and include all relevant and applicable information in accordance with 10 CSR 20-6.010(7)(A)-(C), and if applicable, federal regulations. The special condition may not include all requirements and requests for additional information may be made at the time of permit renewal under 644.051.13(5) RSMo and 40 CFR 122.21(h). Prior to submittal, the facility must review the entire submittal to confirm all required information and data is provided; it is the facility's responsibility to discern if additional information is required. Failure to fully disclose applicable information with the application or application addendums may result in a permit revocation per 10 CSR 20-6.010(8)(A) and may

result in the forfeiture of permit shield protection authorized in 644.051.16 RSMo. Forms are located at:

<https://dnr.mo.gov/water/business-industry-other-entities/permits-certification-engineering-fees/wastewater>

- ✓ This facility shall submit an appropriate and complete application to the Department no less than 180 days prior to the expiration date listed on page 1 of the permit.
- ✓ The facility may email cleanwaterpermits@dnr.mo.gov to submit the application to the Program. A paper copy is not necessary if submitted via email. For larger applications, a drop-box type service may also be used.
- ✓ Application materials shall include complete Form A, and Form C. If the form name has changed, then the facility should ensure they are submitting the correct forms as required by regulation.

SAMPLING FREQUENCY JUSTIFICATION

Sampling and reporting frequency was generally retained from previous permit. 40 CFR 122.45(d)(1) indicates all continuous discharges, such as wastewater discharges, shall be permitted with daily maximum and monthly average limits. Minimum sampling frequency for all parameters is annually per 40 CFR 122.44(i)(2).

A reduction in monitoring frequency is not considered backsliding. A numeric or narrative limit established in the permit is applicable every hour of every day, not only during the day the monitoring occurs, therefore, a reduction in monitoring frequency has no bearing on the numeric limits applied in the permit. Both § 402(o)(1) and the safety clause in § 402(o)(3) prohibit renewed permits from containing effluent limitations that are less stringent. The Department does not read 402(o) to apply to any other non-limiting type of permit conditions.

SAMPLING TYPE JUSTIFICATION

Sampling type was continued from the previous permit. The sampling types are representative of the discharges, and are protective of water quality. Discharges with altering effluent will consider implementing composite sampling; discharges with uniform effluent can have grab samples. Grab samples are usually appropriate for stormwater. Parameters which must have grab sampling are: pH, ammonia, *E. coli*, total residual chlorine, free available chlorine, hexavalent chromium, dissolved oxygen, total phosphorus, volatile organic compounds, and others. For further information on sampling and testing methods see 10 CSR 20-7.015(9)(D)2.

SCHEDULE OF COMPLIANCE (SOC)

A schedule of compliance is time allowed to meet future more stringent limitations.

- ✓ Not applicable; this permit does not contain a SOC.

SPILLS, OVERFLOWS, AND OTHER UNAUTHORIZED DISCHARGE REPORTING

Per 260.505 RSMo, any emergency involving a hazardous substance must be reported to the Department's 24 hour Environmental Emergency Response hotline at (573) 634-2436 at the earliest possible moment after discovery. The Department may require the submittal of a written report detailing measures taken to clean up a spill. These reporting requirements apply whether or not the spill results in chemicals or materials leaving the permitted property or reaching waters of the state. This requirement is in addition to the noncompliance reporting requirement found in Standard Conditions Part I.

<https://revisor.mo.gov/main/OneSection.aspx?section=260.500&bid=13989&hl=>

Any other spills, overflows, or unauthorized discharges reaching waters of the state must be reported to the regional office during normal business hours, or after normal business hours, to the Department's 24 hour Environmental Emergency Response spill line at 573-634-2436.

Certain industrial facilities are subject to the self-implementing regulations for Oil Pollution Prevention in 40 CFR 112, and are required to initiate and follow Spill Prevention, Control, and Countermeasure (SPCC) Plans. This permit, as issued, is not intended to be a replacement for any SPCC plan, nor can this permit's conditions be automatically relaxed based on the SPCC plan if the permit is more stringent than the plan.

STANDARD CONDITIONS

The standard conditions Part I attached to this permit incorporate all sections of 10 CSR 20-6.010(8) and 40 CFR 122.41(a) through (n) by reference as required by law. These conditions, in addition to the conditions enumerated within the standard conditions must be reviewed by the facility to ascertain compliance with this permit, state regulations, state statutes, federal regulations, and the Clean Water Act.

STORMWATER POLLUTION PREVENTION PLAN (SWPPP)

A SWPPP must be prepared by the facility if the SIC code or facility description type is found in 40 CFR 122.26(b)(14) and/or 10 CSR 20-6.200(2). A SWPPP may be required of other facilities where stormwater has been identified as necessitating better management. The purpose of a SWPPP is to comply with all applicable stormwater regulations by creating an adaptive management plan to control and mitigate stream pollution from stormwater runoff.

- ✓ Not applicable; this facility is not applicable to stormwater requirements. Only steam-cycle power generating facilities or those with coal require stormwater permit requirements.

SUFFICIENTLY SENSITIVE ANALYTICAL METHODS

Please review Standard Conditions Part 1, §A, No. 4. The analytical and sampling methods used shall conform to the reference methods listed in 10 CSR 20-7.015 or 40 CFR 136 unless alternates are approved by the Department and incorporated within this permit. The facility shall use sufficiently sensitive analytical methods for detecting, identifying, and measuring the concentrations of pollutants. The facility shall ensure the selected methods are able to quantify the presence of pollutants in any given discharge at concentrations low enough to determine compliance with Water Quality Standards in 10 CSR 20-7.031 or effluent limitations unless provisions in the permit allow for other alternatives. The reporting limits established by the chosen laboratory must be below the lowest effluent limits established for the specified parameter (including any parameter's future limit after an SOC) in the permit unless the permit provides for an ML or if the facility provides a written rationale to the Department. It is the facility's responsibility to ensure the laboratory has adequate equipment and controls in place to quantify the pollutant. Inflated reporting limits will not be accepted by the Department if the reporting limit is above the parameter value stipulated in the permit. A method is "sufficiently sensitive" when; 1) the method quantifies the pollutant below the level of the applicable water quality criterion or; 2) the method minimum level is above the applicable water quality criterion, but the amount of pollutant in a facility's discharge is high enough the method detects and quantifies the level of pollutant in the discharge, or 3) the method has the lowest minimum level of the analytical methods approved under 10 CSR 20-7.015 and or 40 CFR 136. These methods are also required for parameters listed as monitoring only, as the data collected may be used to determine if numeric limitations need to be established. A facility is responsible for working with their contractors to ensure the analysis performed is sufficiently sensitive.

UNDERGROUND INJECTION CONTROL (UIC)

Class V wells are sub-surface dispersal or injection of any industrial wastewater; and in certain circumstances, may also be considered a Class V well if it is domestic wastewater. They can also be shallow injection wells like heat pumps and groundwater remediation wells. UIC systems may be described as having "septic tanks" or "lateral lines" in addition to the traditional well type of injection.

✓ Not applicable; the facility has not submitted materials indicating the facility is or will be performing UIC at this site.

WHOLE EFFLUENT TOXICITY (WET) TEST

A WET test is a quantifiable method to conclusively determine if discharges from the facility cause toxicity to aquatic life by itself, in combination with, or through synergistic responses, typically when mixed with receiving stream water. Under the CWA §101(a)(3), requiring WET testing is reasonably appropriate for Missouri State Operating Permits to quantify toxicity. WET testing is also required by 40 CFR 122.44(d)(1) when RP is found. WET testing ensures the provisions in 10 CSR 20-6 and Missouri's Water Quality Standards in 10 CSR 20-7 are being met; the acute WQS for WET is 0.3 TUa. Under 10 CSR 20-6.010(8)(A)4, the Department may require other terms and conditions it deems necessary to ensure compliance with the CWA and related regulations of the Missouri Clean Water Commission. Missouri Clean Water Law (MCWL) RSMo 644.051.3 requires the Department to set permit conditions complying with the MCWL and CWA. 644.051.4 RSMo specifically references toxicity as an item the Department must consider in permits (along with water quality-based effluent limits); and RSMo 644.051.5 is the basic authority to require testing conditions. Requirements found in the federal application requirements for POTWs (40 CFR 122.21(j)(5)) do not apply to industrial facilities, therefore WET testing can be implemented on a case by case basis following the factors outlined below. Annual testing is the minimum testing frequency if reasonable potential is found; monitoring requirements promulgated in 40 CFR 122.44(i)(2) state "requirements to report monitoring results shall be established on a case-by-case basis with a frequency dependent on the nature and effect of the discharge, but in no case less than once per year." To determine reasonable potential, factors considered are: 1) history of toxicity; 2) quantity and quality of substances (either limited or not) in the permit with aquatic life protections assigned; and 3) operational controls on toxic pollutants. See Part III under REASONABLE POTENTIAL for additional information. A facility does not have to be designated as a major facility to receive WET testing; and being a major facility does not automatically require WET testing. Additionally per 40 CFR 122.44(d)(1)(v), limits on whole effluent toxicity are not necessary where the permitting authority demonstrates in the fact sheet, using the procedures in 40 CFR 122.44(d)(1)(ii) of this section, that chemical-specific limits or specified operational controls are sufficient to attain and maintain applicable numeric and narrative water quality standards.

✓ Not applicable; WET testing was not implemented in this permit because there are no pollutants identified as "toxic", and there is no RP for WET.

PART IV. EFFLUENT LIMIT DETERMINATIONS

OUTFALL #001 – WASTEWATER

EFFLUENT LIMITATIONS TABLE:

PARAMETERS	UNIT	DAILY MAX	MONTHLY AVG.	PREVIOUS PERMIT LIMITS	MINIMUM SAMPLING FREQUENCY	REPORTING FREQUENCY	SAMPLE TYPE
PHYSICAL							
FLOW	MGD	*	*	SAME	ANNUALLY	ANNUALLY	24 Hr. EST
CONVENTIONAL							
OIL & GREASE	mg/L	15	10	SAME	ANNUALLY	ANNUALLY	GRAB
pH [†]	SU	6.5 TO 9.0	-	SAME	ANNUALLY	ANNUALLY	GRAB
TOTAL SUSPENDED SOLIDS (TSS)	mg/L	100	30	SAME	ANNUALLY	ANNUALLY	GRAB

* monitoring and reporting requirement only

† report the minimum and maximum pH values; pH is not to be averaged

PHYSICAL:

Flow

In accordance with [40 CFR Part 122.44(i)(1)(ii)] the volume of effluent discharged from each outfall is needed to ensure compliance with permitted effluent limitations. If the facility is unable to obtain effluent flow, then it is the responsibility of the facility to inform the Department, which may require the submittal of an operating permit modification. The facility will report the total flow in millions of gallons per day (MGD), annual monitoring continued from previous permit. The facility did not discharge in the last permit term.

CONVENTIONAL:

Oil & Grease

15 mg/L daily maximum; 10 mg/L monthly average; continued from previous permit using RPD. The facility did not discharge in the last permit term. Oil and grease is considered a conventional pollutant. Oil and grease is a comprehensive test which measures for gasoline, diesel, crude oil, creosote, kerosene, heating oils, heavy fuel oils, lubricating oils, waxes, and some asphalt and pitch. The test can also detect some volatile organics such as benzene, toluene, ethylbenzene, or xylene, but these constituents are often lost during testing due to their boiling points. An RPD on this parameter found RP based on the type of facility. Oils and greases of different densities will possibly form sheen or unsightly bottom deposits at levels which vary from 10 mg/L. To protect the general criteria, it is the responsibility of the facility to visually observe the discharge and receiving waters for sheen or bottom deposits. The limit this permit applies does not allow the facility to violate general criteria pursuant to 10 CSR 20-7.015(4) even if data provided are below the numeric limit.

AQL Chronic: 10 mg/L per 10 CSR 20-7.031 Table A1

Set chronic standard equal to chronic WLA per TSD §5.4.2 (EPA/505/2-90-001); multiply by 1.5 to obtain acute limit.

10 mg/L * 1.5 = 15 mg/L

pH

6.5 to 9.0 SU – instantaneous grab sample. Water quality limits [10 CSR 20-7.031(5)(E)] are applicable to this outfall. pH is a fundamental water quality indicator. Limitations in this permit will protect against aquatic organism toxicity, downstream water quality issues, human health hazard contact, and negative physical changes in accordance with the general criteria at 10 CSR 20-7.031(4) and the Clean Water Act's (CWA) goal of 100% fishable and swimmable rivers and streams. The facility did not discharge in the last permit term.

Total Suspended Solids (TSS)

100 mg/L daily maximum, 30 mg/L monthly average technology limits per best professional judgment; continued from previous permit. To conform to antibacksliding rules, the limit shall remain. This limit is based on similar activities (electrical generation) who install a settling basin to control solids. The facility did not discharge in the last permit term.

PART V. ADMINISTRATIVE REQUIREMENTS

On the basis of preliminary staff review and the application of applicable standards and regulations, the Department, as administrative agent for the Missouri Clean Water Commission, proposes to issue a permit(s) subject to certain effluent limitations, schedules, and special conditions contained herein and within the operating permit. The proposed determinations are tentative pending public comment.

PERMIT SYNCHRONIZATION

Permits are normally issued on a five-year term, but to achieve watershed synchronization some permits will need to be issued for less than the full five years as allowed by regulation. The intent is all permits within a watershed will move through the Watershed Based Management (WBM) cycle together will all expire in the same fiscal year. This will allow the Department to explore a watershed based permitting effort at some point in the future.

- ✓ Industrial permits are not being synchronized.

PUBLIC NOTICE

The Department shall give public notice a draft permit has been prepared and its issuance is pending. Additionally, public notice will be issued if a public hearing is to be held because of a significant degree of interest in or with concerns related to a draft permit. No public notice is required when a request for a permit modification or termination is denied; however, the requester and facility must be notified of the denial in writing. <https://dnr.mo.gov/water/what-were-doing/public-notice> The Department must issue public notice of a draft operating permit. The public comment period is the length of time not less than 30 days following the date of the public notice which interested persons may submit written comments about the proposed permit.

For persons wishing to submit comments regarding this proposed operating permit, please refer to the Public Notice page located at the front of this draft operating permit. The Public Notice page gives direction on how and where to submit appropriate comments. All comments must be in written form.

- ✓ This Public Notice period for this operating permit started July 7, 2023, and ended August 7, 2023. There were no comments.

DATE OF FACT SHEET: AUGUST 9, 2023

COMPLETED BY:

PAM HACKLER, ENVIRONMENTAL SCIENTIST
MISSOURI DEPARTMENT OF NATURAL RESOURCES
WATER PROTECTION PROGRAM
OPERATING PERMITS SECTION - INDUSTRIAL UNIT
(573-526-3386
pam.hackler@dnr.mo.gov



STANDARD CONDITIONS FOR NPDES PERMITS
ISSUED BY
THE MISSOURI DEPARTMENT OF NATURAL RESOURCES
MISSOURI CLEAN WATER COMMISSION
REVISED
AUGUST 1, 2014

These Standard Conditions incorporate permit conditions as required by 40 CFR 122.41 or other applicable state statutes or regulations. These minimum conditions apply unless superseded by requirements specified in the permit.

Part I – General Conditions

Section A – Sampling, Monitoring, and Recording

1. **Sampling Requirements.**
 - a. Samples and measurements taken for the purpose of monitoring shall be representative of the monitored activity.
 - b. All samples shall be taken at the outfall(s) or Missouri Department of Natural Resources (Department) approved sampling location(s), and unless specified, before the effluent joins or is diluted by any other body of water or substance.
2. **Monitoring Requirements.**
 - a. Records of monitoring information shall include:
 - i. The date, exact place, and time of sampling or measurements;
 - ii. The individual(s) who performed the sampling or measurements;
 - iii. The date(s) analyses were performed;
 - iv. The individual(s) who performed the analyses;
 - v. The analytical techniques or methods used; and
 - vi. The results of such analyses.
 - b. If the permittee monitors any pollutant more frequently than required by the permit at the location specified in the permit using test procedures approved under 40 CFR Part 136, or another method required for an industry-specific waste stream under 40 CFR subchapters N or O, the results of such monitoring shall be included in the calculation and reported to the Department with the discharge monitoring report data (DMR) submitted to the Department pursuant to Section B, paragraph 7.
3. **Sample and Monitoring Calculations.** Calculations for all sample and monitoring results which require averaging of measurements shall utilize an arithmetic mean unless otherwise specified in the permit.
4. **Test Procedures.** The analytical and sampling methods used shall conform to the reference methods listed in 10 CSR 20-7.015 unless alternates are approved by the Department. The facility shall use sufficiently sensitive analytical methods for detecting, identifying, and measuring the concentrations of pollutants. The facility shall ensure that the selected methods are able to quantify the presence of pollutants in a given discharge at concentrations that are low enough to determine compliance with Water Quality Standards in 10 CSR 20-7.031 or effluent limitations unless provisions in the permit allow for other alternatives. A method is “sufficiently sensitive” when; 1) the method minimum level is at or below the level of the applicable water quality criterion for the pollutant or, 2) the method minimum level is above the applicable water quality criterion, but the amount of pollutant in a facility’s discharge is high enough that the method detects and quantifies the level of pollutant in the discharge, or 3) the method has the lowest minimum level of the analytical methods approved under 10 CSR 20-7.015. These methods are also required for parameters that are listed as monitoring only, as the data collected may be used to determine if limitations need to be established. A permittee is responsible for working with their contractors to ensure that the analysis performed is sufficiently sensitive.
5. **Record Retention.** Except for records of monitoring information required by the permit related to the permittee’s sewage sludge use and disposal activities, which shall be retained for a period of at least five (5) years (or longer as required by 40 CFR part 503), the permittee shall retain records of all monitoring information, including all calibration and maintenance records and all original strip chart recordings for continuous monitoring instrumentation, copies of all reports required by the permit, and records of all data used to complete the application for the permit, for a period of at least three (3) years from the date of the sample, measurement, report or application. This period may be extended by request of the Department at any time.

6. **Illegal Activities.**
 - a. The Federal Clean Water Act provides that any person who falsifies, tampers with, or knowingly renders inaccurate any monitoring device or method required to be maintained under the permit shall, upon conviction, be punished by a fine of not more than \$10,000, or by imprisonment for not more than two (2) years, or both. If a conviction of a person is for a violation committed after a first conviction of such person under this paragraph, punishment is a fine of not more than \$20,000 per day of violation, or by imprisonment of not more than four (4) years, or both.
 - b. The Missouri Clean Water Law provides that any person or who falsifies, tampers with, or knowingly renders inaccurate any monitoring device or method required to be maintained pursuant to sections 644.006 to 644.141 shall, upon conviction, be punished by a fine of not more than \$10,000, or by imprisonment for not more than six (6) months, or by both. Second and successive convictions for violation under this paragraph by any person shall be punished by a fine of not more than \$50,000 per day of violation, or by imprisonment for not more than two (2) years, or both.

Section B – Reporting Requirements

1. **Planned Changes.**
 - a. The permittee shall give notice to the Department as soon as possible of any planned physical alterations or additions to the permitted facility when:
 - i. The alteration or addition to a permitted facility may meet one of the criteria for determining whether a facility is a new source in 40 CFR 122.29(b); or
 - ii. The alteration or addition could significantly change the nature or increase the quantity of pollutants discharged. This notification applies to pollutants which are subject neither to effluent limitations in the permit, nor to notification requirements under 40 CFR 122.42;
 - iii. The alteration or addition results in a significant change in the permittee’s sludge use or disposal practices, and such alteration, addition, or change may justify the application of permit conditions that are different from or absent in the existing permit, including notification of additional use or disposal sites not reported during the permit application process or not reported pursuant to an approved land application plan;
 - iv. Any facility expansions, production increases, or process modifications which will result in a new or substantially different discharge or sludge characteristics must be reported to the Department 60 days before the facility or process modification begins. Notification may be accomplished by application for a new permit. If the discharge does not violate effluent limitations specified in the permit, the facility is to submit a notice to the Department of the changed discharge at least 30 days before such changes. The Department may require a construction permit and/or permit modification as a result of the proposed changes at the facility.
2. **Non-compliance Reporting.**
 - a. The permittee shall report any noncompliance which may endanger health or the environment. Relevant information shall be provided orally or via the current electronic method approved by the Department, within 24 hours from the time the permittee becomes aware of the circumstances, and shall be reported to the appropriate Regional Office during normal business hours or the Environmental Emergency Response hotline at 573-634-2436 outside of normal business hours. A written submission shall also be provided within five (5) business days of the time the permittee becomes aware of the circumstances. The written submission shall contain a description of the noncompliance and its cause; the period of noncompliance, including exact dates and times, and if the noncompliance has not been corrected, the anticipated time it is expected to continue; and steps taken or planned to reduce, eliminate, and prevent reoccurrence of the noncompliance.



STANDARD CONDITIONS FOR NPDES PERMITS
ISSUED BY
THE MISSOURI DEPARTMENT OF NATURAL RESOURCES
MISSOURI CLEAN WATER COMMISSION
REVISED
AUGUST 1, 2014

- b. The following shall be included as information which must be reported within 24 hours under this paragraph.
 - i. Any unanticipated bypass which exceeds any effluent limitation in the permit.
 - ii. Any upset which exceeds any effluent limitation in the permit.
 - iii. Violation of a maximum daily discharge limitation for any of the pollutants listed by the Department in the permit required to be reported within 24 hours.
 - c. The Department may waive the written report on a case-by-case basis for reports under paragraph 2. b. of this section if the oral report has been received within 24 hours.
3. **Anticipated Noncompliance.** The permittee shall give advance notice to the Department of any planned changes in the permitted facility or activity which may result in noncompliance with permit requirements. The notice shall be submitted to the Department 60 days prior to such changes or activity.
 4. **Compliance Schedules.** Reports of compliance or noncompliance with, or any progress reports on, interim and final requirements contained in any compliance schedule of the permit shall be submitted no later than 14 days following each schedule date. The report shall provide an explanation for the instance of noncompliance and a proposed schedule or anticipated date, for achieving compliance with the compliance schedule requirement.
 5. **Other Noncompliance.** The permittee shall report all instances of noncompliance not reported under paragraphs 2, 3, and 6 of this section, at the time monitoring reports are submitted. The reports shall contain the information listed in paragraph 2. a. of this section.
 6. **Other Information.** Where the permittee becomes aware that it failed to submit any relevant facts in a permit application, or submitted incorrect information in a permit application or in any report to the Department, it shall promptly submit such facts or information.
 7. **Discharge Monitoring Reports.**
 - a. Monitoring results shall be reported at the intervals specified in the permit.
 - b. Monitoring results must be reported to the Department via the current method approved by the Department, unless the permittee has been granted a waiver from using the method. If the permittee has been granted a waiver, the permittee must use forms provided by the Department.
 - c. Monitoring results shall be reported to the Department no later than the 28th day of the month following the end of the reporting period.
- b. Notice.
 - i. Anticipated bypass. If the permittee knows in advance of the need for a bypass, it shall submit prior notice, if possible at least 10 days before the date of the bypass.
 - ii. Unanticipated bypass. The permittee shall submit notice of an unanticipated bypass as required in Section B – Reporting Requirements, paragraph 5 (24-hour notice).
 - c. Prohibition of bypass.
 - i. Bypass is prohibited, and the Department may take enforcement action against a permittee for bypass, unless:
 1. Bypass was unavoidable to prevent loss of life, personal injury, or severe property damage;
 2. There were no feasible alternatives to the bypass, such as the use of auxiliary treatment facilities, retention of untreated wastes, or maintenance during normal periods of equipment downtime. This condition is not satisfied if adequate back-up equipment should have been installed in the exercise of reasonable engineering judgment to prevent a bypass which occurred during normal periods of equipment downtime or preventive maintenance; and
 3. The permittee submitted notices as required under paragraph 2. b. of this section.
 - ii. The Department may approve an anticipated bypass, after considering its adverse effects, if the Department determines that it will meet the three (3) conditions listed above in paragraph 2. c. i. of this section.
3. **Upset Requirements.**
 - a. Effect of an upset. An upset constitutes an affirmative defense to an action brought for noncompliance with such technology based permit effluent limitations if the requirements of paragraph 3. b. of this section are met. No determination made during administrative review of claims that noncompliance was caused by upset, and before an action for noncompliance, is final administrative action subject to judicial review.
 - b. Conditions necessary for a demonstration of upset. A permittee who wishes to establish the affirmative defense of upset shall demonstrate, through properly signed, contemporaneous operating logs, or other relevant evidence that:
 - i. An upset occurred and that the permittee can identify the cause(s) of the upset;
 - ii. The permitted facility was at the time being properly operated; and
 - iii. The permittee submitted notice of the upset as required in Section B – Reporting Requirements, paragraph 2. b. ii. (24-hour notice).
 - iv. The permittee complied with any remedial measures required under Section D – Administrative Requirements, paragraph 4.
 - c. Burden of proof. In any enforcement proceeding, the permittee seeking to establish the occurrence of an upset has the burden of proof.

Section C – Bypass/Upset Requirements

1. **Definitions.**
 - a. *Bypass*: the intentional diversion of waste streams from any portion of a treatment facility, except in the case of blending.
 - b. *Severe Property Damage*: substantial physical damage to property, damage to the treatment facilities which causes them to become inoperable, or substantial and permanent loss of natural resources which can reasonably be expected to occur in the absence of a bypass. Severe property damage does not mean economic loss caused by delays in production.
 - c. *Upset*: an exceptional incident in which there is unintentional and temporary noncompliance with technology based permit effluent limitations because of factors beyond the reasonable control of the permittee. An upset does not include noncompliance to the extent caused by operational error, improperly designed treatment facilities, inadequate treatment facilities, lack of preventive maintenance, or careless or improper operation.
2. **Bypass Requirements.**
 - a. Bypass not exceeding limitations. The permittee may allow any bypass to occur which does not cause effluent limitations to be exceeded, but only if it also is for essential maintenance to assure efficient operation. These bypasses are not subject to the provisions of paragraphs 2. b. and 2. c. of this section.

Section D – Administrative Requirements

1. **Duty to Comply.** The permittee must comply with all conditions of this permit. Any permit noncompliance constitutes a violation of the Missouri Clean Water Law and Federal Clean Water Act and is grounds for enforcement action; for permit termination, revocation and reissuance, or modification; or denial of a permit renewal application.
 - a. The permittee shall comply with effluent standards or prohibitions established under section 307(a) of the Federal Clean Water Act for toxic pollutants and with standards for sewage sludge use or disposal established under section 405(d) of the CWA within the time provided in the regulations that establish these standards or prohibitions or standards for sewage sludge use or disposal, even if the permit has not yet been modified to incorporate the requirement.
 - b. The Federal Clean Water Act provides that any person who violates section 301, 302, 306, 307, 308, 318 or 405 of the Act, or any permit condition or limitation implementing any such sections in a permit issued under section 402, or any requirement imposed in a pretreatment program approved under sections 402(a)(3) or 402(b)(8) of the Act, is subject to a civil penalty not to exceed \$25,000 per day for each violation. The Federal Clean Water Act provides that any person who negligently violates sections 301, 302, 306, 307, 308, 318, or 405 of the Act, or any condition or limitation implementing any of such sections in a permit issued under section 402 of the Act, or any requirement



STANDARD CONDITIONS FOR NPDES PERMITS
ISSUED BY
THE MISSOURI DEPARTMENT OF NATURAL RESOURCES
MISSOURI CLEAN WATER COMMISSION
REVISED
AUGUST 1, 2014

- imposed in a pretreatment program approved under section 402(a)(3) or 402(b)(8) of the Act, is subject to criminal penalties of \$2,500 to \$25,000 per day of violation, or imprisonment of not more than one (1) year, or both. In the case of a second or subsequent conviction for a negligent violation, a person shall be subject to criminal penalties of not more than \$50,000 per day of violation, or by imprisonment of not more than two (2) years, or both. Any person who knowingly violates such sections, or such conditions or limitations is subject to criminal penalties of \$5,000 to \$50,000 per day of violation, or imprisonment for not more than three (3) years, or both. In the case of a second or subsequent conviction for a knowing violation, a person shall be subject to criminal penalties of not more than \$100,000 per day of violation, or imprisonment of not more than six (6) years, or both. Any person who knowingly violates section 301, 302, 303, 306, 307, 308, 318 or 405 of the Act, or any permit condition or limitation implementing any of such sections in a permit issued under section 402 of the Act, and who knows at that time that he thereby places another person in imminent danger of death or serious bodily injury, shall, upon conviction, be subject to a fine of not more than \$250,000 or imprisonment of not more than 15 years, or both. In the case of a second or subsequent conviction for a knowing endangerment violation, a person shall be subject to a fine of not more than \$500,000 or by imprisonment of not more than 30 years, or both. An organization, as defined in section 309(c)(3)(B)(iii) of the CWA, shall, upon conviction of violating the imminent danger provision, be subject to a fine of not more than \$1,000,000 and can be fined up to \$2,000,000 for second or subsequent convictions.
- c. Any person may be assessed an administrative penalty by the EPA Director for violating section 301, 302, 306, 307, 308, 318 or 405 of this Act, or any permit condition or limitation implementing any of such sections in a permit issued under section 402 of this Act. Administrative penalties for Class I violations are not to exceed \$10,000 per violation, with the maximum amount of any Class I penalty assessed not to exceed \$25,000. Penalties for Class II violations are not to exceed \$10,000 per day for each day during which the violation continues, with the maximum amount of any Class II penalty not to exceed \$125,000.
- d. It is unlawful for any person to cause or permit any discharge of water contaminants from any water contaminant or point source located in Missouri in violation of sections 644.006 to 644.141 of the Missouri Clean Water Law, or any standard, rule or regulation promulgated by the commission. In the event the commission or the director determines that any provision of sections 644.006 to 644.141 of the Missouri Clean Water Law or standard, rules, limitations or regulations promulgated pursuant thereto, or permits issued by, or any final abatement order, other order, or determination made by the commission or the director, or any filing requirement pursuant to sections 644.006 to 644.141 of the Missouri Clean Water Law or any other provision which this state is required to enforce pursuant to any federal water pollution control act, is being, was, or is in imminent danger of being violated, the commission or director may cause to have instituted a civil action in any court of competent jurisdiction for the injunctive relief to prevent any such violation or further violation or for the assessment of a penalty not to exceed \$10,000 per day for each day, or part thereof, the violation occurred and continues to occur, or both, as the court deems proper. Any person who willfully or negligently commits any violation in this paragraph shall, upon conviction, be punished by a fine of not less than \$2,500 nor more than \$25,000 per day of violation, or by imprisonment for not more than one year, or both. Second and successive convictions for violation of the same provision of this paragraph by any person shall be punished by a fine of not more than \$50,000 per day of violation, or by imprisonment for not more than two (2) years, or both.
2. **Duty to Reapply.**
- a. If the permittee wishes to continue an activity regulated by this permit after the expiration date of this permit, the permittee must apply for and obtain a new permit.
- b. A permittee with a currently effective site-specific permit shall submit an application for renewal at least 180 days before the expiration date of the existing permit, unless permission for a later date has been granted by the Department. (The Department shall not grant permission for applications to be submitted later than the expiration date of the existing permit.)
- c. A permittee with currently effective general permit shall submit an application for renewal at least 30 days before the existing permit expires, unless the permittee has been notified by the Department that an earlier application must be made. The Department may grant permission for a later submission date. (The Department shall not grant permission for applications to be submitted later than the expiration date of the existing permit.)
3. **Need to Halt or Reduce Activity Not a Defense.** It shall not be a defense for a permittee in an enforcement action that it would have been necessary to halt or reduce the permitted activity in order to maintain compliance with the conditions of this permit.
4. **Duty to Mitigate.** The permittee shall take all reasonable steps to minimize or prevent any discharge or sludge use or disposal in violation of this permit which has a reasonable likelihood of adversely affecting human health or the environment.
5. **Proper Operation and Maintenance.** The permittee shall at all times properly operate and maintain all facilities and systems of treatment and control (and related appurtenances) which are installed or used by the permittee to achieve compliance with the conditions of this permit. Proper operation and maintenance also includes adequate laboratory controls and appropriate quality assurance procedures. This provision requires the operation of back-up or auxiliary facilities or similar systems which are installed by a permittee only when the operation is necessary to achieve compliance with the conditions of the permit.
6. **Permit Actions.**
- a. Subject to compliance with statutory requirements of the Law and Regulations and applicable Court Order, this permit may be modified, suspended, or revoked in whole or in part during its term for cause including, but not limited to, the following:
- i. Violations of any terms or conditions of this permit or the law;
- ii. Having obtained this permit by misrepresentation or failure to disclose fully any relevant facts;
- iii. A change in any circumstances or conditions that requires either a temporary or permanent reduction or elimination of the authorized discharge; or
- iv. Any reason set forth in the Law or Regulations.
- b. The filing of a request by the permittee for a permit modification, revocation and reissuance, or termination, or a notification of planned changes or anticipated noncompliance does not stay any permit condition.
7. **Permit Transfer.**
- a. Subject to 10 CSR 20-6.010, an operating permit may be transferred upon submission to the Department of an application to transfer signed by the existing owner and the new owner, unless prohibited by the terms of the permit. Until such time the permit is officially transferred, the original permittee remains responsible for complying with the terms and conditions of the existing permit.
- b. The Department may require modification or revocation and reissuance of the permit to change the name of the permittee and incorporate such other requirements as may be necessary under the Missouri Clean Water Law or the Federal Clean Water Act.
- c. The Department, within 30 days of receipt of the application, shall notify the new permittee of its intent to revoke or reissue or transfer the permit.
8. **Toxic Pollutants.** The permittee shall comply with effluent standards or prohibitions established under section 307(a) of the Federal Clean Water Act for toxic pollutants and with standards for sewage sludge use or disposal established under section 405(d) of the Federal Clean Water Act within the time provided in the regulations that establish these standards or prohibitions or standards for sewage sludge use or disposal, even if the permit has not yet been modified to incorporate the requirement.
9. **Property Rights.** This permit does not convey any property rights of any sort, or any exclusive privilege.



STANDARD CONDITIONS FOR NPDES PERMITS
ISSUED BY
THE MISSOURI DEPARTMENT OF NATURAL RESOURCES
MISSOURI CLEAN WATER COMMISSION
REVISED
AUGUST 1, 2014

10. **Duty to Provide Information.** The permittee shall furnish to the Department, within a reasonable time, any information which the Department may request to determine whether cause exists for modifying, revoking and reissuing, or terminating this permit or to determine compliance with this permit. The permittee shall also furnish to the Department upon request, copies of records required to be kept by this permit.
11. **Inspection and Entry.** The permittee shall allow the Department, or an authorized representative (including an authorized contractor acting as a representative of the Department), upon presentation of credentials and other documents as may be required by law, to:
 - a. Enter upon the permittee's premises where a regulated facility or activity is located or conducted, or where records must be kept under the conditions of the permit;
 - b. Have access to and copy, at reasonable times, any records that must be kept under the conditions of this permit;
 - c. Inspect at reasonable times any facilities, equipment (including monitoring and control equipment), practices, or operations regulated or required under this permit; and
 - d. Sample or monitor at reasonable times, for the purposes of assuring permit compliance or as otherwise authorized by the Federal Clean Water Act or Missouri Clean Water Law, any substances or parameters at any location.
12. **Closure of Treatment Facilities.**
 - a. Persons who cease operation or plan to cease operation of waste, wastewater, and sludge handling and treatment facilities shall close the facilities in accordance with a closure plan approved by the Department.
 - b. Operating Permits under 10 CSR 20-6.010 or under 10 CSR 20-6.015 are required until all waste, wastewater, and sludges have been disposed of in accordance with the closure plan approved by the Department and any disturbed areas have been properly stabilized. Disturbed areas will be considered stabilized when perennial vegetation, pavement, or structures using permanent materials cover all areas that have been disturbed. Vegetative cover, if used, shall be at least 70% plant density over 100% of the disturbed area.
13. **Signatory Requirement.**
 - a. All permit applications, reports required by the permit, or information requested by the Department shall be signed and certified. (See 40 CFR 122.22 and 10 CSR 20-6.010)
 - b. The Federal Clean Water Act provides that any person who knowingly makes any false statement, representation, or certification in any record or other document submitted or required to be maintained under this permit, including monitoring reports or reports of compliance or non-compliance shall, upon conviction, be punished by a fine of not more than \$10,000 per violation, or by imprisonment for not more than six (6) months per violation, or by both.
 - c. The Missouri Clean Water Law provides that any person who knowingly makes any false statement, representation or certification in any application, record, report, plan, or other document filed or required to be maintained pursuant to sections 644.006 to 644.141 shall, upon conviction, be punished by a fine of not more than ten thousand dollars, or by imprisonment for not more than six months, or by both.
14. **Severability.** The provisions of the permit are severable, and if any provision of the permit, or the application of any provision of the permit to any circumstance, is held invalid, the application of such provision to other circumstances, and the remainder of the permit, shall not be affected thereby.

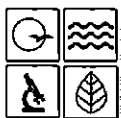

MISSOURI DEPARTMENT OF NATURAL RESOURCES
WATER PROTECTION PROGRAM
**FORM A – APPLICATION FOR NONDOMESTIC PERMIT UNDER MISSOURI
CLEAN WATER LAW**

FOR AGENCY USE ONLY

CHECK NUMBER

DATE RECEIVED
04/01/2022

FEE SUBMITTED

JET PAY CONFIRMATION NUMBER
ACH3DAS2321

**PLEASE READ ALL THE ACCOMPANYING INSTRUCTIONS BEFORE COMPLETING THIS FORM.
SUBMITTAL OF AN INCOMPLETE APPLICATION MAY RESULT IN THE APPLICATION BEING RETURNED.**

IF YOUR FACILITY IS ELIGIBLE FOR A NO EXPOSURE EXEMPTION:Fill out the No Exposure Certification Form (Mo 780-2828): <https://dnr.mo.gov/forms/780-2828-f.pdf>**1. REASON FOR APPLICATION:**

- ☒ a. This facility is now in operation under Missouri State Operating Permit (permit) MO – 0122963, is submitting an application for renewal, and there is no proposed increase in design wastewater flow. Annual fees will be paid when invoiced and there is no additional permit fee required for renewal.
- ☐ b. This facility is now in operation under permit MO – _____, is submitting an application for renewal, and there is a proposed increase in design wastewater flow. Antidegradation Review may be required. Annual fees will be paid when invoiced and there is no additional permit fee required for renewal.
- ☐ c. This is a facility submitting an application for a new permit (for a new facility). Antidegradation Review may be required. New permit fee is required.
- ☐ d. This facility is now in operation under Missouri State Operating Permit (permit) MO – _____ and is requesting a modification to the permit. Antidegradation Review may be required. Modification fee is required.

2. FACILITY

NAME AECI, Nodaway Power Plant		TELEPHONE NUMBER WITH AREA CODE	
ADDRESS (PHYSICAL) 31491 300th Street	CITY Conception Junction	STATE MO	ZIP CODE 64434

3. OWNER

NAME Associated Electric Cooperative, Inc.		TELEPHONE NUMBER WITH AREA CODE 417-881-1204	
EMAIL ADDRESS rbennett@aeci.org			
ADDRESS (MAILING) P.O. Box 754	CITY Springfield	STATE MO	ZIP CODE 65807

4. CONTINUING AUTHORITY

NAME Associated Electric Cooperative, Inc.		TELEPHONE NUMBER WITH AREA CODE	
EMAIL ADDRESS rbennett@aeci.org			
ADDRESS (MAILING) P.O. Box 754	CITY Springfield	STATE MO	ZIP CODE 65807

5. OPERATOR CERTIFICATION

NAME N/A	CERTIFICATE NUMBER	TELEPHONE NUMBER WITH AREA CODE	
ADDRESS (MAILING)	CITY	STATE	ZIP CODE

6. FACILITY CONTACT

NAME Karl Dreher	TITLE Combustion Turbine Specialist	TELEPHONE NUMBER WITH AREA CODE 660-582-5114
E-MAIL ADDRESS kdreher@aeci.org		

7. DOWNSTREAM LANDOWNER(S) Attach additional sheets as necessary.

NAME Stephen & Myrna Spurlock			
ADDRESS 29002 Highway F	CITY Maryville	STATE MO	ZIP CODE 64468

8. ADDITIONAL FACILITY INFORMATION**8.1 Legal Description of Outfalls. (Attach additional sheets if necessary.)***For Universal Transverse Mercator (UTM), use Zone 15 North referenced to North American Datum 1983 (NAD83)*

001 SE $\frac{1}{4}$ SW $\frac{1}{4}$ Sec 1 T 63N R 35W _____ County
UTM Coordinates Easting (X): 347569 Northing (Y): 4461220

002 _____ $\frac{1}{4}$ _____ $\frac{1}{4}$ Sec _____ T _____ R _____ County
UTM Coordinates Easting (X): _____ Northing (Y): _____

003 _____ $\frac{1}{4}$ _____ $\frac{1}{4}$ Sec _____ T _____ R _____ County
UTM Coordinates Easting (X): _____ Northing (Y): _____

004 _____ $\frac{1}{4}$ _____ $\frac{1}{4}$ Sec _____ T _____ R _____ County
UTM Coordinates Easting (X): _____ Northing (Y): _____

Include all subsurface discharges and underground injection systems for permit consideration.

8.2 Primary Standard Industrial Classification (SIC) and Facility North American Industrial Classification System (NAICS) Codes.

Primary SIC 4911 and NAICS 221112 SIC _____ and NAICS _____
SIC _____ and NAICS _____ SIC _____ and NAICS _____

9. ADDITIONAL FORMS AND MAPS NECESSARY TO COMPLETE THIS APPLICATION

- A. Is this permit for a manufacturing, commercial, mining, solid/hazardous waste, or silviculture facility? YES ☒ NO ☐
If yes, complete Form C.
- B. Is the facility considered a "Primary Industry" under EPA guidelines (40 CFR Part 122, Appendix A): YES ☐ NO ☒
If yes, complete Forms C and D.
- C. Is wastewater land applied? YES ☐ NO ☒
If yes, complete Form I.
- D. Are sludge, biosolids, ash, or residuals generated, treated, stored, or land applied? YES ☐ NO ☒
If yes, complete Form R.
- E. Have you received or applied for any permit or construction approval under the CWA or any other environmental regulatory authority? YES ☐ NO ☒
If yes, please include a list of all permits or approvals for this facility:
Environmental Permits for this facility: _____
- F. Do you use cooling water in your operations at this facility? YES ☐ NO ☒
If yes, please indicate the source of the water: _____
- G. Attach a map showing all outfalls and the receiving stream at 1" = 2,000' scale.

10. ELECTRONIC DISCHARGE MONITORING REPORT (eDMR) SUBMISSION SYSTEM

Per 40 CFR Part 127 National Pollutant Discharge Elimination System (NPDES) Electronic Reporting Rule, reporting of effluent limits and monitoring shall be submitted by the permittee via an electronic system to ensure timely, complete, accurate, and nationally consistent set of data. **One of the following must be checked in order for this application to be considered complete.** Please visit <https://dnr.mo.gov/env/wpp/edmr.htm> for information on the Department's eDMR system and how to register.

- ☐ - I will register an account online to participate in the Department's eDMR system through the Missouri Gateway for Environmental Management (MoGEM) before any reporting is due, in compliance with the Electronic Reporting Rule.
- ☒ - I have already registered an account online to participate in the Department's eDMR system through MoGEM.
- ☐ - I have submitted a written request for a waiver from electronic reporting. See instructions for further information regarding waivers.
- ☐ - The permit I am applying for does not require the submission of discharge monitoring reports.

11. FEES

Permit fees may be paid by attaching a check, or online by credit card or eCheck through the JetPay system. Use the URL provided to access JetPay and make an online payment:

For new permits: <https://magic.collectorsolutions.com/magic-ui/payments/mo-natural-resources/591>

For modifications: <https://magic.collectorsolutions.com/magic-ui/payments/mo-natural-resources/596>

12. CERTIFICATION

I certify under penalty of law that this document and all attachments were prepared under my direction or supervision in accordance with a system designed to assure that qualified personnel properly gather and evaluate the information submitted. Based on my inquiry of the person or persons who manage the system, or those persons directly responsible for gathering the information, the information submitted is, to the best of my knowledge and belief, true, accurate, and complete. I am aware that there are significant penalties for submitting false information, including the possibility of fine and imprisonment for knowing violations.

NAME AND OFFICIAL TITLE (TYPE OR PRINT)

Ken Wilmot - Senior Vice President & Chief Operations Officer

TELEPHONE NUMBER WITH AREA CODE

417-881-1204

SIGNATURE

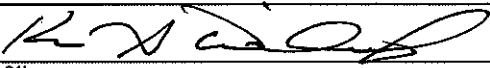

DATE SIGNED

5/25/22

MO 780-1479 (04-21)

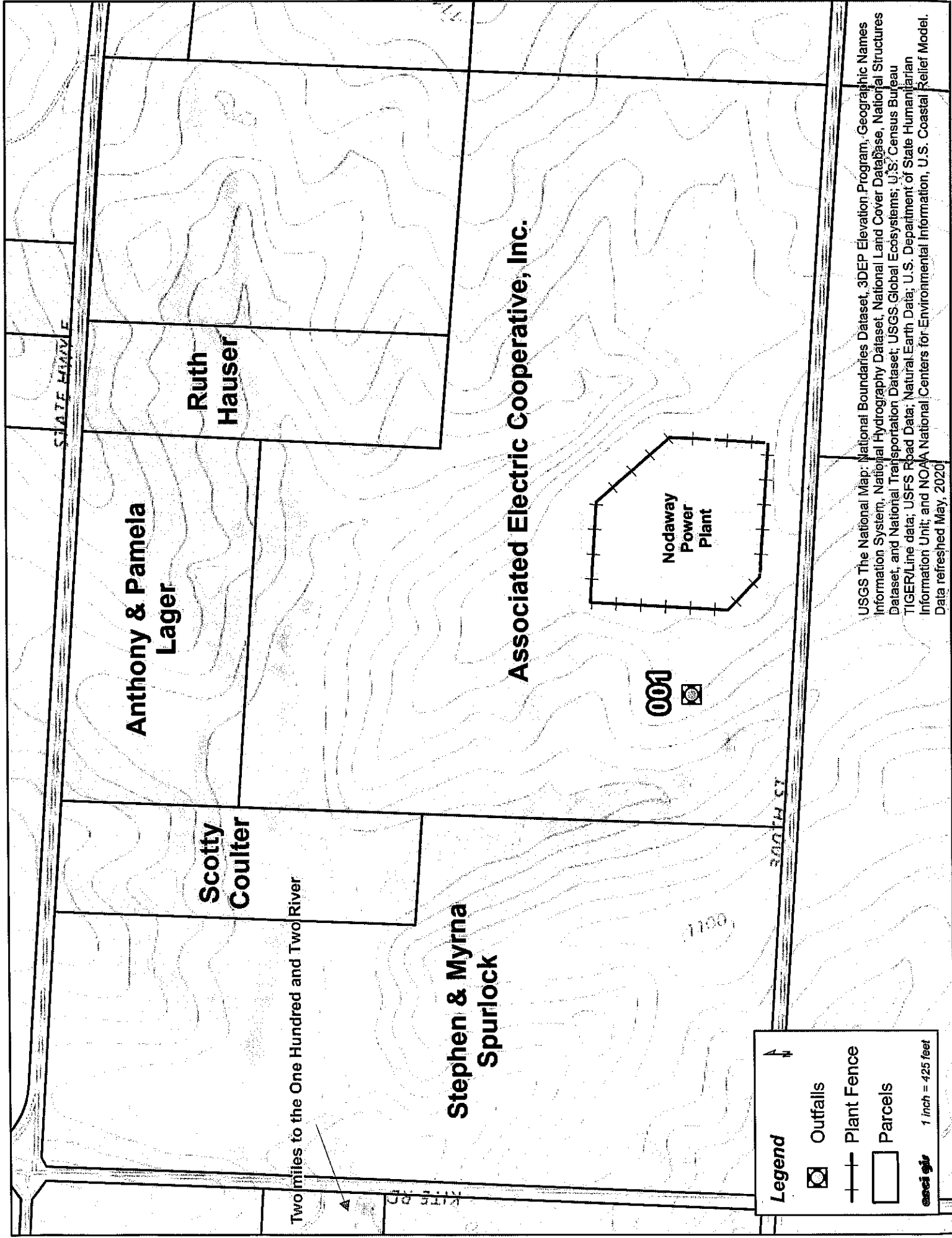

Anthony & Pamela
Lager

Ruth
Hauser

Scotty
Coulter

Stephen & Myrna
Spurlock

Associated Electric Cooperative, Inc.

Nodaway
Power
Plant

001

Two miles to the One Hundred and Two River

Legend

- Outfalls
- Plant Fence
- Parcels

1 inch = 425 feet

USGS The National Map: National Boundaries Dataset, 3DEP Elevation Program, Geographic Names Information System, National Hydrography Dataset, National Land Cover Database, National Structures Dataset, and National Transportation Dataset; USGS Global Ecosystems; U.S. Census Bureau TIGER/Line data; USFS Road Data; Natural Earth Data; U.S. Department of State Humanitarian Information Unit; and NOAA National Centers for Environmental Information, U.S. Coastal Relief Model. Data refreshed May, 2020

