

STATE OF MISSOURI  
**DEPARTMENT OF NATURAL RESOURCES**

MISSOURI CLEAN WATER COMMISSION

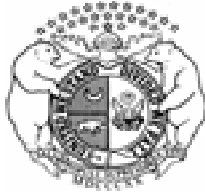

**MISSOURI STATE OPERATING PERMIT**

In compliance with the Missouri Clean Water Law, (Chapter 644 R.S. Mo. as amended, hereinafter, the Law), and the Federal Water Pollution Control Act (Public Law 92-500, 92<sup>nd</sup> Congress) as amended,

Permit No. MO-0119831

Owner: Leath & Sons, Inc.  
Address: 11606 E. 67<sup>th</sup> Street, Raytown, MO 64133

Continuing Authority: Same as above  
Address: Same as above

Facility Name: Leath & Sons, Inc.  
Address: 6603 S. Noland Road, Kansas City, MO 64133

Legal Description: SE¼, NE¼, Sec 11, T48N, R32W; Jackson County

Receiving Stream: Tributary to Little Blue River (U)  
First Classified Stream and ID: Little Blue River (C) (00423)  
USGS Basin & Sub-watershed No.: (10300101 – 050002)

is authorized to discharge from the facility described herein, in accordance with the effluent limitations and monitoring requirements as set forth herein:

**FACILITY DESCRIPTION**

Outfall #001 – Industrial- SIC # 3531  
Stormwater run-off from plant site.  
Design flow is dependant upon rainfall.

This permit authorizes only wastewater discharges under the Missouri Clean Water Law and the National Pollutant Discharge Elimination System; it does not apply to other regulated areas. This permit may be appealed in accordance with Section 644.051.6 of the Law.

October 12, 2007  
Effective Date

Doyle Childers, Director, Department of Natural Resources  
Executive Secretary, Clean Water Commission

October 11, 2012  
Expiration Date

Karl Fett, Director, Kansas City Regional Office

<b>A. EFFLUENT LIMITATIONS AND MONITORING REQUIREMENTS</b>					PAGE NUMBER 2 of 3	
					PERMIT NUMBER MO-0119831	
The permittee is authorized to discharge from outfall(s) with serial number(s) as specified in the application for this permit. The final effluent limitations shall become effective upon issuance and remain in effect until expiration of the permit. Such discharges shall be controlled, limited and monitored by the permittee as specified below:						
OUTFALL NUMBER AND EFFLUENT PARAMETER(S)	UNITS	FINAL EFFLUENT LIMITATIONS			MONITORING REQUIREMENTS	
		DAILY MAXIMUM	WEEKLY AVERAGE	MONTHLY AVERAGE	MEASUREMENT FREQUENCY	SAMPLE TYPE
<u>Outfall #001 &amp; #004</u>						
Flow	MGD	*		*	Once/ quarter	24 hr. estimate
pH – Units	SU	**		**	Once/ quarter	grab
Biochemical Oxygen Demand	mg/L		65	45	Once/ quarter	grab
Settleable Solids	mL/L/HR	1.5		1.0	Once/ quarter	grab
Total Suspended Solids	mg/L		110	70	Once/ quarter	grab
Color***	Description	*		*	Once/ quarter	grab
MONITORING REPORTS SHALL BE SUBMITTED <u>QUARTERLY</u> ; THE FIRST REPORT IS DUE <u>January 28, 2008</u> . THERE SHALL BE NO DISCHARGE OF FLOATING SOLIDS OR VISIBLE FOAM IN OTHER THAN TRACE AMOUNTS.						
<b>B. STANDARD CONDITIONS</b>						
IN ADDITION TO SPECIFIED CONDITIONS STATED HEREIN, THIS PERMIT IS SUBJECT TO THE ATTACHED <u>Parts I &amp; III</u> STANDARD CONDITIONS DATED <u>October 1, 1980 and August 15, 1994</u> , AND HEREBY INCORPORATED AS THOUGH FULLY SET FORTH HEREIN.						

MO 780-0010 (8/91)

**A. EFFLUENT LIMITATIONS AND MONITORING REQUIREMENTS** (continued)

- \* Monitoring requirement only.
- \*\* pH is measured in pH units and is not to be averaged. The pH is limited to the range of 6.0-9.0 pH units.
- \*\*\* Provide a visual description of the effluent For example: clear, green, brown ,turbid, etc.

**C. SPECIAL CONDITIONS**

1. This permit may be reopened and modified, or alternatively revoked and reissued, to:
  - (a) Comply with any applicable effluent standard or limitation issued or approved under Sections 301(b)(2)(C) and (D), 304(b)(2), and 307(a) (2) of the Clean Water Act, if the effluent standard or limitation so issued or approved:
    - (1) contains different conditions or is otherwise more stringent than any effluent limitation in the permit; or
    - (2) controls any pollutant not limited in the permit.
  - (b) Incorporate new or modified effluent limitations or other conditions, if the result of a waste load allocation study, toxicity test or other information indicates changes are necessary to assure compliance with Missouri's Water Quality Standard.
  - (c) Incorporate new or modified effluent limitations or other conditions if, as the result of a watershed analysis, a Total Maximum Daily Load (TMDL) limitation is developed for the receiving waters which are currently included in Missouri's list of waters of the state not fully achieving the state's water quality standards, also called the 303(d) list.

The permit as modified or reissued under this paragraph shall also contain any other requirements of the Clean Water Act then applicable.

2. All outfalls must be clearly marked in the field.

C. SPECIAL CONDITIONS (continued)

3. Permittee will cease discharge by connection to areawide wastewater treatment system within 90 days of notice of its availability.

4. Changes in Discharges of Toxic Substances

The permittee shall notify the Director as soon as it knows or has reason to believe:

- (a) That any activity has occurred or will occur which would result in the discharge of any toxic pollutant which is not limited in the permit, if that discharge will exceed the highest of the following "notification levels:"
  - (1) One hundred micrograms per liter (100 µg/L);
  - (2) Two hundred micrograms per liter (200 µg/L) for acrolein and acrylonitrile; five hundred micrograms per liter (500 µg/L) for 2,5 dinitrophenol and for 2-methyl-4, 6-dinitrophenol; and one milligram per liter (1 mg/L) for antimony;
  - (3) Five (5) times the maximum concentration value reported for the pollutant in the permit application;
  - (4) The level established in Part A of the permit by the Director.
- (b) That they have begun or expect to begin to use or manufacture as an intermediate or final product or byproduct any toxic pollutant, which was not reported in the permit application.

5. Report as no-discharge when a discharge does not occur during the report period.

6. Water Quality Standards

- (a) Discharges to waters of the state shall not cause a violation of water quality standards rule under 10 CSR 20-7.031, including both specific and general criteria.
- (b) General Criteria. The following general water quality criteria shall be applicable to all waters of the state at all times including mixing zones. No water contaminant, by itself or in combination with other substances, shall prevent the waters of the state from meeting the following conditions:
  - (1) Waters shall be free from substances in sufficient amounts to cause the formation of putrescent, unsightly or harmful bottom deposits or prevent full maintenance of beneficial uses.
  - (2) Waters shall be free from oil, scum and floating debris in sufficient amounts to be unsightly or prevent full maintenance of beneficial uses;
  - (3) Waters shall be free from substances in sufficient amounts to cause unsightly color or turbidity, offensive odor or prevent full maintenance of beneficial uses;
  - (4) Waters shall be free from substances or conditions in sufficient amounts to result in toxicity to human, animal or aquatic life;
  - (5) There shall be no significant human health hazard from incidental contact with the water;
  - (6) There shall be no acute toxicity to livestock or wildlife watering;
  - (7) Waters shall be free from physical, chemical or hydrologic changes that would impair the natural biological community;
  - (8) Waters shall be free from used tires, car bodies, appliances, demolition debris, used vehicles or equipment and solid waste as defined in Missouri's Solid Waste Law, section 260.200, RSMo, except as the use of such materials is specifically permitted pursuant to section 260.200-260.2

7. Sludge and Biosolids Use For Domestic Wastewater Treatment Facilities

- (a) Permittee shall comply with the pollutant limitations, monitoring, reporting, and other requirements in accordance with the attached permit Standard Conditions.
- (b) If sludge is not removed by a contract hauler, permittee is authorized to land apply biosolids. Permit Standard Conditions, Part III shall apply to the land application of biosolids. Permittee shall notify the department at least 180 days prior to the planned removal of biosolids. The department may require submittal of a biosolids management plan for department review and approval as determined appropriate on a case-by-case basis.

Date of Fact Sheet: 12/28/06

Date of Public Notice: 08/03/07

NATIONAL POLLUTANT DISCHARGE ELIMINATION SYSTEM (NPDES) PERMIT  
FACT SHEET

This Fact Sheet explains the applicable regulations, rationale for development of this permit and the public participation process.

NPDES PERMIT NUMBER: MO-0119831

FACILITY NAME: Leath & Sons, Inc.

OWNER NAME: Leath & Sons, Inc.

LOCATION: SE¼, NE¼, Sec 11, T48N, R32W; Jackson County:

RECEIVING STREAM: Tributary to Little Blue River

FACILITY CONTACT PERSON: Becky Leath TELEPHONE: (816) 353 - 8623

The Federal Water Pollution Control Act ("Clean Water Act" section 402 Public Law 92-500 as amended) established the National Pollutant Discharge Elimination System (NPDES) permit program. This program regulates the discharge of pollutants from point sources into the waters of the United States, and the release of storm water from certain point sources. All such discharges are unlawful without a permit (section 301 of the "Clean Water Act"). After a permit is obtained, A discharge not in compliance with all permit terms and conditions is unlawful. Permits in Missouri are issued by the Director of the Department of Natural Resources under an approved program, operating in accordance with federal and state laws( Federal "Clean Water Act" and "Missouri Clean Water Law" Section 644 as amended).

10 CSR 20-7.031 Missouri Water Quality Standards, Missouri Department of Natural Resources (the Department) "defines the Clean Water Commission water quality objectives in terms of water uses to be maintained and the criteria to protect those uses". The receiving stream's beneficial water uses to be maintained are " Livestock and Wildlife Watering (LWW), Protection of Aquatic Life (AQL) and Whole Body Contact Recreation (WBC-B).

To protect these beneficial uses and the water quality of the receiving streams, effluent limitations have been established under federal and state laws.

FACILITY DESCRIPTION AND RATIONALE

This site formerly stored materials for compost without containment or cover. Rainfall and other forms of precipitation falling on the site and the compost materials were subject to contamination. Presently the owners of the facility report that a contract with a local farmer to process the compost is in effect and no compost is stored on the site. Residue from the former compost pile may remain on-site necessitating continued monitoring. In the event that future monitoring fails to show effects of the previous compost pile and there are no future plans to store or process compost on the site in an uncovered, or uncontained scenario, then the permittee may apply for a change in the permit conditions or cancellation of the permit. Permit limits have been continued from the expired permit.

This permit will be issued for a period of five years.

# Leath and Sons, Inc. Topographic Map

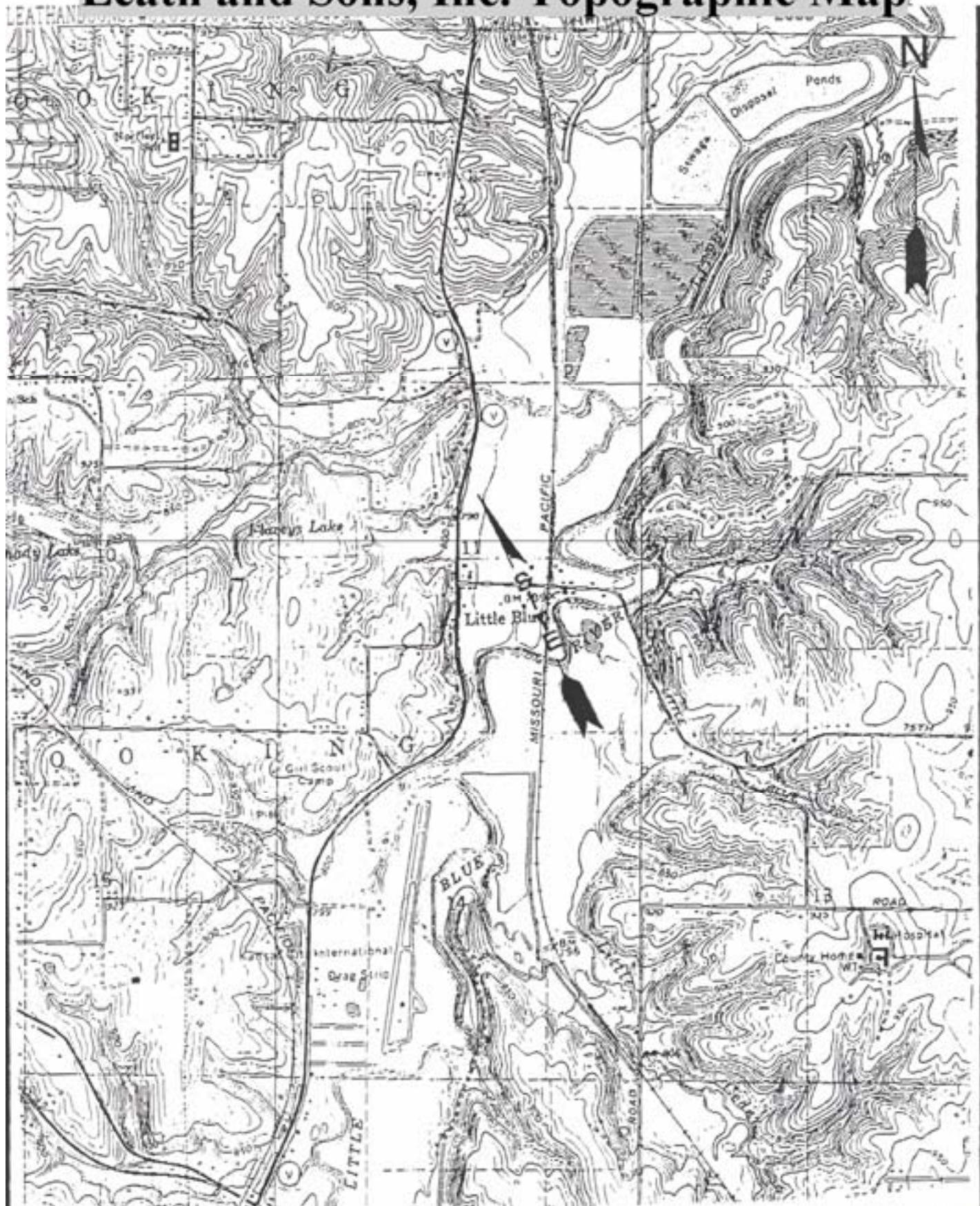



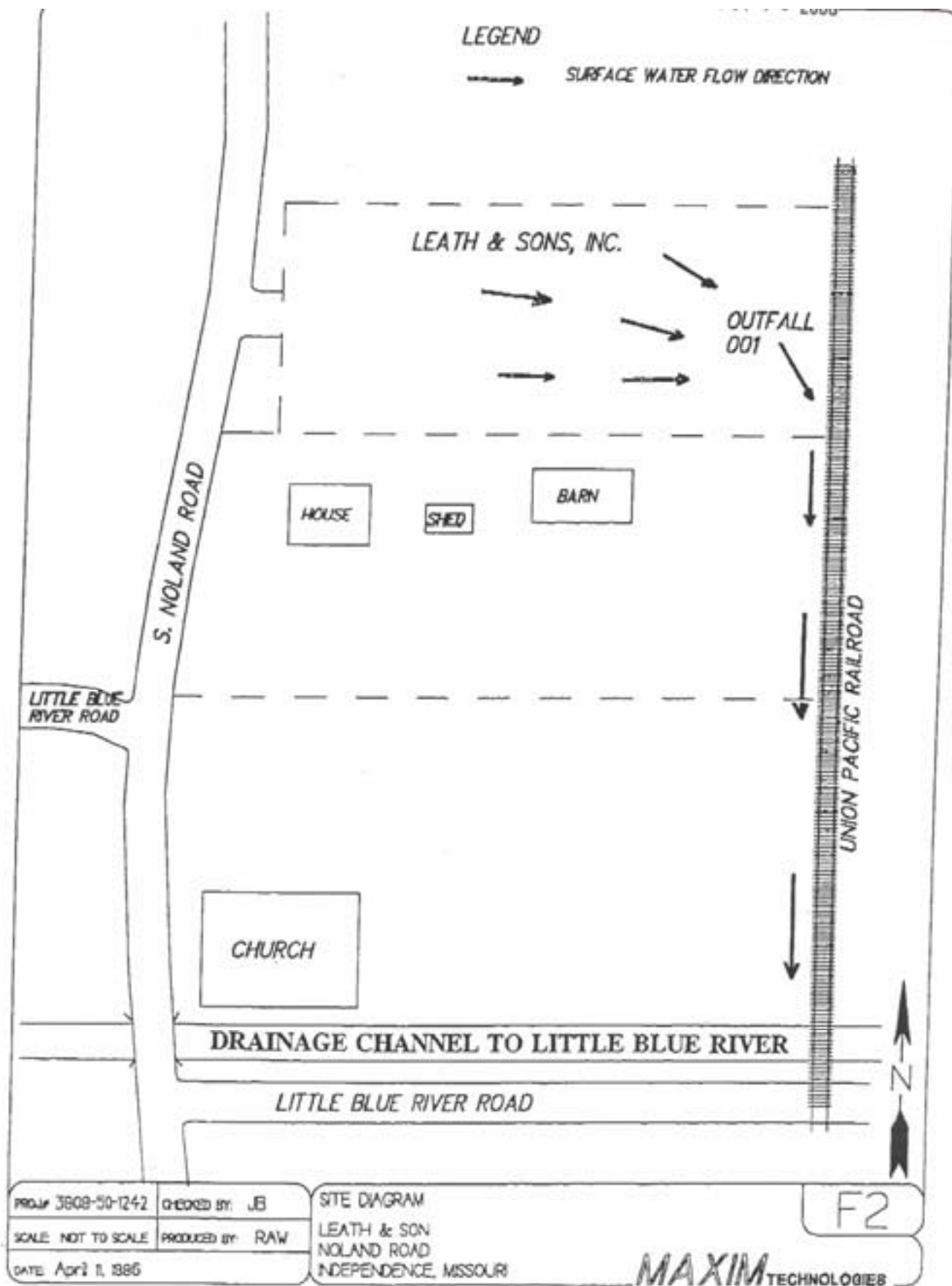

**Site Diagram and Outfall Location**

DRAFT