

STATE OF MISSOURI

DEPARTMENT OF NATURAL RESOURCES

MISSOURI CLEAN WATER COMMISSION



MISSOURI STATE OPERATING PERMIT

In compliance with the Missouri Clean Water Law (Chapter 644 RSMo, hereinafter, the Law), and the Federal Water Pollution Control Act (Public Law 92-500, 92nd Congress) as amended,

Permit No. MO-0116459

Owner: Gateway Refrigerated Warehouse LLC
Address: 11500 Olive Street, Suite 276, Creve Coeur, MO 64141

Continuing Authority: Same as above
Address: Same as above

Facility Name: Gateway Refrigerated Warehouses
Facility Address: 18249 Quarry Road, Warrenton, MO 63383

Legal Description: Sec.15, T46N, R02W, Warren County
UTM Coordinates: Outfall #001: X = 663977, Y = 4290477
Outfall #002: X = 663953, Y = 4290540

Receiving Waterbody: Tributary to Owl Creek
First Classified Waterbody and ID: 100K Extent Remaining Stream (C) WBID# 3960
USGS Basin & Sub-watershed No.: Lower Missouri (10300200-0505)

is authorized to discharge from the facility described herein, in accordance with the effluent limitations and monitoring requirements as set forth herein:

FACILITY DESCRIPTION

Warehouse; SIC 4222; NAICS # 493120, cooling wastewater and domestic wastewater. Domestic wastewater is directed to #001. Treatment at #001 utilizes aerated septic tanks, flow equalization, extended aeration, aerobic digestion, clarification, ultraviolet disinfection; sludge retained in system/removed by hauler. Outfall #002 receives cooling water [with no additives] sourced from [the city of Warrenton]; the effluent receives no treatment prior to discharge. This facility does not require a certified wastewater operator per 10 CSR 20-9.030. Stormwater conditions are required for this type of facility per 10 CSR 20-6.200.

Outfall #001 Design Flow: 0.003 MGD	Actual Average Flow: 0.078 MGD;	PE: 32, Design Sludge: 0.68 dry tons/yr
Outfall #002 Design Flow: 0.010 MGD	Actual Average Flow: 0.106 MGD	

This permit authorizes only wastewater and stormwater discharges under the Missouri Clean Water Law and the National Pollutant Discharge Elimination System; it does not apply to other regulated areas.

December 1, 2020
Effective Date

Edward B. Galbraith, Director, Division of Environmental Quality

September 30, 2025
Expiration Date

Chris Wieberg, Director, Water Protection Program

A. EFFLUENT LIMITATIONS AND MONITORING REQUIREMENTS

OUTFALL #001 <i>domestic wastewater</i>	TABLE A-1 INTERIM EFFLUENT LIMITATIONS AND MONITORING REQUIREMENTS					
The facility is authorized to discharge from outfall(s) as specified. In accordance with 10 CSR 20-7.031, the final effluent limitations outlined in Table A-2 must be achieved as soon as possible but no later than <u>December 1, 2025</u> . These interim effluent limitations are effective beginning <u>December 1, 2020</u> and remain in effect through <u>November 30, 2025</u> or as soon as possible. Discharges shall be controlled, limited, and monitored by the facility as specified below:						
EFFLUENT PARAMETERS	UNITS	INTERIM EFFLUENT LIMITATIONS			MONITORING REQUIREMENTS	
		DAILY MAXIMUM	WEEKLY AVERAGE	MONTHLY AVERAGE	MEASUREMENT FREQUENCY	SAMPLE TYPE
LIMIT SET: M						
PHYSICAL						
Flow	MGD	*	-	*	once/month	24 hr. total
CONVENTIONAL						
Biochemical Oxygen Demand – 5 day	mg/L	-	45	30	once/month	composite**
<i>E. coli</i> †	#/100 ml	1,030	-	206	once/month	grab
pH †	SU	6.5 to 9.0			once/month	grab
Total Suspended Solids (TSS)	mg/L	-	45	30	once/month	composite**
NUTRIENTS						
Ammonia as N; January & February	mg/L	12.1		3.1	once/month	grab
Ammonia as N; March	mg/L	10.1		2.9	once/month	grab
Ammonia as N; April	mg/L	8.4		2.1	once/month	grab
Ammonia as N; May	mg/L	12.1		2.1	once/month	grab
Ammonia as N; June	mg/L	10.1		1.4	once/month	grab
Ammonia as N; July & August	mg/L	8.4		1.4	once/month	grab
Ammonia as N; September	mg/L	8.4		1.4	once/month	grab
Ammonia as N; October	mg/L	8.4		2.9	once/month	grab
Ammonia as N; November	mg/L	8.4		2.9	once/month	grab
Ammonia as N; December	mg/L	10.1		2.9	once/month	grab
MONITORING REPORTS SHALL BE SUBMITTED MONTHLY; THE FIRST REPORT IS DUE JANUARY 28, 2021. THERE SHALL BE NO DISCHARGE OF FLOATING SOLIDS OR VISIBLE FOAM IN OTHER THAN TRACE AMOUNTS.						

A. EFFLUENT LIMITATIONS AND MONITORING REQUIREMENTS (CONTINUED)

OUTFALL #001 <i>domestic wastewater</i>	TABLE A-2 FINAL EFFLUENT LIMITATIONS AND MONITORING REQUIREMENTS					
The facility is authorized to discharge from outfall(s) as specified. The final effluent limitations shall become effective on December 1, 2025 and remain in effect until expiration of the permit. Discharges shall be controlled, limited, and monitored by the facility as specified below:						
EFFLUENT PARAMETERS	UNITS	FINAL EFFLUENT LIMITATIONS			MONITORING REQUIREMENTS	
		DAILY MAXIMUM	WEEKLY AVERAGE	MONTHLY AVERAGE	MEASUREMENT FREQUENCY	SAMPLE TYPE
LIMIT SET: M						
PHYSICAL						
Flow	MGD	*	-	*	once/month	24 hr. total
CONVENTIONAL						
Biochemical Oxygen Demand – 5 day	mg/L	-	45	30	once/month	composite **
<i>E. coli</i> †	#/100 ml	1,030	-	206	once/month	grab
pH †	SU	6.5 to 9.0 at all times			once/month	grab
Total Suspended Solids (TSS)	mg/L	-	45	30	once/month	composite **
NUTRIENTS						
Ammonia as N; January & February	mg/L	12.1		3.1	once/month	grab
Ammonia as N; March	mg/L	10.1		2.1	once/month	grab
Ammonia as N; April	mg/L	8.4		2.1	once/month	grab
Ammonia as N; May	mg/L	12.1		2.1	once/month	grab
Ammonia as N; June	mg/L	10.1		1.3	once/month	grab
Ammonia as N; July & August	mg/L	8.4		0.9	once/month	grab
Ammonia as N; September	mg/L	8.4		1.2	once/month	grab
Ammonia as N; October	mg/L	8.4		1.8	once/month	grab
Ammonia as N; November	mg/L	8.4		2.4	once/month	grab
Ammonia as N; December	mg/L	10.1		2.7	once/month	grab
MONITORING REPORTS SHALL BE SUBMITTED MONTHLY; THE FIRST REPORT IS DUE JANUARY 28, 2026. THERE SHALL BE NO DISCHARGE OF FLOATING SOLIDS OR VISIBLE FOAM IN OTHER THAN TRACE AMOUNTS.						

A. EFFLUENT LIMITATIONS AND MONITORING REQUIREMENTS (CONTINUED)

OUTFALL #002 <i>non-contact cooling wastewater</i>	TABLE A-3 FINAL EFFLUENT LIMITATIONS AND MONITORING REQUIREMENTS					
The facility is authorized to discharge from outfall(s) as specified. The final effluent limitations shall become effective on December 1, 2020 and remain in effect until expiration of the permit. Discharges shall be controlled, limited, and monitored by the facility as specified below:						
EFFLUENT PARAMETERS	UNITS	FINAL EFFLUENT LIMITATIONS			MONITORING REQUIREMENTS	
		DAILY MAXIMUM	WEEKLY AVERAGE	MONTHLY AVERAGE	MEASUREMENT FREQUENCY	SAMPLE TYPE
LIMIT SET: M						
PHYSICAL						
Flow	MGD	*		*	once/month	24 hr. total
Temperature	°F	*		*	once/month	measured
CONVENTIONAL						
Oxygen, Dissolved – Minimum :	mg/L	* :		*	once/month	grab
pH †	SU	6.5 to 9.0		6.5 to 9.0	once/month	grab
MONITORING REPORTS SHALL BE SUBMITTED MONTHLY; THE FIRST REPORT IS DUE JANUARY 28, 2021. THERE SHALL BE NO DISCHARGE OF FLOATING SOLIDS OR VISIBLE FOAM IN OTHER THAN TRACE AMOUNTS.						

* Monitoring and reporting requirement only

** Composite Sampling: a 24-hour composite sample is composed of 48 aliquots (subsamples) collected at 30 minute intervals by an automatic sampling device.

‡ *E. coli*: final limitations and monitoring requirements are applicable only during the recreational season from April 1 through October 31. The Monthly Average Limit for *E. coli* is expressed as a geometric mean.

† pH: the facility will report the minimum and maximum values; pH is not to be averaged.

:

Oxygen, Dissolved: is a minimum value. The facility will report the minimum value for the daily report.

B. SCHEDULE OF COMPLIANCE

Schedules of compliance are allowed per 40 CFR 122.47 and 10 CSR 20-7.031(11). The facility shall attain compliance with final effluent limitations established in this permit as soon as reasonably achievable:

1. Within six months of the effective date of this permit, the facility shall report progress made in attaining compliance with the final effluent limits.
2. The facility shall submit interim progress reports detailing progress made in attaining compliance with the final effluent limits every 12 months from effective date. The first report is due December 1, 2021.
3. Within 5 years of the effective date of this permit, the facility shall attain compliance with the final effluent limits at outfall #001, for ammonia as N, for monthly averages in the months of March, June, July, August, September, October, November, and December.

C. STANDARD CONDITIONS

In addition to specified conditions stated herein, this permit is subject to the attached Part I and Part III standard conditions dated August 1, 2014 and August 1, 2019, respectively, and hereby incorporated as though fully set forth herein.

D. SPECIAL CONDITIONS

1. Spills, Overflows, and Other Unauthorized Discharges.
 - (a) Any spill, overflow, or other discharge(s) not specifically authorized above are unauthorized discharges.
 - (b) Should an unauthorized discharge cause or permit any contaminants to discharge or enter waters of the state, the unauthorized discharge must be reported to the regional office as soon as practicable but no more than 24 hours after the discovery of the discharge. If the spill or overflow needs to be reported after normal business hours or on the weekend, the facility must call the Department's 24 hour spill line at 573-634-2436.
2. Electronic Discharge Monitoring Report (eDMR) Submission System

Per 40 CFR Part 127 National Pollutant Discharge Elimination System (NPDES) Electronic Reporting Rule, reporting of effluent monitoring data and any report required by the permit (unless specifically directed otherwise by the permit), shall be submitted via an electronic system to ensure timely, complete, accurate, and nationally consistent set of data about the NPDES program.

 - (a) eDMR Registration Requirements. The facility must register with the Department's eDMR system through the Missouri Gateway for Environmental Management (MoGEM) before the first report is due. Registration and other information regarding MoGEM can be found at <https://dnr.mo.gov/mogem>. Information about the eDMR system can be found at <https://dnr.mo.gov/env/wpp/edmr.htm>. The first user shall register as an Organization Official and the association to the facility must be approved by the Department. Regarding Standard Conditions Part I, Section B, #7, the eDMR system is currently the only Department approved reporting method for this permit unless a waiver is granted by the department. See paragraph (c) below.
 - (b) Electronic Submissions. To access the eDMR system, use the following link in your web browser: <https://apps5.mo.gov/mogems/welcome.action> If you experience difficulties with using the eDMR system you may contact edmr@dnr.mo.gov or call 855-789-3889 or 573-526-2082 for assistance.
 - (c) Waivers from Electronic Reporting. The facility must electronically submit compliance monitoring data and reports unless a waiver is granted by the department in compliance with 40 CFR Part 127. Only facilities with an approved waiver request may submit monitoring data and reports on paper to the Department for the period the approved electronic reporting waiver is effective. Facilities may obtain an electronic reporting waiver by first submitting an eDMR Waiver Request Form: <http://dnr.mo.gov/forms/780-2692-f.pdf>. The department will either approve or deny this electronic reporting waiver request within 120 calendar days.
3. Site-wide minimum Best Management Practices (BMPs). At a minimum, the facility shall adhere to the following:
 - (a) Prevent the spillage or loss of fluids, oil, grease, fuel, etc. from vehicle maintenance, equipment cleaning, warehouse activities, and other areas, and thereby prevent the contamination of stormwater from these substances.
 - (b) Ensure adequate provisions are provided to prevent surface water intrusion into the wastewater storage basin, to divert stormwater runoff around the wastewater storage basin, and to protect embankments from erosion.
 - (c) Provide collection facilities and arrange for proper disposal of waste products including but not limited to petroleum waste products, and solvents.
 - (d) Store all paint, solvents, petroleum products and petroleum waste products (except fuels), and storage containers (such as drums, cans, or cartons) so these materials are not exposed to stormwater or provide other prescribed BMPs such as plastic lids and/or portable spill pans to prevent the commingling of stormwater with container contents. Commingled water may not be discharged under this permit. Provide spill prevention control, and/or management sufficient to prevent any spills of these pollutants from entering waters of the state. Any containment system used to implement this requirement shall be constructed of materials compatible with the substances contained and shall also prevent the contamination of groundwater. Spill records should be retained on-site.
 - (e) Provide good housekeeping practices on the site to keep trash from entry into waters of the state.
 - (f) Provide sediment and erosion control sufficient to prevent or control sediment loss off of the property.
4. Permittee will cease discharge by connection to a facility with an area-wide management plan per 10 CSR 20-6.010(3)(B) within 90 days of notice of its availability.
5. Bypasses are not authorized at this facility unless they meet the criteria in 40 CFR 122.41(m). If a bypass occurs, the permittee shall report in accordance to 40 CFR 122.41(m)(3), and with Standard Condition Part I, Section B, subsection 2. Bypasses are to be reported to the Regional Office during normal business hours or by using the online Sanitary Sewer Overflow/Facility Bypass Application located at: <https://dnr.mo.gov/mogem/> or the Environmental Emergency Response spill-line at 573-634-2436 outside of normal business hours. Once an electronic reporting system compliant with 40 CFR Part 127, the National Pollutant Discharge Elimination System (NPDES) Electronic Reporting Rule, is available all bypasses must be reported electronically via the new system. Blending, which is the practice of combining a partially-treated wastewater process stream with a fully-treated wastewater process stream prior to discharge, is not considered a form of bypass. If the permittee wishes to utilize blending, the permittee shall file an application to modify this permit to facilitate the inclusion of appropriate monitoring conditions.

D. SPECIAL CONDITIONS (CONTINUED)

6. The domestic treatment facility must be sufficiently secured to restrict entry by children, livestock and unauthorized persons as well as to protect the facility from vandalism.
7. An Operation and Maintenance (O & M) manual shall be maintained by the facility and made available to the operator. The O & M manual shall include key operating procedures and a brief summary of the operation of the facility.
8. An all-weather access road to the treatment facility shall be maintained.
9. The outfall sewer shall be protected and maintained against the effects of floodwater, ice, or other hazards as to reasonably ensure its structural stability, freedom from stoppage, and that a sample of the effluent can be obtained at a point after the final treatment process and before the discharge mixes with the receiving waters.
10. Stormwater Pollution Prevention Plan (SWPPP).

The facility's SIC code or description is found in 40 CFR 122.26(b)(14) and/or 10 CSR 20-6.200(2) and hence shall implement a Stormwater Pollution Prevention Plan (SWPPP) which must be prepared and implemented 90 days after permit effective date. The SWPPP must be kept on-site and should not be sent to the Department unless specifically requested. The SWPPP must be reviewed and updated annually or if site conditions affecting stormwater change. The facility shall select, install, use, operate, and maintain the Best Management Practices prescribed in the SWPPP in accordance with the concepts and methods described in: *Developing Your Stormwater Pollution Prevention Plan, A Guide for Industrial Operators*, (EPA 833-B-09-002) published by the EPA in 2015 https://www.epa.gov/sites/production/files/2015-11/documents/swppp_guide_industrial_2015.pdf The purpose of the SWPPP and the Best Management Practices (BMPs) listed herein is the prevention of pollution of waters of the state. A deficiency of a BMP means it was ineffective at providing the necessary protections for which it was designed. Corrective action describes the steps the facility took to eliminate the deficiency.

The SWPPP must include:

 - (a) A listing of specific contaminants and their control measures (or BMPs) and a narrative explaining how BMPs are implemented to control and minimize the amount of contaminants potentially entering stormwater.
 - (b) A map with all outfalls and structural BMPs marked.
 - (c) A schedule for at least once per month site inspections and brief written reports. The inspection report must include precipitation information for the entire period since last inspection, as well as observations and evaluations of BMP effectiveness. Throughout coverage under this permit, the facility must perform ongoing SWPPP review and revision to incorporate any site condition changes.
 - (1) Operational deficiencies must be corrected within seven (7) calendar days.
 - (2) Minor structural deficiencies must be corrected within fourteen (14) calendar days.
 - (3) Major structural deficiencies (deficiencies projected to take longer than 14 days to correct) must be reported as an uploaded attachment through the eDMR system with the DMRs. The initial report shall consist of the deficiency noted, the proposed remedies, the interim or temporary remedies (including proposed timing of the placement of the interim measures), and an estimate of the timeframe needed to wholly complete the repairs or construction. If required by the Department, the facility shall work with the regional office to determine the best course of action. The facility should consider temporary structures to control stormwater runoff. The facility shall correct the major structural deficiency as soon as reasonably achievable.
 - (4) All actions taken to correct the deficiencies shall be included with the written report, including photographs, and kept with the SWPPP. Additionally, corrective action of major structural deficiencies shall be reported as an uploaded attachment through the eDMR system with the DMRs.
 - (5) Inspection reports must be kept on site with the SWPPP and maintained for a period of five (5) years. These must be made available to Department personnel upon request. Electronic versions of the documents and photographs are acceptable.
 - (d) A provision for designating an individual to be responsible for environmental matters and a provision for providing training to all personnel involved in housekeeping, material handling (including but not limited to loading and unloading), storage, and staging of all operational, maintenance, storage, and cleaning areas. Proof of training shall be submitted upon request by the Department.

D. SPECIAL CONDITIONS (CONTINUED)

11. Petroleum Secondary Containment.

Before releasing water accumulated in petroleum secondary containment areas, it must be examined for hydrocarbon odor and presence of sheen to protect the general criteria found at 10 CSR 20-7.031(4).

- (a) If odor or sheen is found, the water shall not be discharged without treatment and shall be disposed of in accordance with legally approved methods, such as being sent to an accepting wastewater treatment facility.
- (b) If the facility wishes to discharge the accumulated stormwater with hydrocarbon odor or presence of sheen, the water shall be treated using an appropriate removal method. Following treatment and before release, the water shall be tested for oil and grease, benzene, toluene, ethylbenzene, and xylene using 40 CFR part 136 methods. All pollutant levels must be below the most protective, applicable standards for the receiving stream, found in 10 CSR 20-7.031 Table A before discharge is authorized. Records of all testing and treatment of water accumulated in secondary containment shall be available on demand to the Department. Electronic records retention is acceptable.
- (c) If the facility discharged stormwater with sheen at any point during the permit cycle, the facility must submit a disclosure of this discharge with the materials for permit renewal.

12. The full implementation of this operating permit, which includes implementation of any applicable schedules of compliance, shall constitute compliance with all applicable federal and state statutes and regulations in accordance with RSMo 644.051.16, and the CWA section 402(k); however, this permit may be reopened and modified, or alternatively revoked and reissued to comply with any applicable effluent standard or limitation issued or approved under Clean Water Act Sections 301(b)(2)(C) and (D), §304(b)(2), and §307(a) (2), if the effluent standard or limitation so issued or approved contains different conditions or is otherwise more stringent than any effluent limitation in the permit; or controls any pollutant not limited in the permit. This permit may be modified, revoked and reissued, or terminated for cause. The filing of a request by the facility for a permit modification, termination, notice of planned changes, or anticipated non-compliance does not stay any permit condition.

13. All outfalls must be clearly marked in the field.

14. Report no discharge when a discharge does not occur during the report period. It is a violation of this permit to report no-discharge when a discharge has occurred.

15. This permit does not apply to fertilizer products receiving a current exemption under the Missouri Clean Water Law and regulations in 10 CSR 20-6.015(3)(B)8., and are land applied in accordance with the exemption.

16. Failure to pay fees associated with this permit is a violation of the Missouri Clean Water Law (644.055 RSMo).

17. This permit does not cover land disturbance activities.

18. This permit does not authorize the placement of fill materials in flood plains, placement of solid materials into any waterway, the obstruction of stream flow, or changing the channel of a defined drainage course. The facility must contact the U.S. Army Corps of Engineers (Corps) to determine if a CWA §404 Department of Army permit or §401 water quality certification is required for the project.

19. Reporting of Non-Detects.

- (a) Compliance analysis conducted by the facility or any contracted laboratory shall be conducted in such a way the precision and accuracy of the analyzed result can be enumerated. See sufficiently sensitive test method requirements in Standard Conditions Part I, Section A, #4 regarding proper testing and detection limits used for sample analysis. For the purposes of this permit, the definitions in 40 CFR 136 apply; method detection limit (MDL) and laboratory established reporting limit (RL) are used interchangeably in this permit.
- (b) The facility shall not report a sample result as “non-detect” without also reporting the MDL. Reporting “non-detect” without also including the MDL will be considered failure to report, which is a violation of this permit.
- (c) For the daily maximum, the facility shall report the highest value; if the highest value was a non-detect, use the less than “<” symbol and the laboratory’s highest method detection limit (MDL) or the highest reporting limit (RL); whichever is higher (e.g. <6).
- (d) When calculating monthly averages, zero shall be used in place of any value(s) not detected. Where all data used in the average are below the MDL or RL, the highest MDL or RL shall be reported as “<#” for the average as indicated in item (c).

D. SPECIAL CONDITIONS (CONTINUED)

20. Changes in Discharges of Toxic Pollutant.

In addition to the reporting requirements under 40 CFR 122.41(1), all existing manufacturing, commercial, mining, and silvicultural dischargers must notify the Director as soon as they know or have reason to believe:

- (a) An activity has occurred or will occur which would result in the discharge, on a routine or frequent basis, of any toxic pollutant which is not limited in the permit, if that discharge will exceed the highest of the following notification levels:
 - (1) One hundred micrograms per liter (100 µg/L);
 - (2) Two hundred micrograms per liter (200 µg/L) for acrolein and acrylonitrile;
 - (3) Five hundred micrograms per liter (500 µg/L) for 2,4-dinitrophenol and for 2-methyl-4, 6-dinitrophenol;
 - (4) One milligram per liter (1 mg/L) for antimony;
 - (5) Five (5) times the maximum concentration value reported for the pollutant in the permit application in accordance with 40 CFR 122.21(g)(7); or
 - (6) The notification level established by the Department in accordance with 40 CFR 122.44(f).
- (b) Any activity has occurred or will occur which would result in any discharge, on a non-routine or infrequent basis, of a toxic pollutant which is not limited in the permit, if that discharge will exceed the highest of the following “notification levels”:
 - (1) Five hundred micrograms per liter (500 µg/L);
 - (2) One milligram per liter (1 mg/L) for antimony;
 - (3) Ten (10) times the maximum concentration value reported for that pollutant in the permit application in accordance with 40 CFR 122.21(g)(7).
 - (4) The level established by the Director in accordance with 40 CFR 122.44(f).

21. Renewal Application Requirements.

- (a) This facility shall submit an appropriate and complete application to the Department no less than 180 days prior to the expiration date listed on page 1 of the permit.
- (b) Application materials shall include complete Form A, Form B (for outfall #001), and Form C (for outfall #002). If the form names have changed, then the facility should ensure they are submitting the correct forms as required by regulation.
- (c) The facility must identify any industrially exposed stormwater for the site. The facility will also identify the outfall location of the stormwater discharge and complete information on Form A and the tables on Form C for each stormwater discharge.
- (d) The facility will also submit the SWPPP to the Department.
- (e) The facility may use the electronic submission system to submit the application to the Program, if available.

E. NOTICE OF RIGHT TO APPEAL

If you were adversely affected by this decision, you may be entitled to pursue an appeal before the administrative hearing commission (AHC) pursuant to Sections 621.250 and 644.051.6 RSMo. To appeal, you must file a petition with the AHC within thirty days after the date this decision was mailed or the date it was delivered, whichever date was earlier. If any such petition is sent by registered mail or certified mail, it will be deemed filed on the date it is mailed; if it is sent by any method other than registered mail or certified mail, it will be deemed filed on the date it is received by the AHC. Any appeal should be directed to:

Administrative Hearing Commission
U.S. Post Office Building, Third Floor
131 West High Street, P.O. Box 1557
Jefferson City, MO 65102-1557
Phone: 573-751-2422
Fax: 573-751-5018
Website: <https://ahc.mo.gov>

MISSOURI DEPARTMENT OF NATURAL RESOURCES
FACT SHEET
FOR THE PURPOSE OF RENEWAL
OF
MO-0116459
GATEWAY REFRIGERATED WAREHOUSES

The Federal Water Pollution Control Act ("Clean Water Act" Section 402 Public Law 92-500 as amended) established the National Pollutant Discharge Elimination System (NPDES) permit program. This program regulates the discharge of pollutants from point sources into the waters of the United States, and the release of stormwater from certain point sources. All such discharges are unlawful without a permit (Section 301 of the "Clean Water Act"). After a permit is obtained, a discharge not in compliance with all permit terms and conditions is unlawful. Missouri State Operating Permits (MSOPs) are issued by the Director of the Missouri Department of Natural Resources (Department) under an approved program, operating in accordance with federal and state laws (Federal "Clean Water Act" and "Missouri Clean Water Law" Section 644 as amended). MSOPs are issued for a period of five (5) years unless otherwise specified for less.

As per [40 CFR Part 124.8(a)] and [10 CSR 20-6.020(1)(A)2.] a factsheet shall be prepared to give pertinent information regarding the applicable regulations, rationale for the development of effluent limitations and conditions, and the public participation process for the Missouri State Operating Permit (MSOP or operating permit) listed below. A factsheet is not an enforceable part of an operating permit.

PART I. FACILITY INFORMATION

Facility Type: Industrial; <1 MGD
SIC Code(s): 4222
NAICS Code(s): 493120
Application Date: 02/18/2020, 08/13/2020
Modification Date: 08/01/2019
Expiration Date: 09/30/2020
Last Inspection: 06/23/2016

FACILITY DESCRIPTION:

Underground warehouses are refrigerated via cooled water; the facility also discharges domestic wastewater (flow equalization, aeration, aerobic digestion, clarifier, UV). The facility does not require a certified operator. For the domestic system, the raw flow enters the flow equalization tank, pumped to the aeration tank, then flows to the clarifier. The RAS is returned to the aeration tank where the excess sludge is pumped to the digester. The clarifier effluent is treated for biologicals using a UV system, then discharged through outfall #001. Cooling wastewater is solids bleed (blowdown) from condensers and compressors and also unit condensate, piped to outfall #002; source water is groundwater and is treated with Monitrol Plus BBB, by Dubois Chemicals.

In accordance with 40 CFR 122.21(f)(6), the Department determined the facility holds no other environmental permits.

PERMITTED FEATURES TABLE:

OUTFALL	AVERAGE FLOW	DESIGN FLOW	TREATMENT LEVEL	EFFLUENT TYPE
#001	0.078 MGD	0.003 MGD	secondary treatment (flow equalization, extended aeration, aerobic digestion, clarification, ultraviolet disinfection)	domestic wastewater; piped to system, treated, then discharges to basin
#002	0.106 MGD	0.010 MGD	none	industrial non-contact condenser and compressor cooling water bleed and unit condensation, collected and combined, then piped to outfall #002 discharging near basin.

FACILITY PERFORMANCE HISTORY & COMMENTS:

The electronic discharge monitoring reports were reviewed for the last permit term. The effluent for outfall #001 exceeded the design flow on numerous occasions. The 2016 inspection found the facility was not meeting effluent limits, the facility failed to comply with permit conditions, there was inadequate disinfection, and the facility failed to comply with previous notice of violation. However, the facility has since installed UV treatment. The facility should continue to submit monitoring data to the department using the eDMR system in a timely fashion.

This permit used to be classified as a domestic facility, however, there are also industrial wastewater and stormwater flows now considered. The previous permit's fee was also much lower, this permit fee is now \$1,800.

CONTINUING AUTHORITY:

The Missouri Secretary of State continuing authority charter number for this facility is LC001521004, this number was verified by the permit writer to be associated with the facility and matches the continuing authority reported by the facility.

FACILITY MAP:

The facility is underground, outfall #001 is the domestic system.



WATER BALANCE DIAGRAM:



PART II. RECEIVING WATERBODY INFORMATION**RECEIVING WATERBODY TABLE:**

OUTFALL	WATERBODY NAME	CLASS	WBID	DESIGNATED USES	DISTANCE TO SEGMENT	12-DIGIT HUC
#001 and #002	100K Extant-Remaining Stream; Tributary to Owl Creek	C	3960	GEN, HHP, IRR, LWW, SCR, WBC-B, WWH (ALP)	0.25 mi	Lower Missouri (10300200-0505)

Classes are representations of hydrologic flow volume or lake basin size as defined in 10 CSR 20-7.031(1)(F). L1: Lakes with drinking water supply - wastewater discharges are not permitted to occur to L1 watersheds per 10 CSR 20-7.015(3)(C); L2: major reservoirs; L3: all other public and private lakes; P: permanent streams; C: streams which may cease flow in dry periods but maintain pools supporting aquatic life; E: streams which do not maintain surface flow; and W: wetland. Losing streams are defined in 10 CSR 20-7.031(1)(O) and are designated on the losing stream dataset or determined by the Department to lose 30% or more of flow to the subsurface.

WBID = Waterbody Identification: Missouri Use Designation Dataset per 10 CSR 20-7.031(1)(Q) and (S) as 100K Extant-Remaining Streams or newer; data can be found as an ArcGIS shapefile on MSDIS at ftp://msdis.missouri.edu/pub/Inland_Water_Resources/MO_2014_WQS_Stream_Classifications_and_Use_shp.zip; New C streams described on the dataset per 10 CSR 20-7.031(2)(A)3. as 100K Extant Remaining Streams.

10 CSR 20-7.031(1)(C)1.: **ALP** = Aquatic Life Protection (formerly AQL); current uses are defined to ensure the protection and propagation of fish shellfish and wildlife, further subcategorized as: WWH = Warm Water Habitat; CLH = Cool Water Habitat; CDH = Cold Water Habitat; EAH = Ephemeral Aquatic Habitat; MAH = Modified Aquatic Habitat; LAH = Limited Aquatic Habitat. This permit uses ALP effluent limitations in 10 CSR 20-7.031 Table A1-B3 for all habitat designations unless otherwise specified.

10 CSR 20-7.031(1)(C)2.: Recreation in and on the water

WBC = Whole Body Contact recreation where the entire body is capable of being submerged;

WBC-A = whole body contact recreation supporting swimming uses and has public access;

WBC-B = whole body contact recreation not included in WBC-A;

SCR = Secondary Contact Recreation (like fishing, wading, and boating)

10 CSR 20-7.031(1)(C)3. to 7.:

HHP (formerly HHF) = Human Health Protection as it relates to the consumption of fish and drinking of water;

IRR = irrigation for use on crops utilized for human or livestock consumption, includes aquifers per 10 CSR 20-7.031(6)(A);

LWW = Livestock and Wildlife Watering (current narrative use is defined as LWP = Livestock and Wildlife Protection), includes aquifers per 10 CSR 20-7.031(6)(A);

DWS = Drinking Water Supply, includes aquifers per 10 CSR 20-7.031(6)(A);

IND = industrial water supply

10 CSR 20-7.031(1)(C)8. to 11.: Wetlands (10 CSR 20-7.031 Tables A1-B3 currently does not have corresponding habitat use criteria for these defined uses): WSA = storm- and flood-water storage and attenuation; WHP = habitat for resident and migratory wildlife species; WRC = recreational, cultural, educational, scientific, and natural aesthetic values and uses; WHC = hydrologic cycle maintenance.

10 CSR 20-7.015(7) and 10 CSR 20-7.031(6): **GRW** = Groundwater

10 CSR 20-7.031(4): **GEN** = general criteria; acute toxicity criteria applicable to all waters even those lacking designated uses

n/a = not applicable

EXISTING WATER QUALITY:

The receiving waterbody has no relevant water quality data available.

303(d) LIST:

Section 303(d) of the federal Clean Water Act requires each state identify waters not meeting water quality standards and for which adequate water pollution controls have not been required. Water quality standards protect such beneficial uses of water as whole body contact (such as swimming), maintaining fish and other aquatic life, and providing drinking water for people, livestock, and wildlife. The 303(d) list helps state and federal agencies keep track of impaired waters not addressed by normal water pollution control programs. <http://dnr.mo.gov/env/wpp/waterquality/303d/303d.htm>

✓ Not applicable.

TOTAL MAXIMUM DAILY LOAD (TMDL):

A TMDL is a calculation of the maximum amount of a given pollutant a water body can absorb before its water quality is affected; hence, the purpose of a TMDL is to determine the pollutant loading a specific waterbody can assimilate without exceeding water quality standards. If a water body is determined to be impaired as listed on the 303(d) list, then a watershed management plan or TMDL may be developed. The TMDL shall include the WLA calculation. <http://dnr.mo.gov/env/wpp/tmdl/>

✓ Applicable; The Missouri River and watershed is associated with the 2002 EPA approved TMDL for chlordane and PCBs. This facility is not considered to be a source of the above listed pollutant(s) or considered to contribute to the impairment.

UPSTREAM OR DOWNSTREAM IMPAIRMENTS:

The permit writer has reviewed upstream and downstream stream segments of this facility for impairments.

✓ The permit writer has noted no upstream or downstream impairments near this facility.

WATERS OF THE STATE DESIGNATIONS:

Waters of the state are divided into seven categories per 10 CSR 20-7.015(1)(B) 1. through 7. The applicable water of the state category is listed below. Missouri's technology-based effluent regulations are found in [10 CSR 20-7.015] and are implemented in 10 CSR 20-7.015(2) through (8). When implementing technology regulations, considerations are made for the facility type, discharge type, and category of waters of the state. Effluent limitations may not be applicable to certain waters of the state, facility type, or discharge type. In these cases, effluent limitations may be based on a best professional judgment evaluation. The best professional judgment evaluation will take site specific conditions into consideration; including facility type, the receiving water body classification, and type of discharge. Stormwater discharges and land application sites are not directly subject to limitations found in 10 CSR 20-7.015, but may be subject to limitations determined by the best professional judgment evaluation. Effluent limitation derivations are discussed in PART IV: EFFLUENTS LIMITS DETERMINATIONS.

✓ Missouri River watershed and other waters

LAKE NUMERIC NUTRIENT CRITERIA:

Water quality standards per 10 CSR 20-7.031(5)(N) describe nutrient criteria requirements assigned to lakes (which include reservoirs) in Missouri, equal to or greater than 10 acres during normal pool conditions. The Department's Nutrient Criteria Implementation Plan (NCIP) may be reviewed at: <https://dnr.mo.gov/env/wpp/rules/documents/nutrient-implementation-plan-final-072618.pdf> Discharges of wastewater in to lakes or lake watersheds designated as L1 (drinking water use) are prohibited per 10 CSR 20-7.015(3)(C).

✓ Not applicable; this facility does not discharge in a lake watershed.

RECEIVING WATERBODY MONITORING REQUIREMENTS:

No receiving water monitoring requirements are recommended at this time.

MIXING CONSIDERATIONS:

For all outfalls, mixing zone and zone of initial dilution are not allowed per 10 CSR 20-7.031(5)(A)4.B.(I)(a) and (b), as the base stream flow does not provide dilution to the effluent.

PART III. RATIONALE AND DERIVATION OF PERMIT CONDITIONS

ALTERNATIVE EVALUATIONS FOR NEW FACILITIES:

As per [10 CSR 20-7.015(4)(A)], discharges to losing streams shall be permitted only after other alternatives including land application, discharges to a gaining stream and connection to a regional wastewater treatment facility have been evaluated and determined to be unacceptable for environmental and/or economic reasons.

✓ Not applicable; the facility is an existing facility.

ANTIBACKSLIDING:

Federal Regulations [CWA §303(d)(4); CWA §402(c); 40 CFR Part 122.44(l)] require a reissued permit to be as stringent as the previous permit with some exceptions. Backsliding (a less stringent permit limitation) is only allowed under certain conditions.

✓ Limitations in this operating permit for the reissuance conform to the anti-backsliding provisions of Section 402(o) of the Clean Water Act, and 40 CFR Part 122.44.

✓ Information is available which was not available at the time of permit issuance (other than revised regulations, guidance, or test methods) which would have justified the application of a less stringent effluent limitation.

- Whole effluent toxicity testing was completed at this facility at outfall #002; the permit writer determined there is no potential for wholly toxic effluent at this outfall due to flow and pollutants present/absent; therefore monitoring was removed.

✓ The Department determined technical mistakes or mistaken interpretations of law were made in issuing the permit under section 402(a)(1)(b).

- Ammonia as N was calculated based on the new ammonia derivation 2020 guidance, where previously, the 2007 guidance was used. This new guidance uses regional pH and temperature data to determine limits for each month of the year. The daily maximum for each month increased, the monthly average for January, February, April, and May also increased. See also SCHEDULE OF COMPLIANCE for new, lower, monthly average limits.
- The previous permit required a piped conduit to the stream, however, this special condition was removed in favor of more appropriate and protective channel protection.

ANTIDEGRADATION REVIEW:

Process water discharges with new, altered, or expanding flows, the Department is to document, by means of antidegradation review, if the use of a water body's available assimilative capacity is justified. In accordance with Missouri's water quality regulations for antidegradation [10 CSR 20-7.031(3)], degradation may be justified by documenting the socio-economic importance of a discharge after determining the necessity of the discharge. Facilities must submit the antidegradation review request to the Department prior to establishing, altering, or expanding discharges. See <http://dnr.mo.gov/env/wpp/permits/antideg-implementation.htm>

- ✓ Not applicable; the facility has not submitted information proposing expanded or altered process water discharge; no further degradation proposed therefore no further review necessary.

This permit requires the development and implementation of a Stormwater Pollution Prevention Plan (SWPPP) which must include an alternative analysis (AA) of the BMPs. The SWPPP must be developed, implemented, updated, and maintained at the facility. Failure to implement and maintain the chosen alternative, is a permit violation. The AA is a structured evaluation of BMPs to determine which are reasonable and cost effective. Analysis should include practices designed to be 1) non-degrading, 2) less degrading, or 3) degrading water quality. The chosen BMP will be the most reasonable and cost effective while ensuring the highest statutory and regulatory requirements are achieved and the highest quality water attainable for the facility is discharged. The analysis must demonstrate why “no discharge” or “no exposure” are not feasible alternatives at the facility. Existing facilities with established SWPPPs and BMPs need not conduct an additional alternatives analysis unless new BMPs are established to address BMP failures or benchmark exceedances. This structured analysis of BMPs serves as the antidegradation review, fulfilling the requirements of 10 CSR 20-7.015(9)(A)5 and 7.031(3). For stormwater discharges with new, altered, or expanding discharges, the stormwater BMP chosen for the facility, through the AA performed by the facility, must be implemented and maintained at the facility. Failure to implement and maintain the chosen BMP alternative is a permit violation; see SWPPP.

- ✓ Applicable; the facility must review and maintain stormwater BMPs as appropriate.

BEST MANAGEMENT PRACTICES:

Minimum site-wide best management practices are established in this permit to ensure all facilities are managing their sites equally to protect waters of the state from certain activities which could cause negative effects in receiving water bodies. While not all sites require a SWPPP because the SIC codes are specifically exempted in 40 CFR 122.26(b)(14), these best management practices are not specifically included for stormwater purposes. These practices are minimum requirements for all industrial sites to protect waters of the state. If the minimum best management practices are not followed, the facility may violate general criteria [10 CSR 20-7.031(4)]. Statutes are applicable to all permitted facilities in the state, therefore pollutants cannot be released unless in accordance with RSMo 644.011 and 644.016 (17).

COST ANALYSIS FOR COMPLIANCE (CAFCON):

Pursuant to Section 644.145, RSMo, when incorporating a new requirement for discharges from publicly owned facilities, or when enforcing provisions of this chapter or the Federal Water Pollution Control Act, 33 U.S.C. 1251 et seq., pertaining to any portion of a publicly owned facility, the Department of Natural Resources shall make a “finding of affordability” on the costs to be incurred and the impact of any rate changes on ratepayers upon which to base such permits and decisions, to the extent allowable under this chapter and the Federal Water Pollution Control Act. This process is completed through a cost analysis for compliance. Permits not including new requirements may be deemed affordable.

- ✓ The Department is not required to complete a cost analysis for compliance because the facility is not publicly owned.

CHANGES IN DISCHARGES OF TOXIC POLLUTANT:

This special condition reiterates the federal rules found in 40 CFR 122.44(f) and 122.42(a)(1). In these rules, the facility is required to report changes in amounts of toxic substances discharged. Toxic substances are defined in 40 CFR 122.2 as “...any pollutant listed as toxic under section 307(a)(1) or, in the case of “sludge use or disposal practices,” any pollutant identified in regulations implementing section 405(d) of the CWA.” Section 307 of the clean water act then refers to those parameters found in 40 CFR 401.15. The facility should also consider any other toxic pollutant in the discharge as reportable under this condition.

COMPLIANCE AND ENFORCEMENT:

Enforcement is the action taken by the Water Protection Program (WPP) to bring an entity into compliance with the Missouri Clean Water Law, its implementing regulations, and/or any terms and conditions of an operating permit. The primary purpose of the enforcement activity in the WPP is to resolve violations and return the entity to compliance.

- ✓ Not applicable; the facility is not currently under Water Protection Program enforcement action.

DOMESTIC WASTEWATER, SLUDGE, AND BIOSOLIDS:

Domestic wastewater is defined as wastewater (i.e., human sewage) originating primarily from the sanitary conveyances of bathrooms and kitchens. Domestic wastewater excludes stormwater, animal waste, process waste, and other similar waste.

- ✓ Applicable, outfall #001 discharges domestic wastewater.
- ✓ Standard conditions Part III is incorporated into this permit.

Sewage sludge is solid, semi-solid, or liquid residue generated during the treatment of domestic sewage in a treatment works; including but not limited to, domestic septage; scum or solids removed in primary, secondary, or advanced wastewater treatment process; and material derived from sewage sludge. Sewage sludge does not include ash generated during the firing of sewage sludge in a sewage sludge incinerator or grit and screening generated during preliminary treatment of domestic sewage in a treatment works. Biosolids are solid materials resulting from domestic wastewater treatment meeting federal and state criteria for productive use (i.e. fertilizer) and after having pathogens removed.

Additional information: <http://extension.missouri.edu/main/DisplayCategory.aspx?C=74> (WQ422 through WQ449).

- ✓ Applicable, sludge/biosolids/septage are removed by contract hauler. The permitted management strategy must be followed, see FACILITY DESCRIPTION in the permit. If the described management strategy cannot be followed, the facility must obtain a permit modification. See Standard Conditions Part III.
- ✓ Standard conditions Part III is incorporated into this permit.

EFFLUENT LIMITATIONS:

Effluent limitations derived and established for this permit are based on current operations of the facility and applied per 10 CSR 20-7.015(9)(A) as applicable. Any flow through the outfall is considered a discharge and must be sampled and reported as provided in the permit. Future permit action due to facility modification may contain new operating permit terms and conditions which supersede the terms and conditions, including effluent limitations, of this operating permit. Daily maximums and monthly averages are required per 40 CFR 122.45(d)(1) for continuous discharges (not from a POTW).

ELECTRONIC DISCHARGE MONITORING REPORT (EDMR) SUBMISSION SYSTEM:

The U.S. Environmental Protection Agency (EPA) promulgated a final rule on October 22, 2015, to modernize Clean Water Act reporting for municipalities, industries, and other facilities by converting to an electronic data reporting system. The final rule requires regulated entities and state and federal regulators to use information technology to electronically report data required by the National Pollutant Discharge Elimination System (NPDES) permit program instead of filing paper reports. To comply with the federal rule, the Department is requiring all facilities to begin submitting discharge monitoring data and reports online.

Per 40 CFR 127.15 and 127.24, permitted facilities may request a temporary waiver for up to 5 years or a permanent waiver from electronic reporting from the Department. To obtain an electronic reporting waiver, a facility must first submit an eDMR Waiver Request Form: <http://dnr.mo.gov/forms/780-2692-f.pdf>. A request must be made for each facility. If more than one facility is owned or operated by a single entity, then the entity must submit a separate request for each facility based on its specific circumstances. An approved waiver is not transferable.

The Department must review and notify the facility within 120 calendar days of receipt if the waiver request has been approved or rejected [40 CFR 124.27(a)]. During the Department review period as well as after a waiver is granted, the facility must continue submitting a hard-copy of any reports required by their permit. The Department will enter data submitted in hard-copy from those facilities allowed to do so and electronically submit the data to the EPA on behalf of the facility.

To assist the facility in entering data into the eDMR system, the permit describes limit sets in each table in Part A of the permit. The data entry personnel should use these identifiers to ensure data entry is being completed appropriately.

- ✓ The facility is currently using the eDMR data reporting system.

FEDERAL EFFLUENT LIMITATION GUIDELINE:

Effluent Limitation Guidelines, or ELGs, are found at 40 CFR 400-499. These are limitations established by the EPA based on the SIC code and the type of work a facility is conducting. Most ELGs are for process wastewater and some address stormwater. All are technology based limitations which must be met by the applicable facility at all times.

- ✓ The facility does not have an associated ELG.

GENERAL CRITERIA CONSIDERATIONS:

In accordance with 40 CFR 122.44(d)(1), effluent limitations shall be placed into permits for pollutants determined to cause, have reasonable potential to cause, or to contribute to, an excursion above any water quality standard, including narrative water quality criteria. In order to comply with this regulation, the permit writer has completed a reasonable potential determination on whether discharges have reasonable potential to cause, or contribute to an excursion of the general criteria listed in 10 CSR 20-7.031(4). In instances where reasonable potential exists, the permit includes limitations within the permit to address the reasonable potential. In discharges where reasonable potential does not exist, the permit may include monitoring to later determine the discharge's potential to impact the narrative criteria. Additionally, RSMo 644.076.1, as well as Section D – Administrative Requirements of Standard Conditions Part I of this permit state it shall be unlawful for any person to cause or allow any discharge of water contaminants from any water contaminant or point source located in Missouri in violation of sections 644.006 to 644.141 of the Missouri Clean Water Law or any standard, rule, or regulation promulgated by the commission. See Part IV for specific determinations.

GROUNDWATER MONITORING:

Groundwater is a water of the state according to RSMo 644.016(27), is subject to regulations at 10 CSR 20-7.015(7) and 10 CSR 20-7.031(6), and must be protected accordingly.

- ✓ This facility is not required to monitor groundwater for the water protection program.

LAND APPLICATION:

Land application, or surficial dispersion of wastewater and/or sludge, is performed by facilities to maintain a basin as no-discharge. Requirements for these types of operations are found in 10 CSR 20-6.015; authority to regulate these activities is from RSMo 644.026.

- ✓ Not applicable; this permit does not authorize operation of a surficial land application system to disperse wastewater or sludge.

LAND DISTURBANCE:

Land disturbance, sometimes called construction activities, are actions which cause disturbance of the root layer or soil; these include clearing, grading, and excavating of the land. 40 CFR 122.26(b)(14) and 10 CSR 20-6.200(3) requires permit coverage for these activities. Coverage is not required for facilities when only providing maintenance of original line and grade, hydraulic capacity, or to continue the original purpose of the facility.

- ✓ Not applicable; this permit does not provide coverage for land disturbance activities. The facility may obtain a separate land disturbance permit (MORA) online at <https://dnr.mo.gov/env/wpp/stormwater/sw-land-disturb-permits.htm>; MORA permits do not cover disturbance of contaminated soils, however, site specific permits such as this one can be modified to include appropriate controls for land disturbance of contaminated soils by adding site-specific BMP requirements and additional outfalls.

MAJOR WATER USER:

Any surface or groundwater user with a water source and the equipment necessary to withdraw or divert 100,000 gallons (or 70 gallons per minute) or more per day combined from all sources from any stream, river, lake, well, spring, or other water source is considered a major water user in Missouri. All major water users are required by law to register water use annually (Missouri Revised Statutes Chapter 256.400 Geology, Water Resources and Geodetic Survey Section). <https://dnr.mo.gov/pubs/pub2236.htm>

- ✓ Applicable; this facility is a major water user and is registered with the state.

NUTRIENT MONITORING:

Nutrient monitoring is required for facilities characteristically or expected to discharge nutrients (nitrogenous compounds and/or phosphorus) when the design flow is equal to or greater than 0.1 MGD per 10 CSR 20-7.015(9)(D)8.

- ✓ Not applicable; the total design flow is less than 0.1 MGD for all wastewater outfalls.

OIL/WATER SEPARATORS:

Oil water separator (OWS) tank systems are frequently found at industrial sites where process water and stormwater may contain oils and greases, oily wastewaters, or other immiscible liquids requiring separation. Food industry discharges typically require pretreatment prior to discharge to municipally owned treatment works. Per 10 CSR 26-2.010(2)(B), all oil water separator tanks must be operated according to manufacturer's specifications and authorized in NPDES permits per 10 CSR 26-2.010(2) or may be regulated as a petroleum tank.

- ✓ Not applicable; the facility has not disclosed the use of any oil water separators they wish to include under the NPDES permit at this facility and therefore oil water separator tanks are not authorized by this permit.

OPERATIONAL CONTROL TESTING REQUIREMENTS:

Missouri Clean Water Commission regulation 10 CSR 20-9.010 requires certain publicly owned treatment works and privately owned facilities regulated by the Public Service Commission to conduct internal operational control monitoring to further ensure proper operation of the facility and to be a safeguard or early warning for potential plant upsets that could affect effluent quality. This requirement is only applicable if the publicly owned treatment works and privately owned facilities regulated by the Public Service Commission has a Population Equivalent greater than two hundred (200). 10 CSR 20-9.010(3) allows the Department to modify the monitoring frequency required in the rule based upon the Department's judgement of monitoring needs for process control at the specified facility.

- ✓ As per [10 CSR 20-9.010(4)], the facility is not required to conduct operational monitoring.

OPERATOR CERTIFICATION REQUIREMENTS:

Operators or supervisors of operations at regulated domestic wastewater treatment facilities shall be certified in accordance with 10 CSR 20-9 and any other applicable state law or regulation.

- ✓ Not applicable; this facility is not required to have a certified operator. The domestic wastewater population equivalent (PE) is less than two hundred (200). Additionally, this facility is not owned or operated by a municipality, public sewer district, county, public water supply district, or private sewer company regulated by the Public Service Commission, or operated by a state or federal agency.

PRETREATMENT:

This permit does not regulate pretreatment requirements for facilities discharging to an accepting permitted wastewater treatment facility. If applicable, the receiving entity (the publicly owned treatment works - POTW) is to ensure compliance with any effluent limitation guidelines for pretreatment listed in 40 CFR Subchapter N per 10 CSR 20-6.100. Pretreatment regulations per RSMo 644.016 are limitations on the introduction of pollutants or water contaminants into publicly owned treatment works or facilities.

- ✓ Not applicable, this facility does not discharge wastewater to a POTW.

REASONABLE POTENTIAL (RP):

Federal regulation [40 CFR Part 122.44(d)(1)(i)] requires effluent limitations for all pollutants which are (or may be) discharged at a level causing or have the reasonable potential to cause (or contribute to) an in-stream excursion above narrative or numeric water quality standards. Per 10 CSR 20-7.031(4), general criteria shall be applicable to all waters of the state at all times; however, acute

toxicity criteria may be exceeded by permit in zones of initial dilution, and chronic toxicity criteria may be exceeded by permit in mixing zones. If the permit writer determines any given pollutant has the reasonable potential to cause or contribute to an in-stream excursion above the WQS, the permit must contain effluent limits for the pollutant per 40 CFR Part 122.44(d)(1)(iii) and the most stringent limits per 10 CSR 20-7.031(9)(A). Permit writers may use mathematical reasonable potential analysis (RPA) using the Technical Support Document for Water Quality Based Toxics Control (TSD) methods (EPA/505/2-90-001) as found in Section 3.3.2, or may also use reasonable potential determinations (RPD) as provided in Sections 3.1.2, 3.1.3, and 3.2 of the TSD.

- ✓ Applicable; an RPA was conducted on appropriate parameters and was conducted as per (TSD Section 3.3.2). A more detailed version including calculations of this RPA is available upon request. See Wasteload Allocations (WLA) for Limits in this section.

Parameter:	Units	CMC Acute	CCC Chronic	Listing	Daily Max	Monthly Average	n#	CV	n Max	MF	RWC Acute	RWC Chronic	RP
Ammonia	mg/L	10.13	2.73	AQL	6.6	2.5	6	0.600	17.5	3.8178299	66.812022	66.812022	Yes

Units are (µg/L) unless otherwise noted.

n/a	Not Applicable
n	number of samples; if the number of samples is 10 or greater, then the CV value must be used in the WQBEL for the applicable constituent.
CV	Coefficient of Variation (CV) is calculated by dividing the Standard Deviation of the sample set by the mean of the same sample set.
CCC	continuous chronic concentration
CMC	continuous maximum concentration
RWC	Receiving Water Concentration: concentration of a toxicant or the parameter in the receiving water after mixing (if applicable)
MF	Multiplying Factor; 99% confidence level and 99% probability basis
RP	Reasonable Potential: an effluent is projected or calculated to cause an excursion above a water quality standard based on a number of factors including, as a minimum, the four factors listed in 40 CFR 122.44(d)(1)(ii).

- ✓ Applicable; the permit writer conducted an RPD on applicable parameters within the permit. See Part IV: Effluent Limits Determinations below.
- ✓ Permit writers use the Department's permit writer's manual (<http://dnr.mo.gov/env/wpp/permits/manual/permit-manual.htm>), the EPA's permit writer's manual (<https://www.epa.gov/npdes/npdes-permit-writers-manual>), program policies, and best professional judgment. For each parameter in each permit, the permit writer carefully considers all applicable information regarding: technology based effluent limitations, effluent limitation guidelines, water quality standards, stream flows and uses, and all applicable site specific information and data gathered by the facility through discharge monitoring reports and renewal (or new) application sampling. Best professional judgment is based on the experience of the permit writer, cohorts in the Department and resources at the EPA, research, and maintaining continuity of permits if necessary. For stormwater permits, the permit writer is required per 10 CSR 6.200(6)(B)2 to consider: A. application and other information supplied by the facility; B. effluent guidelines; C. best professional judgment of the permit writer; D. water quality; and E. BMPs. Part IV provides specific decisions related to this permit.

REMOVAL EFFICIENCY:

Removal efficiency is a method by which the Federal Regulations define Secondary Treatment and Equivalent to Secondary Treatment, which applies to Biochemical Oxygen Demand 5-day (BOD₅) and Total Suspended Solids (TSS) for Publicly Owned Treatment Works (POTWs)/municipals.

- ✓ Influent monitoring is not being required to determine percent removal. This facility is not a POTW or municipal facility.

RENEWAL REQUIREMENTS:

The renewal special condition permit requirement is designed to guide the facility to prepare and include all relevant and applicable information in accordance with 10 CSR 20-6.010(7)(A)-(C), and if applicable, federal regulations. The special condition may not include all requirements and requests for additional information may be made at the time of permit renewal under RSMo 644.051.13(5) and 40 CFR 122.21(h). Prior to submittal, the facility must review the entire submittal to confirm all required information and data is provided; it is the facility's responsibility to discern if additional information is required. Failure to fully disclose applicable information with the application or application addendums may result in a permit revocation per 10 CSR 20-6.010(8)(A) and may result in the forfeiture of permit shield protection authorized in RSMo 644.051.16.

SAMPLING FREQUENCY JUSTIFICATION:

Sampling and reporting frequency was generally retained from previous permit. 40 CFR 122.45(d)(1) indicates all continuous discharges shall be permitted with daily maximum and monthly average limits. Minimum sampling frequency for all parameters is annually per 40 CFR 122.44(i)(2).

SAMPLING TYPE JUSTIFICATION:

Sampling type was continued from the previous permit. The sampling types are representative of the discharges, and are protective of water quality. Discharges with altering effluent should have composite sampling; discharges with uniform effluent can have grab samples. Grab samples are usually appropriate for stormwater. Parameters which must have grab sampling are: pH, ammonia, *E. coli*, total residual chlorine, free available chlorine, hexavalent chromium, dissolved oxygen, total phosphorus, volatile organic compounds, and others. For further information on sampling and testing methods see 10 CSR 20-7.015(9)(D)2.

BOD₅, TSS, and WET test samples collected for mechanical plants per 10 CSR 20-7.015, shall be a 24 hour composite sample. Due to the small size of this facility this composite sample shall be made up from a minimum of four/six grab samples collected within a 24-hour period with a minimum of two hours between each grab sample. Grab samples, however, must be collected for pH, Ammonia as N, *E. coli*, TRC, oil & grease, and total phosphorus. This is due to the holding time restriction for *E. coli*, the volatility of Ammonia and TRC, and pH and DO cannot be preserved and must be sampled in the field. Ammonia, oil & grease, and total phosphorus samples must be immediately preserved with acid, these samples are to be collected as a grab.

SANITARY SEWER OVERFLOWS (SSO) AND INFLOW AND INFILTRATION (I&I):

Sanitary Sewer Overflows (SSOs) are defined as untreated sewage releases and are considered bypassing under state regulation [10 CSR 20-2.010(12)] and should not be confused with the federal definition of bypass. SSOs result from a variety of causes including blockages, line breaks, and sewer defects that can either allow wastewater to backup within the collection system during dry weather conditions or allow excess stormwater and groundwater to enter and overload the collection system during wet weather conditions. SSOs can also result from lapses in sewer system operation and maintenance, inadequate sewer design and construction, power failures, and vandalism. SSOs include overflows out of manholes, cleanouts, broken pipes, and other into waters of the state and onto city streets, sidewalks, and other terrestrial locations.

Inflow and Infiltration (I&I) is defined as unwanted intrusion of stormwater or groundwater into a collection system. This can occur from points of direct connection such as sump pumps, roof drain downspouts, foundation drains, and storm drain cross-connections or through cracks, holes, joint failures, faulty line connections, damaged manholes, and other openings in the collection system itself. I&I results from a variety of causes including line breaks, improperly sealed connections, cracks caused by soil erosion/settling, penetration of vegetative roots, and other sewer defects. In addition, excess stormwater and groundwater entering the collection system from line breaks and sewer defects have the potential to negatively impact the treatment facility.

Missouri RSMo §644.026.1.(13) mandates that the Department issue permits for discharges of water contaminants into the waters of this state, and also for the operation of sewer systems. Such permit conditions shall ensure compliance with all requirements as established by sections 644.006 to 644.141. Standard Conditions Part I, referenced in the permit, contains provisions requiring proper operation and maintenance of all facilities and systems of treatment and control. Missouri RSMo §644.026.1.(15) instructs the Department to require proper maintenance and operation of treatment facilities and sewer systems and proper disposal of residual waste from all such facilities. To ensure that public health and the environment are protected, any noncompliance which may endanger public health or the environment must be reported to the Department within 24 hours of the time the permittee becomes aware of the noncompliance. Standard Conditions Part I, referenced in the permit, contains the reporting requirements for the permittee when bypasses and upsets occur.

- ✓ This facility is not required to develop or implement a program for maintenance and repair of the collection system; however, it is a violation of Missouri State Environmental Laws and Regulations to allow untreated wastewater to discharge to waters of the state.

SCHEDULE OF COMPLIANCE (SOC):

A schedule of remedial measures included in a permit, including an enforceable sequence of interim requirements (actions, effluent limits, operations, or milestone events) leading to compliance with the Missouri Clean Water Law, its implementing regulations, and/or the terms and conditions of an operating permit. SOC's are allowed under 40 CFR 122.47 and 10 CSR 20-7.031(11) providing certain conditions are met. An SOC is not allowed:

- For effluent limitations based on technology-based standards established in accordance with federal requirements, if the deadline for compliance established in federal regulations has passed in accordance with 40 CFR 125.3.
- For a newly constructed facility in most cases per RSMo 644.029. Newly constructed facilities must meet all applicable effluent limitations (technology and water quality) when discharge begins. New facilities are required to install the appropriate control technologies as specified in a permit or antidegradation review. A SOC is allowed for a new water quality based effluent limit not included in a previously public noticed permit or antidegradation review, which may occur if a regulation changes during construction.
- To develop a TMDL, UAA, or other study associated with development of a site specific criterion. A facility is not prohibited from conducting these activities, but a SOC may not be granted for conducting these activities.

In order to provide guidance in developing SOC's, and to attain a greater level of consistency, the Department issued a policy on development of SOC's on October 25, 2012. The policy provides guidance to permit writers on standard time frames for schedules for common activities, and guidance on factors to modify the length of the schedule.

- ✓ Applicable; the time given for effluent limitations of this permit listed under Interim Effluent Limitations and Final Effluent Limitations were established in accordance with [10 CSR 20-7.031(11)]. The facility has been given a schedule of compliance to meet final effluent limits. See permit Sections A and B for compliance dates. Ammonia limits were recalculated based on the February 2020 guidance and local ecoregion conditions. The facility will not be able to meet certain monthly averages. A schedule is provided for the facility to implement additional controls or install additional treatment, as the facility determines necessary.

SPILLS, OVERFLOWS, AND OTHER UNAUTHORIZED DISCHARGE REPORTING:

Per 260.505 RSMo, any emergency involving a hazardous substance must be reported to the Department's 24 hour Environmental Emergency Response hotline at (573) 634-2436 at the earliest practicable moment after discovery. The Department may require the submittal of a written report detailing measures taken to clean up a spill. These reporting requirements apply whether or not the spill results in chemicals or materials leaving the permitted property or reaching waters of the state. This requirement is in addition to the noncompliance reporting requirement found in Standard Conditions Part I. <http://dnr.mo.gov/env/esp/spillbill.htm>

Any other spills, overflows, or unauthorized discharges reaching waters of the state must be reported to the regional office during normal business hours, or after normal business hours, to the Department's 24 hour Environmental Emergency Response spill line at 573-634-2436.

SLUDGE – INDUSTRIAL:

Industrial sludge is solid, semi-solid, or liquid residue generated during the treatment of industrial process or non-process wastewater in a treatment works; including but not limited to, scum or solids removed in primary, secondary, or advanced wastewater treatment process; scum and solids filtered from water supplies and backwashed; and any material derived from industrial sludge. Industrial sludge could also be derived from lagoon dredging or other similar maintenance activities.

✓ Not applicable; industrial sludge is not generated at this facility.

STANDARD CONDITIONS:

The standard conditions Part I attached to this permit incorporate all sections of 10 CSR 20-6.010(8) and 40 CFR 122.41(a) through (n) by reference as required by law. These conditions, in addition to the conditions enumerated within the standard conditions should be reviewed by the facility to ascertain compliance with this permit, state regulations, state statutes, federal regulations, and the Clean Water Act. Standard Conditions Part III, if attached to this permit, incorporate requirements dealing with domestic wastewater, domestic sludge, and land application of domestic wastes.

STORMWATER PERMITTING: LIMITATIONS AND BENCHMARKS:

Because of the fleeting nature of stormwater discharges, the Department, under the direction of EPA guidance, has determined monthly averages are capricious measures of stormwater-only discharges. The *Technical Support Document for Water Quality Based Toxics Control* (EPA/505/2-90-001; 1991) Section 3.1 indicates most procedures within the document apply only to water quality based approaches, not end-of-pipe technology-based controls. Hence, stormwater-only outfalls will generally only contain a maximum daily limit (MDL), a benchmark, or a monitoring requirement as dictated by site specific conditions, the BMPs in place, the BMPs proposed, past performance of the facility, and the receiving water's current quality.

Sufficient rainfall to cause a discharge for one hour or more from a facility would not necessarily cause significant flow in a receiving stream. Acute Water Quality Standards (WQSs) are based on one hour of exposure, and must be protected at all times. Therefore, industrial stormwater facilities with toxic contaminants present in the stormwater may have the potential to cause a violation of acute WQSs if toxic contaminants occur in sufficient amounts. In this instance, the permit writer may apply daily maximum limitations.

Conversely, it is unlikely for rainfall to cause a discharge for four continuous days from a facility; if this does occur however, the receiving stream will also likely sustain a significant amount of flow providing dilution. Most chronic WQSs are based on a four-day exposure with some exceptions. Under this scenario, most industrial stormwater facilities have limited potential to cause a violation of chronic water quality standards in the receiving stream.

A standard mass-balance equation cannot be calculated for stormwater because stormwater flow and flow in the receiving stream cannot be determined for conditions on any given day or storm event without real-time ad-hoc monitoring. The amount of stormwater discharged from the facility will vary based on current and previous rainfall, soil saturation, humidity, detention time, BMPs, surface permeability, etc. Flow in the receiving stream will vary based on climatic conditions, size of watershed, area of surfaces with reduced permeability (houses, parking lots, and the like) in the watershed, hydrogeology, topography, etc. Decreased permeability may increase the stream flow dramatically over a short period of time (flash).

Numeric benchmark values are based on site specific requirements taking in to account a number of factors but cannot be applied to any process water discharges. First, the technology in place at the site to control pollutant discharges in stormwater is evaluated. The permit writer also evaluates other similar permits for similar activities. A review of the guidance forming the basis of Environmental Protection Agency's (EPA's) *Multi-Sector General Permit for Stormwater Discharges Associated with Industrial Activity* (MSGP) may also occur. Because precipitation events are sudden and momentary, benchmarks based on state or federal standards or recommendations use the Criteria Maximum Concentration (CMC) value, or acute standard may also be used. The CMC is the estimate of the highest concentration of a material in surface water to which an aquatic community can be exposed briefly without resulting in an unacceptable effect. The CMC for aquatic life is intended to be protective of the vast majority of the aquatic communities in the United States. If a facility has not disclosed BMPs applicable to the pollutants for the site, the facility may not be eligible for benchmarks.

40 CFR 122.44(b)(1) requires the permit implement the most stringent limitations for each discharge, including industrially exposed stormwater; and 40 CFR 122.44(d)(1)(i) and (iii) requires the permit to include water-quality based effluent limitations where reasonable potential has been found. However, because of the non-continuous nature of stormwater discharges, staff are unable to perform statistical Reasonable Potential Analysis (RPA) under most stormwater discharge scenarios. Reasonable potential determinations (RPDs; see REASONABLE POTENTIAL above) using best professional judgment are performed.

Benchmarks require the facility to monitor, and if necessary, replace and update stormwater control measures. Benchmark concentrations are not effluent limitations. A benchmark exceedance, therefore, is not a permit violation; however, failure to take corrective action is a violation of the permit. Benchmark monitoring data is used to determine the overall effectiveness of control measures and to assist the facility in knowing when additional corrective actions may be necessary to comply with the conditions of the permit.

BMP inspections typically occur more frequently than sampling. Sampling frequencies are based on the facility's ability to comply with the benchmarks and the requirements of the permit. Inspections should occur after large rain events and any other time an issue is noted; sampling after a benchmark exceedance may need to occur to show the corrective action taken was meaningful.

When a permitted feature or outfall consists of only stormwater, a benchmark may be implemented at the discretion of the permit writer, if there is no RP for water quality excursions.

- ✓ Applicable, this facility is required to determine where any industrial stormwater leaves the site and prepare a SWPPP for those areas. Please review the citations above and below to determine what qualifies as industrially-exposed stormwater at the site. If none is occurring, the facility must report so at the renewal.

STORMWATER POLLUTION PREVENTION PLAN (SWPPP):

In accordance with 40 CFR 122.44(k), Best Management Practices (BMPs) must be used to control or abate the discharge of pollutants when: 1) Authorized under section 304(e) of the Clean Water Act (CWA) for the control of toxic pollutants and hazardous substances from ancillary industrial activities; 2) Authorized under section 402(p) of the CWA for the control of stormwater discharges; 3) Numeric effluent limitations are infeasible; or 4) the practices are reasonably necessary to achieve effluent limitations and standards or to carry out the purposes and intent of the CWA. In accordance with the EPA's *Developing Your Stormwater Pollution Prevention Plan, A Guide for Industrial Operators*, (EPA 833-B-09-002) published by the EPA in 2015 https://www.epa.gov/sites/production/files/2015-11/documents/swppp_guide_industrial_2015.pdf, BMPs are measures or practices used to reduce the amount of pollution entering waters of the state from a permitted facility. BMPs may take the form of a process, activity, or physical structure. Additionally in accordance with the Stormwater Management, a SWPPP is a series of steps and activities to 1) identify sources of pollution or contamination, and 2) select and carry out actions which prevent or control the pollution of storm water discharges. Additional information can be found in *Stormwater Management for Industrial Activities: Developing Pollution Prevention Plans and Best Management Practices* (EPA 832-R-92-006; September 1992).

A SWPPP must be prepared by the facility if the SIC code is found in 40 CFR 122.26(b)(14) and/or 10 CSR 20-6.200(2). A SWPPP may be required of other facilities where stormwater has been identified as necessitating better management. The purpose of a SWPPP is to comply with all applicable stormwater regulations by creating an adaptive management plan to control and mitigate stream pollution from stormwater runoff. Developing a SWPPP provides opportunities to employ appropriate BMPs to minimize the risk of pollutants being discharged during storm events. The following paragraph outlines the general steps the facility should take to determine which BMPs will work to achieve the benchmark values or limits in the permit. This section is not intended to be all encompassing or restrict the use of any physical BMP or operational and maintenance procedure assisting in pollution control. Additional steps or revisions to the SWPPP may be required to meet the requirements of the permit.

Areas which should be included in the SWPPP are identified in 40 CFR 122.26(b)(14). Once the potential sources of stormwater pollution have been identified, a plan should be formulated to best control the amount of pollutant being released and discharged by each activity or source. This should include, but is not limited to, minimizing exposure to stormwater, good housekeeping measures, proper facility and equipment maintenance, spill prevention and response, vehicle traffic control, and proper materials handling. Once a plan has been developed the facility will employ the control measures determined to be adequate to achieve the benchmark values discussed above. The facility will conduct monitoring and inspections of the BMPs to ensure they are working properly and re-evaluate any BMP not achieving compliance with permitting requirements. For example, if sample results from an outfall show values of TSS above the benchmark value, the BMP being employed is deficient in controlling stormwater pollution. Corrective action should be taken to repair, improve, or replace the failing BMP. This internal evaluation is required at least once per month but should be continued more frequently if BMPs continue to fail. If failures do occur, continue this trial and error process until appropriate BMPs have been established.

For new, altered, or expanded stormwater discharges, the SWPPP shall identify reasonable and effective BMPs while accounting for environmental impacts of varying control methods. The antidegradation analysis must document why no discharge or no exposure options are not feasible. The selection and documentation of appropriate control measures shall serve as an alternative analysis of

technology and fulfill the requirements of antidegradation [10 CSR 20-7.031(3)]. For further guidance, consult the antidegradation implementation procedure (<http://dnr.mo.gov/env/wpp/docs/AIP050212.pdf>).

Alternative Analysis (AA) evaluation of the BMPs is a structured evaluation of BMPs which are reasonable and cost effective. The AA evaluation should include practices designed to be: 1) non-degrading; 2) less degrading; or 3) degrading water quality. The glossary of AIP defines these three terms. The chosen BMP will be the most reasonable and effective management strategy while ensuring the highest statutory and regulatory requirements are achieved and the highest quality water attainable for the facility is discharged. The AA evaluation must demonstrate why “no discharge” or “no exposure” is not a feasible alternative at the facility. This structured analysis of BMPs serves as the antidegradation review, fulfilling the requirements of 10 CSR 20-7.031(3) Water Quality Standards and *Antidegradation Implementation Procedure* (AIP), Section II.B.

If parameter-specific numeric benchmark exceedances continue to occur and the facility feels there are no practicable or cost-effective BMPs which will sufficiently reduce a pollutant concentration in the discharge to the benchmark values established in the permit, the facility can submit a request to re-evaluate the benchmark values. This request needs to include 1) a detailed explanation of why the facility is unable to comply with the permit conditions and unable to establish BMPs to achieve the benchmark values; 2) financial data of the company and documentation of cost associated with BMPs for review and 3) the SWPPP, which should contain adequate documentation of BMPs employed, failed BMPs, corrective actions, and all other required information. This will allow the Department to conduct a cost analysis on control measures and actions taken by the facility to determine cost-effectiveness of BMPs. The request shall be submitted in the form of an operating permit modification, which includes an appropriate fee; the application is found at: <https://dnr.mo.gov/forms/#WaterPollution>

- ✓ Applicable; a SWPPP shall be developed and implemented for any industrially-exposed stormwater at this facility; see specific requirements in the SPECIAL CONDITIONS section of the permit. If there is no industrially-exposed stormwater, the facility must determine why the stormwater at the site is not industrially exposed, and provide a brief statement to the Department for renewal purposes.

SUFFICIENTLY SENSITIVE ANALYTICAL METHODS:

Please review Standard Conditions Part 1, section A, number 4. The analytical and sampling methods used shall conform to the reference methods listed in 10 CSR 20-7.015 and/or 40 CFR 136 unless alternates are approved by the Department and incorporated within this permit. The facility shall use sufficiently sensitive analytical methods for detecting, identifying, and measuring the concentrations of pollutants. The facility shall ensure the selected methods are able to quantify the presence of pollutants in a given discharge at concentrations low enough to determine compliance with Water Quality Standards in 10 CSR 20-7.031 or effluent limitations unless provisions in the permit allow for other alternatives. A method is “sufficiently sensitive” when; 1) the method quantifies the pollutant below the level of the applicable water quality criterion or; 2) the method minimum level is above the applicable water quality criterion, but the amount of pollutant in a facility’s discharge is high enough the method detects and quantifies the level of pollutant in the discharge, or 3) the method has the lowest minimum level of the analytical methods approved under 10 CSR 20-7.015 and or 40 CFR 136. These methods are also required for parameters listed as monitoring only, as the data collected may be used to determine if numeric limitations need to be established. A facility is responsible for working with their contractors to ensure the analysis performed is sufficiently sensitive.

UNDERGROUND INJECTION CONTROL (UIC):

The UIC program for all classes of wells in the State of Missouri is administered by the Missouri Department of Natural Resources and approved by EPA pursuant to section 1422 and 1425 of the Safe Drinking Water Act (SDWA) and 40 CFR 147 Subpart AA. Injection wells are classified based on the liquids which are being injected. Class I wells are hazardous waste wells which are banned by RSMo 577.155; Class II wells are established for oil and natural gas production; Class III wells are used to inject fluids to extract minerals; Class IV wells are also banned by Missouri in RSMo 577.155; Class V wells are shallow injection wells; some examples are heat pump wells and groundwater remediation wells. Domestic wastewater being disposed of sub-surface is also considered a Class V well. In accordance with 40 CFR 144.82, construction, operation, maintenance, conversion, plugging, or closure of injection wells shall not cause movement of fluids containing any contaminant into Underground Sources of Drinking Water (USDW) if the presence of any contaminant may cause a violation of drinking water standards or groundwater standards under 10 CSR 20-7.031, or other health based standards, or may otherwise adversely affect human health. If the director finds the injection activity may endanger USDWs, the Department may require closure of the injection wells, or other actions listed in 40 CFR 144.12(c), (d), or (e). In accordance with 40 CFR 144.26, the facility shall submit a Class V Well Inventory Form for each active or new underground injection well drilled, or when the status of a well changes, to the Missouri Department of Natural Resources, Geological Survey Program, P.O. Box 250, Rolla, Missouri 65402. The Class V Well Inventory Form can be requested from the Geological Survey Program or can be found at the following web address: <http://dnr.mo.gov/forms/780-1774-f.pdf> Single family residential septic systems and non-residential septic systems used solely for sanitary waste and having the capacity to serve fewer than 20 persons a day are excluded from the UIC requirements (40 CFR 144.81(9)).

- ✓ Not applicable; the facility has not submitted materials indicating the facility will be performing UIC at this site.

VARIANCE:

Per the Missouri Clean Water Law §644.061.4, variances shall be granted for such period of time and under such terms and conditions as specified by the commission in its order. The variance may be extended by affirmative action of the commission. In no event shall the variance be granted for a period of time greater than is reasonably necessary for complying with the Missouri Clean Water Law §§644.006 to 644.141 or any standard, rule or regulation promulgated pursuant to Missouri Clean Water Law §§644.006 to 644.141.

- ✓ Not applicable; this permit is not drafted under premise of a petition for variance.

WASTELOAD ALLOCATIONS (WLA) FOR LIMITS:

As per [10 CSR 20-2.010; definitions], the WLA is the amount of pollutant each discharger is allowed to discharge into the receiving stream without endangering water quality. Two general types of effluent limitations, technology-based effluent limits (TBELs) and water quality based effluent limits (WQBELs) are reviewed. If one limit does not provide adequate protection for the receiving water, then the other must be used per 10 CSR 20-7.015(9)(A). Total Maximum Daily Loads, if required for this facility, were also reviewed.

- ✓ Applicable; wasteload allocations for toxic parameters were calculated using water quality criteria or water quality model results and by applying *Technical Support Document For Water Quality-Based Toxics Control* or TSD EPA/505/2-90-001; 3/1991 methods.

WASTELOAD ALLOCATION (WLA) MODELING:

Facilities may submit site specific studies to better determine the site specific wasteload allocations applied in permits.

- ✓ Not applicable; a WLA study was either not submitted or determined not applicable by Department staff.

WATER QUALITY STANDARD REVISION:

In accordance with section 644.058, RSMo, the Department is required to utilize an evaluation of the environmental and economic impacts of modifications to water quality standards of twenty-five percent or more when making individual site-specific permit decisions.

- ✓ This operating permit does not contain requirements for a water quality standard changing twenty-five percent or more since the previous operating permit.

PART IV. EFFLUENT LIMITS DETERMINATIONS**OUTFALL #001 – DOMESTIC WASTEWATER****EFFLUENT LIMITATIONS TABLE:**

PARAMETERS	UNIT	DAILY MAX	WEEKLY AVERAGE	MONTHLY AVG.	PREVIOUS PERMIT LIMITS	MINIMUM SAMPLING FREQUENCY	REPORTING FREQUENCY	SAMPLE TYPE
PHYSICAL								
FLOW	MGD	*	-	*	SAME	ONCE/MONTH	MONTHLY	24 Hr Tot
CONVENTIONAL								
BOD ₅	mg/L	-	45	30	SAME	ONCE/MONTH	MONTHLY	COMPOSITE **
<i>E. COLI</i>	#/100mL	1030	-	206	SAME	ONCE/MONTH	MONTHLY	GRAB
pH [†]	SU	6.5 TO 9.0			SAME	ONCE/MONTH	MONTHLY	GRAB
TOTAL SUSPENDED SOLIDS (TSS)	mg/L	-	45	30	SAME	ONCE/MONTH	MONTHLY	COMPOSITE **
NUTRIENTS								
AMMONIA AS N – APR - SEP	mg/L	3.6	-	1.4	♦ OLD	ONCE/MONTH	MONTHLY	GRAB
AMMONIA AS N – OCT - MAR	mg/L	7.5	-	2.9	♦ OLD	ONCE/MONTH	MONTHLY	GRAB
AMMONIA AS N – JAN, FEB	mg/L	12.1	-	3.1	♦ NEW	ONCE/MONTH	MONTHLY	GRAB
AMMONIA AS N – MAR	mg/L	10.1	-	2.1	♦ NEW	ONCE/MONTH	MONTHLY	GRAB
AMMONIA AS N – APR	mg/L	8.4	-	2.1	♦ NEW	ONCE/MONTH	MONTHLY	GRAB
AMMONIA AS N – MAY	mg/L	12.1	-	2.1	♦ NEW	ONCE/MONTH	MONTHLY	GRAB
AMMONIA AS N – JUN	mg/L	10.1	-	1.3	♦ NEW	ONCE/MONTH	MONTHLY	GRAB
AMMONIA AS N – JUL, AUG	mg/L	8.4	-	0.9	♦ NEW	ONCE/MONTH	MONTHLY	GRAB
AMMONIA AS N – SEP	mg/L	8.4	-	1.2	♦ NEW	ONCE/MONTH	MONTHLY	GRAB
AMMONIA AS N – OCT	mg/L	8.4	-	1.8	♦ NEW	ONCE/MONTH	MONTHLY	GRAB
AMMONIA AS N – NOV	mg/L	8.4	-	2.4	♦ NEW	ONCE/MONTH	MONTHLY	GRAB
AMMONIA AS N – DEC	mg/L	10.1	-	2.7	♦ NEW	ONCE/MONTH	MONTHLY	GRAB

* monitoring and reporting requirement only

** composite sample, see permit

† report the minimum and maximum pH values; pH is not to be averaged

new parameter not established in previous state operating permit

♦ see permit section A and narrative under ammonia parameter; this parameter is provided an SOC, See Part B in the permit for SOC

DERIVATION AND DISCUSSION OF LIMITS:**PHYSICAL:****Flow**

In accordance with [40 CFR Part 122.44(i)(1)(ii)] the volume of effluent discharged from each outfall is needed to ensure compliance with permitted effluent limitations. If the facility is unable to obtain effluent flow, then it is the responsibility of the facility to inform the Department, which may require the submittal of an operating permit modification. The facility will report the total flow in millions of gallons per day (MGD), monthly monitoring continued from previous permit.

CONVENTIONAL:**Biochemical Oxygen Demand - 5 Day (BOD₅)**

Operating permit retains 45 mg/l as a weekly average and 30 mg/l as a monthly average from the previous permit. Effluent limits were established in accordance with 10 CSR 20-7.015(8) for discharges to all other waters.

Escherichia coli (E. coli)

Daily maximum limit of 1030 colony forming units per 100 mL [10 CSR 20-7.015(9)(B)1.E.] and a monthly geometric mean limit of 206 bacteria per 100 mL [10 CSR 20-7.031 Table A1] during the recreational season from April 1 through October 31 only [10 CSR 20-7.031(5)(C)], to protect Whole Body Contact (B) [10 CSR 20-7.031(C)2.A.(II)] designated use of the receiving stream.

Monthly monitoring frequency established per permit writer's best professional judgment. Additional samples should be obtained if necessary to meet permit limits for monthly geometric mean.

An effluent limit for both daily maximum and monthly geometric mean is required by 40 CFR 122.45(d). The geometric mean is calculated by multiplying all of the data points and then taking the n^{th} root of this product, where $n = \#$ of samples collected. For example: Five *E. coli* samples were collected with results of 1, 4, 5, 6, and 10 (#/100 mL). Geometric mean = 5^{th} root of $(1)(4)(5)(6)(10) = 5^{\text{th}}$ root of 1,200 = 4.1 #/100 mL.

Data for this parameter exceeded the daily maximum and monthly average frequently prior to installation of the UV disinfection system. Since the installation of the UV disinfection system, no exceedances were noted. The facility must continue to assure the UV system is functioning properly to comply with the limitations of this permit.

pH

6.5 to 9.0 SU – instantaneous grab sample. Water quality limits [10 CSR 20-7.031(5)(E)] are applicable to this outfall. pH is a fundamental water quality indicator. Additionally, metals leachability and ammonia availability in wastewater is dependent on pH. Limitations in this permit will protect against aquatic organism toxicity, downstream water quality issues, human health hazard contact, and negative physical changes in accordance with the general criteria at 10 CSR 20-7.031(4) and the Clean Water Act's (CWA) goal of 100% fishable and swimmable rivers and streams. The facility reported from 6.9 to 8.7 at this outfall. The permit writer has determined limits on this parameter should be continued due to fluctuations in the effluent causing reasonable potential to cause or contribute to exceedances of water quality criteria.

Total Suspended Solids (TSS)

Operating permit retains 45 mg/L as a weekly average and 30 mg/L as a monthly average. Effluent limits were established in accordance with 10 CSR 20-7.015(8) for discharges to All Other Waters.

NUTRIENTS:**Ammonia, Total as Nitrogen**

Previous permit limits were based on the 2007 ammonia guidance. This permit implements monthly limits in accordance with 2020 guidance. See Part III, ANTIBACKSLIDING for more information. Early life stages present [10 CSR 20-7.031(5)(B)7.C & Table B3], salmonids absent based on WWH designation of stream; total ammonia nitrogen criteria apply. This facility has RP, see Part III, REASONABLE POTENTIAL for more information. There are no standardized technology limits for this discharge.

The Department previously followed the 2007 Ammonia Guidance method for derivation of ammonia limits. However, the EPA's Technical Support Document for Water Quality-Based Toxic Controls (TSD) establishes other alternatives to limit derivation. The Department has determined the approach established in Section 5.4.2 of the TSD, which allows for direct application of both the acute and chronic wasteload allocations (WLA) as permit limits for toxic pollutants, is more appropriate limit derivation approach. Using this method for a discharge to a waterbody where mixing is not allowed, the criterion continuous concentration (CCC) and the criterion maximum concentration (CMC) will equal the chronic and acute WLA respectively. The WLAs are then applied as effluent limits, per Section 5.4.2 of the TSD, where the CMC is the Daily Maximum and the CCC is the Monthly Average. The direct application of both acute and chronic criteria as WLA is also applicable for facilities discharging into receiving waterbodies with mixing considerations. The CCC and CMC will need to be calculated into WLA with mixing considerations using the standard mass-balance equation. In the event mixing considerations derive an AML less stringent than the MDL, the AML and MDL will be equal and based on the MDL.

	Interior River Valleys and Hills	
Month	Median pH	75th %ile °C
Jan	7.8	2.7
Feb	7.8	4.5
Mar	7.9	9.5
Apr	8.0	16.1
May	7.8	21.1
Jun	7.9	26.0

	Interior River Valleys and Hills	
Month	Median pH	75th %ile °C
Jul	8.0	29.4
Aug	8.0	29.3
Sep	8.0	25.6
Oct	8.0	19.1
Nov	8.0	12.0
Dec	7.9	6.9

January

Previous limit: 7.5 mg/L daily maximum, 2.9 mg/L monthly average.

Acute AQL: $(0.411/(1+10^{7.204-7.8}))+(58.4/(1+10^{(7.8-7.204)})) = 12.139$ mg/L

Chronic AQL: $(0.0577/(1+10^{7.688-7.8}))+(2.487/(1+10^{7.8-7.688}))*\text{MIN}(2.85,(1.45*10^{0.028*(25-2.7)})) = 3.122$ mg/L

February

Previous limit: 7.5 mg/L daily maximum, 2.9 mg/L monthly average.

Acute AQL: $(0.411/(1+10^{7.204-7.8}))+(58.4/(1+10^{(7.8-7.204)})) = 12.139$ mg/L

Chronic AQL: $(0.0577/(1+10^{7.688-7.8}))+(2.487/(1+10^{7.8-7.688}))*\text{MIN}(2.85,(1.45*10^{0.028*(25-4.5)})) = 3.122$ mg/L

March

Previous limit: 7.5 mg/L daily maximum, 2.9 mg/L monthly average.

Acute AQL: $(0.411/(1+10^{7.204-7.9}))+(58.4/(1+10^{(7.9-7.204)})) = 10.131$ mg/L

Chronic AQL: $(0.0577/(1+10^{7.688-7.9}))+(2.487/(1+10^{7.9-7.688}))*\text{MIN}(2.85,(1.45*10^{0.028*(25-9.5)})) = 2.732$ mg/L

April

Previous limit: 3.6 mg/L daily maximum, 1.4 mg/L monthly average.

Acute AQL: $(0.411/(1+10^{7.204-8}))+(58.4/(1+10^{(8-7.204)})) = 8.408$ mg/L

Chronic AQL: $(0.0577/(1+10^{7.688-8}))+(2.487/(1+10^{8-7.688}))*\text{MIN}(2.85,(1.45*10^{0.028*(25-16.1)})) = 2.137$ mg/L

May

Previous limit: 3.6 mg/L daily maximum, 1.4 mg/L monthly average.

Acute AQL: $(0.411/(1+10^{7.204-7.8}))+(58.4/(1+10^{(7.8-7.204)})) = 12.139$ mg/L

Chronic AQL: $(0.0577/(1+10^{7.688-7.8}))+(2.487/(1+10^{7.8-7.688}))*\text{MIN}(2.85,(1.45*10^{0.028*(25-21.1)})) = 2.054$ mg/L

June

Previous limit: 3.6 mg/L daily maximum, 1.4 mg/L monthly average.

Acute AQL: $(0.411/(1+10^{7.204-7.9}))+(58.4/(1+10^{(7.9-7.204)})) = 10.131$ mg/L

Chronic AQL: $(0.0577/(1+10^{7.688-7.9}))+(2.487/(1+10^{7.9-7.688}))*\text{MIN}(2.85,(1.45*10^{0.028*(25-26)})) = 1.322$ mg/L

July

Previous limit: 3.6 mg/L daily maximum, 1.4 mg/L monthly average.

Acute AQL: $(0.411/(1+10^{7.204-8}))+(58.4/(1+10^{(8-7.204)})) = 8.408$ mg/L

Chronic AQL: $(0.0577/(1+10^{7.688-8}))+(2.487/(1+10^{8-7.688}))*\text{MIN}(2.85,(1.45*10^{0.028*(25-29.4)})) = 0.929$ mg/L

August

Previous limit: 3.6 mg/L daily maximum, 1.4 mg/L monthly average.

Acute AQL: $(0.411/(1+10^{7.204-8}))+(58.4/(1+10^{(8-7.204)})) = 8.408$ mg/L

Chronic AQL: $(0.0577/(1+10^{7.688-8}))+(2.487/(1+10^{8-7.688}))*\text{MIN}(2.85,(1.45*10^{0.028*(25-29.3)})) = 0.935$ mg/L

September

Previous limit: 3.6 mg/L daily maximum, 1.4 mg/L monthly average.

Acute AQL: $(0.411/(1+10^{7.204-8}))+(58.4/(1+10^{(8-7.204)})) = 8.408$ mg/L

Chronic AQL: $(0.0577/(1+10^{7.688-8}))+(2.487/(1+10^{8-7.688}))*\text{MIN}(2.85,(1.45*10^{0.028*(25-25.6)})) = 1.176$ mg/L

October

Previous limit: 7.5 mg/L daily maximum, 2.9 mg/L monthly average.

Acute AQL: $(0.411/(1+10^{7.204-8}))+(58.4/(1+10^{(8-7.204)})) = 8.408$ mg/L

Chronic AQL: $(0.0577/(1+10^{7.688-8}))+(2.487/(1+10^{8-7.688}))*\text{MIN}(2.85,(1.45*10^{0.028*(25-19.1)})) = 1.768$ mg/L

November

Previous limit: 7.5 mg/L daily maximum, 2.9 mg/L monthly average.

Acute AQL: $(0.411/(1+10^{7.204-8}))+(58.4/(1+10^{(8-7.204)})) = 8.408 \text{ mg/L}$

Chronic AQL: $(0.0577/(1+10^{7.688-8}))+(2.487/(1+10^{8-7.688}))*\text{MIN}(2.85,(1.45*10^{0.028*(25-12)})) = 2.362 \text{ mg/L}$

December

Previous limit: 7.5 mg/L daily maximum, 2.9 mg/L monthly average.

Acute AQL: $(0.411/(1+10^{7.204-7.9}))+(58.4/(1+10^{(7.9-7.204)})) = 10.131 \text{ mg/L}$

Chronic AQL: $(0.0577/(1+10^{7.688-7.9}))+(2.487/(1+10^{7.9-7.688}))*\text{MIN}(2.85,(1.45*10^{0.028*(25-6.9)})) = 2.732 \text{ mg/L}$

The facility cannot meet all of the new limits, see permit Part B, and fact sheet Part III, SCHEDULE OF COMPLIANCE for additional information on the schedule to meet the limits. This permit authorizes certain months of less stringent limits, See permit, Tables A-1 and A-2, for these months, the less stringent limit will be applied immediately, see fact sheet Part III, ANTIBACKSLIDING. All daily maximum values are less stringent. However, some limits are more stringent than the previous permit's limits. All limits which are more stringent will be supplied a schedule to come in to compliance with those limits.

Some limits are very stringent, for example, July and August monthly averages. The permit writer notes, there are other scenarios available to the facility other than discharge during these months. First, the facility may consider land application as a method of wastewater dispersal; watering vegetation in a manner which does not allow runoff, which may include watering trees and grasses during the hottest summer months, would allow the facility to not discharge from outfall #001 at these times. However, significant infrastructure is required, including a holding tank that is designed to retain all of the wastewater, and a robust sprinkler system to evenly disperse the wastewater. The facility also needs to hold or lease land for the land application of the wastewater; it appears from the satellite imagery there is significant adjacent lands to provide sufficient area for land application. If the facility chooses to not land apply, the facility may install a holding tank or other design feature so the system does not have a constant discharge. When a facility batch discharges, the Department provides alternative effluent limits which typically do not include monthly average limitations. When the monthly average is omitted, then the facility is only required to meet the daily maximum for that month. A third solution may be to combine the cooling water and domestic wastewater where the cooling water would provide dilution, but TSS limits would then apply to the cooling water. A fourth solution is to connect to a local publically owned treatment works. Other solutions may be available to this facility, and contacting the permit writer, searching the internet, or hiring a consultant would likely result in helpful information for the facility.

Most of the solutions will require a permit modification, as they were not considered in the development of this permit. If the facility wishes to implement any of these changes, they must contact the Department prior to construction or implementation of the change. The final effluent limits are effective at the renewal year. Please contact a permit writer or regional office for additional information.

OUTFALL #002 – NON-CONTACT COOLING WATER**EFFLUENT LIMITATIONS TABLE:**

PARAMETERS	UNIT	DAILY MAX	MONTHLY AVG.	PREVIOUS PERMIT LIMITS	MINIMUM SAMPLING FREQUENCY	REPORTING FREQUENCY	SAMPLE TYPE
PHYSICAL							
FLOW	MGD	*	*	SAME	ONCE/MONTH	MONTHLY	24 Hr. Tot
TEMPERATURE	°F	*	*	°C MONITORING	ONCE/MONTH	MONTHLY	GRAB
CONVENTIONAL							
OXYGEN, DISSOLVED	mg/L	MIN*	*	SAME	ONCE/MONTH	MONTHLY	GRAB
pH †	SU	6.5-9.0	6.5-9.0	SAME	ONCE/MONTH	MONTHLY	GRAB

* monitoring and reporting requirement only

† report the minimum and maximum pH values; pH is not to be averaged

DERIVATION AND DISCUSSION OF LIMITS:**PHYSICAL:****Flow**

In accordance with [40 CFR Part 122.44(i)(1)(ii)] the volume of effluent discharged from each outfall is needed to ensure compliance with permitted effluent limitations. If the facility is unable to obtain effluent flow, then it is the responsibility of the facility to inform the Department, which may require the submittal of an operating permit modification. The facility will report the total flow in millions of gallons per day (MGD), monthly monitoring continued from previous permit.

Temperature

Monthly monitoring. In accordance with 10 CSR 20-7.031(5)(D), water contaminant sources shall not cause or contribute to stream temperature in excess of ninety degrees Fahrenheit (90 °F) or change the stream temperature by more than 5 degrees Fahrenheit. Previous permit required monitoring in degrees Celsius, this permit initiates sampling in Fahrenheit because Fahrenheit is more common.

CONVENTIONAL:**Oxygen, Dissolved**

Monthly monitoring continued from previous permit. This facility utilizes groundwater in the cooling system. Several factors can cause low dissolved oxygen, such as high dissolved organic components, high nitrogen, high iron, or other oxygen demanding sequences. Sometimes, even the age of the groundwater can contribute to lower natural dissolved oxygen concentrations. Data prior to 2019 show significantly lower values than current data; most data in the last year is above 5.0 mg/L, which is the warm water, water quality criteria.

pH

6.5 to 9.0 SU – instantaneous grab sample, monthly. Water quality limits [10 CSR 20-7.031(5)(E)] are applicable to this outfall. pH is a fundamental water quality indicator. Additionally, metals leachability and ammonia availability in wastewater is dependent on pH. Limitations in this permit will protect against aquatic organism toxicity, downstream water quality issues, human health hazard contact, and negative physical changes in accordance with the general criteria at 10 CSR 20-7.031(4) and the Clean Water Act's (CWA) goal of 100% fishable and swimmable rivers and streams.

PART V. ADMINISTRATIVE REQUIREMENTS

On the basis of preliminary staff review and the application of applicable standards and regulations, the Department, as administrative agent for the Missouri Clean Water Commission, proposes to issue a permit(s) subject to certain effluent limitations, schedules, and special conditions contained herein and within the operating permit. The proposed determinations are tentative pending public comment.

PERMIT SYNCHRONIZATION:

The Department of Natural Resources is currently undergoing a synchronization process for operating permits. Permits are normally issued on a five-year term, but to achieve synchronization many permits will need to be issued for less than the full five years allowed by regulation. The intent is all permits within a watershed will move through the Watershed Based Management (WBM) cycle together will all expire in the same fiscal year. <http://dnr.mo.gov/env/wpp/cpp/docs/watershed-based-management.pdf>. This will allow further streamlining by placing multiple permits within a smaller geographic area on public notice simultaneously, thereby reducing repeated administrative efforts. This will also allow the Department to explore a watershed based permitting effort at some point in the future. Renewal applications must continue to be submitted within 180 days of expiration, however, in instances where effluent data from the previous renewal is less than two years old, such data may be re-submitted to meet the requirements of the renewal application. If the permit provides a schedule of compliance for meeting new water quality based effluent limits beyond the expiration date of the permit, the time remaining in the schedule of compliance will be allotted in the renewed permit.

✓ This permit will maintain synchronization by expiring in 5 years.

PUBLIC NOTICE:

The Department shall give public notice a draft permit has been prepared and its issuance is pending. Additionally, public notice will be issued if a public hearing is to be held because of a significant degree of interest in or with water quality concerns related to a draft permit. No public notice is required when a request for a permit modification or termination is denied; however, the requester and facility must be notified of the denial in writing. <http://dnr.mo.gov/env/wpp/permits/pn/index.html>

The Department must issue public notice of a pending operating permit or of a new or reissued statewide general permit. The public comment period is the length of time not less than 30 days following the date of the public notice which interested persons may submit written comments about the proposed permit.

For persons wanting to submit comments regarding this proposed operating permit, then please refer to the Public Notice page located at the front of this draft operating permit. The Public Notice page gives direction on how and where to submit appropriate comments.

✓ The Public Notice period for this operating permit was from 10/2/2020-11/2/2020; no comments were received.

DATE OF FACT SHEET: NOVEMBER 3, 2020

COMPLETED BY:

PAM HACKLER, ENVIRONMENTAL SCIENTIST
MISSOURI DEPARTMENT OF NATURAL RESOURCES
WATER PROTECTION PROGRAM
OPERATING PERMITS SECTION - INDUSTRIAL UNIT
(573) 526-3386
pam.hackler@dnr.mo.gov



STANDARD CONDITIONS FOR NPDES PERMITS
ISSUED BY
THE MISSOURI DEPARTMENT OF NATURAL RESOURCES
MISSOURI CLEAN WATER COMMISSION
REVISED
AUGUST 1, 2014

These Standard Conditions incorporate permit conditions as required by 40 CFR 122.41 or other applicable state statutes or regulations. These minimum conditions apply unless superseded by requirements specified in the permit.

Part I – General Conditions

Section A – Sampling, Monitoring, and Recording

1. **Sampling Requirements.**
 - a. Samples and measurements taken for the purpose of monitoring shall be representative of the monitored activity.
 - b. All samples shall be taken at the outfall(s) or Missouri Department of Natural Resources (Department) approved sampling location(s), and unless specified, before the effluent joins or is diluted by any other body of water or substance.
2. **Monitoring Requirements.**
 - a. Records of monitoring information shall include:
 - i. The date, exact place, and time of sampling or measurements;
 - ii. The individual(s) who performed the sampling or measurements;
 - iii. The date(s) analyses were performed;
 - iv. The individual(s) who performed the analyses;
 - v. The analytical techniques or methods used; and
 - vi. The results of such analyses.
 - b. If the permittee monitors any pollutant more frequently than required by the permit at the location specified in the permit using test procedures approved under 40 CFR Part 136, or another method required for an industry-specific waste stream under 40 CFR subchapters N or O, the results of such monitoring shall be included in the calculation and reported to the Department with the discharge monitoring report data (DMR) submitted to the Department pursuant to Section B, paragraph 7.
3. **Sample and Monitoring Calculations.** Calculations for all sample and monitoring results which require averaging of measurements shall utilize an arithmetic mean unless otherwise specified in the permit.
4. **Test Procedures.** The analytical and sampling methods used shall conform to the reference methods listed in 10 CSR 20-7.015 unless alternates are approved by the Department. The facility shall use sufficiently sensitive analytical methods for detecting, identifying, and measuring the concentrations of pollutants. The facility shall ensure that the selected methods are able to quantify the presence of pollutants in a given discharge at concentrations that are low enough to determine compliance with Water Quality Standards in 10 CSR 20-7.031 or effluent limitations unless provisions in the permit allow for other alternatives. A method is “sufficiently sensitive” when; 1) the method minimum level is at or below the level of the applicable water quality criterion for the pollutant or, 2) the method minimum level is above the applicable water quality criterion, but the amount of pollutant in a facility’s discharge is high enough that the method detects and quantifies the level of pollutant in the discharge, or 3) the method has the lowest minimum level of the analytical methods approved under 10 CSR 20-7.015. These methods are also required for parameters that are listed as monitoring only, as the data collected may be used to determine if limitations need to be established. A permittee is responsible for working with their contractors to ensure that the analysis performed is sufficiently sensitive.
5. **Record Retention.** Except for records of monitoring information required by the permit related to the permittee’s sewage sludge use and disposal activities, which shall be retained for a period of at least five (5) years (or longer as required by 40 CFR part 503), the permittee shall retain records of all monitoring information, including all calibration and maintenance records and all original strip chart recordings for continuous monitoring instrumentation, copies of all reports required by the permit, and records of all data used to complete the application for the permit, for a period of at least three (3) years from the date of the sample, measurement, report or application. This period may be extended by request of the Department at any time.

6. **Illegal Activities.**
 - a. The Federal Clean Water Act provides that any person who falsifies, tampers with, or knowingly renders inaccurate any monitoring device or method required to be maintained under the permit shall, upon conviction, be punished by a fine of not more than \$10,000, or by imprisonment for not more than two (2) years, or both. If a conviction of a person is for a violation committed after a first conviction of such person under this paragraph, punishment is a fine of not more than \$20,000 per day of violation, or by imprisonment of not more than four (4) years, or both.
 - b. The Missouri Clean Water Law provides that any person or who falsifies, tampers with, or knowingly renders inaccurate any monitoring device or method required to be maintained pursuant to sections 644.006 to 644.141 shall, upon conviction, be punished by a fine of not more than \$10,000, or by imprisonment for not more than six (6) months, or by both. Second and successive convictions for violation under this paragraph by any person shall be punished by a fine of not more than \$50,000 per day of violation, or by imprisonment for not more than two (2) years, or both.

Section B – Reporting Requirements

1. **Planned Changes.**
 - a. The permittee shall give notice to the Department as soon as possible of any planned physical alterations or additions to the permitted facility when:
 - i. The alteration or addition to a permitted facility may meet one of the criteria for determining whether a facility is a new source in 40 CFR 122.29(b); or
 - ii. The alteration or addition could significantly change the nature or increase the quantity of pollutants discharged. This notification applies to pollutants which are subject neither to effluent limitations in the permit, nor to notification requirements under 40 CFR 122.42;
 - iii. The alteration or addition results in a significant change in the permittee’s sludge use or disposal practices, and such alteration, addition, or change may justify the application of permit conditions that are different from or absent in the existing permit, including notification of additional use or disposal sites not reported during the permit application process or not reported pursuant to an approved land application plan;
 - iv. Any facility expansions, production increases, or process modifications which will result in a new or substantially different discharge or sludge characteristics must be reported to the Department 60 days before the facility or process modification begins. Notification may be accomplished by application for a new permit. If the discharge does not violate effluent limitations specified in the permit, the facility is to submit a notice to the Department of the changed discharge at least 30 days before such changes. The Department may require a construction permit and/or permit modification as a result of the proposed changes at the facility.
2. **Non-compliance Reporting.**
 - a. The permittee shall report any noncompliance which may endanger health or the environment. Relevant information shall be provided orally or via the current electronic method approved by the Department, within 24 hours from the time the permittee becomes aware of the circumstances, and shall be reported to the appropriate Regional Office during normal business hours or the Environmental Emergency Response hotline at 573-634-2436 outside of normal business hours. A written submission shall also be provided within five (5) business days of the time the permittee becomes aware of the circumstances. The written submission shall contain a description of the noncompliance and its cause; the period of noncompliance, including exact dates and times, and if the noncompliance has not been corrected, the anticipated time it is expected to continue; and steps taken or planned to reduce, eliminate, and prevent reoccurrence of the noncompliance.



STANDARD CONDITIONS FOR NPDES PERMITS
ISSUED BY
THE MISSOURI DEPARTMENT OF NATURAL RESOURCES
MISSOURI CLEAN WATER COMMISSION
REVISED
AUGUST 1, 2014

- b. The following shall be included as information which must be reported within 24 hours under this paragraph.
 - i. Any unanticipated bypass which exceeds any effluent limitation in the permit.
 - ii. Any upset which exceeds any effluent limitation in the permit.
 - iii. Violation of a maximum daily discharge limitation for any of the pollutants listed by the Department in the permit required to be reported within 24 hours.
 - c. The Department may waive the written report on a case-by-case basis for reports under paragraph 2. b. of this section if the oral report has been received within 24 hours.
3. **Anticipated Noncompliance.** The permittee shall give advance notice to the Department of any planned changes in the permitted facility or activity which may result in noncompliance with permit requirements. The notice shall be submitted to the Department 60 days prior to such changes or activity.
 4. **Compliance Schedules.** Reports of compliance or noncompliance with, or any progress reports on, interim and final requirements contained in any compliance schedule of the permit shall be submitted no later than 14 days following each schedule date. The report shall provide an explanation for the instance of noncompliance and a proposed schedule or anticipated date, for achieving compliance with the compliance schedule requirement.
 5. **Other Noncompliance.** The permittee shall report all instances of noncompliance not reported under paragraphs 2, 3, and 6 of this section, at the time monitoring reports are submitted. The reports shall contain the information listed in paragraph 2. a. of this section.
 6. **Other Information.** Where the permittee becomes aware that it failed to submit any relevant facts in a permit application, or submitted incorrect information in a permit application or in any report to the Department, it shall promptly submit such facts or information.
 7. **Discharge Monitoring Reports.**
 - a. Monitoring results shall be reported at the intervals specified in the permit.
 - b. Monitoring results must be reported to the Department via the current method approved by the Department, unless the permittee has been granted a waiver from using the method. If the permittee has been granted a waiver, the permittee must use forms provided by the Department.
 - c. Monitoring results shall be reported to the Department no later than the 28th day of the month following the end of the reporting period.
- b. Notice.
 - i. Anticipated bypass. If the permittee knows in advance of the need for a bypass, it shall submit prior notice, if possible at least 10 days before the date of the bypass.
 - ii. Unanticipated bypass. The permittee shall submit notice of an unanticipated bypass as required in Section B – Reporting Requirements, paragraph 5 (24-hour notice).
 - c. Prohibition of bypass.
 - i. Bypass is prohibited, and the Department may take enforcement action against a permittee for bypass, unless:
 1. Bypass was unavoidable to prevent loss of life, personal injury, or severe property damage;
 2. There were no feasible alternatives to the bypass, such as the use of auxiliary treatment facilities, retention of untreated wastes, or maintenance during normal periods of equipment downtime. This condition is not satisfied if adequate back-up equipment should have been installed in the exercise of reasonable engineering judgment to prevent a bypass which occurred during normal periods of equipment downtime or preventive maintenance; and
 3. The permittee submitted notices as required under paragraph 2. b. of this section.
 - ii. The Department may approve an anticipated bypass, after considering its adverse effects, if the Department determines that it will meet the three (3) conditions listed above in paragraph 2. c. i. of this section.
3. **Upset Requirements.**
 - a. Effect of an upset. An upset constitutes an affirmative defense to an action brought for noncompliance with such technology based permit effluent limitations if the requirements of paragraph 3. b. of this section are met. No determination made during administrative review of claims that noncompliance was caused by upset, and before an action for noncompliance, is final administrative action subject to judicial review.
 - b. Conditions necessary for a demonstration of upset. A permittee who wishes to establish the affirmative defense of upset shall demonstrate, through properly signed, contemporaneous operating logs, or other relevant evidence that:
 - i. An upset occurred and that the permittee can identify the cause(s) of the upset;
 - ii. The permitted facility was at the time being properly operated; and
 - iii. The permittee submitted notice of the upset as required in Section B – Reporting Requirements, paragraph 2. b. ii. (24-hour notice).
 - iv. The permittee complied with any remedial measures required under Section D – Administrative Requirements, paragraph 4.
 - c. Burden of proof. In any enforcement proceeding, the permittee seeking to establish the occurrence of an upset has the burden of proof.

Section C – Bypass/Upset Requirements

1. **Definitions.**
 - a. *Bypass*: the intentional diversion of waste streams from any portion of a treatment facility, except in the case of blending.
 - b. *Severe Property Damage*: substantial physical damage to property, damage to the treatment facilities which causes them to become inoperable, or substantial and permanent loss of natural resources which can reasonably be expected to occur in the absence of a bypass. Severe property damage does not mean economic loss caused by delays in production.
 - c. *Upset*: an exceptional incident in which there is unintentional and temporary noncompliance with technology based permit effluent limitations because of factors beyond the reasonable control of the permittee. An upset does not include noncompliance to the extent caused by operational error, improperly designed treatment facilities, inadequate treatment facilities, lack of preventive maintenance, or careless or improper operation.
2. **Bypass Requirements.**
 - a. Bypass not exceeding limitations. The permittee may allow any bypass to occur which does not cause effluent limitations to be exceeded, but only if it also is for essential maintenance to assure efficient operation. These bypasses are not subject to the provisions of paragraphs 2. b. and 2. c. of this section.

Section D – Administrative Requirements

1. **Duty to Comply.** The permittee must comply with all conditions of this permit. Any permit noncompliance constitutes a violation of the Missouri Clean Water Law and Federal Clean Water Act and is grounds for enforcement action; for permit termination, revocation and reissuance, or modification; or denial of a permit renewal application.
 - a. The permittee shall comply with effluent standards or prohibitions established under section 307(a) of the Federal Clean Water Act for toxic pollutants and with standards for sewage sludge use or disposal established under section 405(d) of the CWA within the time provided in the regulations that establish these standards or prohibitions or standards for sewage sludge use or disposal, even if the permit has not yet been modified to incorporate the requirement.
 - b. The Federal Clean Water Act provides that any person who violates section 301, 302, 306, 307, 308, 318 or 405 of the Act, or any permit condition or limitation implementing any such sections in a permit issued under section 402, or any requirement imposed in a pretreatment program approved under sections 402(a)(3) or 402(b)(8) of the Act, is subject to a civil penalty not to exceed \$25,000 per day for each violation. The Federal Clean Water Act provides that any person who negligently violates sections 301, 302, 306, 307, 308, 318, or 405 of the Act, or any condition or limitation implementing any of such sections in a permit issued under section 402 of the Act, or any requirement



STANDARD CONDITIONS FOR NPDES PERMITS
ISSUED BY
THE MISSOURI DEPARTMENT OF NATURAL RESOURCES
MISSOURI CLEAN WATER COMMISSION
REVISED
AUGUST 1, 2014

- imposed in a pretreatment program approved under section 402(a)(3) or 402(b)(8) of the Act, is subject to criminal penalties of \$2,500 to \$25,000 per day of violation, or imprisonment of not more than one (1) year, or both. In the case of a second or subsequent conviction for a negligent violation, a person shall be subject to criminal penalties of not more than \$50,000 per day of violation, or by imprisonment of not more than two (2) years, or both. Any person who knowingly violates such sections, or such conditions or limitations is subject to criminal penalties of \$5,000 to \$50,000 per day of violation, or imprisonment for not more than three (3) years, or both. In the case of a second or subsequent conviction for a knowing violation, a person shall be subject to criminal penalties of not more than \$100,000 per day of violation, or imprisonment of not more than six (6) years, or both. Any person who knowingly violates section 301, 302, 303, 306, 307, 308, 318 or 405 of the Act, or any permit condition or limitation implementing any of such sections in a permit issued under section 402 of the Act, and who knows at that time that he thereby places another person in imminent danger of death or serious bodily injury, shall, upon conviction, be subject to a fine of not more than \$250,000 or imprisonment of not more than 15 years, or both. In the case of a second or subsequent conviction for a knowing endangerment violation, a person shall be subject to a fine of not more than \$500,000 or by imprisonment of not more than 30 years, or both. An organization, as defined in section 309(c)(3)(B)(iii) of the CWA, shall, upon conviction of violating the imminent danger provision, be subject to a fine of not more than \$1,000,000 and can be fined up to \$2,000,000 for second or subsequent convictions.
- c. Any person may be assessed an administrative penalty by the EPA Director for violating section 301, 302, 306, 307, 308, 318 or 405 of this Act, or any permit condition or limitation implementing any of such sections in a permit issued under section 402 of this Act. Administrative penalties for Class I violations are not to exceed \$10,000 per violation, with the maximum amount of any Class I penalty assessed not to exceed \$25,000. Penalties for Class II violations are not to exceed \$10,000 per day for each day during which the violation continues, with the maximum amount of any Class II penalty not to exceed \$125,000.
- d. It is unlawful for any person to cause or permit any discharge of water contaminants from any water contaminant or point source located in Missouri in violation of sections 644.006 to 644.141 of the Missouri Clean Water Law, or any standard, rule or regulation promulgated by the commission. In the event the commission or the director determines that any provision of sections 644.006 to 644.141 of the Missouri Clean Water Law or standard, rules, limitations or regulations promulgated pursuant thereto, or permits issued by, or any final abatement order, other order, or determination made by the commission or the director, or any filing requirement pursuant to sections 644.006 to 644.141 of the Missouri Clean Water Law or any other provision which this state is required to enforce pursuant to any federal water pollution control act, is being, was, or is in imminent danger of being violated, the commission or director may cause to have instituted a civil action in any court of competent jurisdiction for the injunctive relief to prevent any such violation or further violation or for the assessment of a penalty not to exceed \$10,000 per day for each day, or part thereof, the violation occurred and continues to occur, or both, as the court deems proper. Any person who willfully or negligently commits any violation in this paragraph shall, upon conviction, be punished by a fine of not less than \$2,500 nor more than \$25,000 per day of violation, or by imprisonment for not more than one year, or both. Second and successive convictions for violation of the same provision of this paragraph by any person shall be punished by a fine of not more than \$50,000 per day of violation, or by imprisonment for not more than two (2) years, or both.
2. **Duty to Reapply.**
- a. If the permittee wishes to continue an activity regulated by this permit after the expiration date of this permit, the permittee must apply for and obtain a new permit.
- b. A permittee with a currently effective site-specific permit shall submit an application for renewal at least 180 days before the expiration date of the existing permit, unless permission for a later date has been granted by the Department. (The Department shall not grant permission for applications to be submitted later than the expiration date of the existing permit.)
- c. A permittee with currently effective general permit shall submit an application for renewal at least 30 days before the existing permit expires, unless the permittee has been notified by the Department that an earlier application must be made. The Department may grant permission for a later submission date. (The Department shall not grant permission for applications to be submitted later than the expiration date of the existing permit.)
3. **Need to Halt or Reduce Activity Not a Defense.** It shall not be a defense for a permittee in an enforcement action that it would have been necessary to halt or reduce the permitted activity in order to maintain compliance with the conditions of this permit.
4. **Duty to Mitigate.** The permittee shall take all reasonable steps to minimize or prevent any discharge or sludge use or disposal in violation of this permit which has a reasonable likelihood of adversely affecting human health or the environment.
5. **Proper Operation and Maintenance.** The permittee shall at all times properly operate and maintain all facilities and systems of treatment and control (and related appurtenances) which are installed or used by the permittee to achieve compliance with the conditions of this permit. Proper operation and maintenance also includes adequate laboratory controls and appropriate quality assurance procedures. This provision requires the operation of back-up or auxiliary facilities or similar systems which are installed by a permittee only when the operation is necessary to achieve compliance with the conditions of the permit.
6. **Permit Actions.**
- a. Subject to compliance with statutory requirements of the Law and Regulations and applicable Court Order, this permit may be modified, suspended, or revoked in whole or in part during its term for cause including, but not limited to, the following:
- i. Violations of any terms or conditions of this permit or the law;
- ii. Having obtained this permit by misrepresentation or failure to disclose fully any relevant facts;
- iii. A change in any circumstances or conditions that requires either a temporary or permanent reduction or elimination of the authorized discharge; or
- iv. Any reason set forth in the Law or Regulations.
- b. The filing of a request by the permittee for a permit modification, revocation and reissuance, or termination, or a notification of planned changes or anticipated noncompliance does not stay any permit condition.
7. **Permit Transfer.**
- a. Subject to 10 CSR 20-6.010, an operating permit may be transferred upon submission to the Department of an application to transfer signed by the existing owner and the new owner, unless prohibited by the terms of the permit. Until such time the permit is officially transferred, the original permittee remains responsible for complying with the terms and conditions of the existing permit.
- b. The Department may require modification or revocation and reissuance of the permit to change the name of the permittee and incorporate such other requirements as may be necessary under the Missouri Clean Water Law or the Federal Clean Water Act.
- c. The Department, within 30 days of receipt of the application, shall notify the new permittee of its intent to revoke or reissue or transfer the permit.
8. **Toxic Pollutants.** The permittee shall comply with effluent standards or prohibitions established under section 307(a) of the Federal Clean Water Act for toxic pollutants and with standards for sewage sludge use or disposal established under section 405(d) of the Federal Clean Water Act within the time provided in the regulations that establish these standards or prohibitions or standards for sewage sludge use or disposal, even if the permit has not yet been modified to incorporate the requirement.
9. **Property Rights.** This permit does not convey any property rights of any sort, or any exclusive privilege.



STANDARD CONDITIONS FOR NPDES PERMITS
ISSUED BY
THE MISSOURI DEPARTMENT OF NATURAL RESOURCES
MISSOURI CLEAN WATER COMMISSION
REVISED
AUGUST 1, 2014

10. **Duty to Provide Information.** The permittee shall furnish to the Department, within a reasonable time, any information which the Department may request to determine whether cause exists for modifying, revoking and reissuing, or terminating this permit or to determine compliance with this permit. The permittee shall also furnish to the Department upon request, copies of records required to be kept by this permit.
11. **Inspection and Entry.** The permittee shall allow the Department, or an authorized representative (including an authorized contractor acting as a representative of the Department), upon presentation of credentials and other documents as may be required by law, to:
 - a. Enter upon the permittee's premises where a regulated facility or activity is located or conducted, or where records must be kept under the conditions of the permit;
 - b. Have access to and copy, at reasonable times, any records that must be kept under the conditions of this permit;
 - c. Inspect at reasonable times any facilities, equipment (including monitoring and control equipment), practices, or operations regulated or required under this permit; and
 - d. Sample or monitor at reasonable times, for the purposes of assuring permit compliance or as otherwise authorized by the Federal Clean Water Act or Missouri Clean Water Law, any substances or parameters at any location.
12. **Closure of Treatment Facilities.**
 - a. Persons who cease operation or plan to cease operation of waste, wastewater, and sludge handling and treatment facilities shall close the facilities in accordance with a closure plan approved by the Department.
 - b. Operating Permits under 10 CSR 20-6.010 or under 10 CSR 20-6.015 are required until all waste, wastewater, and sludges have been disposed of in accordance with the closure plan approved by the Department and any disturbed areas have been properly stabilized. Disturbed areas will be considered stabilized when perennial vegetation, pavement, or structures using permanent materials cover all areas that have been disturbed. Vegetative cover, if used, shall be at least 70% plant density over 100% of the disturbed area.
13. **Signatory Requirement.**
 - a. All permit applications, reports required by the permit, or information requested by the Department shall be signed and certified. (See 40 CFR 122.22 and 10 CSR 20-6.010)
 - b. The Federal Clean Water Act provides that any person who knowingly makes any false statement, representation, or certification in any record or other document submitted or required to be maintained under this permit, including monitoring reports or reports of compliance or non-compliance shall, upon conviction, be punished by a fine of not more than \$10,000 per violation, or by imprisonment for not more than six (6) months per violation, or by both.
 - c. The Missouri Clean Water Law provides that any person who knowingly makes any false statement, representation or certification in any application, record, report, plan, or other document filed or required to be maintained pursuant to sections 644.006 to 644.141 shall, upon conviction, be punished by a fine of not more than ten thousand dollars, or by imprisonment for not more than six months, or by both.
14. **Severability.** The provisions of the permit are severable, and if any provision of the permit, or the application of any provision of the permit to any circumstance, is held invalid, the application of such provision to other circumstances, and the remainder of the permit, shall not be affected thereby.

STANDARD CONDITIONS FOR NPDES PERMITS
ISSUED BY
THE MISSOURI DEPARTMENT OF NATURAL RESOURCES
MISSOURI CLEAN WATER COMMISSION
August 1, 2019

PART III – BIOSOLIDS AND SLUDGE FROM DOMESTIC TREATMENT FACILITIES

SECTION A – GENERAL REQUIREMENTS

1. PART III Standard Conditions pertain to biosolids and sludge requirements under the Missouri Clean Water Law and regulations for domestic and municipal wastewater and also incorporates federal sludge disposal requirements under 40 CFR Part 503 for domestic wastewater. The Environmental Protection Agency (EPA) has principal authority for permitting and enforcement of the federal sludge regulations under 40 CFR Part 503 for domestic biosolids and sludge.
2. PART III Standard Conditions apply only to biosolids and sludge generated at domestic wastewater treatment facilities, including public owned treatment works (POTW) and privately owned facilities.
3. Biosolids and Sludge Use and Disposal Practices:
 - a. The permittee is authorized to operate the biosolids and sludge generating, treatment, storage, use, and disposal facilities listed in the facility description of this permit.
 - b. The permittee shall not exceed the design sludge/biosolids volume listed in the facility description and shall not use biosolids or sludge disposal methods that are not listed in the facility description, without prior approval of the permitting authority.
 - c. For facilities operating under general operating permits that incorporate Standard Conditions PART III, the facility is authorized to operate the biosolids and sludge generating, treatment, storage, use and disposal facilities identified in the original operating permit application, subsequent renewal applications or subsequent written approval by the department.
4. Biosolids or Sludge Received from other Facilities:
 - a. Permittees may accept domestic wastewater biosolids or sludge from other facilities as long as the permittee's design sludge capacity is not exceeded and the treatment facility performance is not impaired.
 - b. The permittee shall obtain a signed statement from the biosolids or sludge generator or hauler that certifies the type and source of the sludge
5. Nothing in this permit precludes the initiation of legal action under local laws, except to the extent local laws are preempted by state law.
6. This permit does not preclude the enforcement of other applicable environmental regulations such as odor emissions under the Missouri Air Pollution Control Law and regulations.
7. This permit may (after due process) be modified, or alternatively revoked and reissued, to comply with any applicable biosolids or sludge disposal standard or limitation issued or approved under Section 405(d) of the Clean Water Act or under Chapter 644 RSMo.
8. In addition to Standard Conditions PART III, the Department may include biosolids and sludge limitations in the special conditions portion or other sections of a site specific permit.
9. Exceptions to Standard Conditions PART III may be authorized on a case-by-case basis by the Department, as follows:
 - a. The Department may modify a site-specific permit following permit notice provisions as applicable under 10 CSR 20-6.020, 40 CFR § 124.10, and 40 CFR § 501.15(a)(2)(ix)(E).
 - b. Exceptions cannot be granted where prohibited by the federal sludge regulations under 40 CFR Part 503.

SECTION B – DEFINITIONS

1. Best Management Practices are practices to prevent or reduce the pollution of waters of the state and include agronomic loading rates (nitrogen based), soil conservation practices, spill prevention and maintenance procedures and other site restrictions.
2. Biosolids means organic fertilizer or soil amendment produced by the treatment of domestic wastewater sludge.
3. Biosolids land application facility is a facility where biosolids are spread onto the land at agronomic rates for production of food, feed or fiber. The facility includes any structures necessary to store the biosolids until soil, weather, and crop conditions are favorable for land application.
4. Class A biosolids means a material that has met the Class A pathogen reduction requirements or equivalent treatment by a Process to Further Reduce Pathogens (PFRP) in accordance with 40 CFR Part 503.
5. Class B biosolids means a material that has met the Class B pathogen reduction requirements or equivalent treatment by a Process to Significantly Reduce Pathogens (PSRP) in accordance with 40 CFR Part 503.
6. Domestic wastewater means wastewater originating from the sanitary conveniences of residences, commercial buildings, factories and institutions; or co-mingled sanitary and industrial wastewater processed by a (POTW) or a privately owned facility.
7. Feed crops are crops produced primarily for consumption by animals.
8. Fiber crops are crops such as flax and cotton.
9. Food crops are crops consumed by humans which include, but is not limited to, fruits, vegetables and tobacco.
10. Industrial wastewater means any wastewater, also known as process wastewater, not defined as domestic wastewater. Per 40 CFR Part 122.2, process wastewater means any water which, during manufacturing or processing, comes into direct contact with or results from the production or use of any raw material, intermediate product, finished product, byproduct, or waste product. Land application of industrial wastewater, residuals or sludge is not authorized by Standard Conditions PART III.
11. Mechanical treatment plants are wastewater treatment facilities that use mechanical devices to treat wastewater, including, sand filters, extended aeration, activated sludge, contact stabilization, trickling filters, rotating biological contact systems, and other similar facilities. It does not include wastewater treatment lagoons or constructed wetlands for wastewater treatment.
12. Plant Available Nitrogen (PAN) is nitrogen that will be available to plants during the growing seasons after biosolids application.
13. Public contact site is land with a high potential for contact by the public. This includes, but is not limited to, public parks, ball fields, cemeteries, plant nurseries, turf farms, and golf courses.
14. Sludge is the solid, semisolid, or liquid residue removed during the treatment of wastewater. Sludge includes septage removed from septic tanks or equivalent facilities. Sludge does not include carbon coal byproducts (CCBs), sewage sludge incinerator ash, or grit/screenings generated during preliminary treatment of domestic sewage.
15. Sludge lagoon is part of a mechanical wastewater treatment facility. A sludge lagoon is an earthen or concrete lined basin that receives sludge that has been removed from a wastewater treatment facility. It does not include a wastewater treatment lagoon or sludge treatment units that are not a part of a mechanical wastewater treatment facility.
16. Septage is the sludge pumped from residential septic tanks, cesspools, portable toilets, Type III marine sanitation devices, or similar treatment works such as sludge holding structures from residential wastewater treatment facilities with design populations of less than 150 people. Septage does not include grease removed from grease traps at a restaurant or material removed from septic tanks and other similar treatment works that have received industrial wastewater. The standard for biosolids from septage is different from other sludges. See Section H for more information.

SECTION C – MECHANICAL WASTEWATER TREATMENT FACILITIES

1. Biosolids or sludge shall be routinely removed from wastewater treatment facilities and handled according to the permit facility description and the requirements of Standard Conditions PART III or in accordance with Section A.3.c., above.
2. The permittee shall operate storage and treatment facilities, as defined by Section 644.016(23), RSMo, so that there is no biosolids or sludge discharged to waters of the state. Agricultural storm water discharges are exempt under the provisions of Section 644.059, RSMo.
3. Mechanical treatment plants shall have separate biosolids or sludge storage compartments in accordance with 10 CSR 20, Chapter 8. Failure to remove biosolids or sludge from these storage compartments on the required design schedule is a violation of this permit.

SECTION D – BIOSOLIDS OR SLUDGE DISPOSED AT OTHER TREATMENT FACILITY OR BY CONTRACT HAULER

1. Permittees that use contract haulers, under the authority of their operating permit, to dispose of biosolids or sludge, are responsible for compliance with all the terms of this permit. Contract haulers that assume the responsibility of the final disposal of biosolids or sludge, including biosolids land application, must obtain a Missouri State Operating Permit unless the hauler transports the biosolids or sludge to another permitted treatment facility.
2. Testing of biosolids or sludge, other than total solids content, is not required if biosolids or sludge are hauled to a permitted wastewater treatment facility, unless it is required by the accepting facility.

SECTION E – INCINERATION OF SLUDGE

1. Please be aware that sludge incineration facilities may be subject to the requirements of 40 CFR Part 503 Subpart E, Missouri Air Conservation Commission regulations under 10 CSR 10, and solid waste management regulations under 10 CSR 80, as applicable.
2. Permittee may be authorized under the facility description of this permit to store incineration ash in lagoons or ash ponds. This permit does not authorize the disposal of incineration ash. Incineration ash shall be disposed in accordance with 10 CSR 80; or, if the ash is determined to be hazardous, with 10 CSR 25.
3. In addition to normal sludge monitoring, incineration facilities shall report the following as part of the annual report, mass of sludge incinerated and mass of ash generated. Permittee shall also provide the name of the ash disposal facility and permit number if applicable.

SECTION F – SURFACE DISPOSAL SITES AND BIOSOLIDS AND SLUDGE LAGOONS

1. Please be aware that surface disposal sites of biosolids or sludge from wastewater treatment facilities may be subject to other laws including the requirements in 40 CFR Part 503 Subpart C, Missouri Air Conservation Commission regulations under 10 CSR 10, and solid waste management regulations under 10 CSR 80, as applicable.
2. Biosolids or sludge storage lagoons are temporary facilities and are not required to obtain a permit as a solid waste management facility under 10 CSR 80. In order to maintain biosolids or sludge storage lagoons as storage facilities, accumulated biosolids or sludge must be removed routinely, but not less than once every two years unless an alternate schedule is approved in the permit. The amount of biosolids or sludge removed will be dependent on biosolids or sludge generation and accumulation in the facility. Enough biosolids or sludge must be removed to maintain adequate storage capacity in the facility.
 - a. In order to avoid damage to the lagoon seal during cleaning, the permittee may leave a layer of biosolids or sludge on the bottom of the lagoon, upon prior approval of the Department; or
 - b. Permittee shall close the lagoon in accordance with Section I.

SECTION G – LAND APPLICATION OF BIOSOLIDS

1. The permittee shall not land apply biosolids unless land application is authorized in the facility description, the special conditions of the issued NPDES permit, or in accordance with Section A.3.c., above.
2. This permit only authorizes “Class A” or “Class B” biosolids derived from domestic wastewater to be land applied onto grass land, crop land, timber, or other similar agricultural or silviculture lands at rates suitable for beneficial use as organic fertilizer and soil conditioner.
3. Class A Biosolids Requirements: Biosolids shall meet Class A requirements for application to public contact sites, residential lawns, home gardens or sold and/or given away in a bag or other container.
4. Class B biosolids that are land applied to agricultural and public contact sites shall comply with the following restrictions:
 - a. Food crops that touch the biosolids/soil mixture and are totally above the land surface shall not be harvested for 14 months after application of biosolids.
 - b. Food crops below the surface of the land shall not be harvested for 20 months after application of biosolids when the biosolids remain on the land surface for four months or longer prior to incorporation into the soil.
 - c. Food crops below the surface of the land shall not be harvested for 38 months after application of biosolids when the biosolids remain on the land surface for less than four months prior to incorporation into the soil.
 - d. Animal grazing shall not be allowed for 30 days after application of biosolids.
 - e. Food crops, feed crops, and fiber crops shall not be harvested for 30 days after application of biosolids.
 - f. Turf shall not be harvested for one year after application of biosolids if used for lawns or high public contact sites in close proximity to populated areas such as city parks or golf courses.
 - g. After Class B biosolids have been land applied to public contact sites with high potential for public exposure, as defined in 40 CFR § 503.31, such as city parks or golf courses, access must be restricted for 12 months.
 - h. After Class B biosolids have been land applied public contact sites with low potential for public exposure as defined in 40 CFR § 503.31, such as a rural land application or reclamation sites, access must be restricted for 30 days.
5. Pollutant limits
 - a. Biosolids shall be monitored to determine the quality for regulated pollutants listed in Table 1, below. Limits for any pollutants not listed below may be established in the permit.
 - b. The number of samples taken is directly related to the amount of biosolids or sludge produced by the facility (See Section J, below). Samples should be taken only during land application periods. When necessary, it is permissible to mix biosolids with lower concentrations of biosolids as well as other suitable Department approved material to achieve pollutant concentration below those identified in Table 1, below.
 - c. Table 1 gives the ceiling concentration for biosolids. Biosolids which exceed the concentrations in Table 1 may not be land applied.

TABLE 1

Biosolids ceiling concentration	
Pollutant	Milligrams per kilogram dry weight
Arsenic	75
Cadmium	85
Copper	4,300
Lead	840
Mercury	57
Molybdenum	75
Nickel	420
Selenium	100
Zinc	7,500

- d. Table 2 below gives the low metal concentration for biosolids. Because of its higher quality, biosolids with pollutant concentrations below those listed in Table 2 can safely be applied to agricultural land, forest, public contact sites, lawns, home gardens or be given away without further analysis. Biosolids containing metals in concentrations above the low metals concentrations but below the ceiling concentration limits may be land applied but shall not exceed the annual loading rates in Table 3 and the cumulative loading rates in Table 4. The permittee is required to track pollutant loading onto application sites for parameters that have exceeded the low metal concentration limits.

TABLE 2

Biosolids Low Metal Concentration	
Pollutant	Milligrams per kilogram dry weight
Arsenic	41
Cadmium	39
Copper	1,500
Lead	300
Mercury	17
Nickel	420
Selenium	100
Zinc	2,800

- e. Annual pollutant loading rate.

Table 3

Biosolids Annual Loading Rate	
Pollutant	Kg/ha (lbs./ac) per year
Arsenic	2.0 (1.79)
Cadmium	1.9 (1.70)
Copper	75 (66.94)
Lead	15 (13.39)
Mercury	0.85 (0.76)
Nickel	21 (18.74)
Selenium	5.0 (4.46)
Zinc	140 (124.96)

- f. Cumulative pollutant loading rates.

Table 4

Biosolids Cumulative Pollutant Loading Rate	
Pollutant	Kg/ha (lbs./ac)
Arsenic	41 (37)
Cadmium	39 (35)
Copper	1500 (1339)
Lead	300 (268)
Mercury	17 (15)
Nickel	420 (375)
Selenium	100 (89)
Zinc	2800 (2499)

6. Best Management Practices. The permittee shall use the following best management practices during land application activities to prevent the discharge of biosolids to waters of the state.
- Biosolids shall not be applied to the land if it is likely to adversely affect a threatened or endangered species listed under § 4 of the Endangered Species Act or its designated critical habitat.
 - Apply biosolids only at the agronomic rate of nitrogen needed (see 5.c. of this section).
 - The applicator must document the Plant Available Nitrogen (PAN) loadings, available nitrogen in the soil, and crop

nitrogen removal when either of the following occurs: 1) When biosolids are greater than 50,000 mg/kgTN; or 2) When biosolids are land applied at an application rate greater than two dry tons per acre per year.

- i. PAN can be determined as follows:
(Nitrate + nitrite nitrogen) + (organic nitrogen x 0.2) + (ammonia nitrogen x volatilization factor¹).
¹ Volatilization factor is 0.7 for surface application and 1 for subsurface application. Alternative volatilization factors and mineralization rates can be utilized on a case-by-case basis.
- ii. Crop nutrient production/removal to be based on crop specific nitrogen needs and realistic yield goals. **NOTE:** There are a number of reference documents on the Missouri Department of Natural Resources website that are informative to implement best management practices in the proper management of biosolids, including crop specific nitrogen needs, realistic yields on a county by county basis and other supporting references.
- iii. Biosolids that are applied at agronomic rates shall not cause the annual pollutant loading rates identified in Table 3 to be exceeded.
- d. Buffer zones are as follows:
 - i. 300 feet of a water supply well, sinkhole, water supply reservoir or water supply intake in a stream;
 - ii. 300 feet of a losing stream, no discharge stream, stream stretches designated for whole body contact recreation, wild and scenic rivers, Ozark National Scenic Riverways or outstanding state resource waters as listed in the Water Quality Standards, 10 CSR 20-7.031;
 - iii. 150 feet of dwellings or public use areas;
 - iv. 100 feet (35 feet if biosolids application is down-gradient or the buffer zone is entirely vegetated) of lake, pond, wetlands or gaining streams (perennial or intermittent);
 - v. 50 feet of a property line. Buffer distances from property lines may be waived with written permission from neighboring property owner.
 - vi. For the application of dry, cake or liquid biosolids that are subsurface injected, buffer zones identified in 5.d.i. through 5.d.iii above, may be reduced to 100 feet. The buffer zone may be reduced to 35 feet if the buffer zone is permanently vegetated. Subsurface injection does not include methods or technology reflective of combination surface/shallow soil incorporation.
- e. Slope limitation for application sites are as follows:
 - i. For slopes less than or equal to 6 percent, no rate limitation;
 - ii. Applied to a slope 7 to 12 percent, the applicator may apply biosolids when soil conservation practices are used to meet the minimum erosion levels;
 - iii. Slopes > 12 percent, apply biosolids only when grass is vegetated and maintained with at least 80 percent ground cover at a rate of two dry tons per acre per year or less.
 - iv. Dry, cake or liquid biosolids that are subsurface injected, may be applied on slopes not to exceed 20 percent. Subsurface injection does not include the use of methods or technology reflective of combination surface/shallow soil incorporation.
- f. No biosolids may be land applied in an area that it is reasonably certain that pollutants will be transported into waters of the state.
- g. Biosolids may be land applied to sites with soil that are snow covered, frozen, or saturated with liquid when site restrictions or other controls are provided to prevent pollutants from being discharged to waters of the state during snowmelt or stormwater runoff. During inclement weather or unfavorable soil conditions use the following management practices:
 - i. A maximum field slope of 6% and a minimum 300 feet grass buffer between the application site and waters of the state. A 35 feet grass buffer may be utilized for the application of dry, cake or liquid biosolids that are subsurface injected. Subsurface injection does not include the use of methods or technology reflective of combination surface/shallow soil incorporation;
 - ii. A maximum field slope of 2% and 100 feet grass buffer between the application site and waters of the state. A 35 feet grass buffer may be used for the application of dry, cake or liquid biosolids that are subsurface injected. Subsurface injection does not include the use of methods or technology reflective of combination surface/shallow soil incorporation;
 - iii. Other best management practices approved by the Department.

SECTION H – SEPTAGE

1. Haulers that land apply septage must obtain a state permit. An operating permit is not required for septage haulers who transport septage to another permitted treatment facility for disposal.
2. Do not apply more than 30,000 gallons of septage per acre per year or the volume otherwise stipulated in the operating permit.
3. Septic tanks are designed to retain sludge for one to three years which will allow for a larger reduction in pathogens and vectors, as compared to mechanical treatment facilities.
4. Septage must comply with Class B biosolids regarding pathogen and vector attraction reduction requirements before it may be applied to crops, pastures or timberland. To meet required pathogen and vector reduction requirements, mix 50 pounds of hydrated lime for every 1,000 gallons of septage and maintain a septage pH of at least 12 pH standard units for 30 minutes or more prior to application.
5. Lime is to be added to the pump truck and not directly to the septic tanks, as lime would harm the beneficial bacteria of the septic tank.
6. As residential septage contains relatively low levels of metals, the testing of metals in septage is not required.

SECTION I– CLOSURE REQUIREMENTS

1. This section applies to all wastewater facilities (mechanical and lagoons) and sludge or biosolids storage and treatment facilities. It does not apply to land application sites.
2. Permittees of a domestic wastewater facility who plan to cease operation must obtain Department approval of a closure plan which addresses proper removal and disposal of all sludges and/or biosolids. Permittee must maintain this permit until the facility is closed in accordance with the approved closure plan per 10 CSR 20 – 6.010 and 10 CSR 20 – 6.015.
3. Biosolids or sludge that are left in place during closure of a lagoon or earthen structure or ash pond shall not exceed the agricultural loading rates as follows:
 - a. Biosolids and sludge shall meet the monitoring and land application limits for agricultural rates as referenced in Section G, above.
 - b. If a wastewater treatment lagoon has been in operation for 15 years or more without sludge removal, the sludge in the lagoon qualifies as a Class B biosolids with respect to pathogens due to anaerobic digestion, and testing for fecal coliform is not required. For other lagoons, testing for fecal coliform is required to show compliance with Class B biosolids limitations. In order to reach Class B biosolids requirements, fecal coliform must be less than 2,000,000 colony forming units or 2,000,000 most probable number. All fecal samples must be presented as geometric mean per gram.
 - c. The allowable nitrogen loading that may be left in the lagoon shall be based on the plant available nitrogen (PAN) loading. For a grass cover crop, the allowable PAN is 300 pounds/acre. Alternative, site-specific application rates may be included in the closure plan for department consideration.
 - i. PAN can be determined as follows:
$$(\text{Nitrate} + \text{nitrite nitrogen}) + (\text{organic nitrogen} \times 0.2) + (\text{ammonia nitrogen} \times \text{volatilization factor}^1).$$
¹ Volatilization factor is 0.7 for surface application and 1 for subsurface application. Alternative volatilization factors and mineralization rates can be utilized on a case-by-case basis.
4. Domestic wastewater treatment lagoons with a design treatment capacity less than or equal to 150 persons, are “similar treatment works” under the definition of septage. Therefore the sludge within the lagoons may be treated as septage during closure activities. See Section B, above. Under the septage category, residuals may be left in place as follows:
 - a. Testing for metals or fecal coliform is not required.
 - b. If the wastewater treatment lagoon has been in use for less than 15 years, mix lime with the sludge at a rate of 50 pounds of hydrated lime per 1000 gallons (134 cubic feet) of sludge.
 - c. The amount of sludge that may be left in the lagoon shall be based on the plant available nitrogen (PAN) loading. 100 dry tons/acre of sludge may be left in the basin without testing for nitrogen. If 100 dry tons/acre or more will be left in the lagoon, test for nitrogen and determine the PAN using the calculation above. Allowable PAN loading is 300 pounds/acre.
5. Biosolids or sludge left within the domestic lagoon shall be mixed with soil on at least a 1 to 1 ratio, and unless otherwise approved, the lagoon berm shall be demolished, and the site shall be graded and contain $\geq 70\%$ vegetative density over 100% of the site so as to avoid ponding of storm water and provide adequate surface water drainage without creating erosion. Alternative biosolids or sludge and soil mixing ratios may be included in the closure plan for department consideration.
6. Lagoon and earthen structure closure activities shall obtain a storm water permit for land disturbance activities that equal or exceed one acre in accordance with 10 CSR 20-6.200.
7. When closing a mechanical wastewater plant, all biosolids or sludge must be cleaned out and disposed of in accordance with the Department approved closure plan before the permit for the facility can be terminated.
 - a. Land must be stabilized which includes any grading, alternate use or fate upon approval by the Department, remediation, or other work that exposes sediment to stormwater per 10 CSR 20-6.200. The site shall be graded and contain $\geq 70\%$ vegetative density over 100% of the site, so as to avoid ponding of storm water and provide adequate

- surface water drainage without creating erosion.
- b. Hazardous Waste shall not be land applied or disposed during mechanical plant closures unless in accordance with Missouri Hazardous Waste Management Law and Regulations pursuant to 10 CSR 25.
 - c. After demolition of the mechanical plant, the site must only contain clean fill defined in Section 260.200.1(6) RSMo as uncontaminated soil, rock, sand, gravel, concrete, asphaltic concrete, cinderblocks, brick, minimal amounts of wood and metal, and inert solids as approved by rule or policy of the Department for fill, reclamation, or other beneficial use. Other solid wastes must be removed.
8. If biosolids or sludge from the domestic lagoon or mechanical treatment plant exceeds agricultural rates under Section G and/or I, a landfill permit or solid waste disposal permit must be obtained if the permittee chooses to seek authorization for on-site sludge disposal under the Missouri Solid Waste Management Law and regulations per 10 CSR 80, and the permittee must comply with the surface disposal requirements under 40 CFR Part 503, Subpart C.

SECTION J – MONITORING FREQUENCY

1. At a minimum, biosolids or sludge shall be tested for volume and percent total solids on a frequency that will accurately represent sludge quantities produced and disposed. Please see the table below.

TABLE 5

Biosolids or Sludge produced and disposed (Dry Tons per Year)	Monitoring Frequency (See Notes 1, and 2)		
	Metals, Pathogens and Vectors, Total Phosphorus, Total Potassium	Nitrogen TKN, Nitrogen PAN ¹	Priority Pollutants ²
319 or less	1/year	1 per month	1/year
320 to 1650	4/year	1 per month	1/year
1651 to 16,500	6/year	1 per month	1/year
16,501+	12/year	1 per month	1/year

¹ Calculate plant available nitrogen (PAN) when either of the following occurs: 1) when biosolids are greater than 50,000 mg/kg TN; or 2) when biosolids are land applied at an application rate greater than two dry tons per acre per year.

² Priority pollutants (40 CFR 122.21, Appendix D, Tables II and III) are required only for permit holders that must have a pre-treatment program. Monitoring requirements may be modified and incorporated into the operating permit by the Department on a case-by-case basis.

Note 1: Total solids: A grab sample of sludge shall be tested one per day during land application periods for percent total solids. This data shall be used to calculate the dry tons of sludge applied per acre.

Note 2: Table 5 is not applicable for incineration and permit holders that landfill their sludge.

2. Permittees that operate wastewater treatment lagoons, peak flow equalization basins, combined sewer overflow basins or biosolids or sludge lagoons that are cleaned out once a year or less, may choose to sample only when the biosolids or sludge is removed or the lagoon is closed. Test one composite sample for each 319 dry tons of biosolids or sludge removed from the lagoon during the reporting year or during lagoon closure. Composite sample must represent various areas at one-foot depth.
3. Additional testing may be required in the special conditions or other sections of the permit.
4. Biosolids and sludge monitoring shall be conducted in accordance with federal regulation 40 CFR § 503.8, Sampling and analysis.

SECTION K – RECORD KEEPING AND REPORTING REQUIREMENTS

1. The permittee shall maintain records on file at the facility for at least five years for the items listed in Standard Conditions PART III and any additional items in the Special Conditions section of this permit. This shall include dates when the biosolids or sludge facility is checked for proper operation, records of maintenance and repairs and other relevant information.
2. Reporting period
 - a. By February 19th of each year, applicable facilities shall submit an annual report for the previous calendar year period for all mechanical wastewater treatment facilities, sludge lagoons, and biosolids or sludge disposal facilities.
 - b. Permittees with wastewater treatment lagoons shall submit the above annual report only when biosolids or sludge are removed from the lagoon during the report period or when the lagoon is closed.
3. Report Form. The annual report shall be prepared on report forms provided by the Department or equivalent forms approved by the Department.
4. Reports shall be submitted as follows:
Major facilities, which are those serving 10,000 persons or more or with a design flow equal to or greater than 1 million gallons per day or that are required to have an approved pretreatment program, shall report to both the Department and EPA if the facility land applied, disposed of biosolids by surface disposal, or operated a sewage sludge incinerator. All other facilities shall maintain their biosolids or sludge records and keep them available to Department personnel upon request. State reports shall be submitted to the address listed as follows:

DNR regional or other applicable office listed in the
permit (see cover letter of permit)
ATTN: Sludge Coordinator

Reports to EPA must be electronically submitted online via the Central Data Exchange at: <https://cdx.epa.gov/> Additional information is available at: <https://www.epa.gov/biosolids/compliance-and-annual-reporting-guidance-about-clean-water-act-laws>

5. Annual report contents. The annual report shall include the following:
 - a. Biosolids and sludge testing performed. If testing was conducted at a greater frequency than what is required by the permit, all test results must be included in the report.
 - b. Biosolids or sludge quantity shall be reported as dry tons for the quantity produced and/or disposed.
 - c. Gallons and % solids data used to calculate the dry ton amounts.
 - d. Description of any unusual operating conditions.
 - e. Final disposal method, dates, and location, and person responsible for hauling and disposal.
 - i. This must include the name and address for the hauler and sludge facility. If hauled to a municipal wastewater treatment facility, sanitary landfill, or other approved treatment facility, give the name of that facility.
 - ii. Include a description of the type of hauling equipment used and the capacity in tons, gallons, or cubic feet.
 - f. Contract Hauler Activities:

If using a contract hauler, provide a copy of a signed contract from the contractor. Permittee shall require the contractor to supply information required under this permit for which the contractor is responsible. The permittee shall submit a signed statement from the contractor that he has complied with the standards contained in this permit, unless the contract hauler has a separate biosolids or sludge use permit.
 - g. Land Application Sites:
 - i. Report the location of each application site, the annual and cumulative dry tons/acre for each site, and the landowners name and address. The location for each spreading site shall be given as a legal description for nearest ¼, ¼, Section, Township, Range, and county, or UTM coordinates. The facility shall report PAN when either of the following occurs: 1) When biosolids are greater than 50,000 mg/kg TN; or 2) when biosolids are land applied at an application rate greater than two dry tons per acre per year.
 - ii. If the “Low Metals” criteria are exceeded, report the annual and cumulative pollutant loading rates in pounds per acre for each applicable pollutant, and report the percent of cumulative pollutant loading which has been reached at each site.
 - iii. Report the method used for compliance with pathogen and vector attraction requirements.
 - iv. Report soil test results for pH and phosphorus. If no soil was tested during the year, report the last date when tested and the results.

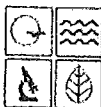

MISSOURI DEPARTMENT OF NATURAL RESOURCES
WATER PROTECTION PROGRAM

**FORM B: APPLICATION FOR OPERATING PERMIT FOR
FACILITIES THAT RECEIVE PRIMARILY DOMESTIC WASTE AND
HAVE A DESIGN FLOW LESS THAN OR EQUAL TO 100,000
GALLONS PER DAY**

34416
FOR AGENCY USE ONLY

CHECK NUMBER

DATE RECEIVED

FEE SUBMITTED

JETPAY CONFIRMATION NUMBER

READ THE ACCOMPANYING INSTRUCTIONS BEFORE COMPLETING THIS FORM

1. THIS APPLICATION IS FOR:

- ☐ An operating permit for a new or unpermitted facility. Construction Permit # _____
(Include completed antidegradation review or request for antidegradation review, see instructions)
- ☐ A new site-specific operating permit formerly general permit #MOG _____
- ☒ A site-specific operating permit renewal: Permit #MO- 0116459 Expiration Date SEPT. 30, 2020
- ☐ A site-specific operating permit modification: Permit #MO- _____ Reason: _____
- ☐ General permit (NON-POTWs) (MOGD -discharging < 50,000 GPD or MOG823 - Land Application of Domestic Wastewater):
Permit #MO- _____ Expiration Date _____

1.1 Is the appropriate fee included with the application (see instructions for appropriate fee)? ☒ YES ☐ NO

2. FACILITY

NAME GATEWAY REFRIGERATED WAREHOUSES WWTP TELEPHONE NUMBER WITH AREA CODE _____
ADDRESS (PHYSICAL) 18249 QUARRY ROAD CITY WARRENTON STATE MO ZIP CODE 63383
2.1 Legal description: Sec. 15, T46N, R2W County WARREN

2.2 UTM Coordinates Easting (X): 663957 Northing (Y): 4290563
For Universal Transverse Mercator (UTM), Zone 15 North referenced to North American Datum 1983 (NAD83)

2.3 Name of receiving stream: TRIBUTARY TO OWL CREEK

2.4 Number of outfalls: 2 Wastewater outfalls: _____ Stormwater outfalls: _____ Instream monitoring sites: _____

3. OWNER: The owner of the regulated activity/discharge being applied for and is not necessarily the owner of the real property on which the activity or discharge is occurring.

NAME GATEWAY REFRIGERATED WAREHOUSES, LLC EMAIL ADDRESS _____ TELEPHONE NUMBER WITH AREA CODE _____
ADDRESS 11500 OLIVE ST., STE 276 CITY CREVE COEUR STATE MO ZIP CODE 63141

3.1 Request review of draft permit prior to public notice? ☒ YES ☐ NO

3.2 Are you a publicly owned treatment works? ☐ YES ☒ NO
If yes, please attach the Financial Questionnaire. See: <https://dnr.mo.gov/forms/780-2511-f.pdf>

3.3 Are you a privately owned treatment works? ☒ YES ☐ NO

3.4 Are you a privately owned treatment facility regulated by the Public Service Commission? ☐ YES ☒ NO

4. CONTINUING AUTHORITY: Permanent organization that will serve as the continuing authority for the operation, maintenance and modernization of the facility.

NAME SAME AS ABOVE EMAIL ADDRESS _____ TELEPHONE NUMBER WITH AREA CODE _____
ADDRESS _____ CITY _____ STATE _____ ZIP CODE _____

If the continuing authority is different than the owner, include a copy of the contract agreement between the two parties and a description of the responsibilities of both parties within the agreement.

5. OPERATOR

NAME DAVE AXTON TITLE OPERATOR CERTIFICATE NUMBER 4133
EMAIL ADDRESS officesupport@labsheet.com TELEPHONE NUMBER WITH AREA CODE 636-257-3976

6. FACILITY CONTACT

NAME KEITH VANHOCSER TITLE GENERAL MANAGER
EMAIL ADDRESS kvannhocser@trilogy3pl.com TELEPHONE NUMBER WITH AREA CODE 636-456-7499 xt. 123
ADDRESS 104 N. MAIN ST. CITY ST. CHARLES STATE MO ZIP CODE 63301

MO 780-1512 (02-19)

RECEIVED

FEB 10 2020

Water Protection Program

7. DESCRIPTION OF FACILITY

7.1 Process Flow Diagram or Schematic: Provide a diagram showing the processes of the treatment plant. Show all of the treatment units, including disinfection (e.g. - chlorination and dechlorination), influents, and outfalls. Specify where samples are taken. Indicate any treatment process changes in the routing of wastewater during dry weather and peak wet weather. Include a brief narrative description of the diagram.

Attach sheets as necessary.

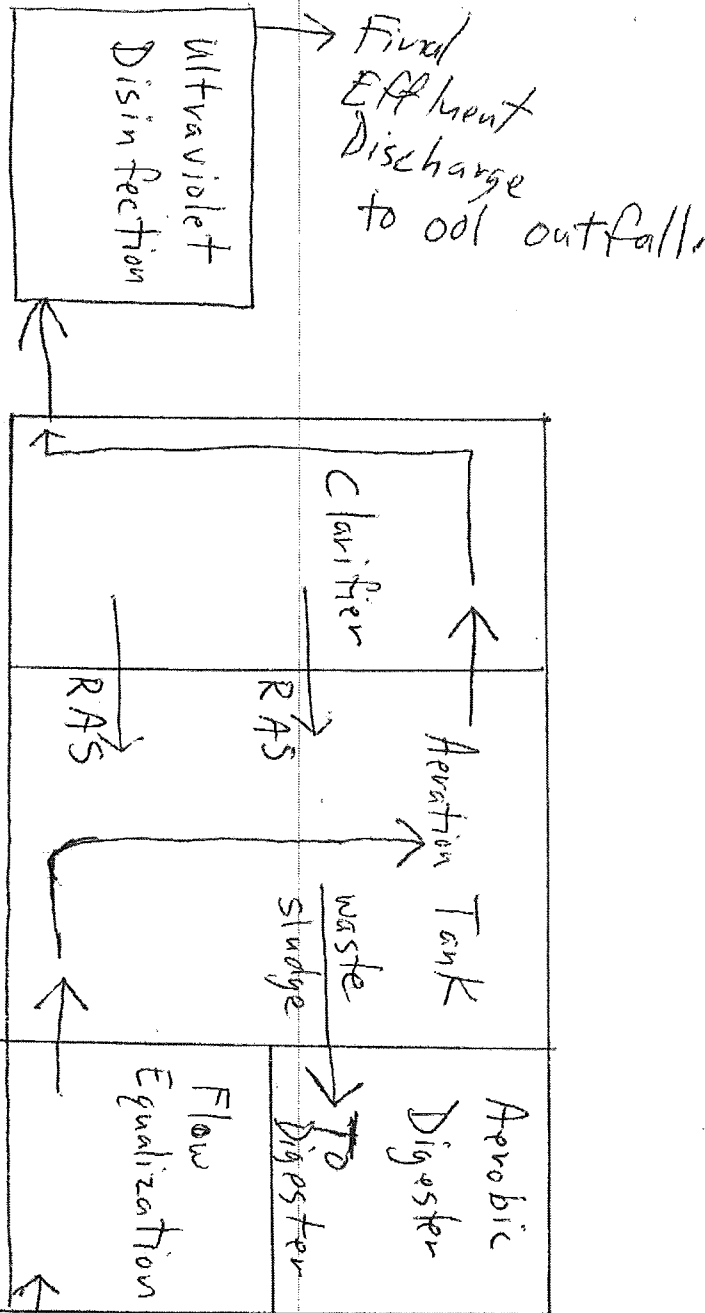

The raw flow enters the flow equalization tank where the flow is pumped to the aeration tank where the flow then flows to the clarifier. The RAS is returned to the aeration tank where the excess sludge is pumped to the digester. The clarifier effluent flow then UV system where the flow is then discharged to the final outfall.

Raw Influent Flow

7.2 Attach an aerial photograph or USGS topographic map showing the location of the facility and outfall.

Please see the following website:

<https://modnr.maps.arcgis.com/apps/webappviewer/index.html?id=1d81212e0854478ca0dae87c33c8c5ce>

• PLEASE SEE ATTACHED

18249 Quarry Rd



Imagery ©2020 Maxar Technologies, USDA Farm Service Agency, Map data ©2020 200 ft

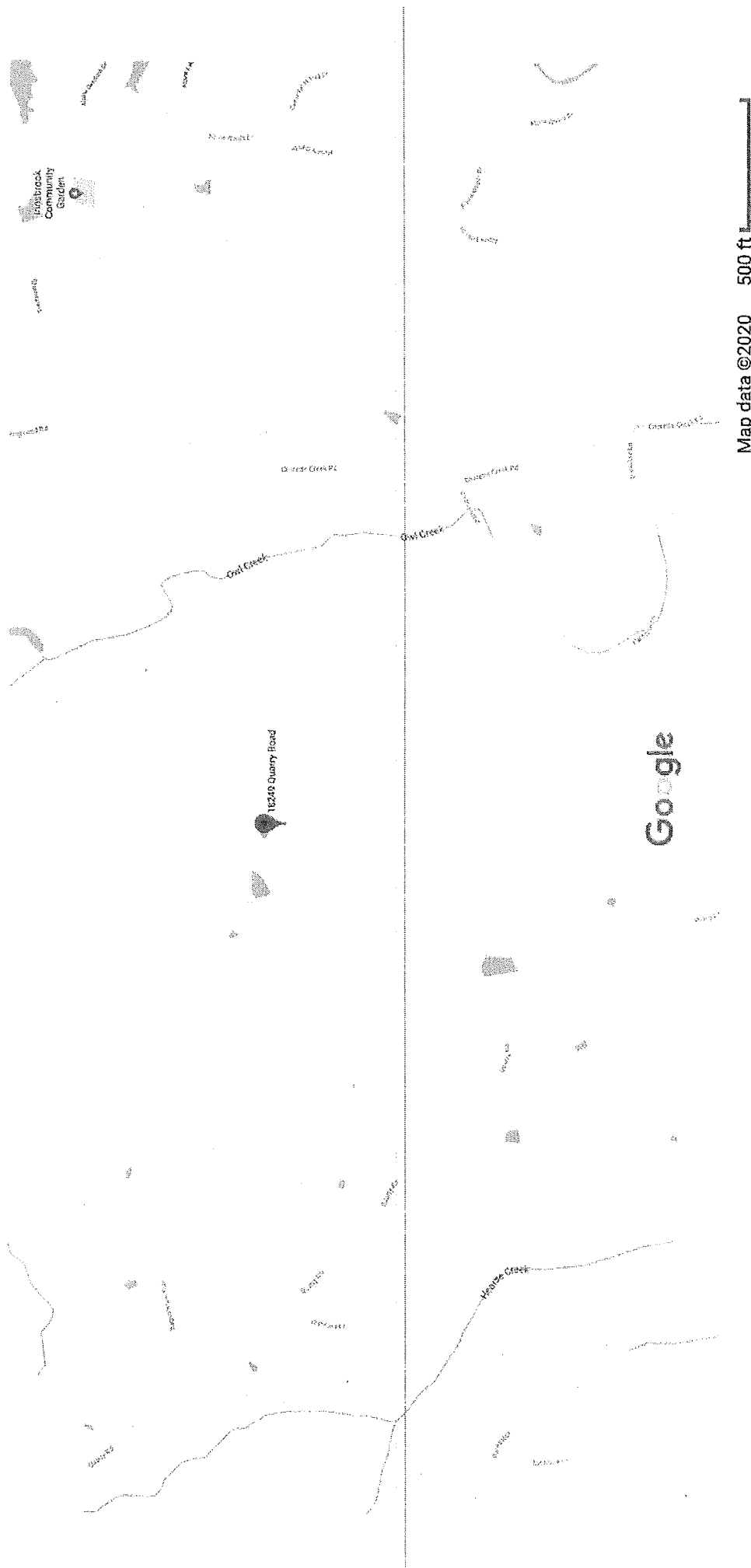

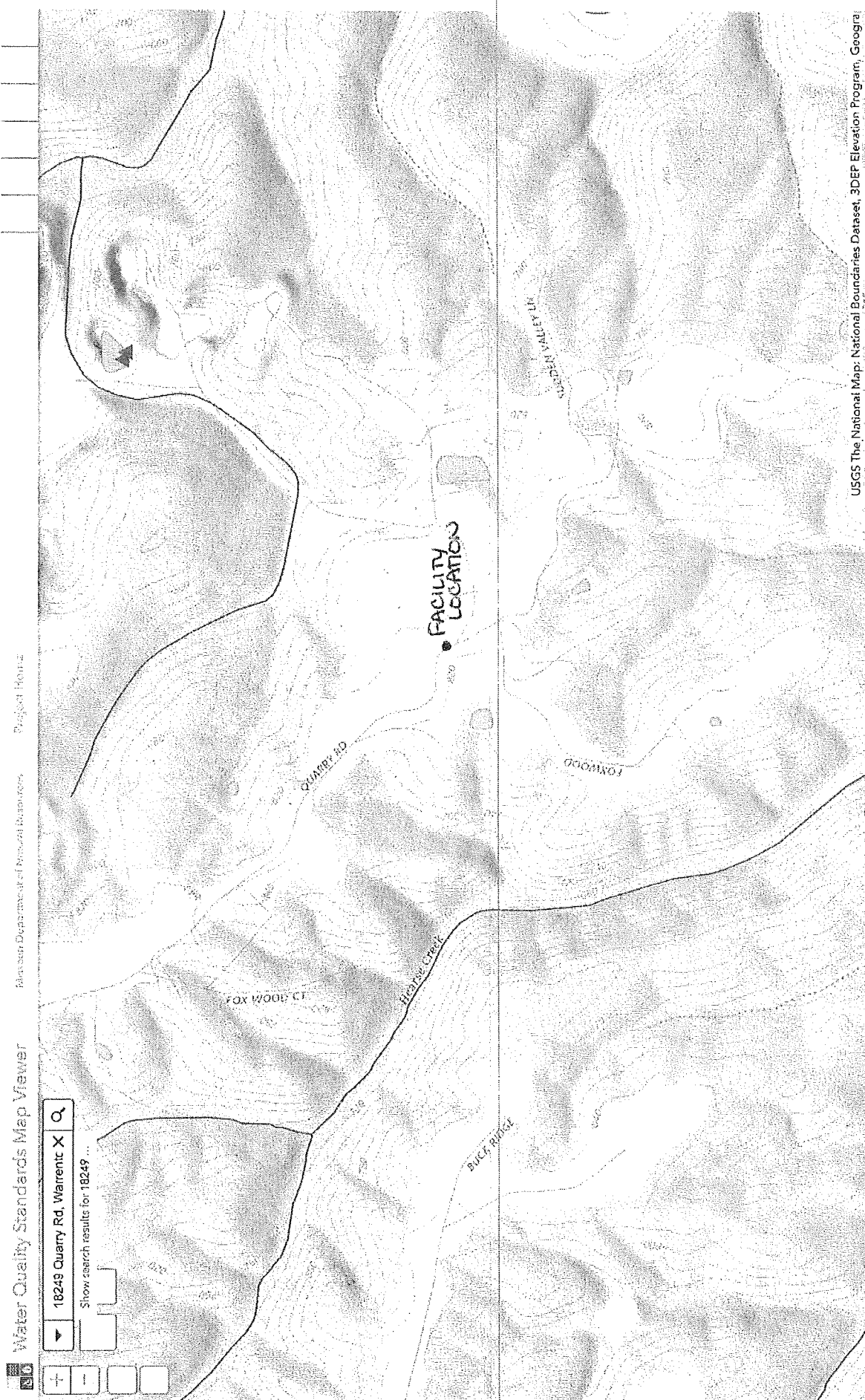

USGS The National Map: National Boundaries Dataset, 3DEP Elevation Program, Geogra

8. ADDITIONAL FACILITY INFORMATION		
8.1 Facility SIC code: <u>4222</u>	Discharge SIC code: _____	
8.2 Number of people presently connected or population equivalent (P.E.)	Design P.E. <u>32</u>	
8.3 Connections to the facility: Number of units presently connected: Residential: _____ Commercial: <u>1</u> Industrial: _____		
8.4 Design flow: <u>3,200</u>	Actual flow: <u>2,400</u>	
8.5 Will discharge be continuous through the year? <input checked="" type="checkbox"/> Yes <input type="checkbox"/> No Discharge will occur during the following months: <u>JAN - DEC.</u> How many days of the week will discharge occur? <u>7</u>		
8.6 Is industrial wastewater discharged to the facility? <input type="checkbox"/> Yes <input checked="" type="checkbox"/> No If yes, attach a list of the industries that discharge to your facility		
8.7 Does the facility accept or process leachate from landfills? <input type="checkbox"/> Yes <input checked="" type="checkbox"/> No		
8.8 Is wastewater land applied? <input type="checkbox"/> Yes <input checked="" type="checkbox"/> No If yes, attach Form I. See: https://dnr.mo.gov/forms/780-1686-f.pdf		
8.9 Does the facility discharge to a losing stream or sinkhole? <input type="checkbox"/> Yes <input checked="" type="checkbox"/> No		
8.10 Has a wasteload allocation study been completed for this facility? <input type="checkbox"/> Yes <input checked="" type="checkbox"/> No		
9. LABORATORY CONTROL INFORMATION		
LABORATORY WORK CONDUCTED BY PLANT PERSONNEL		
Lab work conducted outside of plant. <input checked="" type="checkbox"/> Yes <input type="checkbox"/> No		
Push-button or visual methods for simple test such as pH, settleable solids. <input checked="" type="checkbox"/> Yes <input type="checkbox"/> No		
Additional procedures such as dissolved oxygen, chemical oxygen demand, biological oxygen demand, titrations, solids, volatile content. <input checked="" type="checkbox"/> Yes <input type="checkbox"/> No		
More advanced determinations such as BOD seeding procedures, fecal coliform/E. coli, nutrients (including Ammonia), Oil & Grease, total oils, phenols, etc. <input checked="" type="checkbox"/> Yes <input type="checkbox"/> No		
Highly sophisticated instrumentation, such as atomic absorption and gas chromatograph. <input type="checkbox"/> Yes <input checked="" type="checkbox"/> No		
10. COLLECTION SYSTEM		
10.1 Are there any municipal satellite collection systems connected to this facility? <input type="checkbox"/> Yes <input checked="" type="checkbox"/> No If yes, please list all connected to this facility, contact phone number and length of each collection system		
FACILITY NAME	CONTACT PHONE NUMBER	LENGTH OF SYSTEM (FEET OR MILES)
10.2 Length of pipe in the sewer collection system? (If available, include totals from satellite collection systems) <u>500</u> Feet, or _____ Miles (either unit is appropriate)		
10.3 Does significant infiltration occur in the collection system? <input type="checkbox"/> Yes <input checked="" type="checkbox"/> No If yes, briefly explain any steps underway or planned to minimize inflow and infiltration:		

11. BYPASSING				
Does any bypassing occur in the collection system or at the treatment facility? <input type="checkbox"/> Yes <input checked="" type="checkbox"/> No				
If yes, explain:				
12. SLUDGE HANDLING, USE AND DISPOSAL				
12.1 Is the sludge a hazardous waste as defined by 10 CSR 25? <input type="checkbox"/> Yes <input checked="" type="checkbox"/> No				
12.2 Sludge production, including sludge received from others: <u>0.68</u> Design dry tons/year _____ Actual dry tons/year				
12.3 Capacity of sludge holding structures: Sludge storage provided: _____ cubic feet; <u>45</u> days of storage; _____ average percent solids of sludge; <input type="checkbox"/> No sludge storage is provided. <input type="checkbox"/> Sludge is stored in lagoon.				
12.4 Type of Storage:				
		<input checked="" type="checkbox"/> Holding tank	<input type="checkbox"/> Building	
		<input type="checkbox"/> Basin	<input type="checkbox"/> Lagoon	
		<input type="checkbox"/> Concrete Pad	<input type="checkbox"/> Other (Describe) _____	
12.5 Sludge Treatment:				
<input type="checkbox"/> Anaerobic Digester		<input type="checkbox"/> Lagoon	<input type="checkbox"/> Composting	
<input checked="" type="checkbox"/> Storage Tank		<input type="checkbox"/> Aerobic Digester	<input type="checkbox"/> Other (Attach description)	
<input type="checkbox"/> Lime Stabilization		<input type="checkbox"/> Air or Heat Drying		
12.6 Sludge Use or Disposal:				
<input type="checkbox"/> Land Application		<input type="checkbox"/> Surface Disposal (Sludge Disposal Lagoon, Sludge held for more than two years)		
<input checked="" type="checkbox"/> Contract Hauler		<input type="checkbox"/> Hauled to Another treatment facility		
<input type="checkbox"/> Incineration		<input type="checkbox"/> Sludge Retained in Wastewater treatment lagoon		
<input type="checkbox"/> Solid waste landfill				
12.7 Person responsible for hauling sludge to disposal facility:				
<input type="checkbox"/> By applicant		<input checked="" type="checkbox"/> By others (complete below)		
NO SLUDGE HAULED AT THIS TIME.				
NAME		EMAIL ADDRESS		
ADDRESS		CITY	STATE	ZIP CODE
CONTACT PERSON		TELEPHONE NUMBER WITH AREA CODE		PERMIT NO. MO-
12.8 Sludge use or disposal facility				
<input type="checkbox"/> By applicant		<input checked="" type="checkbox"/> By others (Complete below.)		
NO SLUDGE HAULED AT THIS TIME.				
NAME		EMAIL ADDRESS		
ADDRESS		CITY	STATE	ZIP CODE
CONTACT PERSON		TELEPHONE NUMBER WITH AREA CODE		PERMIT NO. MO-
12.9 Does the sludge or biosolids disposal comply with federal sludge regulations under 40 CFR 503?				
<input checked="" type="checkbox"/> Yes <input type="checkbox"/> No (Explain)				

13. ELECTRONIC DISCHARGE MONITORING REPORT (eDMR) SUBMISSION SYSTEM

Per 40 CFR Part 127 National Pollutant Discharge Elimination System (NPDES) Electronic Reporting Rule, reporting of effluent limits and monitoring shall be submitted by the permittee via an electronic system to ensure timely, complete, accurate, and nationally-consistent set of data. **One of the following must be checked in order for this application to be considered complete.** Please complete the eDMR Registration by clicking on the following link: <https://dnr.mo.gov/forms/780-2204-f.pdf>.

- ☐ - You have completed and submitted with this permit application the required documentation to participate in the eDMR system.
- ☒ - You have previously submitted the required documentation to participate in the eDMR system and/or you are currently using the eDMR system.
- ☐ - You have submitted a written request for a waiver from electronic reporting. See instructions for further information regarding waivers.

14. JETPAY

Permit fees may be paid online by credit card or eCheck through a system called JetPay. Use the URL provided to access JetPay and make an online payment.

New Site Specific Permit: <https://magic.collectorsolutions.com/magic-ui/payments/mo-natural-resources/591/>

Construction Permits: <https://magic.collectorsolutions.com/magic-ui/payments/mo-natural-resources/592/>

Modification Fee: <https://magic.collectorsolutions.com/magic-ui/payments/mo-natural-resources/596/>

New General Domestic WW: <https://magic.collectorsolutions.com/magic-ui/payments/mo-natural-resources/772/>

15. CERTIFICATION

I certify under penalty of law that this document and all attachments were prepared under my direction or supervision in accordance with a system designed to assure that qualified personnel properly gather and evaluate the information submitted. Based on my inquiry of the person or persons who manage the system, or those persons directly responsible for gathering the information, the information submitted is, to the best of my knowledge and belief, true, accurate, and complete. I am aware that there are significant penalties for submitting false information, including the possibility of fine and imprisonment for knowing violations.

NAME (TYPE OR PRINT) <i>Keith Vanhooser</i>	OFFICIAL TITLE <i>General MANAGER</i>	TELEPHONE NUMBER WITH AREA CODE <i>636-456-7999 x123</i>
SIGNATURE <i>Keith Vanhooser</i>		DATE SIGNED <i>02/05/2020</i>

**INSTRUCTIONS FOR COMPLETING FORM B: APPLICATION FOR OPERATING PERMIT FOR FACILITIES
THAT RECEIVE PRIMARILY DOMESTIC WASTE AND HAVE A DESIGN FLOW
LESS THAN OR EQUAL TO 100,000 GALLONS PER DAY
(Facilities over 100,000 gallons per day of domestic waste must use FORM B2)
(Facilities that receive wastes other than domestic contact the department)**

1. Check the appropriate box. **Do not check more than one item.** Operating permit refers to a permit issued by the Department of Natural Resources' Water Protection Program. If an Antidegradation Review has not been conducted, submit the application located at the following link to the Missouri Department of Natural Resources, Water Protection Program, P.O. Box 176, Jefferson City, MO 65102: dnr.mo.gov/forms/780-1893-f.pdf.
- 1.1 **Fees Information:**

DOMESTIC OPERATING PERMIT FEES – PRIVATE

Annual operating permit fees are based on flow.

Annual fee/Design flow	Annual fee/Design flow	Annual fee/Design flow
\$150.....<5,000 gpd	\$1,000.....15,000-24,999 gpd	\$4,000.....100,000-249,999 gpd
\$300.....5,000-9,999 gpd	\$1,500.....25,000-29,999 gpd	\$5,000.....≥250,000 gpd
\$600.....10,000-14,999 gpd	\$3,000.....30,000-99,999 gpd	

New domestic wastewater treatment facilities must submit the annual fee with the original application.
If the application is for a site-specific permit re-issuance, send no fees. You will be invoiced separately by the department on the anniversary date of the original permit. Permit fees must be current for the department to reissue the operating permit. Late fees of two percent per month are charged and added to outstanding annual fees.

PUBLIC SEWER SYSTEM OPERATING PERMIT FEES (city, public sewer district, public water district, or other publicly owned treatment works). Annual fee is based on number of service connections. Fees listings are found in 10 CSR 20-6.011 which is available at <http://s1.sos.mo.gov/cmsimages/adrules/csr/current/10csr/10c20-6.pdf>. New public sewer system facilities should not submit any fee as the department will invoice the permittee.

OPERATING PERMIT MODIFICATIONS, including transfers, are subject to the following fees:

 - a. Publicly Owned Treatment Works (POTWs) - \$200 each.
 - b. Non-POTWs - \$100 each for a minor modification (name changes, address changes, other non-substantive changes) or a fee equal to 25% of the facility's annual operating fee for a major modification.
2. Name of Facility – Include the name by which this facility is locally known. Example: Southwest Sewage Treatment Plant, Country Club Mobile Home Park, etc. Provide the street address or location of the facility. If the facility lacks a street name or route number, provide the names of the closest intersection, highway, country road, etc.
 - 2.1 Self-explanatory
 - 2.2 Global Positioning System, or GPS, is a satellite-based navigation system. The department prefers that a GPS receiver is used at the outfall pipe and the displayed coordinates submitted. If access to a GPS receiver is not available, use a mapping system to approximate the coordinates; the department's mapping system is available at <https://modnr.maps.arcgis.com/apps/webappviewer/index.html?id=1d81212e0854478ca0dae87c33c8c5ce>.
 - 2.3-2.4 Self-explanatory
3. Owner – Provide the legal name, mailing address, phone number, and email address of the owner. The owner identified in this section and subsequently reflected on the certificate page of the operating permit, is the owner of the regulated activity/discharge being applied for and is not necessarily the owner of the real property on which the activity or discharge is occurring.
Prior to submitting a permit to public notice, the Department of Natural Resources shall provide the permit applicant 10 days to review the draft permit for nonsubstantive drafting errors. In the interest of expediting permit issuance, permit applicants may waive the opportunity to review draft permits prior to public notice.
- 3.2-3.4 Self-explanatory. The Financial Questionnaire is available at: <https://dnr.mo.gov/forms/780-2511-f.pdf>
4. Continuing Authority - A continuing authority is a company, business, entity or person(s) that will be operating the facility and/or ensuring compliance with the permit requirements. A continuing authority is not, however, an entity or individual that is contractually hired by the permittee to sample or operate and maintain the system for a defined time period, such as a certified operator or analytical laboratory. To access the regulatory requirement regarding continuing authority, 10 CSR 20-6.010(2), please visit <https://s1.sos.mo.gov/cmsimages/adrules/csr/current/10csr/10c20-6.pdf>. If the continuing authority is not an individual(s), government, or otherwise required to register with the Missouri Secretary of State (SoS), then the business name must be listed exactly as it appears on the SoS's webpage:
<https://bsd.sos.mo.gov/BusinessEntity/BESearch.aspx?SearchType=0>
5. Operator – Provide the name, certificate number, title, mailing address, primary phone number, and e-mail address of the operator of the facility.
6. Provide the name, title, mailing address, primary phone number, and e-mail address of a person who is thoroughly familiar with the operation of the facility and with the facts reported in this application and who can be contacted by the department.

7.1 Process Flow Diagram Examples

WASTEWATER TREATMENT LAGOON

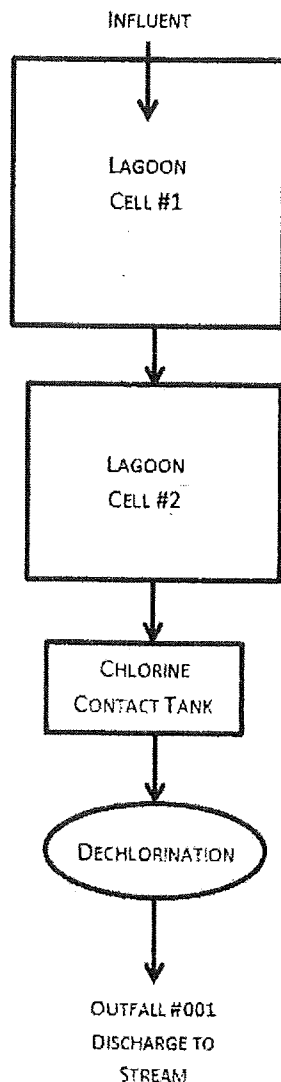

WASTEWATER TREATMENT FACILITY

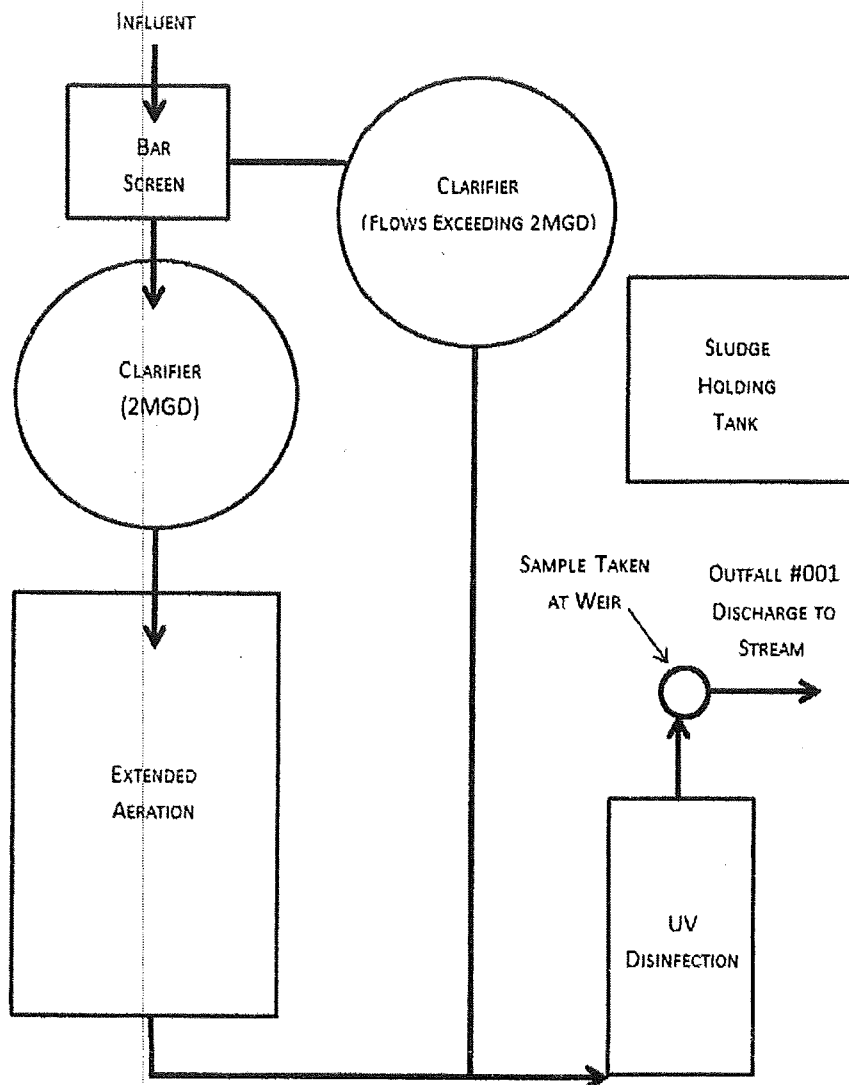

- 7.2 A topographic map is available on the Web at <https://modnr.maps.arcgis.com/apps/webappviewer/index.html?id=1d81212e0854478ca0dae87c33c8c5ce> or from the Department of Natural Resources' Geological Survey Division in Rolla at 573-368-2125.
- 8.1 For Standard Industrial Codes visit www.osha.gov/pls/imis/sicsearch.html or contact the Department of Natural Resources' Water Protection Program. For example, a family style restaurant has a Facility SIC code of 5812.
- 8.2-8.7 Self-explanatory.
- 8.8 If wastewater is land applied submit for Form I: www.dnr.mo.gov/forms/780-1686-f.pdf.
- 8.9-8.10 Self-explanatory

**INSTRUCTIONS FOR COMPLETING FORM B: APPLICATION FOR OPERATING PERMIT FOR FACILITIES
THAT RECEIVE PRIMARILY DOMESTIC WASTE AND HAVE A DESIGN FLOW
LESS THAN OR EQUAL TO 100,000 GALLONS PER DAY (continued)**

9. Self-explanatory.
- 10.1 Self-explanatory.
- 10.2 Self-explanatory.
- 10.3 If Inflow and Infiltration (I&I) is a problem at the facility, list possible actions to be taken to repair the collection and treatment facility.
11. Include overflows of combined sewers and lift stations or bypassing of the wastewater treatment facility. Provide a detailed description of the circumstances that sewage bypassing occurs and the frequency of occurrence.
12. A copy of 10 CSR 25 is available on the Web at www.sos.mo.gov/adrules/csr/current/10csr/10csr.asp#10-25.
- 12.1-12.8 Self-explanatory.
- 12.9 Refer to University of Missouri Extension Environmental Quality publications about biosolids (WQ420-WQ426). The documents are available at extension.missouri.edu/main/DisplayCategory.aspx?C=74. In addition, the federal sludge regulations are available through the U.S. Government Printing Office at <https://www.gpo.gov/fdsys/browse/collectionCfr.action?collectionCode=CFR>.
13. Electronic Discharge Monitoring Report (eDMR) Submission System – Visit the eDMR site at <https://dnr.mo.gov/env/wpp/edmr.htm> and click on the "Facility Participation Package" link. The eDMR Permit Holder and Certifier Registration Form and information about the eDMR system can be found in the Facility Participation Package. Waivers to electronic reporting may be granted by the Department per 40 CFR 127.15 under certain, special circumstances. A written request must be submitted to the Department for approval. Waivers may be granted to facilities owned or operated by:
- a. members of religious communities that choose not to use certain technologies or
 - b. permittees located in areas with limited broadband access. The National Telecommunications and Information Administration (NTIA) in collaboration with the Federal Communications Commission (FCC) have created a broadband internet availability map: <https://broadbandmap.fcc.gov/#/>. Please contact the Department if you need assistance.
14. **JETPAY**
Applicants can pay fees online by credit card or eCheck through a system called JetPay.
- a. Per Section 37.001, RSMo, a transaction fee will be included. The transaction fee is paid to the third party vendor JetPay, not the Department of Natural Resources.
 - b. Be sure to select the correct fee type and corresponding URL to ensure your payment is applied appropriately. If you are unsure what type of fee to pay, please contact the Water Protection Program's Budget, Fees, and Grants Management Unit by phone at (573) 522-1485 for assistance.
 - c. Upon successful completion of your payment, JetPay provides a payment confirmation. Submit this form with a copy of the payment confirmation if requesting a new permit or a permit modification. For permit renewals of active permits, the Department will invoice fees annually in a separate request.
 - d. If you are unable to make your payment online, but want to pay with credit card, you may email your name, phone number, and invoice number, if applicable, to WPPFees@dnr.mo.gov. The Budget, Fees, and Grants Management Unit will contact you to assist with the credit card payment. **Please do not include your credit card information in the email.**
 - e. Applicants can find fee rates in 10 CSR 20-6.011 (<https://dnr.mo.gov/pubs/pub2564.htm>).
15. **CERTIFICATION**
Signature - All applications must be signed as follows and the signatures must be original:
- a. For a corporation, by an officer having responsibility for the overall operation of the regulated facility or activity or for environmental matters.
 - b. For a partnership or sole proprietorship, by a general partner or the proprietor.
 - c. For a municipal, state, federal or other public facility, by either a principal executive officer or by an individual having overall responsibility for environmental matters at the facility.

Submittal of an incomplete application may result in the application being returned.

This completed form and any attachments along with the applicable permit fees, should be submitted to:

Department of Natural Resources
Water Protection Program
ATTN: NPDES Permits and Engineering Section
P.O. Box 176
Jefferson City, MO 65102

Map of regional offices with addresses and phone numbers are available on the Web at <https://dnr.mo.gov/regions/>. If there are any questions concerning this form, contact the appropriate regional office or the Department of Natural Resources, Water Protection Program, Operating Permits Section at 800-361-4827 or 573-522-4502.